

KitchenAid™

**BLADE GRINDER /
MOLINILLO CON CUCHILLAS /
MOEDOR COM LÂMINAS**

INSTRUCTIONS / INSTRUCCIONES / INSTRUÇÕES



FOR THE WAY IT'S MADE.™

Table of Contents

Blade Grinder Safety	2
Important Safeguards	3
Electrical Requirements	4
KitchenAid™ Blade Grinder Features	6
KitchenAid™ Blade Grinder Operating Instructions	7
Coffee Grinding Tips	8
Blade Grinder Care	9

Blade Grinder Safety

Your safety and the safety of others are very important.

We have provided many important safety messages in this manual and on your appliance. Always read and obey all safety messages.



This is the safety alert symbol.

This symbol alerts you to potential hazards that can kill or hurt you and others.

All safety messages will follow the safety alert symbol and either the word “DANGER” or “WARNING.” These words mean:



You can be killed or seriously injured if you don't immediately follow instructions.



You can be killed or seriously injured if you don't follow instructions.

All safety messages will tell you what the potential hazard is, tell you how to reduce the chance of injury, and tell you what can happen if the instructions are not followed.

IMPORTANT SAFEGUARDS

When using electrical appliances, basic safety precautions should always be followed, including the following:

1. Read all instructions.
2. To protect against risk of electric shock do not put Blade Grinder in water or other liquid.
3. Close supervision is necessary when any appliance is used by or near children.
4. Unplug Blade Grinder from outlet when not in use, before putting on or taking off parts, and before cleaning.
5. Avoid contacting moving parts.
6. Do not operate any appliance with a damaged cord or plug or after the appliance malfunctions, or is dropped or damaged in any manner. Return appliance to the nearest authorized service facility for examination, repair or electrical or mechanical adjustment.
7. The use of attachments not recommended or sold by KitchenAid may cause fire, electric shock, or injury.
8. Do not use outdoors.
9. Do not let cord hang over edge of table or counter, or touch hot surfaces.
10. Check bowl for presence of foreign objects before using.
11. This product is designed for household use only.
12. Do not place on or near a hot gas or electric burner or in a heated oven.
13. Do not use appliance for other than intended use.
14. This appliance is not intended for use by persons (including children) with reduced physical sensory or mental capabilities, or lack of experience and knowledge, unless they have been given supervision or instruction concerning use of the appliance by a person responsible for their safety. Children should be supervised to ensure that they do not play with the appliance.

SAVE THESE INSTRUCTIONS

Electrical Requirements

Volts: 220-240 Volts AC only

Hertz: 60 Hz

(Brazil Only: 127 Volts AC / 60 Hz)

NOTE: This Blade Grinder has a grounded plug. To reduce the risk of electrical shock, this plug will fit in an outlet only one way. If the plug does not fit in the outlet, contact a qualified electrician. Do not modify the plug in any way.

A short power supply cord is provided to reduce the risk resulting from becoming entangled in or tripping over a longer cord. Extension cords are available and may be used if care is exercised in their use.

If a longer extension cord is used,

- The marked electrical rating of the extension cord should be at least as great as the electrical rating of the appliance.
- The cord should be arranged so that it will not drape over the countertop or tabletop where it can be pulled on by children or tripped over unintentionally.

⚠ WARNING



Electric Shock Hazard

Plug into a grounded outlet.

Do not use with an adaptor or T.

Do not use with an extension cord.

Failure to follow these instructions could result in death, fire, or electric shock.

Electrical Requirements For Brazil Only

! WARNING



Electric Shock Hazard

Plug into a grounded 3-prong outlet.

Do not remove the ground prong.

Do not use with an adaptor or T.

Do not use with an extension cord.

Failure to follow these instructions could result in death, fire, or electric shock.

Residence mains:

The mains wires must be of copper with a minimum cross-section per ABNT (NBR-5410.)

To protect this appliance and the mains against over loading, this appliance must be connected to a circuit that is protected with a thermo-magnetic circuit breaker.

If the household circuit does not include a circuit breaker, contact an electrician to have one installed.

Electric outlet:

For your safety and to avoid damage to your product, it is very important that your product is earthed correctly.

Your appliance power cord features a 3-pin-shaped hexagon-shaped plug, 10A, per ABNT (NBR 14136).

Your residence electrical installation must have a suitable electric outlet for this type of plug. If not, it is your responsibility to have one installed by a qualified electrician.

Use appropriate outlet type for your appliance plug, as shown below:

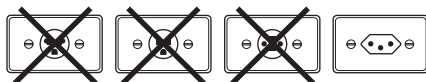

Before operating this appliance, make sure the main voltage at the installation site is the same as indicated on product technical data label.

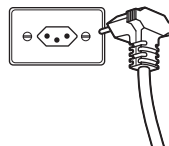

This information is also included on the label attached to your appliance's cord near the plug.

IMPORTANT:

- If it is necessary to convert your 127V appliance to 220V, use a 1.0 KVA stabiliser.
- If it is necessary to convert your 220V appliance to 127V, use a 1.0 KVA stabiliser.
- Never plug your appliance into multi-plug adapters with another appliance in the same socket. Do not use an extension cord. This type of connection may cause electrical overload in the mains, and can damage the appliance and could cause a fire. The appliance should be plugged into its own outlet.
- In case of oscillation in mains voltage, install an automatic voltage stabiliser with minimum rating of 1500 Watts between the appliance and the socket.
- If the cord of this appliance is damaged, it must be replaced. Contact your nearest authorized KitchenAid Customer Care Center.

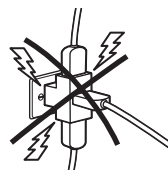

KitchenAid™ Blade Grinder Features

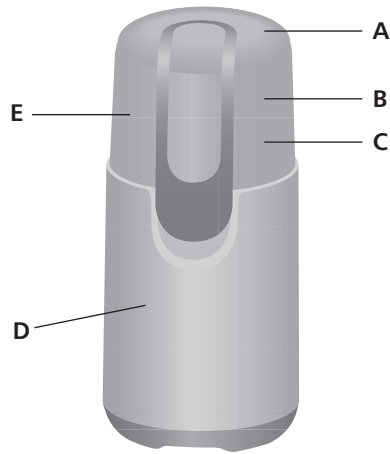

A. Clear top cover with fingertip control

B. Removable stainless steel 125 mL capacity bowl

C. Stainless steel blade (not shown)

D. Brushed stainless steel housing

E. Dual safety switch system

Clear Top Cover

Push down on the clear top cover to begin grinding and release to stop grinding. Top cover must be in place to operate Blade Grinder. Cover can be washed in the top rack of a dishwasher.

Stainless Steel 125 mL Capacity Bowl

Bowl has measurement markings etched inside for ease of processing the amount of beans needed for 4, 8, 10, or 12 cups of coffee. It locks into the motor housing with a clockwise turn. Bowl can be washed in a dishwasher.

Stainless Steel Blade

Blade is mounted inside stainless steel bowl.

Dual Safety Switch System

Dual switch mechanism keeps the Blade Grinder from operating until the top cover is correctly positioned over side guides on the motor housing.

Heavy Duty Motor Housing

Keeps Blade Grinder stable during operation.

Round Power Cord (not shown)

Cleans easily.

KitchenAid™ Blade Grinder Operating Instructions

Before First Use:

Wash bowl and top cover in hot, soapy water. Rinse and dry. Handle the blade gently. Bowl and top cover can also be washed in the dishwasher (top rack only).

To Use Blade Grinder:

1. Be sure the Blade Grinder is unplugged. Make sure inside of top cover is free of coffee grinds or residue.
2. Secure the bowl to the motor housing by placing the bowl on top and turning clockwise to lock into place.

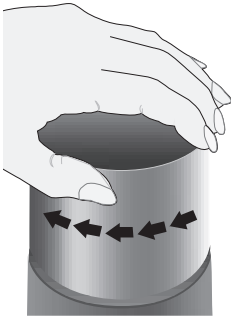

3. A scale is provided inside the bowl for the recommended amount of beans to grind for 4, 8, 10, and 12 cups of coffee. Fill the bowl to your desired cup size (4 cups minimum or 12 cups maximum) level. Various bean blends and bean sizes can cause differences in fill level and grind times.
4. Position the top cover over the bowl so that the lid's latch aligns with the motor housing base and the side guides fall into place.

NOTE: Make sure both cover and bowl are in position; otherwise, the coffee grinder will not operate.

5. Plug power cord into electrical outlet.
6. Press down the top cover to start processing. For optimum grinding results, do not pulse the top cover. Continue grinding until all the beans are ground to the desired consistency or see the "Suggested Grinding Chart" in the "Grinding Tips" section for automatic drip coffee makers and French Press machines.

NOTE: Do not operate the Blade Grinder for longer than 25 seconds.

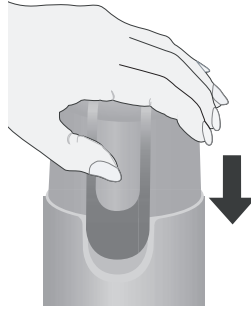

7. To stop processing, release pressure on top cover.
8. Unplug the Blade Grinder.
9. Wait until the blade has stopped rotating and remove top cover.
10. Unlock bowl by turning it counter-clockwise from the motor housing.

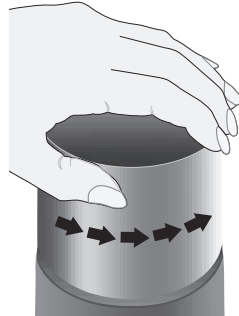

11. Pour out contents.

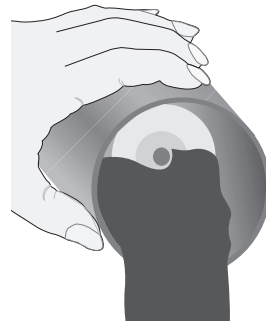

Coffee Grinding Tips

1. Grind only beans you will immediately use for freshest tasting coffee.
2. Adjust amount of coffee beans and grinding time to suit your own personal taste. Shorter grinding time results in coarser grinds. Longer grinding times result in finer grinds, but can overheat the coffee grinds and valuable coffee flavors can be lost. (For optimum grinding results, do not pulse top cover.)

NOTE: KitchenAid does not recommend using this grinder to grind beans for pump espresso-type machines.

SUGGESTED GRINDING CHART

AUTOMATIC DRIP COFFEE MAKERS
AND FRENCH PRESS MACHINES*

12-CUP FILL LINE

Grind Time = 21 seconds
Automatic Drip



10-CUP FILL LINE

Grind Time = 19 seconds
Automatic Drip



8-CUP FILL LINE

Grind Time = 17 seconds
Automatic Drip



4-CUP FILL LINE

Grind Time = 14 seconds
Automatic Drip



*French Press machines require a course grind. For optimum results, process beans continuously until desired grind size is achieved.

Blade Grinder Care

1. Always unplug Blade Grinder before cleaning.
2. Remove the bowl and top cover. Wash in hot, soapy water, rinse and dry. Bowl and top cover can also be washed in the dishwasher (top rack only). After removing from dishwasher, allow to cool before assembling.
3. Wipe the motor housing clean with a damp, soft cloth.
NOTES: Do not use abrasive cleaners. Do not immerse the motor housing in water.
4. Wipe cord with warm, sudsy cloth; then wipe clean with damp cloth. Dry with soft cloth.
5. Reassemble your Blade Grinder after cleaning.