

IndiGraph

EN

¿What is it?

Indigraph is a fountain pen designed to keep the ink fresh allowing the use of special inks like indian and calligraphy ink. The core of the product is to avoid the clogging of the nib, making it ideal for artistic purposes.

Indigraph has a water reservoir with a special membrane that allows humidity to keep the nib wet.

⚠ Caution

Warnings:

Firstly fill the reservoir with water.

Keep the reservoir always with water.

Don't let the nib exposed to the air without cap if it is not in use.

Do not fill with hot water.

Cleaning the pen monthly is highly recommended.

Load Water

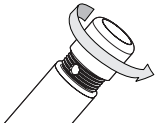

Open the reservoir cap until the hole appears.

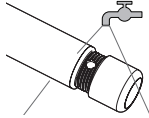

Put under the tap with the hole upwards.

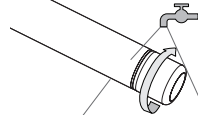

Close the cap under the tap.

⚠ Close softly.



Water level can be seen through the window.

Load Indian ink

Converter Method

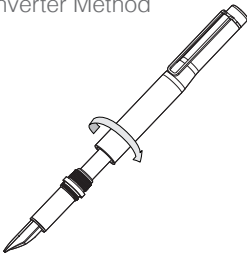

Disassemble the body.

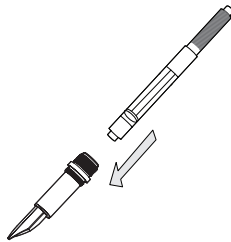

Remove the converter from the grip.

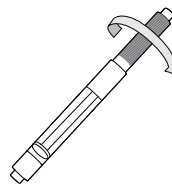

Slide piston for next absorption.

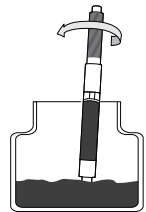

Introduce the tip in the ink and twist until full. Clean when finished.

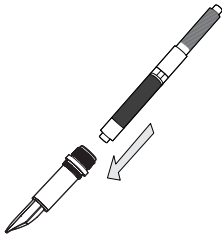

Put in the grip.



Twist counter-clockwise until a drop falls.

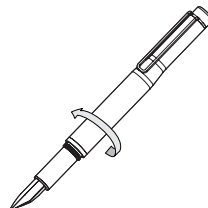

Assemble the body and clean the nib.

Nib Replacement

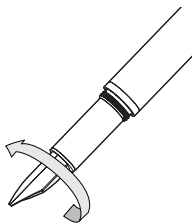

Twist the nib counter-clockwise holding firmly the grip.

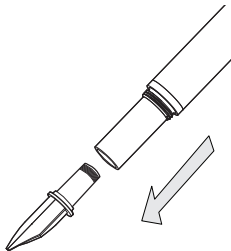

Take out and change the nib.

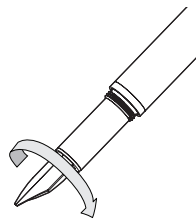

Assemble to the grip twisting clockwise.

Cleaning Indian ink

Dry ink



Put the nib under the tap.

Clog ink

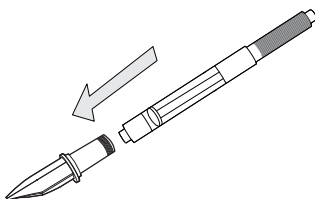

Disassemble the converter and the nib out of the fountain pen and assemble both pieces.

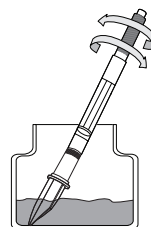

1/ Fill and empty the converter with water and few drops of ammonia.
2/ Submerge at least 2h the nib in water and ammonia and let the ammonia work.
3/ Repeat first step for optimal cleaning.

Ink

Ink Indian

Indigraph ink**	
Kuretake Black 60	
Pebeo	
Talens Drawing	
Pelikan 17	
Speedball Super Black	
Sennelier	
Talens	
Herbin	
Carbon	
Rotring	

Ink Color

Aero color- Schmincke	
Pelikan color	
Winsor and Newton ink	
Liquitex ink	
Amsterdam Acrylic ink	
Koh-i-noor shellac	
Pebeo color	

*For ink replacement make clog ink cleaning method without ammonia when the converter is empty.

** Specially formulated indian ink for Indigraph use.

