



LED Under cabinet lighting

UCA-LED Series

RDALIGHTING.COM

Agenda

- Introduction
- Accessories
- Simple plug in and hardwire lighting assembly
- FAQs

Key features

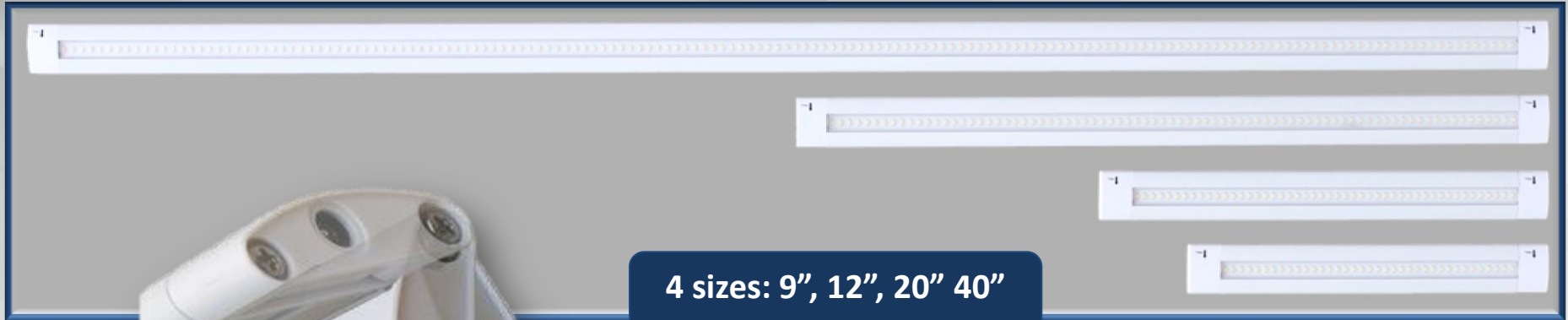

4 sizes: 9", 12", 20" 40"



Ultra slim pivoting design



Hardwired or Plug in

Key features



Dimmable

3000K

4000K

Color temperature options



Wide range of accessories

Accessories



ACCESSORIES

4 accessories



UCA-DC Junction Box Connector

Allows you to run bell wire (18-2 LVT) behind the dry wall.

PIR Motion Sensor

Detects motion in the room and switches the light On/Off.

Touch Dimmer

Dims light to desired levels.
Touch On/Off
Touch dim

Switch Connector

On/off switch ideal for plugin installs.

2 Load Splitters



4 WAY SPLITTER

Splits the load from one power supply in 4 runs



8 WAY SPLITTER

Splits the load from one power supply in 8 runs

2 connectors



Direct Connector

Cable Connector

- 6"
- 1 meter (40")
- 2 meter (80")

Connects fixtures and accessories in a single run.

3 Plug in power supplies, 5 Hard wired power supplies



Plug in Power Supply

- 6W
- 24W
- 48W

Hardwired Power Supply

- 25W (non-dimmable)
- 40W (dimmable)
- 60W (dimmable)
- 96W (dimmable)
- 150W (magnetic, dimmable)

UCA Simple Plug in Assembly

Switch connector or touch
dimmer connector or
occupancy sensor

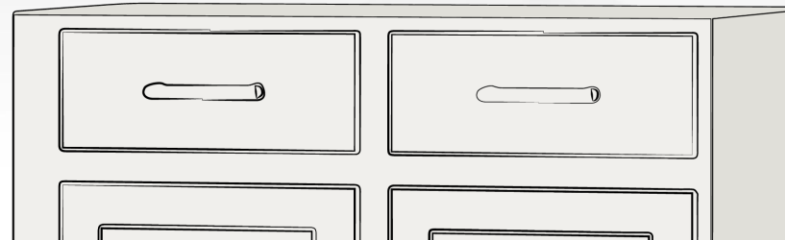
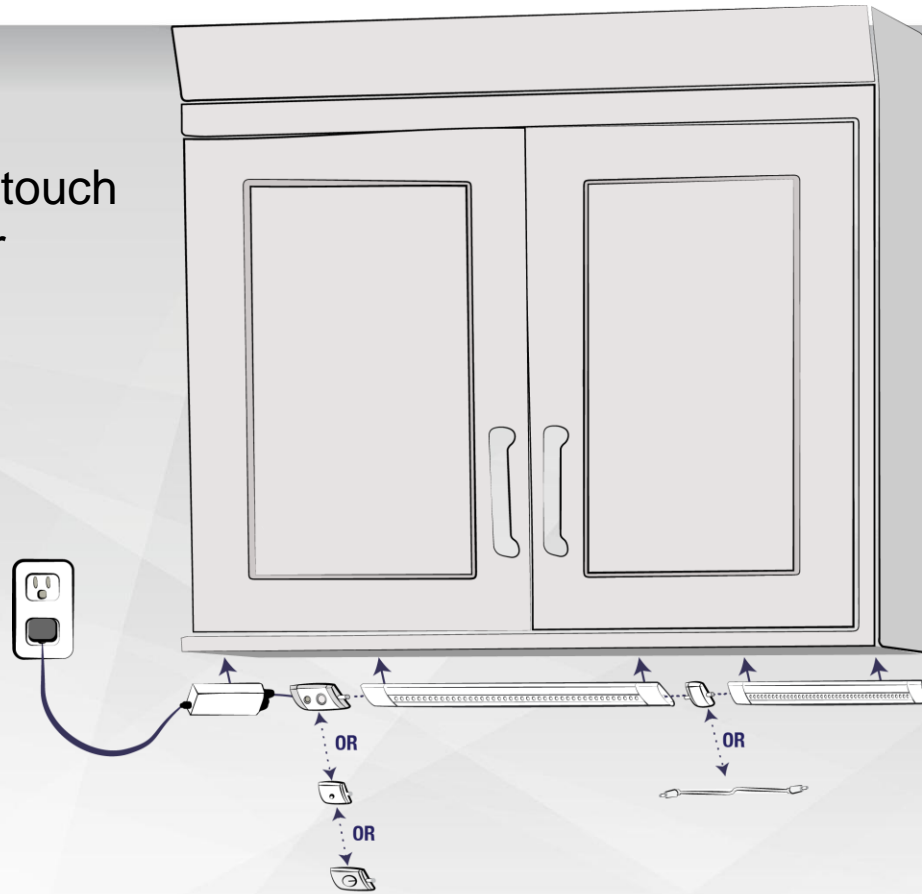

UCA Simple Hard wired Assembly

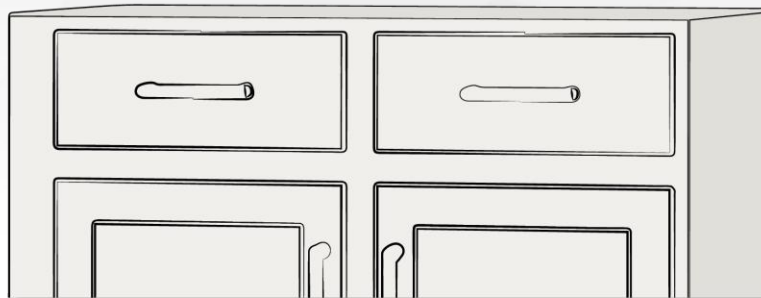
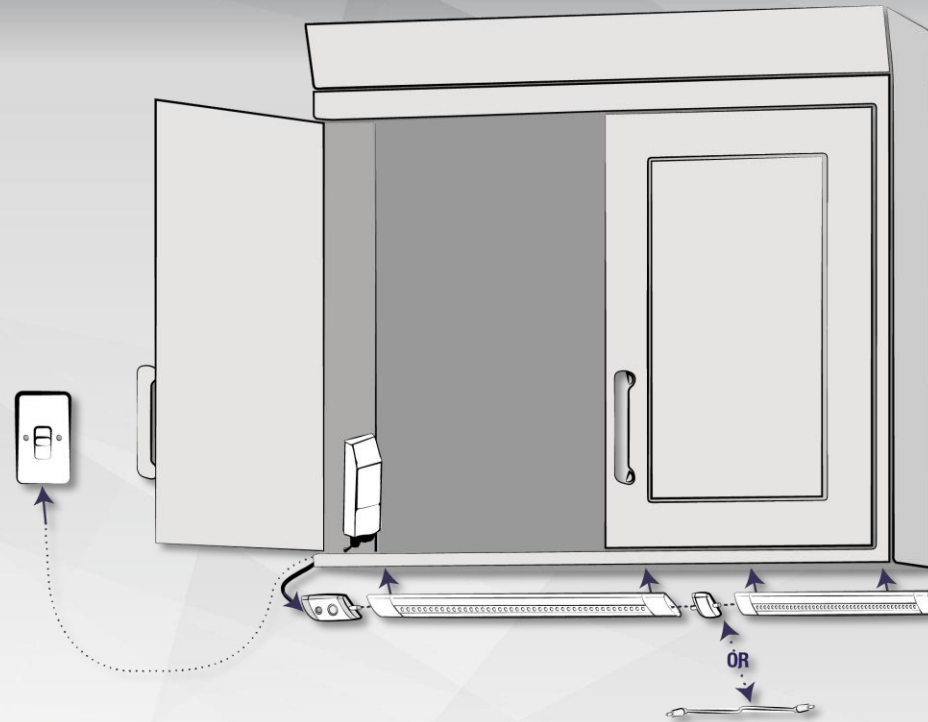

Frequently Asked Questions

- What is the maximum wattage on a series run?

32W

Helpful
Tips

When selecting a power supply, sum up the wattage of individual components in your run, add a buffer of 10% for voltage drops on the line to decide the maximum wattage you will need.

Frequently Asked Questions

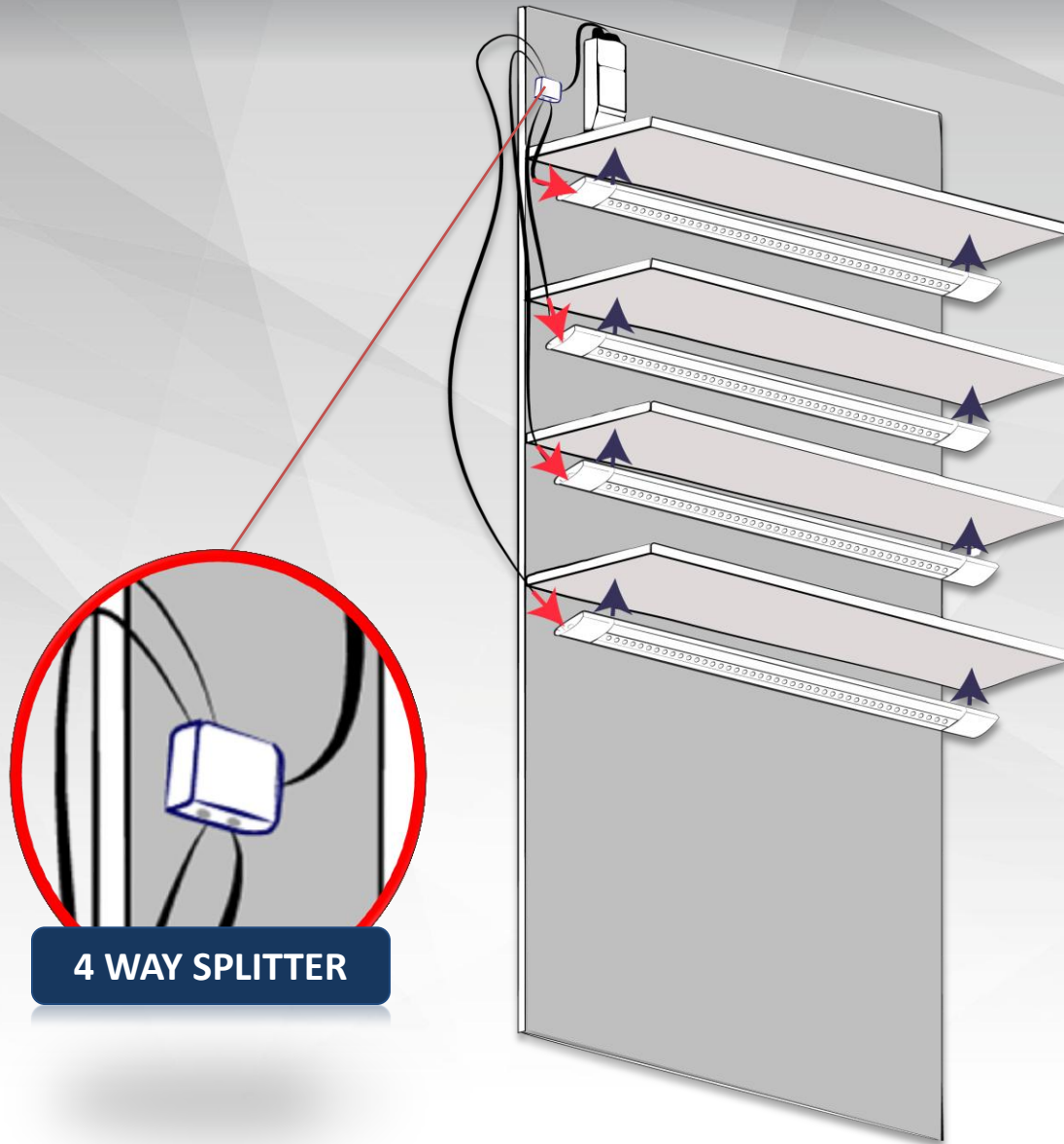

- What accessory do you use to create 4 different runs on a single power supply?

Frequently Asked Questions

- How do you run bell wire behind a dry wall?

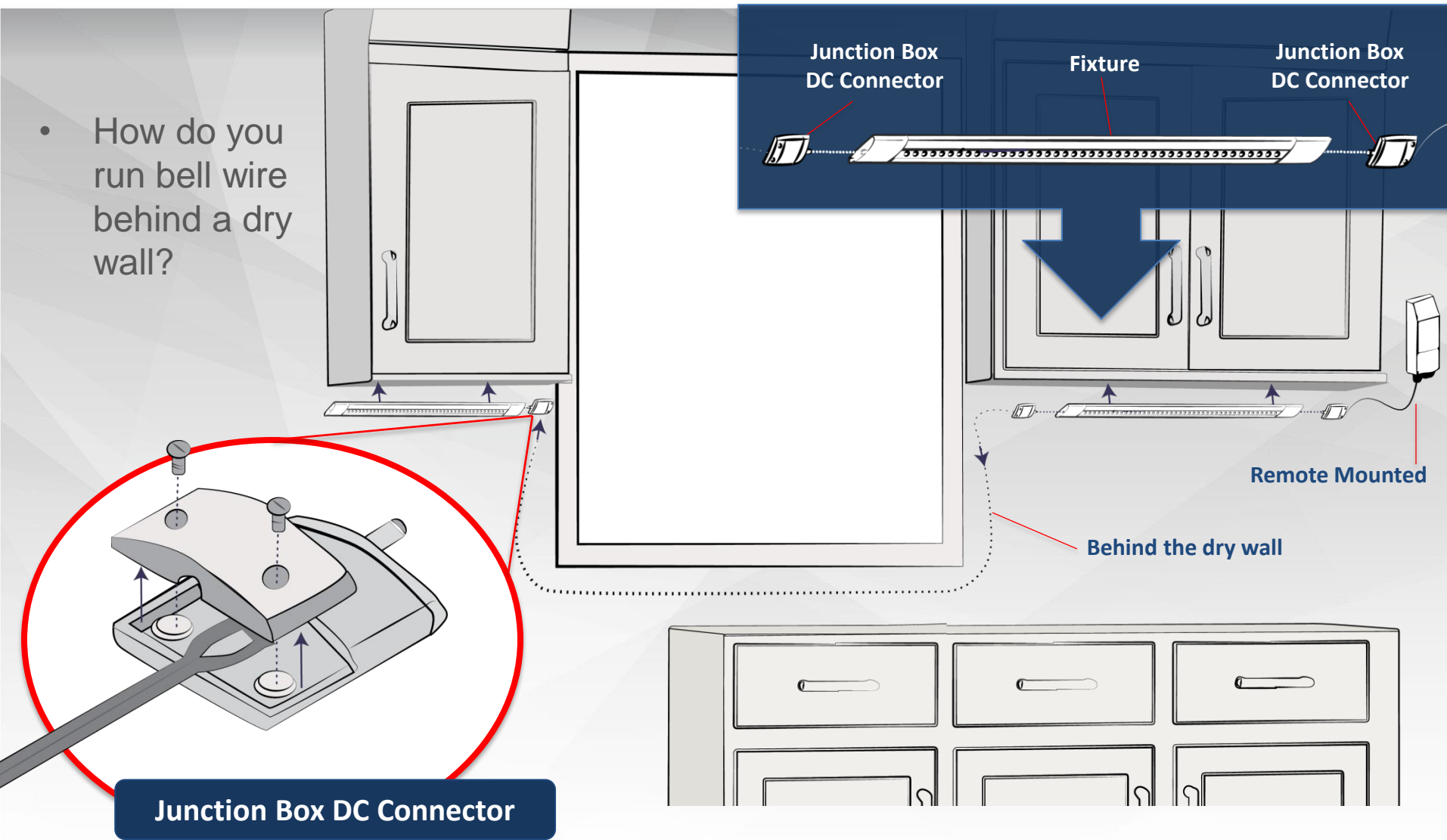

Frequently Asked Questions

- Will UCAs work in wet locations such as freezers?

NO



They are meant for dry, interior applications.

Frequently Asked Questions

- Is there a 12V DC option available?

YES (Special Order)

- Can you have a cable hard wired to the fixture?

YES (Special Order)

Helpful
Tips

12V DC Option typically used in boats and motor homes.

Frequently Asked Questions

Where do you mount under cabinet light?

One third of the distance from the edge of the wall.

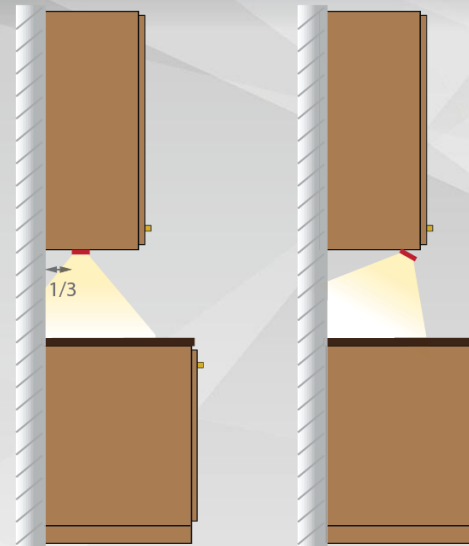

Helpful
Tips

With UCA's adjustable mounting bracket, you can direct light outward toward work areas.

In case of glossy counter tops/backsplashes, you could mount the fixture closer to the edge of the cabinet and direct light inwards to create an indirect lighting effect. This helps limit the glare that arises from glossy surfaces.

Frequently Asked Questions

- **How do you determine how many light fixtures you need?**

Take measurements of every section of the under cabinet as shown in the diagram below:

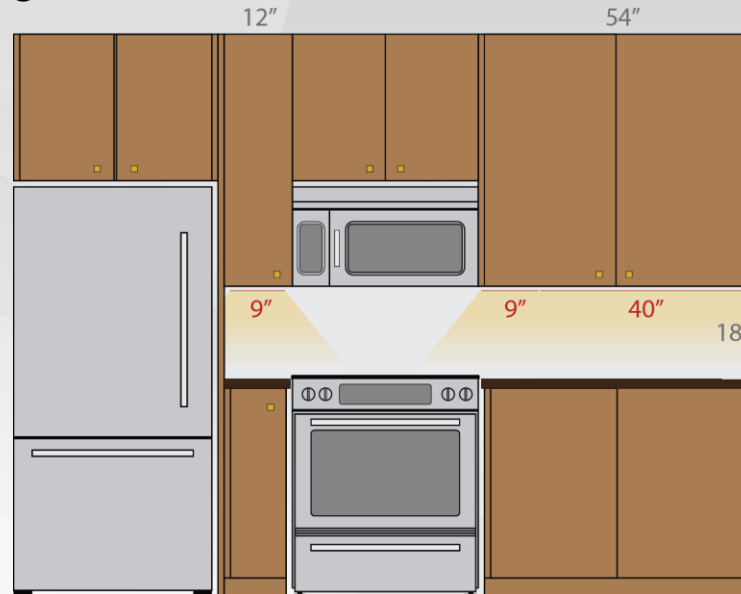

Helpful
Tips

For the UCA, try to cover the entire length of the cabinet for uniform lighting. Ensure you allocate enough space for accessories/connectors (typically 1 -2")

- If your customers need a custom lighting layout for their kitchen, direct them to:

blog.rdalighting.com/UCA-custom-layout

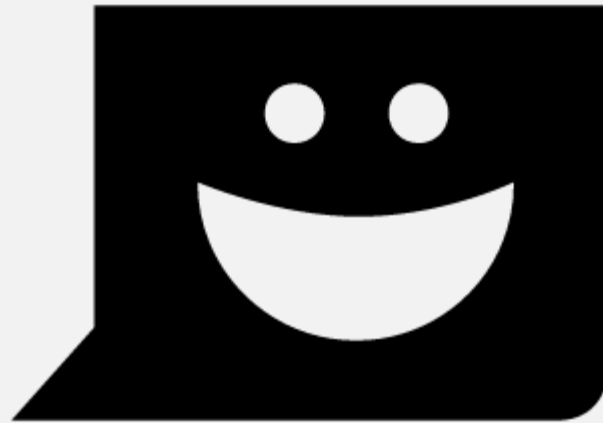

Thank you!