

FORMER 210/2 251 etc.



KNURLED KNOBS M6 x

Former base socket 02-41-135-55
first: 01-82-951-55 M6x21
then: 01-82-949-55 M6x19

Current base socket 02-41-130-55
screw: 01-82-948-55 M6x16

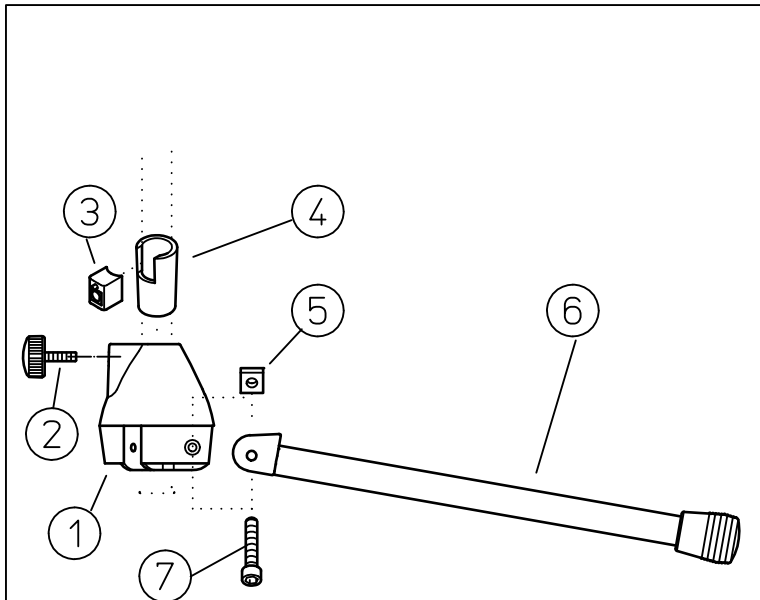
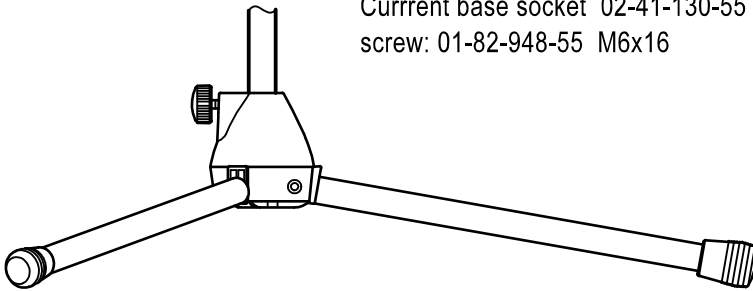
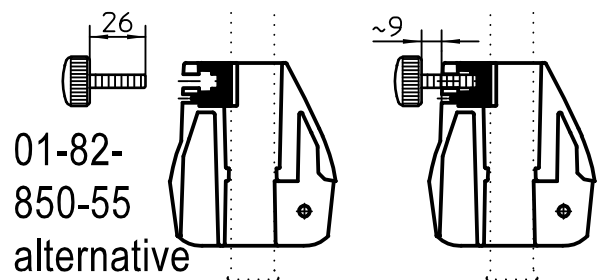
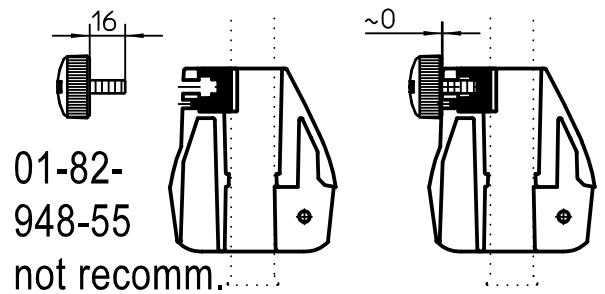
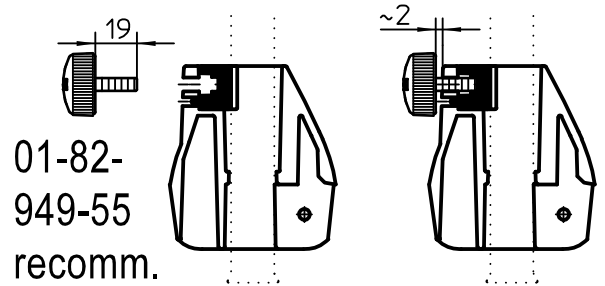
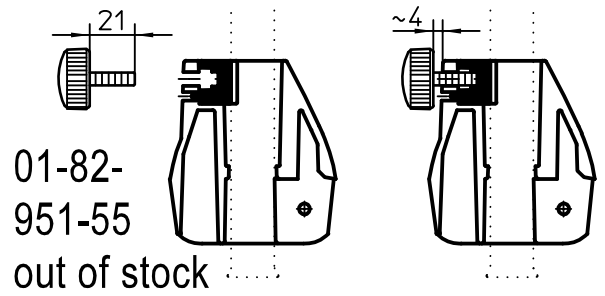

Fig.: Knurled knobs for former base socket 02-41-135-55



SPARES - TILL 2008

NO	PART NAME	CODE-NR.	Q'TY
1	SOCKET	02.41.135.55	- 1
2	KNURLED KNOB	01.82.949.55	- 1
3	LOCKING SPACER	6.86642.1.55	- 1
4	SPACER RING	01.86.260.55	- 1
5	SQUARE NUT	03.08.210.29	- 3
6	COMPLETE LEG	6.21025.1.55	- 3
7	ALLEN SCREW M5x30	03.02.165.00	- 3

SPARES - SINCE 2008

PART NAME	CODE-NR.
SOCKET	02.41.130.55
KNURLED KNOB	01.82.948.55
LOCKING SPACER	6.86642.1.55
SPACER RING	01.86.261.55
SQUARE NUT	03.08.210.29
COMPLETE LEG	6.21025.1.55
ALLEN SCREW M5x36	03.02.176.00