

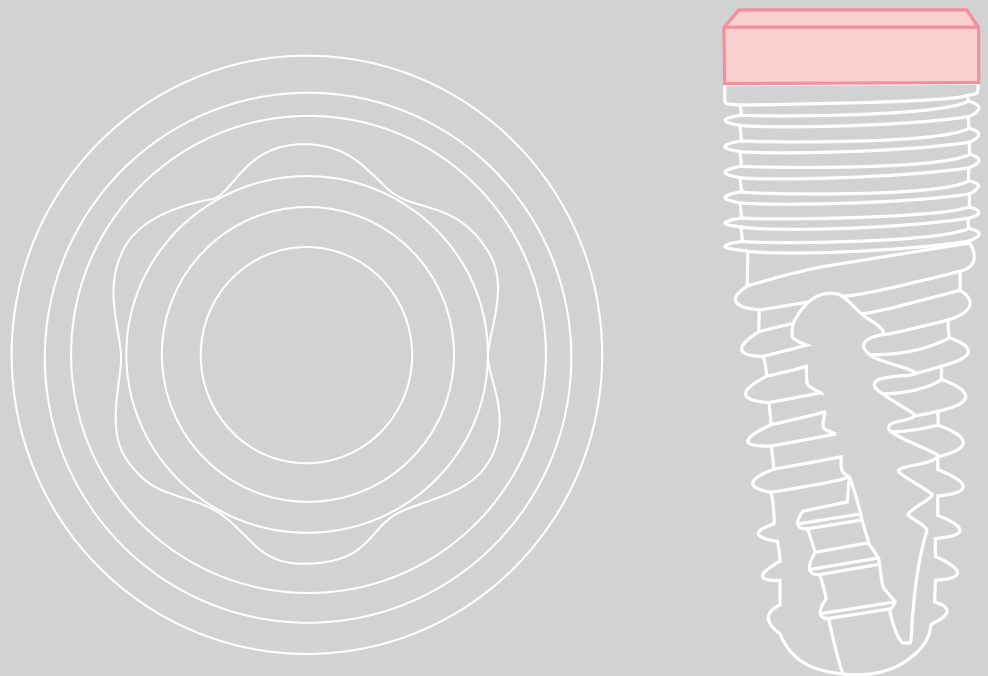

Smarter Thinking. Simpler Design.



Genesis

Product Catalog

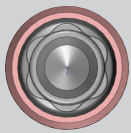

Genesis

Ø3.5/3.8 mm Genesis Implants	4
Ø3.5/3.8 mm Prosthetic Options	5
Ø3.5/3.8 mm Prosthetic Components	6
Ø4.5 mm Genesis Implants	10
Ø4.5 mm Prosthetic Options	11
Ø4.5 mm Prosthetic Components	12
Ø5.5/6.5 mm Genesis Implants	16
Ø5.5/6.5 mm Prosthetic Options	17
Ø5.5/6.5 mm Prosthetic Components	18

Digital

Imagine™ Milling Services	23
Core3dcentres®	26
In-Office Milling	28

LOCATOR® Abutments

LOCATOR® Prosthetic Options	30
LOCATOR® Abutment	31
LOCATOR® R-Tx™ Abutment	32
LOCATOR® F-Tx™ Abutment	33

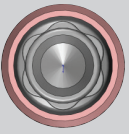

Surgical Kit & Instruments

Genesis Surgical Kit	35
Genesis Instruments	36

Surgical Motors & Accessories

Surgical Motors	40
Surgical Motor Accessories	42
Terms & Conditions	43

Product specifications are subject to change without notice.
Items illustrated are not to scale.



Genesis Implants

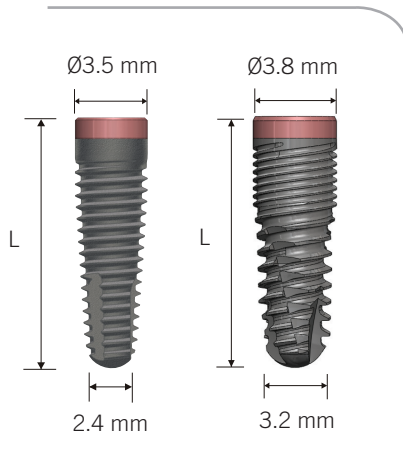

Catalog #

- G21050**
- G21051**
- G21052**
- G21053**

- G21130**
- G21131**
- G21132**
- G21133**
- G21135**

Implant Size

- Ø3.5 x 10 mm Length
- Ø3.5 x 11.5 mm Length
- Ø3.5 x 13 mm Length
- Ø3.5 x 16 mm Length
- Ø3.8 x 8.5 mm Length
- Ø3.8 x 10 mm Length
- Ø3.8 x 11.5 mm Length
- Ø3.8 x 13 mm Length
- Ø3.8 x 16 mm Length

Cover Screw



Catalog #

- G21100**

Description

- Ø3.5/3.8 mm

Healing Abutments



Catalog #

- G21103**
- G21104**
- G21105**
- G21106**

Description

- Ø3.5/3.8 mm
- Ø3.5/3.8 mm
- Ø3.5/3.8 mm
- Ø3.5/3.8 mm

Flare

- 4.0 mm
- 4.0 mm
- 5.0 mm
- 5.0 mm

Cuff Height

- 3.0 mm
- 5.0 mm
- 3.0 mm
- 5.0 mm

The Ø3.5 & Ø3.8 mm Genesis can be restored with Ø4.0 and Ø5.0 mm flared prosthetic components. An Abutment Screw is included with all TiLobe® abutments.

Ø3.5 mm Implant available in 2016.

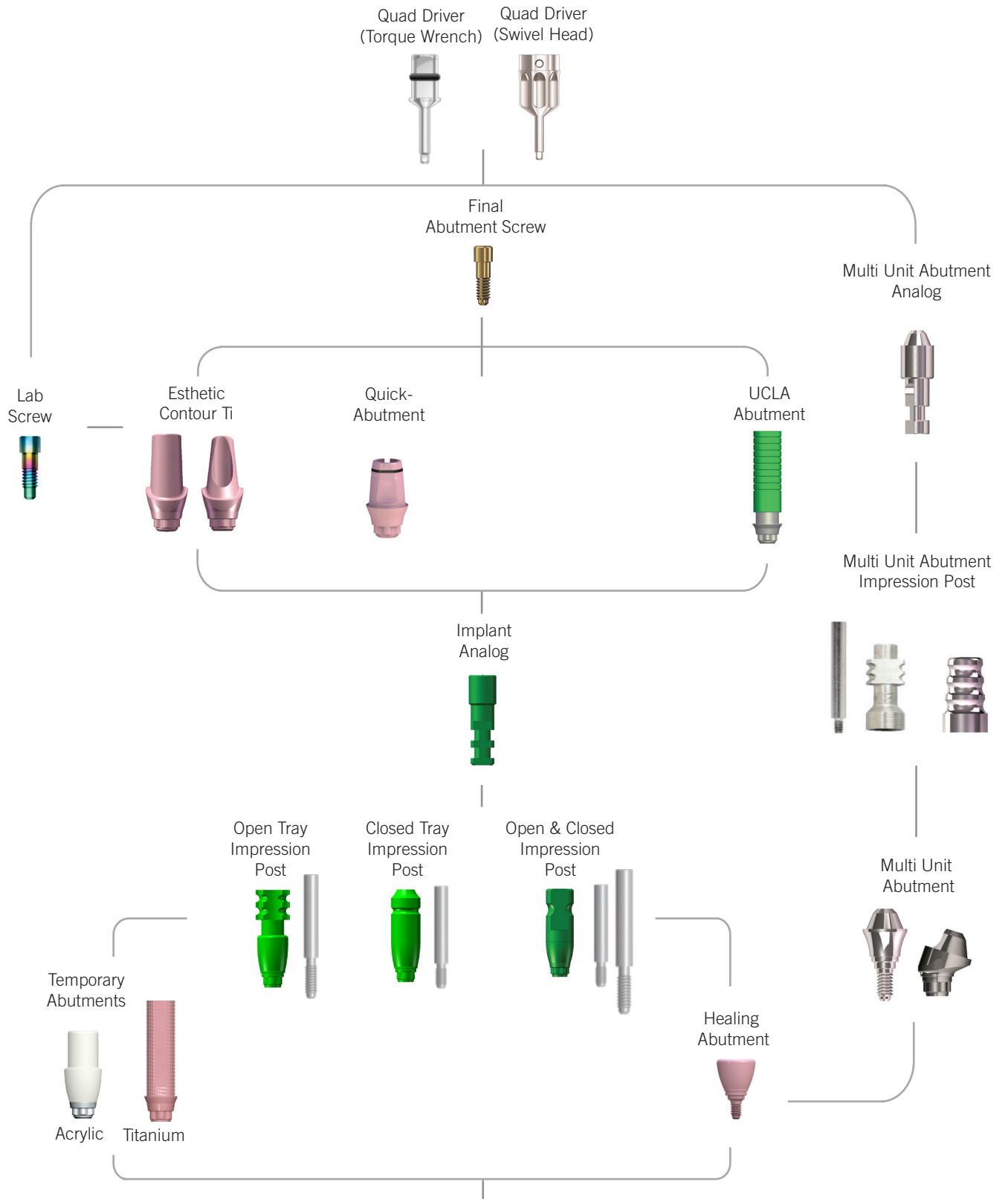



Prosthetic Components

Internal TiLobe®

Open & Closed Tray Impression Post



Catalog #	Description	Flare
G71100	Ø3.5/3.8 mm	4.0 mm
G71101	Ø3.5/3.8 mm	5.0 mm

Open Tray Impression Post



Catalog #	Description	Flare
45904K	Ø3.5/3.8 mm	4.0 mm
45906K	Ø3.5/3.8 mm	5.0 mm

Closed Tray Impression Post



Catalog #	Description	Flare
45905K	Ø3.5/3.8 mm	4.0 mm
45907K	Ø3.5/3.8 mm	5.0 mm

Implant Analog



Catalog #	Description
G71107	Ø3.5/3.8 mm, 1-Pack
G71108	Ø3.5/3.8 mm, 10-Pack

Temporary Abutment



Catalog #	Description	Flare
G71130	Ø3.5/3.8 mm, Locking	4.0 mm
G71131	Ø3.5/3.8 mm, Non-Locking	4.0 mm
G71132	Ø3.5/3.8 mm, Locking	5.0 mm
G71133	Ø3.5/3.8 mm, Non-Locking	5.0 mm

Ti Temporary Abutment



Catalog #	Description
G71144	Ø3.5/3.8 mm, Locking
G71145	Ø3.5/3.8 mm, Non-Locking

Esthetic Contour Ti Abutment

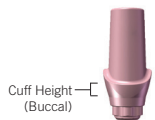

Catalog #	Description	Flare	Cuff Height
G71200	Ø3.5/3.8 mm, Straight	4.0 mm	1.0 mm
G71201	Ø3.5/3.8 mm, Straight	4.0 mm	2.0 mm
G71202	Ø3.5/3.8 mm, 15° Angled	4.0 mm	1.0 mm
G71203	Ø3.5/3.8 mm, 15° Angled	4.0 mm	2.0 mm
G71204	Ø3.5/3.8 mm, Straight	5.0 mm	1.0 mm
G71205	Ø3.5/3.8 mm, Straight	5.0 mm	3.0 mm
G71206	Ø3.8 mm, 15° Angled	5.0 mm	1.0 mm
G71207	Ø3.8 mm, 15° Angled	5.0 mm	3.0 mm

UCLA Abutment



Catalog #	Description	Cuff Height
G71231	Gold/Plastic Sleeve, Locking	1.0 mm
G71232	Gold/Plastic Sleeve, Non-Locking	1.0 mm

Replacement
Final Abutment Screw



Catalog # Description

G71125 1-Pack

Laboratory Screw



Catalog # Description

G71127 10-Pack

Quick-Packs



Catalog # Description Flare Cuff Height

G71400	Ø3.5/3.8 mm	5.0 mm	1.0 mm
G71401	Ø3.5/3.8 mm	5.0 mm	2.0 mm
G71402	Ø3.5/3.8 mm	5.0 mm	3.0 mm
G71403	Ø3.5/3.8 mm	5.0 mm	4.0 mm

Quick-Abutment

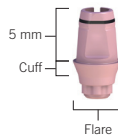

Catalog # Description Flare Cuff Height

G71434	Ø3.5/3.8 mm	5.0 mm	1.0 mm
G71435	Ø3.5/3.8 mm	5.0 mm	2.0 mm
G71436	Ø3.5/3.8 mm	5.0 mm	3.0 mm
G71437	Ø3.5/3.8 mm	5.0 mm	4.0 mm

Quick-Abutment
Quick-Cap®



Catalog # Description Flare

G71428 Ø3.5/3.8 mm, 1-Pack 5.0 mm

Quick-Abutment
Temporary/Healing Cap



Catalog # Description Flare

G71462 Ø3.5/3.8 mm 5.0 mm

Quick-Abutment Analog



Catalog # Description Flare

G71468 Ø3.5/3.8 mm 5.0 mm

Quick-Abutment
Plastic Sleeve



Catalog # Description Flare

G71478	Ø3.5/3.8 mm, Locking	5.0 mm
G71479	Ø3.5/3.8 mm, Non-Locking	5.0 mm

Quick-Abutment
Ceramic Coping



Catalog # Description Flare

G71475 Ø3.5/3.8 mm 5.0 mm



Prosthetic Components

Internal TiLobe®

Multi Unit Abutment



Catalog #

Description

Cuff Height

45312K

Ø3.5/3.8 mm, Straight

1.0 mm

45313K

Ø3.5/3.8 mm, Straight

2.0 mm

45314K

Ø3.5/3.8 mm, Straight

3.0 mm

45321K

Ø3.5/3.8 mm, Angled, 17°

3.0 mm

45322K

Ø3.5/3.8 mm, Angled, 17°

4.0 mm

45936K

Ø3.5/3.8 mm, Angled, 30°

3.0 mm

45937K

Ø3.5/3.8 mm, Angled, 30°

4.0 mm

45938K

Ø3.5/3.8 mm, Angled, 30°

5.0 mm

Multi Unit Abutment Healing Cap



Catalog #

Description

45330K

Ø3.5/3.8 mm

Multi Unit Abutment Impression Post



Catalog #

Description

45327K

Open Tray, Ø3.5/3.8 mm with screw

45328K

Closed Tray, Ø3.5/3.8 mm

Multi Unit Abutment Analog



Catalog #

Description

45329K

Ø3.5/3.8 mm



**Multi Unit Abutment
Ti Temporary Sleeve**



Catalog #

45331K

Description

Ø3.5/3.8 mm

**Multi Unit Abutment
Plastic Sleeve**



Catalog #

45332K

Description

Ø3.5/3.8 mm

**Multi Unit Abutment
Prosthetic Screw**



Catalog #

45333K

Description

1-Pack

**Angled Multi-Unit Abutment
Replacement Screw**



Catalog #

45334K

Description

1-Pack

Genesis Implants

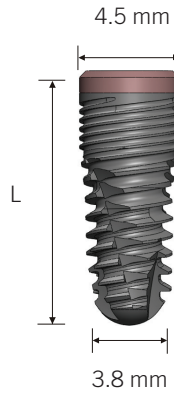

Catalog #

- G21137**
- G21138**
- G21139**
- G21140**
- G21142**

Implant Size

- Ø4.5 x 8.5 mm Length
- Ø4.5 x 10 mm Length
- Ø4.5 x 11.5 mm Length
- Ø4.5 x 13 mm Length
- Ø4.5 x 16 mm Length

Cover Screw



Catalog #

- G21101**

Description

Ø4.5 mm

Healing Abutments



Catalog #

- G21107**
- G21108**
- G21109**
- G21110**

Description

- Ø4.5 mm
- Ø4.5 mm
- Ø4.5 mm
- Ø4.5 mm

Flare

- 5.0 mm
- 5.0 mm
- 6.0 mm
- 6.0 mm

Cuff Height

- 3.0 mm
- 5.0 mm
- 3.0 mm
- 5.0 mm

The Ø4.5 mm Genesis can be restored with Ø5.0 and Ø6.0 mm flared prosthetic components. An Abutment Screw is included with all TiLobe® abutments.

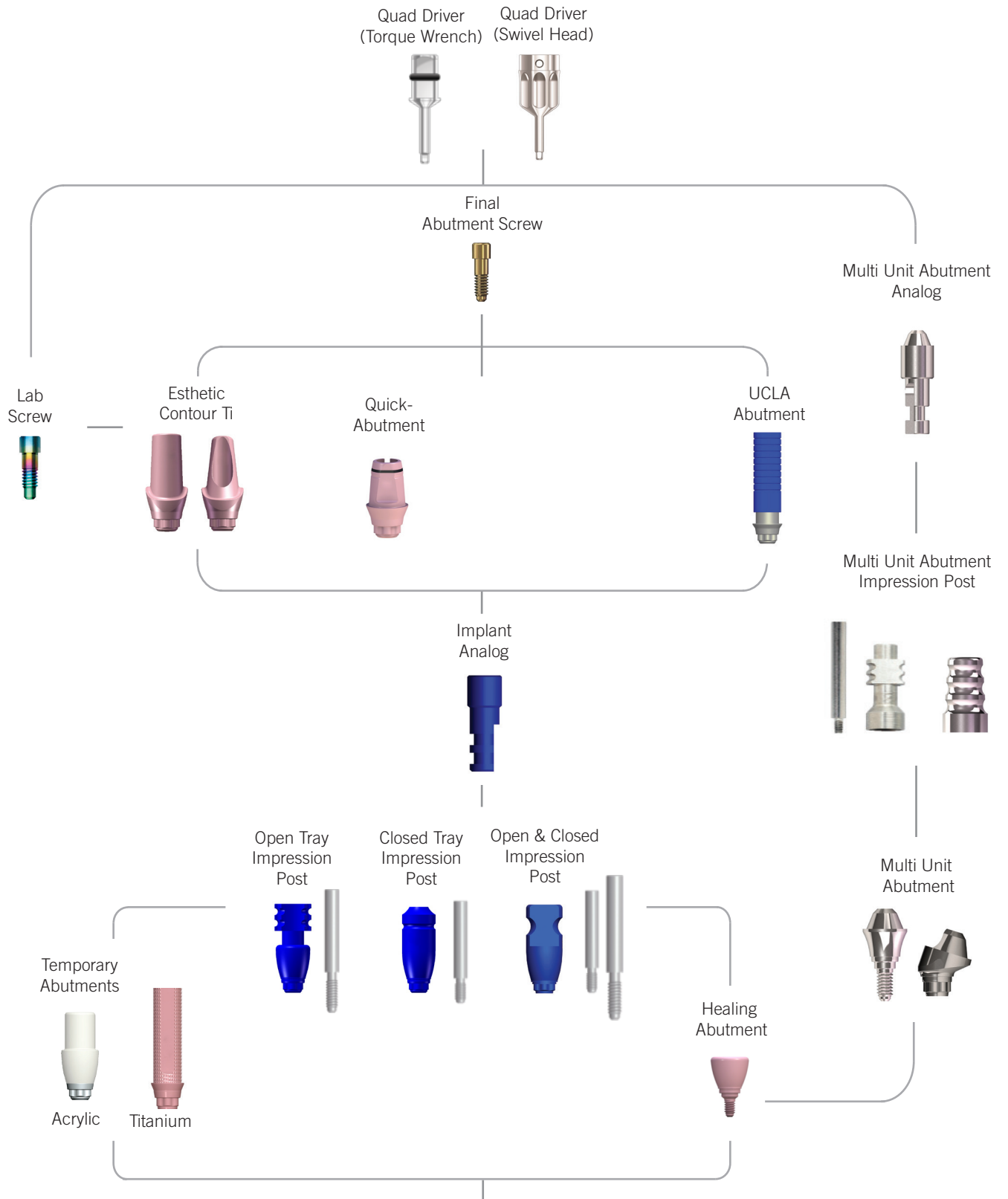

Open & Closed Tray
Impression Post



Catalog #

Description

Flare

G71102

Ø4.5 mm

5.0 mm

G71103

Ø4.5 mm

6.0 mm

Open Tray
Impression Post



Catalog #

Description

Flare

45908K

Ø4.5 mm

5.0 mm

45910K

Ø4.5 mm

6.0 mm

Closed Tray
Impression Post



Catalog #

Description

Flare

45909K

Ø4.5 mm

5.0 mm

45911K

Ø4.5 mm

6.0 mm

Implant Analog



Catalog #

Description

G71109

Ø4.5 mm, 1-Pack

G71110

Ø4.5 mm, 10-Pack

Temporary Abutment



Catalog #

Description

Flare

G71134

Ø4.5 mm, Locking

5.0 mm

G71135

Ø4.5 mm, Non-Locking

5.0 mm

G71136

Ø4.5 mm, Locking

6.0 mm

G71137

Ø4.5 mm, Non-Locking

6.0 mm

Ti Temporary Abutment



Catalog #

Description

G71146

Ø4.5 mm, Locking

G71147

Ø4.5 mm, Non-Locking

Esthetic Contour
Ti Abutment

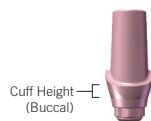

Catalog #

Description

Flare

Cuff Height

G71208

Ø4.5 mm, Straight

5.0 mm

0.5 mm

G71209

Ø4.5 mm, Straight

5.0 mm

1.5 mm

G71210

Ø4.5 mm, 15° Angled

5.0 mm

0.5 mm

G71211

Ø4.5 mm, 15° Angled

5.0 mm

1.5 mm

G71212

Ø4.5 mm, Straight

6.0 mm

1.0 mm

G71213

Ø4.5 mm, Straight

6.0 mm

3.0 mm

G71214

Ø4.5 mm, 15° Angled

6.0 mm

1.0 mm

G71215

Ø4.5 mm, 15° Angled

6.0 mm

3.0 mm

UCLA Abutment



Catalog #

Description

Cuff Height

G71233

Gold/Plastic Sleeve, Locking

1.0 mm

G71234

Gold/Plastic Sleeve, Non-Locking

1.0 mm

**Replacement
Final Abutment Screw**



Catalog # *Description*

G71125 1-Pack

Laboratory Screw



Catalog # *Description*

G71127 10-Pack

Quick-Packs



Catalog # *Description* *Flare* *Cuff Height*

G71404	Ø4.5 mm	5.0 mm	0.5 mm
G71405	Ø4.5 mm	5.0 mm	1.5 mm
G71406	Ø4.5 mm	5.0 mm	2.5 mm
G71407	Ø4.5 mm	5.0 mm	4.0 mm
G71408	Ø4.5 mm	6.0 mm	0.5 mm
G71409	Ø4.5 mm	6.0 mm	1.5 mm
G71410	Ø4.5 mm	6.0 mm	2.5 mm
G71411	Ø4.5 mm	6.0 mm	4.0 mm

Quick-Abutment

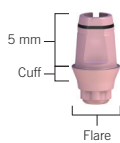

Catalog # *Description* *Flare* *Cuff Height*

G71438	Ø4.5 mm	5.0 mm	0.5 mm
G71439	Ø4.5 mm	5.0 mm	1.5 mm
G71440	Ø4.5 mm	5.0 mm	2.5 mm
G71441	Ø4.5 mm	5.0 mm	4.0 mm
G71442	Ø4.5 mm	6.0 mm	0.5 mm
G71443	Ø4.5 mm	6.0 mm	1.5 mm
G71444	Ø4.5 mm	6.0 mm	2.5 mm
G71445	Ø4.5 mm	6.0 mm	4.0 mm

**Quick-Abutment
Quick-Cap®**



Catalog # *Description* *Flare*

G71429	Ø4.5 mm, 1-Pack	5.0 mm
G71430	Ø4.5 mm, 1-Pack	6.0 mm

**Quick-Abutment
Temporary/Healing Cap**



Catalog # *Description* *Flare*

G71463	Ø4.5 mm	5.0 mm
G71464	Ø4.5 mm	6.0 mm

**Quick-Abutment
Analog**



Catalog # *Description* *Flare*

G71469	Ø4.5 mm	5.0 mm
G71470	Ø4.5 mm	6.0 mm

Quick-Abutment Plastic Sleeve



<i>Catalog #</i>	<i>Description</i>	<i>Flare</i>
G71480	Ø4.5 mm, Locking	5.0 mm
G71481	Ø4.5 mm, Non-Locking	5.0 mm
G71482	Ø4.5 mm, Locking	6.0 mm
G71483	Ø4.5 mm, Non-Locking	6.0 mm

Quick-Abutment Ceramic Coping



<i>Catalog #</i>	<i>Description</i>	<i>Flare</i>
G71476	Ø4.5 mm	5.0 mm

Multi Unit Abutment

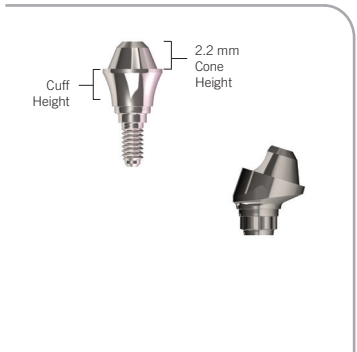

<i>Catalog #</i>	<i>Description</i>	<i>Cuff Height</i>
45315K	Ø4.5 mm, Straight	1.0 mm
45316K	Ø4.5 mm, Straight	2.0 mm
45317K	Ø4.5 mm, Straight	3.0 mm
45318K	Ø4.5 mm, Straight	4.0 mm
45323K	Ø4.5 mm, Angled, 17°	3.0 mm
45324K	Ø4.5 mm, Angled, 17°	4.0 mm
45965K	Ø4.5 mm, Angled, 30°	3.0 mm
45325K	Ø4.5 mm, Angled, 30°	4.0 mm
45326K	Ø4.5 mm, Angled, 30°	5.0 mm

Multi Unit Abutment Healing Cap



<i>Catalog #</i>	<i>Description</i>
45330K	Ø4.5 mm

Multi Unit Abutment Impression Post



<i>Catalog #</i>	<i>Description</i>
45327K	Open Tray, Ø4.5 mm with screw
45328K	Closed Tray, Ø4.5 mm

Multi Unit Abutment Analog



<i>Catalog #</i>	<i>Description</i>
45329K	Ø4.5 mm

**Multi Unit Abutment
Ti Temporary Sleeve**

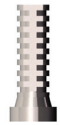

<i>Catalog #</i>	<i>Description</i>
45331K	Ø4.5 mm

**Multi Unit Abutment
Plastic Sleeve**



<i>Catalog #</i>	<i>Description</i>
45332K	Ø4.5 mm

**Multi Unit Abutment
Prosthetic Screw**



<i>Catalog #</i>	<i>Description</i>
45333K	1-Pack

**Angled Multi-Unit Abutment
Replacement Screw**



<i>Catalog #</i>	<i>Description</i>
45334K	1-Pack



Genesis Implants

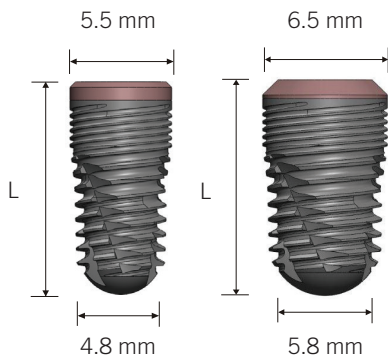

Catalog #

Implant Size

- G21144** Ø5.5 x 8.5 mm Length
- G21145** Ø5.5 x 10 mm Length
- G21146** Ø5.5 x 11.5 mm Length
- G21147** Ø5.5 x 13 mm Length

Catalog #

Implant Size

- G21150** Ø6.5 x 8.5 mm Length
- G21151** Ø6.5 x 10 mm Length
- G21152** Ø6.5 x 11.5 mm Length
- G21153** Ø6.5 x 13 mm Length

Cover Screw

Catalog #

Description

- G21102** Ø5.5/6.5 mm



Healing Abutments

Catalog #

Description

Flare

Cuff Height

- | | | | |
|---------------|-------------|--------|--------|
| G21111 | Ø5.5 mm | 5.0 mm | 3.0 mm |
| G21112 | Ø5.5 mm | 5.0 mm | 5.0 mm |
| G21113 | Ø5.5/6.5 mm | 6.0 mm | 3.0 mm |
| G21114 | Ø5.5/6.5 mm | 6.0 mm | 5.0 mm |
| G21296 | Ø5.5/6.5 mm | 7.0 mm | 3.0 mm |
| G21297 | Ø5.5/6.5 mm | 7.0 mm | 5.0 mm |
| G21298 | Ø5.5/6.5 mm | 8.0 mm | 3.0 mm |
| G21299 | Ø5.5/6.5 mm | 8.0 mm | 5.0 mm |



The Ø5.5 and Ø6.5 mm Genesis can be restored with Ø5.0 and Ø6.0 mm flared prosthetic components. An Abutment Screw is included with all TiLobe® abutments.

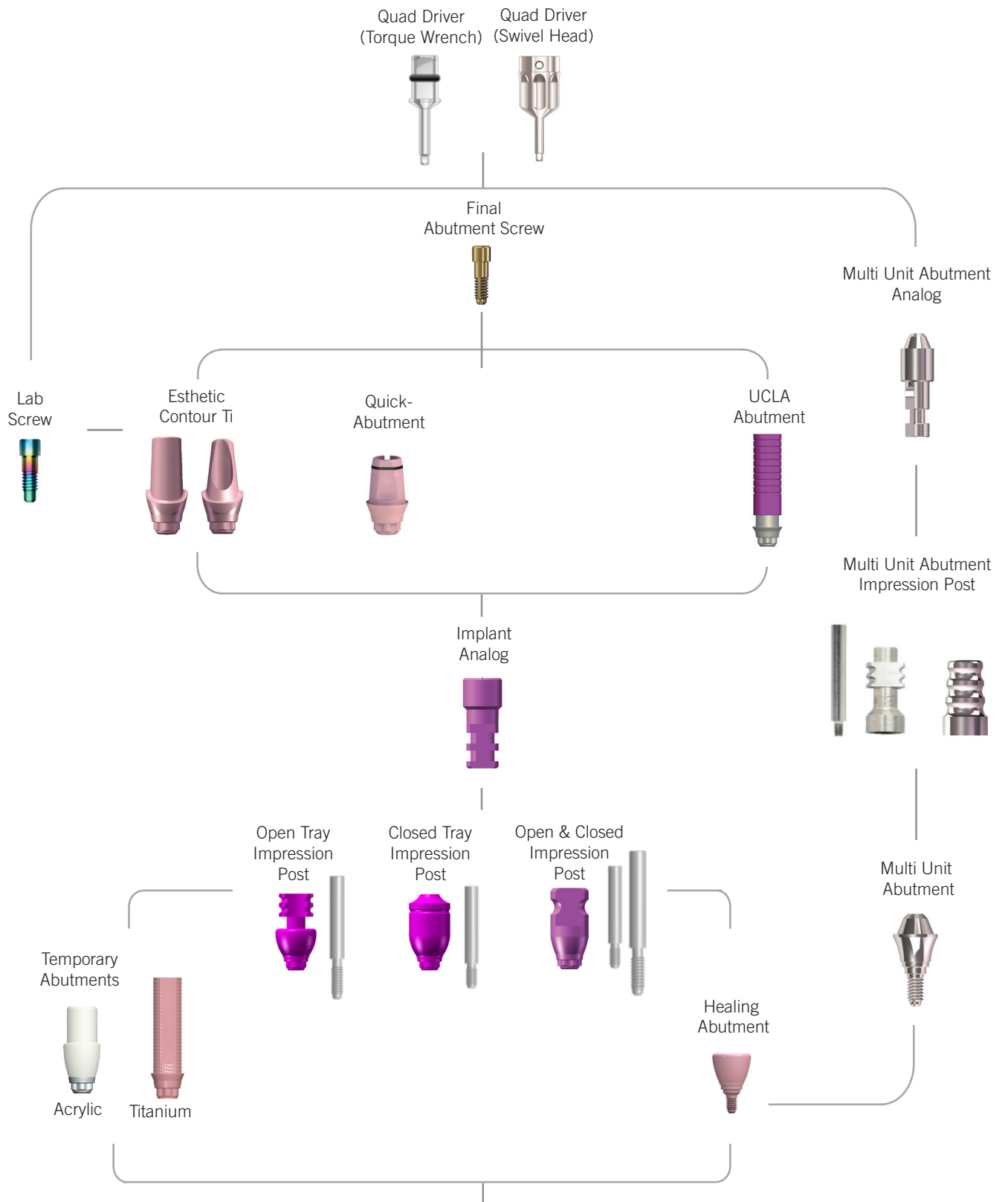



Prosthetic Components

Internal TiLobe®

Open & Closed Impression Post



Catalog #	Description	Flare
G71104	Ø5.5 mm	5.0 mm
G71105	Ø5.5/6.5 mm	6.0 mm

Impression Post



Catalog #	Description	Flare
45916K	Ø5.5/6.5 mm	7.0 mm
45918K	Ø5.5/6.5 mm	8.0 mm

Impression Post



Catalog #	Description	Flare
45917K	Ø5.5/6.5 mm	7.0 mm
45919K	Ø5.5/6.5 mm	8.0 mm

Implant Analog



Catalog #	Description
G71111	Ø5.5 mm, 1-Pack
G71112	Ø5.5 mm, 10-Pack
G71113	Ø6.5 mm 1-Pack
G71114	Ø6.5 mm 10-Pack

Temporary Abutment



Catalog #	Description	Flare
G71138	Ø5.5 mm, Locking	5.0 mm
G71139	Ø5.5 mm, Non-Locking	5.0 mm
G71140	Ø5.5/6.5 mm, Locking	6.0 mm
G71141	Ø5.5/6.5 mm, Non-Locking	6.0 mm

Ti Temporary Abutment



Catalog #	Description
G71148	Ø5.5/6.5 mm, Locking
G71149	Ø5.5/6.5 mm, Non-Locking

Esthetic Contour Ti Abutment

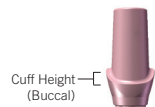

Catalog #	Description	Flare	Cuff Height
G71216	Ø5.5 mm, Straight	5.0 mm	0.5 mm
G71217	Ø5.5 mm, Straight	5.0 mm	1.5 mm
G71218	Ø5.5 mm, 15° Angled	5.0 mm	0.5 mm
G71219	Ø5.5 mm, 15° Angled	5.0 mm	1.5 mm
G71220	Ø5.5/6.5 mm, Straight	6.0 mm	1.0 mm
G71221	Ø5.5/6.5 mm, Straight	6.0 mm	3.0 mm
G71222	Ø5.5/6.5 mm, 15° Angled	6.0 mm	1.0 mm

UCLA Abutment



Catalog #	Description	Cuff Height
G71235	Gold/Plastic Sleeve, Locking	1.0 mm
G71236	Gold/Plastic Sleeve, Non-Locking	1.0 mm

Replacement
Final Abutment Screw



Catalog #	Description
G71125	1-Pack

Laboratory Screw



Catalog #	Description
G71127	10-Pack

Quick-Packs



Catalog #	Description	Flare	Cuff Height
G71412	Ø5.5 mm	5.0 mm	0.5 mm
G71413	Ø5.5 mm	5.0 mm	1.5 mm
G71414	Ø5.5 mm	5.0 mm	2.5 mm
G71415	Ø5.5 mm	5.0 mm	4.0 mm
G71416	Ø5.5/6.5 mm	6.0 mm	0.5 mm
G71417	Ø5.5/6.5 mm	6.0 mm	1.5 mm
G71418	Ø5.5/6.5 mm	6.0 mm	2.5 mm
G71419	Ø5.5/6.5 mm	6.0 mm	4.0 mm

Quick-Abutment

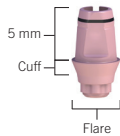

Catalog #	Description	Flare	Cuff Height
G71446	Ø5.5 mm	5.0 mm	0.5 mm
G71447	Ø5.5 mm	5.0 mm	1.5 mm
G71448	Ø5.5 mm	5.0 mm	2.5 mm
G71449	Ø5.5 mm	5.0 mm	4.0 mm
G71450	Ø5.5/6.5 mm	6.0 mm	0.5 mm
G71451	Ø5.5/6.5 mm	6.0 mm	1.5 mm
G71452	Ø5.5/6.5 mm	6.0 mm	2.5 mm
G71453	Ø5.5/6.5 mm	6.0 mm	4.0 mm

Quick-Abutment
Quick-Cap®



Catalog #	Description	Flare
G71431	Ø5.5 mm, 1-Pack	5.0 mm
G71432	Ø5.5/6.5 mm, 1-Pack	6.0 mm

Quick-Abutment
Temporary/Healing Cap



Catalog #	Description	Flare
G71465	Ø5.5 mm	5.0 mm
G71466	Ø5.5/6.5 mm	6.0 mm

Quick-Abutment Analog



Catalog #	Description	Flare
G71471	Ø5.5 mm	5.0 mm
G71472	Ø5.5/6.5 mm	6.0 mm



Prosthetic Components

Internal TiLobe®

Quick-Abutment Plastic Sleeve



<i>Catalog #</i>	<i>Description</i>	<i>Flare</i>
G71484	Ø5.5 mm, Locking	5.0 mm
G71485	Ø5.5 mm, Non-Locking	5.0 mm
G71486	Ø5.5/6.5 mm, Locking	6.0 mm
G71488	Ø5.5/6.5 mm, Non-Locking	6.0 mm
45939K	Ø5.5/6.5 mm, Straight	3.0 mm
45940K	Ø5.5/6.5 mm, Straight	4.0 mm
45941K	Ø5.5/6.5 mm, Angled, 17°	3.0 mm
45942K	Ø5.5/6.5 mm, Angled, 17°	4.0 mm
45966K	Ø5.5/6.5 mm, Angled, 30°	3.0 mm
45967K	Ø5.5/6.5 mm, Angled, 30°	4.0 mm

Quick-Abutment Ceramic Coping



<i>Catalog #</i>	<i>Description</i>	<i>Flare</i>
G71477	Ø5.5 mm	6.0 mm

Multi Unit Abutment

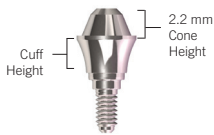

<i>Catalog #</i>	<i>Description</i>	<i>Cuff Height</i>
45319K	Ø5.5/6.5 mm, Straight	1.0 mm
45320K	Ø5.5/6.5 mm, Straight	2.0 mm
45939K	Ø5.5/6.5 mm, Straight	3.0 mm
45940K	Ø5.5/6.5 mm, Straight	4.0 mm
45941K	Ø5.5/6.5 mm, Angled, 17°	3.0 mm
45942K	Ø5.5/6.5 mm, Angled, 17°	4.0 mm
45966K	Ø5.5/6.5 mm, Angled, 30°	3.0 mm
45967K	Ø5.5/6.5 mm, Angled, 30°	4.0 mm

Multi Unit Abutment Healing Cap



<i>Catalog #</i>	<i>Description</i>
45330K	Ø5.5/6.5 mm

**Multi Unit Abutment
Impression Post**



Catalog #

Description

45327K
45328K

Open Tray, Ø5.5/6.5 mm with screw
Closed Tray, Ø5.5/6.5 mm

**Multi Unit Abutment
Analog**

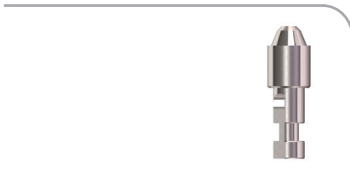

Catalog #

Description

45329K

Ø5.5/6.5 mm

**Multi Unit Abutment
Ti Temporary Sleeve**



Catalog #

Description

45331K

Ø5.5/6.5 mm

**Multi Unit Abutment
Plastic Sleeve**



Catalog #

Description

45332K

Ø5.0/5.5/6.5 mm

**Multi Unit Abutment
Prosthetic Screw**



Catalog #

Description

45333K

1-Pack

**Angled Multi-Unit Abutment
Replacement Screw**



Catalog #

Description

45334K

1-Pack

Digital



Angled Abutment Drivers
(Latch Type) (Torque Wrench)

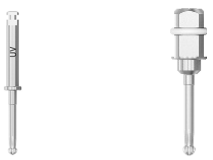

Angulated Screw



Ti-Base



Angulated Screw Channel

Quad Driver (Torque Wrench) Quad Driver (Swivel Head)

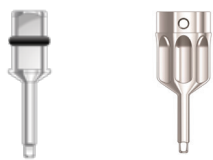

Final Abutment Screw



Ti-Base



Locking



Non-Locking

Ti-Blanks



Digital Scanbodies



Digital Analog



Download Digital Libraries from Imagine



Temporary Abutments



Acrylic



Titanium



Healing Abutment



Ø4.1 Shown





Digital Components

Internal TiLobe®

Digital Scanbodies



Catalog #

Description

IM-SBKEP35

Mist IC Scanbody 3.5

IM-SBKEP41

Mist IC Scanbody 4.1

IM-SBKEP50

Mist IC Scanbody 5.0

Digital Analog



Catalog #

Description

IM-3DKEP35

Mist IC 3D Analog 3.5

IM-3DKEP41

Mist IC 3D Analog 4.1

IM-3DKEP50

Mist IC 3D Analog 5.0

Tibase (Locking)



Catalog #

Description

IM-LLKEP35

Mist IC L-Link Single 3.5

IM-LLKEP41

Mist IC L-Link Single 4.1

IM-LLKEP50

Mist IC L-Link Single 5.0

Tibase (Non-Locking)



Catalog #

Description

IM-3DKEP35

Mist IC 3D Analog 3.5

IM-3DKEP41

Mist IC 3D Analog 4.1

IM-3DKEP50

Mist IC 3D Analog 5.0

Tibase Angulated Screw Channel



Catalog #

Description

IM-SLKEP35

Mist IC S-Link 3.5

IM-SLKEP41

Mist IC S-Link 4.1

IM-SLKEP50

Mist IC S-Link 5.0



Ti Blanks 10



Catalog #	Description
IM-PF10KEP35	Mist IC PreFit10, 3.5
IM-PF10KEP41	Mist IC PreFit10, 4.1
IM-PF10KEP50	Mist IC PreFit10, 5.0

Ti Blanks 14



Catalog #	Description
IM-PF14KEP35	Mist IC PreFit14, 3.5
IM-PF14KEP41	Mist IC PreFit14, 4.1
IM-PF14KEP50	Mist IC PreFit14, 5.0

Final Abutment Screws

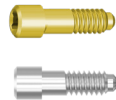

Catalog #	Description
IM-SCKEP	Mist IC Screw (Pack of 5)
IM-SCKEP UV	Mist IC Angulated Screw (Pack of 5)

Angled Abutment Drivers

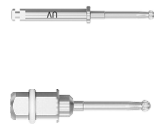

Catalog #	Description
IM-ALDUVR	Mist IC Angled Latch Driver Reg (13mm)
IM-ALDUVL	Mist IC Angled Latch Driver Long (20mm)
IM-ASDUVR	Mist IC Angled Square Driver Reg (13mm)
IM-ASDUVL	Mist IC Angled Square Driver Long (20mm)

Quad Drivers



Catalog #	Description
15272K	Swivel Head, Short
15273K	Swivel Head, Long
45293K	Swivel Head, X-Long (35 mm)
15274K	Latch Type, Short
15275K	Latch Type, Long
45294K	Latch Type, X-Long (35 mm)
15276K	Torque Wrench, Short
15277K	Torque Wrench, Long



Digital Components

Internal TiLobe®

Quad Driver (Torque Wrench) Quad Driver (Swivel Head)

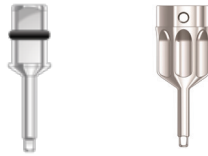

Final Abutment Screw



Ti-Base



Pink (Short)



Pink (Long)



(Short)



(Long)

Ti-Blanks



Available only through Core3dcentres®

Scan Abutment



Digital Analog



Download Digital Libraries from Core3dcentres®



Temporary Abutments



Acrylic



Titanium



Milling Services

Healing Abutment



Ø4.1 Shown





Scan Abutment



Catalog #

Description

- CORE3D-4805** Scan Abutment Genesis \varnothing 3.5
- CORE3D-4806** Scan Abutment Genesis \varnothing 3.8
- CORE3D-4807** Scan Abutment Genesis \varnothing 4.5
- CORE3D-4808** Scan Abutment Genesis \varnothing 5.5
- CORE3D-4809** Scan Abutment Genesis \varnothing 6.5

Digital Analog



Catalog #

Description

- CORE3D-3559** Digital Analog PrimaConnex® \varnothing 3.5
- CORE3D-3560** Digital Analog PrimaConnex® \varnothing 4.1
- CORE3D-3561** Digital Analog PrimaConnex® \varnothing 5.0

Ti Base (Short)



Catalog #

Description

- 45806K** Ti Base Insert \varnothing 3.5, Short
- 45807K** Ti Base Insert \varnothing 4.1, Short
- 45808K** Ti Base Insert \varnothing 5.0, Short

Ti Base (Long)



Catalog #

Description

- 45901K** Ti Base Insert \varnothing 3.5, Long
- 45902K** Ti Base Insert \varnothing 4.1, Long
- 45903K** Ti Base Insert \varnothing 5.0, Long

Ti Base Pink (Short)



Catalog #

Description

- 45809K** Ti Base Insert \varnothing 3.5, Short
- 45810K** Ti Base Insert \varnothing 4.1, Short
- 45811K** Ti Base Insert \varnothing 5.0, Short

Ti Base Pink (Long)

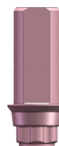

Catalog #

Description

- 45812K** Ti Base Insert \varnothing 3.5, Long
- 45813K** Ti Base Insert \varnothing 4.1, Long
- 45814K** Ti Base Insert \varnothing 5.0, Long

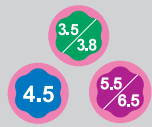

In-Office Milling

Internal TiLobe®

Quad Driver (Torque Wrench) Quad Driver (Swivel Head)

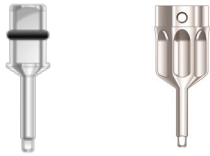

Final Abutment Screw



Esthetic Contour Ti-Base Abutment



Esthetic Contour Ti Digital Impression Post



Healing Abutment



Ø4.1 Shown

Esthetic Contour Ti Digital Impression Post



Catalog #

Description

45933K

Esthetic Contour Ti Digital Impression Post ø3.5

45934K

Esthetic Contour Ti Digital Impression Post ø4.1

45935K

Esthetic Contour Ti Digital Impression Post ø5.0

Esthetic Contour Ti-Base Abutment



Catalog #

Description

45930K

Esthetic Contour Ti-Base Abutment ø3.5

45931K

Esthetic Contour Ti-Base Abutment ø4.1

45932K

Esthetic Contour Ti-Base Abutment ø5.0

LOCATOR[®] Abutments



LOCATOR® Abutments

Prosthetic Options

LOCATOR®
Core Tool



Retention
Insert Tool



LOCATOR®
Analog



Abutment
Analog



Impression
Coping



Impression
Coping



LOCATOR®
Abutment



LOCATOR
R-Tx™
Abutment

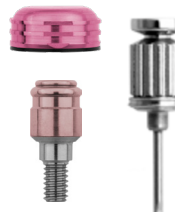

LOCATOR® Abutment Assembly



<i>Catalog #</i>	<i>Description</i>	<i>Cuff Height</i>
45062K	Ø3.5 mm	1.0 mm
45258K	Ø3.5 mm	2.0 mm
45259K	Ø3.5 mm	3.0 mm
45260K	Ø3.5 mm	4.0 mm
45063K	Ø3.5 mm	5.0 mm
45064K	Ø3.5 mm	6.0 mm
45065K	Ø4.1 mm	1.0 mm
45261K	Ø4.1 mm	2.0 mm
45262K	Ø4.1 mm	3.0 mm
45263K	Ø4.1 mm	4.0 mm
45066K	Ø4.1 mm	5.0 mm
45067K	Ø4.1 mm	6.0 mm
45068K	Ø5.0 mm	1.0 mm
45264K	Ø5.0 mm	2.0 mm
45265K	Ø5.0 mm	3.0 mm
45069K	Ø5.0 mm	4.0 mm
45070K	Ø5.0 mm	5.0 mm
45071K	Ø5.0 mm	6.0 mm

LOCATOR® Abutment Accessories



<i>Catalog #</i>	<i>Description</i>
L8519-2	Denture Cap with Black Processing Male, 2-Pack Clear, Pink, Blue Retention, Block out spacers
45266K	LOCATOR® Replacement Male, Clear, Standard Retention, 4-Pack
45267K	LOCATOR® Replacement Male, Pink, Light Retention, 4-Pack
45268K	LOCATOR® Replacement Male, Blue, (ELR) Extra Light Retention, 4-Pack
45269K	LOCATOR® Replacement Male, Green, (ER) Extended Range, 4-Pack
45270K	LOCATOR® Female Analog, 4-Pack
45271K	LOCATOR® Impression Coping, 4-Pack
45273K	LOCATOR® Core Tool
45274K	LOCATOR® Torque Wrench Driver



LOCATOR® R-Tx™ Abutment

Prosthetic Options

LOCATOR R-Tx™ Abutment



Catalog

LOCR-TX 31200-01
LOCR-TX 31200-02
LOCR-TX 31200-03
LOCR-TX 31200-04
LOCR-TX 31200-05
LOCR-TX 31200-06

Description

Ø3.5 mm
 Ø3.5 mm
 Ø3.5 mm
 Ø3.5 mm
 Ø3.5 mm
 Ø3.5 mm

Cuff Height

1.0 mm
 2.0 mm
 3.0 mm
 4.0 mm
 5.0 mm
 6.0 mm

LOCR-TX 31201-01
LOCR-TX 31201-02
LOCR-TX 31201-03
LOCR-TX 31201-04
LOCR-TX 31201-05
LOCR-TX 31201-06

Ø4.1 mm
 Ø4.1 mm
 Ø4.1 mm
 Ø4.1 mm
 Ø4.1 mm
 Ø4.1 mm

1.0 mm
 2.0 mm
 3.0 mm
 4.0 mm
 5.0 mm
 6.0 mm

LOCR-TX 31202-01
LOCR-TX 31202-02
LOCR-TX 31202-03
LOCR-TX 31202-04
LOCR-TX 31202-05
LOCR-TX 31202-06

Ø5.0 mm
 Ø5.0 mm
 Ø5.0 mm
 Ø5.0 mm
 Ø5.0 mm
 Ø5.0 mm

1.0 mm
 2.0 mm
 3.0 mm
 4.0 mm
 5.0 mm
 6.0 mm

LOCATOR R-Tx™ Abutment Accessories



Catalog

LOCR-TX 30013-01
LOCR-TX 30001-01
LOCR-TX 30002-01
LOCR-TX 30003-01
LOCR-TX 30004-01
LOCR-TX 30014-01
LOCR-TX 30015-01
LOCR-TX 30016-01
LOCR-TX 30017-01
LOCR-TX 30021-01
LOCR-TX 04936
LOCR-TX 08007
LOCR-TX 08008
LOCR-TX 30012-01
LOCR-TX 30018-01

Description

Denture Attachment Processing Assembly, 4-Pack
 Zero Retention Insert, 4-Pack
 Low Retention Insert, 4-Pack
 Medium Retention Insert, 4-Pack
 High Retention Insert, 4-Pack
 3.35 mm Abutment Analog, 4-Pack
 4.0 mm Abutment Analog, 4-Pack
 5.0 mm Abutment Analog, 4-Pack
 Impression Coping, 4-Pack
 Retention Insert Tool
 .050"/1.25 mm Hex, Torque Wrench
 .050"/1.25 mm Hex Driver with Thumb Knob
 .050"/1.25 mm Hex, Latch Lock Driver
 Processing Insert, 4-Pack
 Processing Spacer, 4-Pack



**LOCATOR F-Tx®
Abutment**



<i>Catalog #</i>	<i>Description</i>	<i>Cuff Height</i>
LOCF-TX 11200-01	Ø3.5 mm	1.0 mm
LOCF-TX 11200-02	Ø3.5 mm	2.0 mm
LOCF-TX 11200-03	Ø3.5 mm	3.0 mm
LOCF-TX 11200-04	Ø3.5 mm	4.0 mm
LOCF-TX 11200-05	Ø3.5 mm	5.0 mm
LOCF-TX 11201-01	Ø4.1 mm	1.0 mm
LOCF-TX 11201-02	Ø4.1 mm	2.0 mm
LOCF-TX 11201-03	Ø4.1 mm	3.0 mm
LOCF-TX 11201-04	Ø4.1 mm	4.0 mm
LOCF-TX 11201-05	Ø4.1 mm	5.0 mm
LOCF-TX 11202-01	Ø5.0 mm	1.0 mm
LOCF-TX 11202-02	Ø5.0 mm	2.0 mm
LOCF-TX 11202-03	Ø5.0 mm	3.0 mm
LOCF-TX 11202-04	Ø5.0 mm	4.0 mm
LOCF-TX 11202-05	Ø5.0 mm	5.0 mm

**LOCATOR F-Tx™
Abutment Accessories**



<i>Catalog #</i>	<i>Description</i>
LOCF-TX 10028-01	Manual Driver
LOCF-TX 10029-01	Latch Driver
LOCF-TX 10030-01	Processing Cap, 2Pk
LOCF-TX 10032-01	Processing Ball, 2Pk
LOCF-TX 10033-01	Low Retention Ball, 2Pk
LOCF-TX 10034-01	Medium Retention Ball, 2Pk
LOCF-TX 10035-01	High Retention Ball, 2 Pk
LOCF-TX 10036-01	Healing Cap, 2Pk
LOCF-TX 10037-01	Abutment Analog, 2Pk
LOCF-TX 10039-01	Polishing Cap, 2Pk
LOCF-TX 10040-01	Waxing Cap, 2Pk
LOCF-TX 10041-01	Denture Attachment Housing, 2Pk
LOCF-TX 10042-01	Retention Ball Hex Driver
LOCF-TX 10043-01	Impression Coping, 2Pk
LOCF-TX 10094	Tip Wrench
LOCF-TX 10095	Seating Tip
LOCF-TX 10096	Removal Tip with Threaded Adapter
LOCF-TX 10097	Replacement Wire
LOCF-TX 10098	Threaded Adapter
LOCF-TX 10099	Wire and Lever Wrench
LOCF-TX 100100	Seating and Removal Tool

Surgical Kit & Instruments

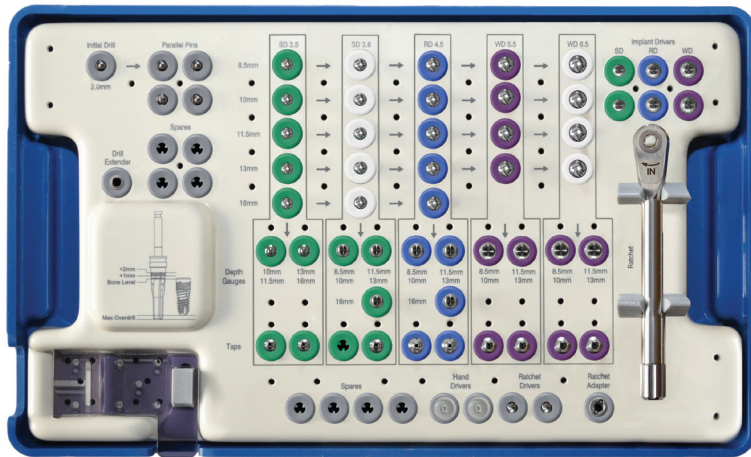
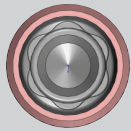

Catalog #	Surgical Options
G31000	Surgical Cassette (empty)
G31001	A. Genesis Surgical Kit for Ø3.5-Ø4.5 mm
G31002	B. Genesis Drill Pack for Ø5.5/Ø6.5 mm

Catalog #	Description	Catalog #	Description
G31001	A. Genesis Surgical Kit for Ø3.5-Ø4.5 mm <i>Includes:</i>	G31036	Implant Depth Gauge 4.5 x 8.5-10 mm
G31000	Surgical Cassette	G31037	Implant Depth Gauge 4.5 x 11.5-13 mm
G21244	2.0 mm Full Depth Twist Drill	G31038	Implant Depth Gauge 4.5 x 16 mm
G21211	Parallel Pin 4-Pack	G21290	3.5/3.8 Implant Driver, Latch, Short
G31008	Final Tapered Drill 3.5 x 8.5 mm	G21291	3.5/3.8 Implant Driver, Latch, Long
G31009	Final Tapered Drill 3.5 x 10 mm	G21292	4.5 Implant Driver, Latch, Short
G31010	Final Tapered Drill 3.5 x 11.5 mm	G21293	4.5 Implant Driver, Latch, Long
G31011	Final Tapered Drill 3.5 x 13 mm	G21274	3.5/3.8 Implant Driver, Ratchet
G31012	Final Tapered Drill 3.5 x 16 mm	G21275	4.5 Implant Driver, Ratchet
G31013	Final Tapered Drill 3.8 x 8.5 mm	K15695	Surgical Ratchet/Torque Wrench
G31014	Final Tapered Drill 3.8 x 10 mm	15224K	Ratchet Adapter
G31015	Final Tapered Drill 3.8 x 11.5 mm	G71612	Quad Driver, Torque Wrench, Short
G31016	Final Tapered Drill 3.8 x 13 mm	G71613	Quad Driver, Torque Wrench, Long
G31017	Final Tapered Drill 3.8 x 16 mm	G71608	Quad Driver, Swivel Head, Short
G31018	Final Tapered Drill 4.5 x 8.5 mm	G71609	Quad Driver, Swivel Head, Long
G31019	Final Tapered Drill 4.5 x 10 mm	G21204	Drill Extender
G31020	Final Tapered Drill 4.5 x 11.5 mm	G21277	Conversion Handle, Latch Type
G31021	Final Tapered Drill 4.5 x 13 mm	G21278	Conversion Handle, Square Type
G31022	Final Tapered Drill 4.5 x 16 mm	100001-EN01	Surgical Manual
G31031	Implant Depth Gauge 3.5 x 10-11.5 mm	100009-EN01	Drill Usage Chart
G31032	Implant Depth Gauge 3.5 x 13-16 mm	100005-EN01	Wall Chart
G31033	Implant Depth Gauge 3.8 x 8.5-10 mm	100027-EN01	Implant Driver, Latch IFU
G31034	Implant Depth Gauge 3.8 x 11.5 -13 mm	MK40091	Genesis Folder
G31035	Implant Depth Gauge 3.8 x 16 mm		

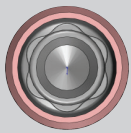

<i>Catalog #</i>	<i>Description</i>
G31002	B. Genesis Drill Pack for Ø5.5/6.5 mm <i>Includes:</i>
G31023	Final Tapered Drill 5.5 x 8.5 mm
G31024	Final Tapered Drill 5.5 x 10 mm
G31025	Final Tapered Drill 5.5 x 11.5 mm
G31026	Final Tapered Drill 5.5 x 13 mm
G31027	Final Tapered Drill 6.5 x 8.5 mm
G31028	Final Tapered Drill 6.5 x 10 mm
G31029	Final Tapered Drill 6.5 x 11.5 mm
G31030	Final Tapered Drill 6.5 x 13 mm
G31039	Implant Depth Gauge 5.5 x 8.5-10 mm
G31040	Implant Depth Gauge 5.5 x 11.5-13 mm
G31041	Implant Depth Gauge 6.5 x 8.5-10 mm
G31042	Implant Depth Gauge 6.5 x 11.5-13 mm
G21294	5.5/6.5 Implant Driver, Latch, Short
G21295	5.5/6.5 Implant Driver, Latch, Long
G21276	5.5/6.5 Implant Driver, Ratchet
100027-EN01	Implant Driver, Latch IFU

Initial Drill

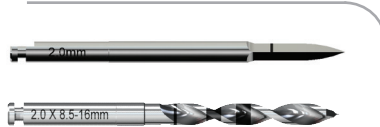

<i>Catalog #</i>	<i>Description</i>
G21243	Spade Drill
G21244	2.0 mm Full Depth Twist Drill

Final Tapered Drills

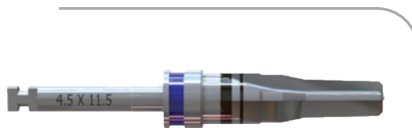

<i>Catalog #</i>	<i>Description</i>
G31008	Ø3.5 x 8.5 mm
G31009	Ø3.5 x 10 mm
G31010	Ø3.5 x 11.5 mm
G31011	Ø3.5 x 13 mm
G31012	Ø3.5 x 16 mm
G31013	Ø3.8 x 8.5 mm
G31014	Ø3.8 x 10 mm
G31015	Ø3.8 x 11.5 mm
G31016	Ø3.8 x 13 mm
G31017	Ø3.8 x 16 mm
G31018	Ø4.5 x 8.5 mm
G31019	Ø4.5 x 10 mm
G31020	Ø4.5 x 11.5 mm
G31021	Ø4.5 x 13 mm
G31022	Ø4.5 x 16 mm
G31023	Ø5.5 x 8.5 mm
G31024	Ø5.5 x 10 mm
G31025	Ø5.5 x 11.5 mm
G31026	Ø5.5 x 13 mm

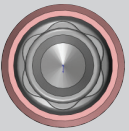

Final Tapered Drills (cont.)



Catalog #

- G31027**
- G31028**
- G31029**
- G31030**

Description

- Ø6.5 x 8.5 mm
- Ø6.5 x 10 mm
- Ø6.5 x 11.5 mm
- Ø6.5 x 13 mm

Depth Gauges



Catalog #

- G31031**
- G31032**
- G31033**
- G31034**
- G31035**
- G31036**
- G31037**
- G31038**
- G31039**
- G31040**
- G31041**
- G31042**

Description

- Ø3.5 x 10-11.5 mm
- Ø3.5 x 13-16 mm
- Ø3.8 x 8.5-10 mm
- Ø3.8 x 11.5-13 mm
- Ø3.8 x 16 mm
- Ø4.5 x 8.5-10 mm
- Ø4.5 x 11.5-13 mm
- Ø4.5 x 16 mm
- Ø5.5 x 8.5-10 mm
- Ø5.5 x 11.5-13 mm
- Ø6.5 x 8.5-10 mm
- Ø6.5 x 11.5-13 mm

Surgical Taps



Catalog #

- G31045**
- G31046**
- G21008**
- G21009**
- G21010**
- G21011**
- G21012**
- G21013**
- G21014**

Description

- Ø3.5 x 10-11.5 mm
- Ø3.5 x 13-15 mm
- Ø3.8 x 11.5-16 mm
- Ø4.5 x 10-13 mm
- Ø4.5 x 16 mm
- Ø5.5 x 8.5 mm
- Ø5.5 x 10-13 mm
- Ø6.5 x 8.5 mm
- Ø6.5 x 10-13 mm

Parallel Pin



Catalog #

- G21211**

Description

- 4-Pack

Drill Extender



Catalog #

- G21204**

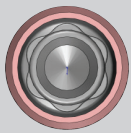

Implant Driver, Latch



Catalog #

Description

G21290
G21291

Ø3.5/3.8 mm, Short
Ø3.5/3.8 mm, Long

G21292
G21293

Ø4.5 mm, Short
Ø4.5 mm, Long

G21294
G21295

Ø5.5/6.5 mm, Short
Ø5.5/6.5 mm, Long

Implant Driver, Ratchet

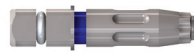

Catalog #

Description

G21274
G21275
15284K

Ø3.5/3.8 mm
Ø4.5 mm
Ø5.5/6.5 mm

**Surgical Ratchet/
Torque Wrench**



Catalog #

Description

K15695

Surgical Ratchet/Torque Wrench

Ratchet Adapter

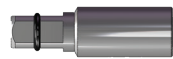

Catalog #

15224K

Conversion Handles

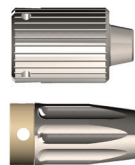

Catalog #

Description

G21277
G21278

Conversion Handle, Latch Type
Conversion Handle, Square Type

Quad Drivers

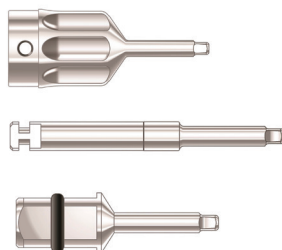

Catalog #

Description

G71608
G71609
45293K

Swivel Head, Short
Swivel Head, Long
Swivel Head, X-Long (35 mm)

G71610
G71611
45294K

Latch Type, Short
Latch Type, Long
Latch Type, X-Long (35 mm)

G71612
G71613

Torque Wrench, Short
Torque Wrench, Long

Surgical Motors & Accessories

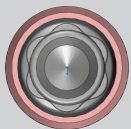

Implantmed Surgical Motors



<i>Catalog #</i>	<i>Description</i>
WH-90000207	SI-1015 Implantmed Base Motor Unit
WH-90000213	SI-1015 Implantmed Motor Unit Fully Loaded
WH-90000208	SI-1015 Implantmed Base Unit with Osstell
WH-90000209	SI-1015 Implantmed Motor Unit, WiFi Footpedal Upgrade
WH-90000210	SI-1015 Implantmed Motor Unit, WiFi Footpedal Upgrade & Osstell
WH-90000211	SI-1015 Implantmed Motor Unit, LED+ Motor Upgrade & Osstell
WH-90000212	SI-1015 Implantmed Motor Unit, LED + Motor Upgrade
WH-90000214	SI-1015 Implantmed Motor Unit Fully Loaded & Osstell

Implantmed Classic Motor



<i>Catalog #</i>	<i>Description</i>
WH-90000270	Implanted Classic + WI-75 E/EM Handpiece non LED
WH-90000271	Implanted Classic + W5-75 LG Handpiece LED

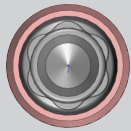

Piezomed Surgical Unit & Accessories



<i>Catalog #</i>	<i>Description</i>
WH-06985000	Piezomed handpiece 1.8m
WH-07004400	Foot Pedal Piezomed
WH-07159200	Piezomed handpiece 3.5m
WH-30078000	Piezomed SA-320 1.8m
WH-30078001	Piezomed SA-320 3.5m
WH-07173200	Instrument Set Special
WH-07997090	Instrument Kit Crestal A
WH-07173500	Instrument Kit EX
WH-07022500	B6 Tip
WH-07022600	B7 Tip

Implantmed Surgical Handpieces



<i>Catalog #</i>	<i>Description</i>
WH-30058000	S-11 1:1 Straight (For Implantmed SI-1015 LC motor only)
WH-30033000	WS-75 L 20:1, Contra-angle (For Implantmed SI-1015 LC motor only)
WH-30065000	WS-75 Contra-Angle 20:1 Dismantlable Handpiece for implant surgery (10-2,000 rpm)
WH-30032000	WS-75 L G Contra-Angle 20:1 Dismantlable Handpiece with Mini LED + for implant surgery (10-2,000 rpm)
WH-90000210	SI-1015 Implantmed Motor Unit, WiFi Footpedal Upgrade
WH-90000211	SI-1015 Implantmed Motor Unit, LED+ Motor Upgrade

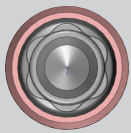

Implantmed Surgical Motor & Accessories*



<i>Catalog #</i>	<i>Description</i>
WH-04363600	Irrigation Tubing and Spike Assembly, 6-Pack, Disposable (for use with Implantmed series & Elcomed SA-310 motors)
WH-00929300	Irrigation Tubing with Luer Lock, Green (10-Pack)
WH-04019000	Irrigation Tubing Clips, 5-Pack (for use with Implantmed SI-310 motors to hold tubing to motor cable)
WH-02610500	Irrigation Needle/Canula (for use with internally irrigated drills)
WH-06016400	Y-Connector Complete
WH-06946300	Irrigation Spray Clip (new series), Right Side, E/KM, Green (3-Pack)
WH-06946400	Irrigation Spray Clip (new series), Light Side, Green (3-Pack)
WH-06946500	Irrigation Spray Clip (new series), Right Side, Green (3-Pack)
WH-04757100	Irrigation Spray Clip (new series), Left Side, E/KM, Black (3-Pack)
WH-05051000	Irrigation Spray Clip (old series), Black (3-Pack)
WH-02139800	Bur testing Gauge (to check all 2.35 mm & 1.6 mm burs)
WH-10940011	W&H F-1 Service Oil, 400ml (Special shipping & handling [aerosol can] Contact Customer Service for shipping rates.)
WH-02038200	Spray Cap for Service Oil (resuable replacement)
WH-04013500	Sterilization Case
WH-30264001	S-NW + SPI WiFi Foot Pedal (for Elcomed SA-310 & Implantmed SI-915 white only)
WH-30264000	S-NW + CAN WiFi Foot Pedal (For Implantmed SI-1015 only)
WH-30210000	Osstell ISQ Module (For Implantmed SI-1015 only)
WH-30185000	EM-19 Motor, 1.8m Cable, without LED + Port (For Implantmed SI-1015 only)
WH-30281000	EM-19 Motor, 1.8m Cable, without LED + Port (For Implantmed SI-1015 only)

May not be available in all markets.

*Products available upon request.

Terms and Conditions

TERMS AND CONDITIONS OF SALE. The following are the terms and conditions by which Keystone Dental, Inc. sells its products. As used herein, the term "Keystone" means Keystone Dental, Inc. and its applicable affiliates; the term "Products" means the Keystone products and services described in this invoice, and "Purchaser" means the person or company purchasing the Products.

GOVERNING TERMS. Any purchase and shipment of Products shall be deemed to be on the terms and conditions stated herein. Any and all terms and conditions submitted by Purchaser are hereby rejected.

TAXES. The prices set forth herein do not include any sales, use, excise, ad valorem, property or other taxes applicable to the sale, use or delivery of the Products, all of which shall be paid by Purchaser separately or added to the contract price and paid by Purchaser to Keystone.

PRICES. The prices set forth for the Products are in United States Dollars. All prices shall be as of the invoice date, regardless of the date the Product is originally ordered from Keystone.

DELIVERY. Products sold hereunder shall be delivered F.O.B. shipping point. Purchaser shall assume responsibility for all subsequent delivery or shipping charges.

ACCEPTANCE. Purchaser must inspect all Products for defects and/or non-conformity within seven (7) calendar days of delivery. After this period, Purchaser will have accepted such Products.

PAYMENT. Payment terms shall be as set forth on the front of the invoice. If payment is late, the maximum statutory interest rate will apply on such late amount. Keystone may, in its sole discretion, suspend shipments of Products until full payment by Purchaser of all past due amounts to Keystone is made.

RETURN; EXCHANGE. Purchaser may return any Product within thirty (30) calendar days of the invoice date so long as there is an offsetting (exchange) order of equal or greater value. Purchaser may return any Product after thirty (30) calendar days from the invoice date, but no later than ninety (90) calendar days after the invoice date, so long as there is an offsetting (exchange) order of equal or greater value, provided, however, such returns shall be subject to a 15% re-stocking fee. Keystone will not accept any returns or exchanges after ninety (90) calendar days following the invoice date.

No biomaterial products (bone grafting and membrane) will be accepted for return or exchange. No returns or exchanges will be accepted for Products that (i) were originally sold as part of a kit, pack or set, (ii) were included on the original invoice at no charge, (iii) have less than six (6) months remaining before expiration or (iv) were custom ordered. The Purchaser shall pay all shipping costs associated with the return or exchange of a Product. No Products will be accepted by Keystone for return or exchange without an RMA number given to Purchaser by Keystone Customer Service. Returned Products must be unexpired, unopened and undamaged, returned freight prepaid.

WARRANTY. EXCEPT AS EXPRESSLY SET FORTH IN KEYSTONE'S LIFETIME IMPLANT WARRANTY PROGRAM, KEYSTONE DOES NOT MAKE ANY WARRANTY, EXPRESS OR IMPLIED, EXCEPT THAT ITS PRODUCTS SHALL BE FREE FROM DEFECTS IN MATERIAL AND/OR WORKMANSHIP. THIS WARRANTY APPLIES ONLY TO THE ORIGINAL PURCHASER. PURCHASER ASSUMES ALL RISKS AND LIABILITY RESULTING FROM THE USE OF THESE PRODUCTS, WHETHER USED SEPARATELY OR IN COMBINATION WITH OTHER PRODUCTS. THE WARRANTY DOES NOT APPLY IF THE FAILURE OF THE PRODUCT IS CAUSED BY TRAUMA OR ACCIDENT OR BY THE PATIENT IN WHOM THE IMPLANT WAS INSTALLED OR IF THE PURCHASER IS NOT CURRENT ON ALL OUTSTANDING PAYMENTS TO KEYSTONE AT THE TIME OF SUCH CLAIM. KEYSTONE MAY MODIFY OR TERMINATE ITS WARRANTY PROGRAM AT ANY TIME, HOWEVER ANY CHANGES TO THE WARRANTY PROGRAM WILL NOT AFFECT PRODUCTS ALREADY PURCHASED AT THE TIME OF SUCH CHANGE. PURCHASER'S SOLE REMEDY WITH RESPECT TO CLAIMS RELATED TO KEYSTONE PRODUCTS IS RESTRICTED TO THE WARRANTY POLICY.

LIMITATION OF LIABILITY. UNDER NO CIRCUMSTANCES SHALL KEYSTONE OR ANY OF ITS AFFILIATES BE LIABLE FOR BUSINESS INTERRUPTION, LOSS OF PROFITS, SPECIAL, INDIRECT, INCIDENTAL OR CONSEQUENTIAL DAMAGES OF ANY NATURE AND FROM ANY CAUSE WHETHER BASED IN CONTRACT, WARRANTY OR TORT (INCLUDING NEGLIGENCE) OR OTHER LEGAL THEORY, EVEN IF KEYSTONE HAS BEEN ADVISED OF THE POSSIBILITY OF SUCH DAMAGES.

INTELLECTUAL PROPERTY. All intellectual property rights in Products sold to Purchaser shall remain the exclusive property of Keystone and its licensors.

PERSONAL DATA. It is Purchaser's responsibility to obtain patient's consent to transfer any personal data to Keystone.

TERMINATION. Keystone may terminate this or any agreement with Purchaser to purchase its products upon immediate written notice if Purchaser fails to pay any of its debt obligations to Keystone on time.

FORCE MAJEURE. Keystone shall not be liable for any loss or damage due to failure or delay arising out of any cause beyond the reasonable control of Keystone. In the event of any failure or delay resulting from such causes, an equitable adjustment of delivery and any other appropriate terms and conditions shall be made. No such failure or delay shall be the basis for an increase in Keystone's obligations, nor any termination by Purchaser.

VALIDITY. If any provision of these Terms and Conditions is found to be illegal or unenforceable in any respect, such illegality or unenforceability shall not affect any other provision of these Terms and Conditions, all of which shall remain enforceable in accordance with their terms.

GENERAL PROVISIONS. The purchase of the Products and these Terms and Conditions are governed by the laws of the Commonwealth of Massachusetts, without regard to conflicts of law principles. Any dispute, claim or controversy arising out of or in connection with the purchase of the Products shall be resolved by arbitration in Boston, Massachusetts. This document incorporates all oral and written representations between the parties and constitutes the entire agreement and understanding of the parties with respect to the subject matter hereof and supersedes any and all other agreements either oral or written between the parties with respect to such subject matter. No amendment or modification may be made to this document unless in writing and duly executed by an authorized representative of Keystone. Keystone may subcontract, assign or transfer its obligations or rights to a competent third party. Purchaser may not assign or transfer any of its obligations without the consent of Keystone.

**Keystone Dental, Inc.
Global Headquarters**

154 Middlesex Turnpike
Burlington, MA 01803 USA
General Inquiries: 781-328-3600
Customer Relations: 866-902-9272 or 781-328-3490
Fax: 866-903-9272 or 781-328-3400
Email: info@keystonedental.com

Keystone Dental, Inc.

5 Holland, Bldg 209
Irvine, CA 92618 USA
Customer Service Number: 866-902-9272
Fax: 866-903-9272 or 781-328-3400
Email: info@keystonedental.com



EMERGO Europe B.V. 

Prinsessegracht 20
2514 AP The Hague
The Netherlands



Caution, consult accompanying documents

Trademark Acknowledgements

TiLobe®, PrimaPlus, Quick-Cap and "Smarter Thinking. Simpler Design." are trademarks and registered trademarks of Keystone Dental, Inc.