



ZLINE



**FIRECLAY SINKS**

---

Installation Guide  
and Users Manual



*This product can expose you to chemicals including nickel, which is known to the State of California to cause cancer, and birth defects or other reproductive harm. For more information go to [www.P65Warnings.ca.gov](http://www.P65Warnings.ca.gov).*

*Even though the materials used in all ZLINE Kitchen and Bath products conform to all federal government regulations and all national product standards, California's Prop 65 requires all businesses to provide a "clear and reasonable warning" if one or more listed chemicals may be present in the product, even if that chemical is present in trace quantities*



ZLINE

Fireclay sinks are meticulously handcrafted in Italy from a unique type of clay found in limited regions of the country. Constructed to be resistant to bacteria, stains, cracks, and scratches, this statement sink is non-porous and naturally sound absorbing. Fireclay sinks are harder than traditional ceramic sinks, allowing for a worry-free washing experience. All ZLINE fireclay sinks are garbage disposal compatible for easy cleanup.

# CONTENTS

● SAFETY INSTRUCTIONS	1
● SINK DIMENSIONS	2
● SINK INSTALLATION	10
● CARE AND CLEANING	11

# SAFETY INSTRUCTIONS

- The installer and/or user must read, understand, and follow these instructions before installing the product. This product must be properly installed before it is used. If instructions are not followed, the manufacturer will not be held responsible for any problems or product malfunction. Failure to follow installation and/or operating instructions voids the warranty.
- We recommend that this product be installed by a certified plumber. In some states or provinces, it is a legal requirement for this type of product to be installed by a certified plumber, according to the plumbing and building codes effective in the region where the sink is used.
- DO NOT attempt to install this sink yourself. Injury could result from installing the unit due to lack of appropriate plumbing and technical background. Due to the size and weight of this sink, two people installation is recommended.
- It is recommended that the cabinet maker waits until the sink is delivered to make the cabinet.
- Shut off the water valves before installing the sink or doing any maintenance.
- Disconnect the power to the dishwasher and garbage disposal.
- Open the sink packaging and verify that the sink is in perfect condition. Put the sink back in its packaging to protect it until time of installation.

# SINK DIMENSIONS

## Fireclay Sink Single Bowl

FRC5117-30 (Apron Mount)

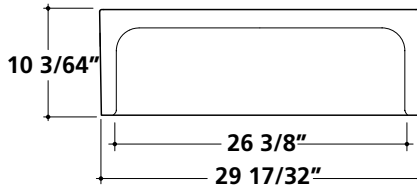
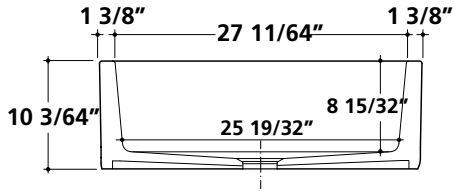
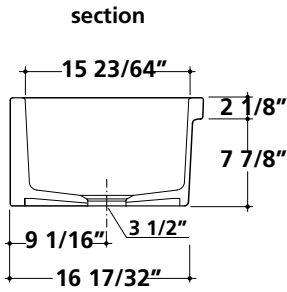
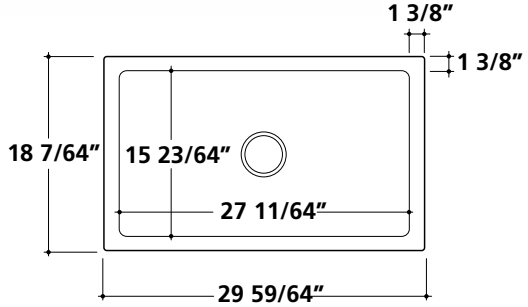

# SINK DIMENSIONS

## Fireclay Sink Single Bowl

FRC5119-30 (Apron Mount)

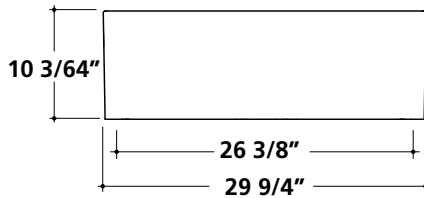
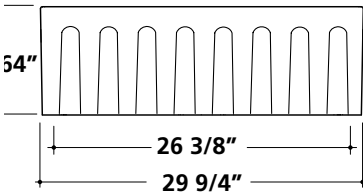
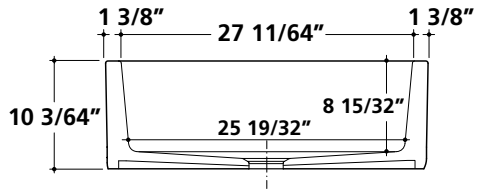
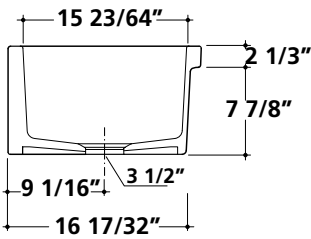
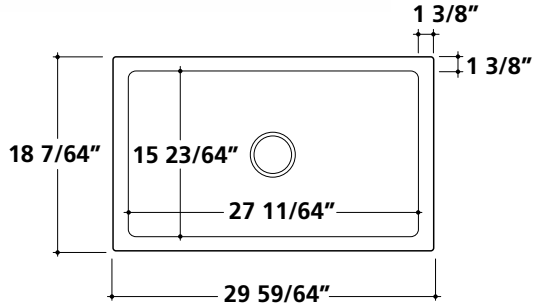

# SINK DIMENSIONS

## Fireclay Sink Single Bowl

FRC5120-24 (Apron Mount)

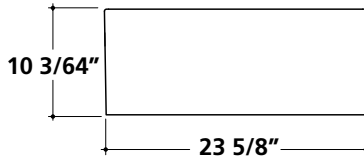
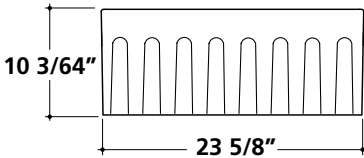
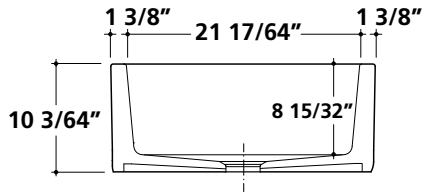
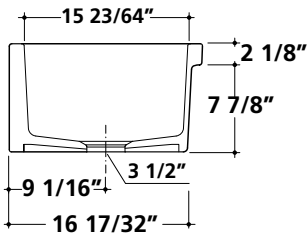
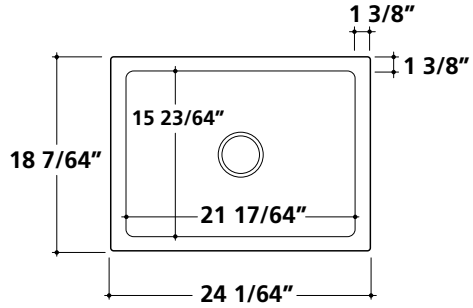



# SINK DIMENSIONS

## Fireclay Sink Double Bowl

FRC5121-36 (Apron Mount)

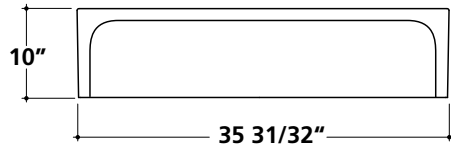
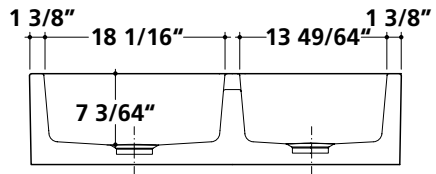
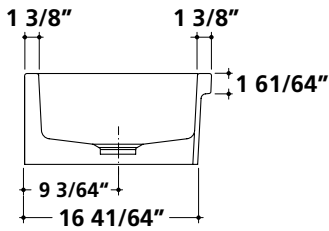
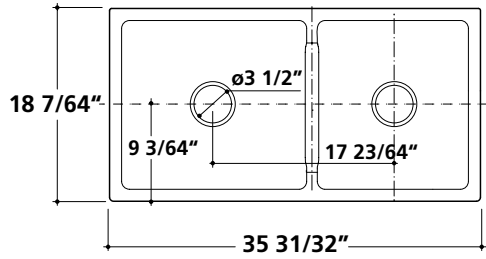

# SINK DIMENSIONS

## Fireclay Sink Single Bowl

FRC5122-36 (Apron Mount)

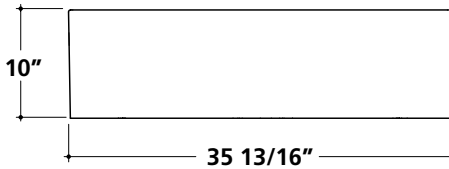
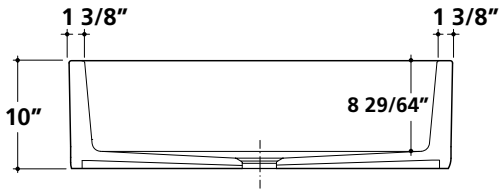
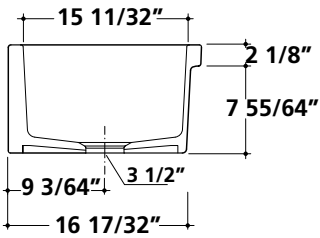
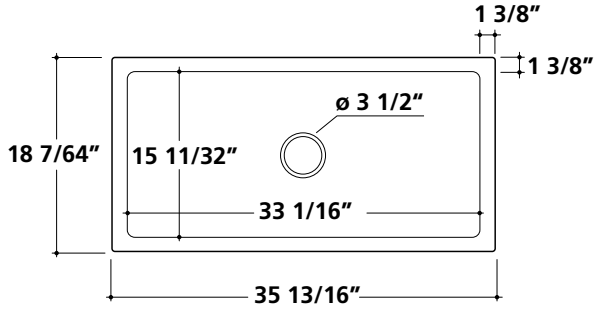

# SINK DIMENSIONS

## Fireclay Sink Single Bowl

FRC5123-36 (Dual Mount)

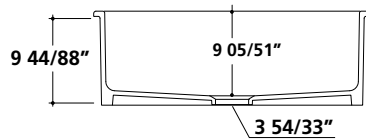
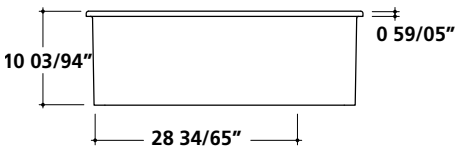
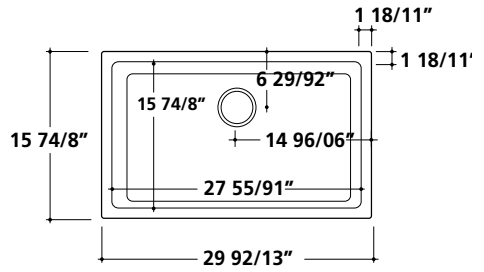

# SINK DIMENSIONS

## Fireclay Sink Single Bowl

FRC5124-24 (Dual Mount)

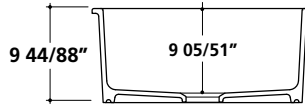
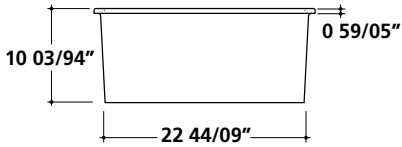
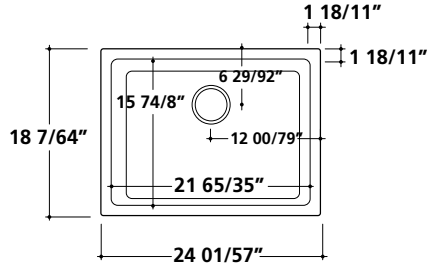

# SINK DIMENSIONS

## Fireclay Sink Single Bowl

FRC5131-33 (Apron Mount)

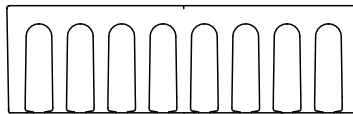
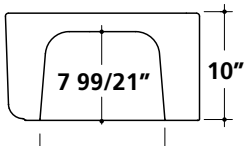
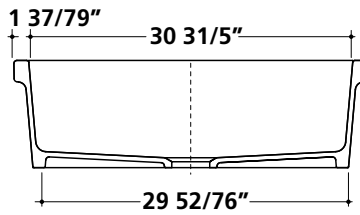
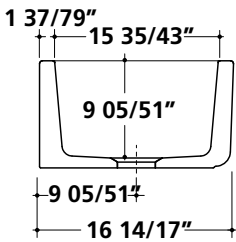
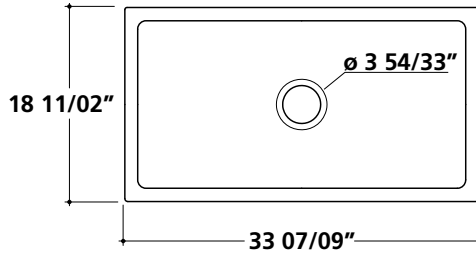

## Before Installation

Inspect the sink for any visible defects. Do not install the sink if defects are found. Call customer service at 1-614-777-5004 for assistance.

## Installation

### 1. Preparing the Cabinets

Make sure that the tank will not interfere with cabinet doors or panels. Ensure that there is enough space for the water supply installation.

### 2. Build a Support Frame

Fireclay sinks need support due to their weight. Installing wooden support beams underneath the sink will reinforce it. Ensure that the top of the sink is aligned where you would like it. Create vertical and horizontal supports with the 2x4s.

### 3. Insert the Sink

Insert the sink on the support frame. Apply silicone-based sealant to each corner between the frame and the sink.

## Easy Cleaning Instructions

Fireclay sinks can be washed with dish soap and water. A rinse and towel drying after each use will take care of most everyday clean ups.

## Scratches

Fireclay sinks are scratch-resistant, but the matte finishes tend to show more markings. Markings that appear to be scratches are typically residue left by metal cutlery or pots and pans. A grid is recommended to reduce appearance of markings. Markings can be removed with a diamond sponge or a Scotch-Brite™ pad.

## Chips

Fireclay sinks are extremely resistant to chips, but if you find any small chips in your sink, there are repair kits available at most local hardware stores.

## Food

Food can easily become stuck in the corners of the fireclay sink due to its shape. Rinse out all food particles to keep the sink clean.

## Dos and Dont's

**Do** rinse thoroughly after each use.

**Do** towel dry after each use to prevent mineral deposits from building up on the surface of the sink.

**Do** clean the sink once a week.

**Do** wax the sink once a month.

**Do Not** allow soap or other household cleansers to dry on the surface of the sink.

**Do Not** use abrasive cleaners to clean your sink.



**ZLINE**  
KITCHEN AND BATH

**Three Locations:**

350 Parr Circle  
Reno, NV 89512

916 Delaware Avenue  
Marysville, OH 43040

319 Rowland Mill Road  
Bruceton, TN 38317

[www.zlinekitchen.com](http://www.zlinekitchen.com)

**1-614-777-5004**