



Orion Multi 52" - Right Corner Bay Install
Flame One (Hybrid)

ORION MULTI

*Multi-Sided Electric Fireplace Featuring NEW HELIOVISION™ Flame Technology
One Fireplace Fits All – Our Orion Linear Electric Fireplace with the Most Versatile Installation Options*

Installation

- ▶ *Front View, Left Corner, Right Corner, Bay*
- ▶ *Built-In Clean Face or Wall Mount*
- ▶ *Wall Mount Installs flush to Wall with Flames Offset Only 1-½"*
- ▶ *Available in Sizes: 52" – 60" – 76" – 100" & 120"*

Flame Display

- ▶ *Features NEW HELIOVISION™ Flame Technology*
- ▶ *18" High Viewing Area – 5" Deep Ember Bed*
- ▶ *3 Flame Patterns – 6 Flame Colors*
- ▶ *Adjustable Flame Speed*
- ▶ *Adjustable Ambient Crackling Sound*
- ▶ *Multi-Color Ember Bed*
- ▶ *Multi-Color Downlighting*
- ▶ *Multi-Dimensional Flame Appearance*
- ▶ *5,000 or 10,000 BTU Heater*

Units

- ▶ *ORION 52" MULTI OR52-MULTI*
- ▶ *ORION 60" MULTI OR60-MULTI*
- ▶ *ORION 76" MULTI OR76-MULTI*
- ▶ *ORION 100" MULTI OR100-MULTI*
- ▶ *ORION 120" MULTI OR120-MULTI*

Model

ORION ADVANCED FEATURES

Modern Flames Orion Electric Fireplaces featuring NEW HELIOVISION™ flame technology. Our Orion electric fireplaces with the most advanced features that fits all your needs.

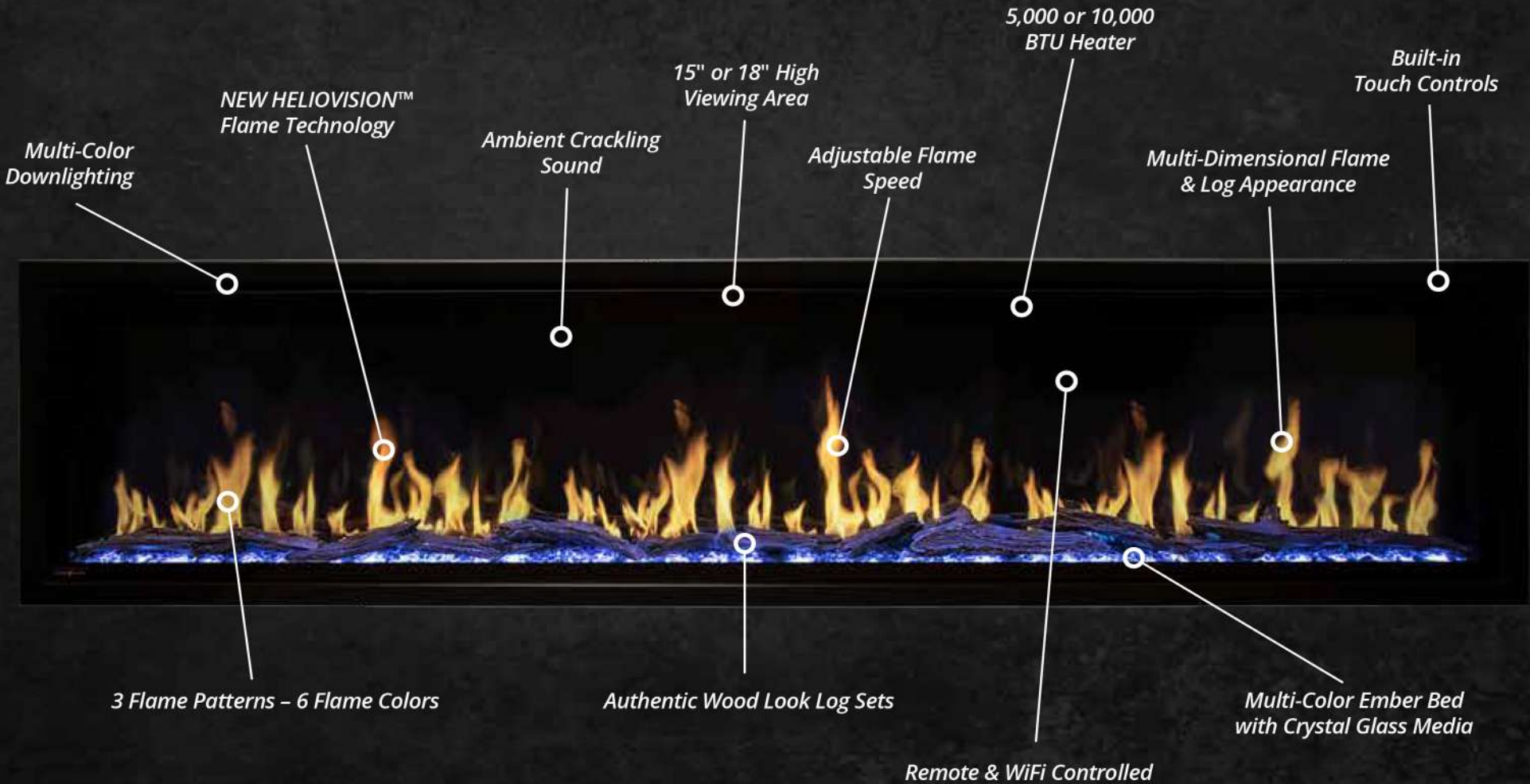

Shown: Flame One - Hybrid

MULTI SPECIFICATIONS

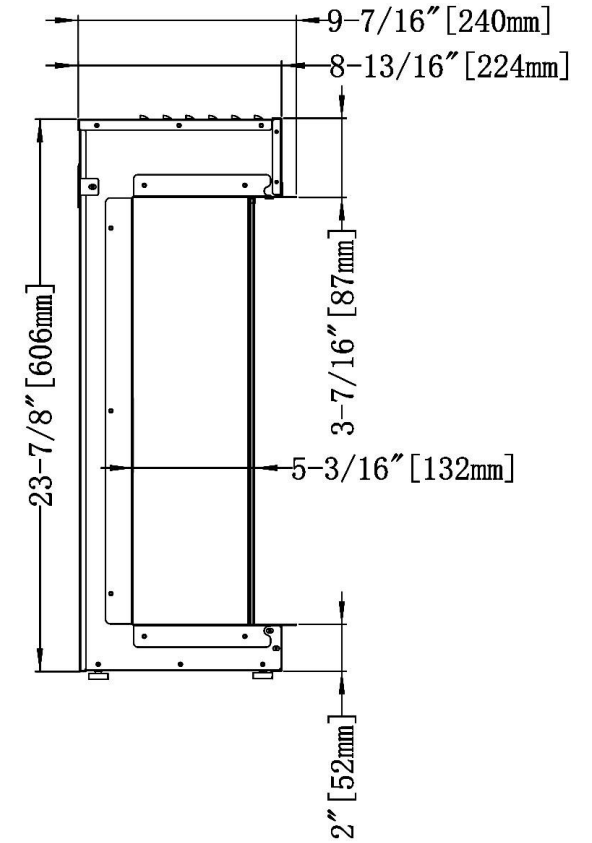
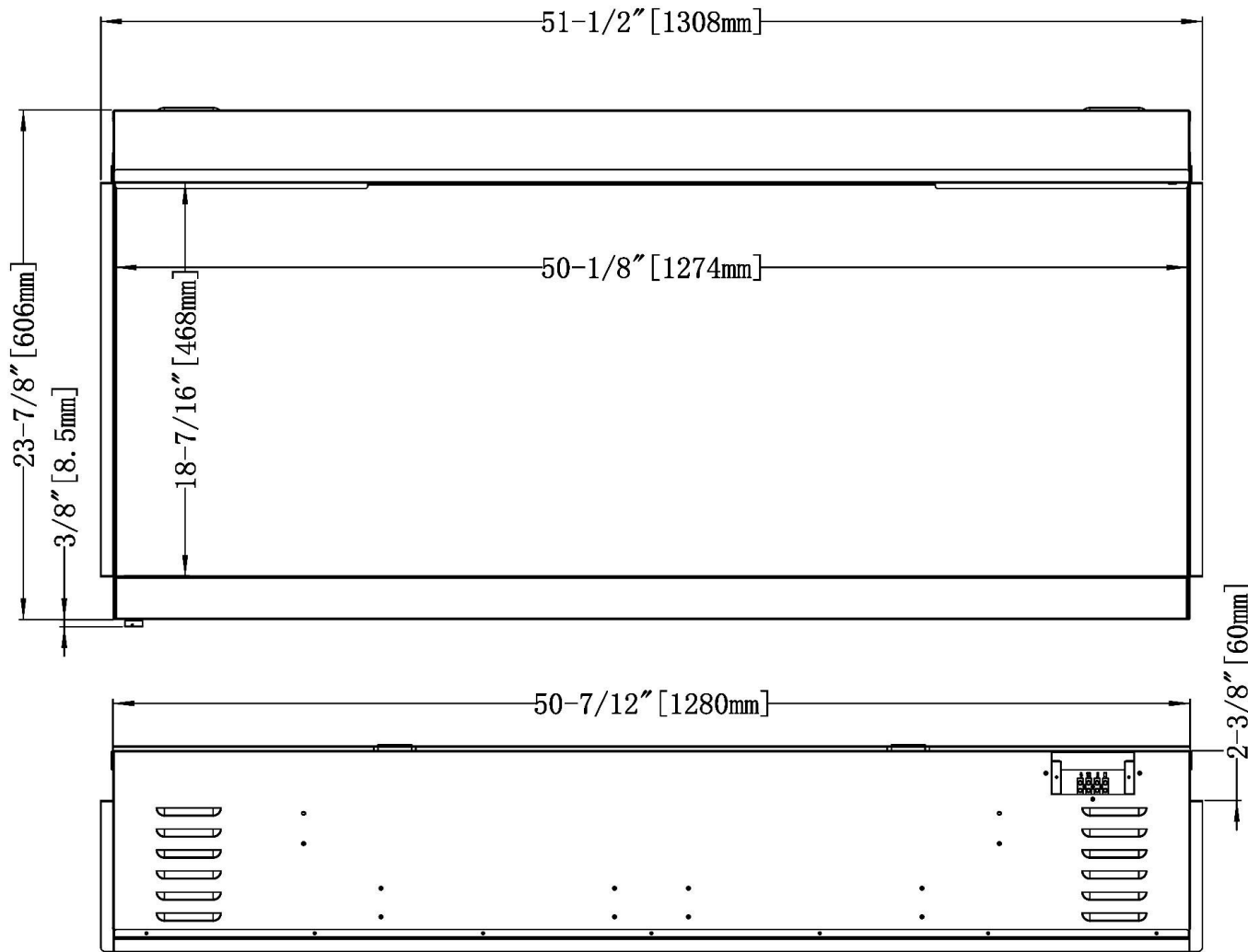

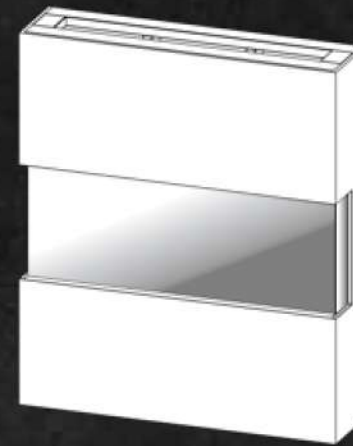
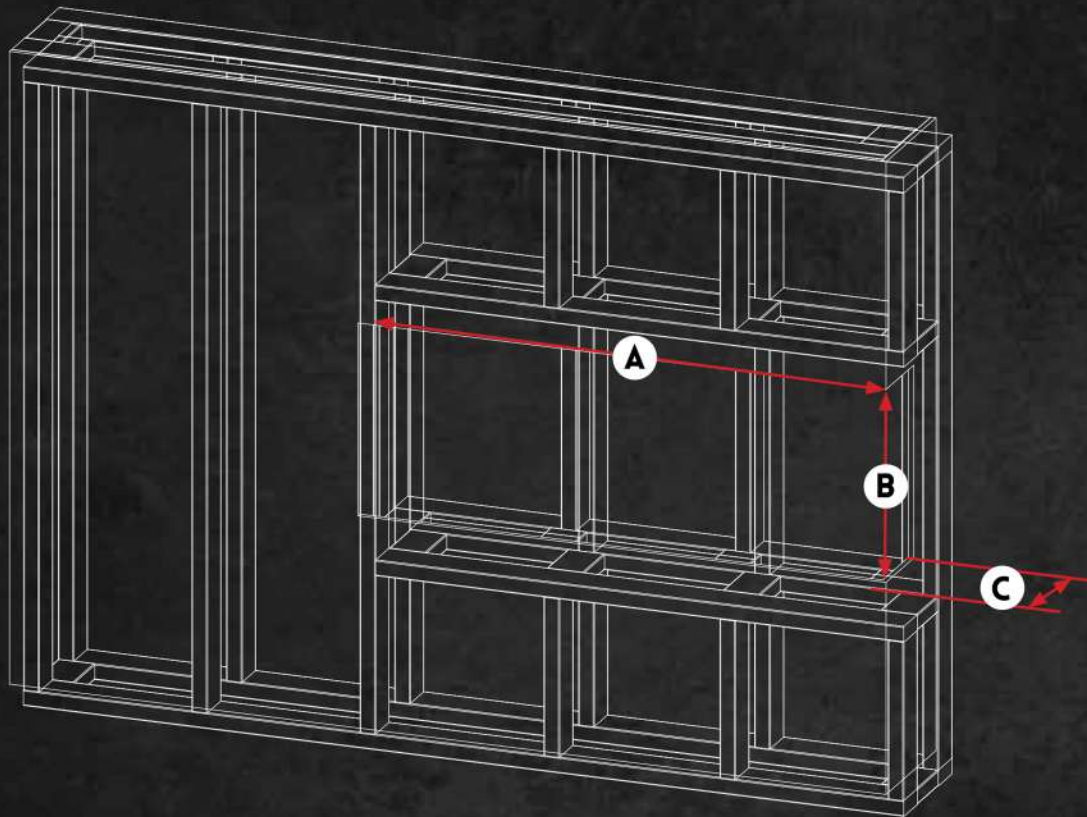

**FINISHED WALL
- THREE SIDED BAY INSTALL**

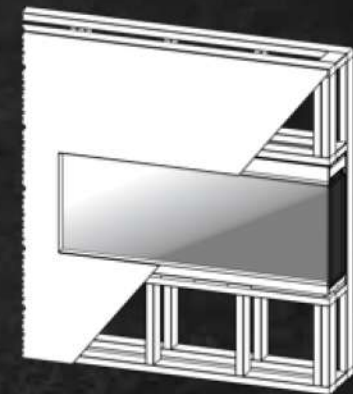

**FINISHED WALL
- RIGHT CORNER INSTALL**

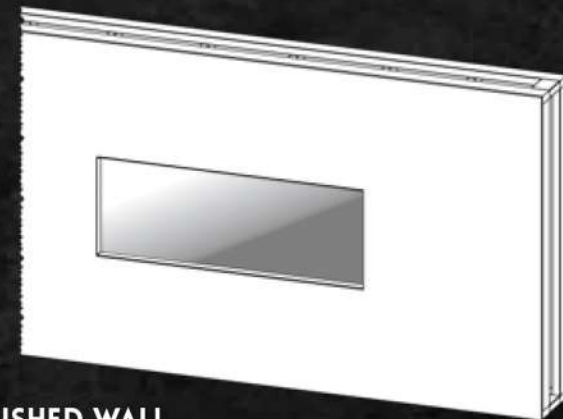
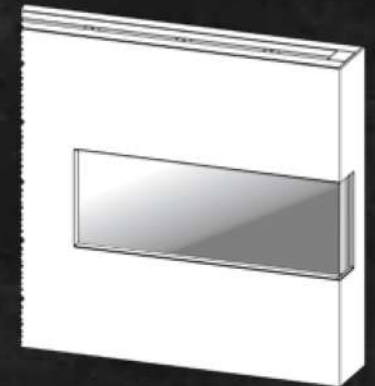

**FINISHED WALL
- SINGLE SIDED INSTALL**

FRAMING DIMENSIONS

| MODEL NUMBER | A | B | C |
|--------------|-------------------|------------------|--------------------------|
| OR52-MULTI | 51" 1295MM | 24-3/4" 629MM | 9" MINIMUM 229MM MIN. |
| OR60-MULTI | 59-1/2" 1511MM | 24-3/4" 629MM | 9" MINIMUM 229MM MIN. |
| OR76-MULTI | 75-1/4" 1911MM | 24-3/4" 629MM | 9" MINIMUM 229MM MIN. |
| OR100-MULTI | 99-1/2" 2527MM | 24-3/4" 629MM | 9" MINIMUM 229MM MIN. |
| OR120-MULTI | 124" 3150MM | 24-3/4" 629MM | 9" MINIMUM 229MM MIN. |

FLAME STYLES



FLAME ONE (HYBRID)



FLAME TWO (WOOD)



FLAME THREE (GAS)

FLAME COLORS



YELLOW



BLUE



YELLOW



BLUE



YELLOW



BLUE

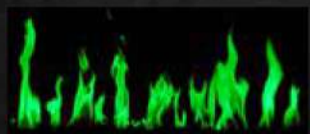

GREEN



ORANGE

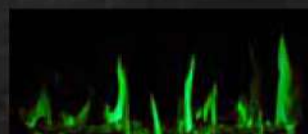

GREEN



ORANGE

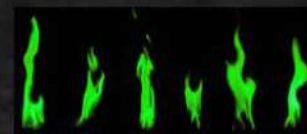

GREEN



ORANGE



PURPLE



WHITE



PURPLE



WHITE



PURPLE



WHITE

MEDIA AND LOG SET

REFLECTIVE BLACK CRUSHED GLASS AND LOG SET - WESTERN DRIFTWOOD are included with each fireplace; you choose the set up.



LOG SET - WESTERN DRIFTWOOD
with REFLECTIVE BLACK CRUSHED GLASS



REFLECTIVE BLACK CRUSHED GLASS

WIFI APP CONTROLS

MODERN FLAMES
MOBILE APP

