



Experience Better Living.



Linear
Series

IGNITE[®] ULTRA

Innovate your space, Ignite your style.



IGNITE[®] ULTRA

Linear Electric Fireplace

Experience Better Living.

Available in
50, 60, 74, 88
& 100 inch
widths

Key Benefits

Modern Elegance

Sleek design and cutting-edge technology create a focal point that exudes modernism.

Adaptable Design

Freedom to fit your vision with five installation choices: front-facing, left corner, right-corner, bay, or create a sleek modular unit.

Natural Hearth

Delivers the most authentic flame and log combination for an unmatched and lifelike fire experience.



Dynamic-Fire Flame Effect

Witness a brand new, remarkably realistic flame effect, patented by Dimplex.



Rhythmic Inner Glow Logs

Features quick connect, moveable logs enhanced with inner glow technology that pulse in rhythm with the dancing flames.



ComfortSaver[®] Heating

On-demand supplemental heating for up to 1,000 sq. ft. with the option to turn the heat off and enjoy the flames year-round.



Crackling Sound Effects

Enhance your sensory journey with the soothing sound of a crackling natural wood fire.



Same fireplace, simply choose 1 of 4 configurations.

Configurations 2-4 require included convertible trim kit.

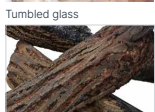

Rhythmic inner glow logs

ULT50 50" Linear Electric Fireplace

Product Dimensions with trim (WxHxD)
50-9/16 × 27-1/2 × 14-1/2 in
128.5 × 69.9 × 36.9 cm

Carton Dimensions (WxHxD)
55 × 29 × 16 in
139.7 × 73.7 × 40.6 cm

Packaged Weight
92 lbs / 41.7 kg

ULT60 60" Linear Electric Fireplace

Product Dimensions with trim (WxHxD)
60-9/16 × 27-1/2 × 14-1/2 in
153.9 × 69.9 × 36.9 cm

Carton Dimensions (WxHxD)
65 × 29 × 16 in
165.1 × 73.7 × 40.6 cm

Packaged Weight
97 lbs / 44 kg

ULT74 74" Linear Electric Fireplace

Product Dimensions with trim (WxHxD)
74-9/16 × 27-1/2 × 14-1/2 in
185.9 × 69.9 × 36.9 cm

Carton Dimensions (WxHxD)
79 × 29 × 16 in
200.7 × 73.7 × 40.6 cm

Packaged Weight
104 lbs / 47.2 kg

ULT88 88" Linear Electric Fireplace

Product Dimensions with trim (WxHxD)
88-9/16 × 27-1/2 × 14-1/2 in
225.0 × 69.9 × 36.9 cm

Carton Dimensions (WxHxD)
93 × 29 × 16 in
236.2 × 73.7 × 40.6 cm

Packaged Weight
111 lbs / 50.3 kg

ULT100 100" Linear Electric Fireplace

Product Dimensions with trim (WxHxD)
100-9/16 × 27-1/2 × 14-1/2 in
255.5 × 69.9 × 36.9 cm

Carton Dimensions (WxHxD)
105 × 29 × 16 in
266.7 × 73.7 × 40.6 cm

Packaged Weight
118 lbs / 53.5 kg



Total Control

Harness total control of your fireplace with the Dimplex Flame Connect App. You can also use the wall-mountable remote control or 3-button touch display.



© Dimplex All rights reserved. Material contained in this publication may not be reproduced in whole or in part, without prior permission in writing of Dimplex. Dimplex is a Registered Trade Mark in North America. All Dimplex flame effects are protected by multiple worldwide patents. All the products shown in this sell sheet are protected by intellectual property rights owned by Dimplex or members of the Glen Dimplex Group on an international basis. The Glen Dimplex Group of Companies will actively protect these rights. Specifications, finishes and dimensions are subject to change. Limited warranty. SE-694-R02-100424

Product Dimensions:

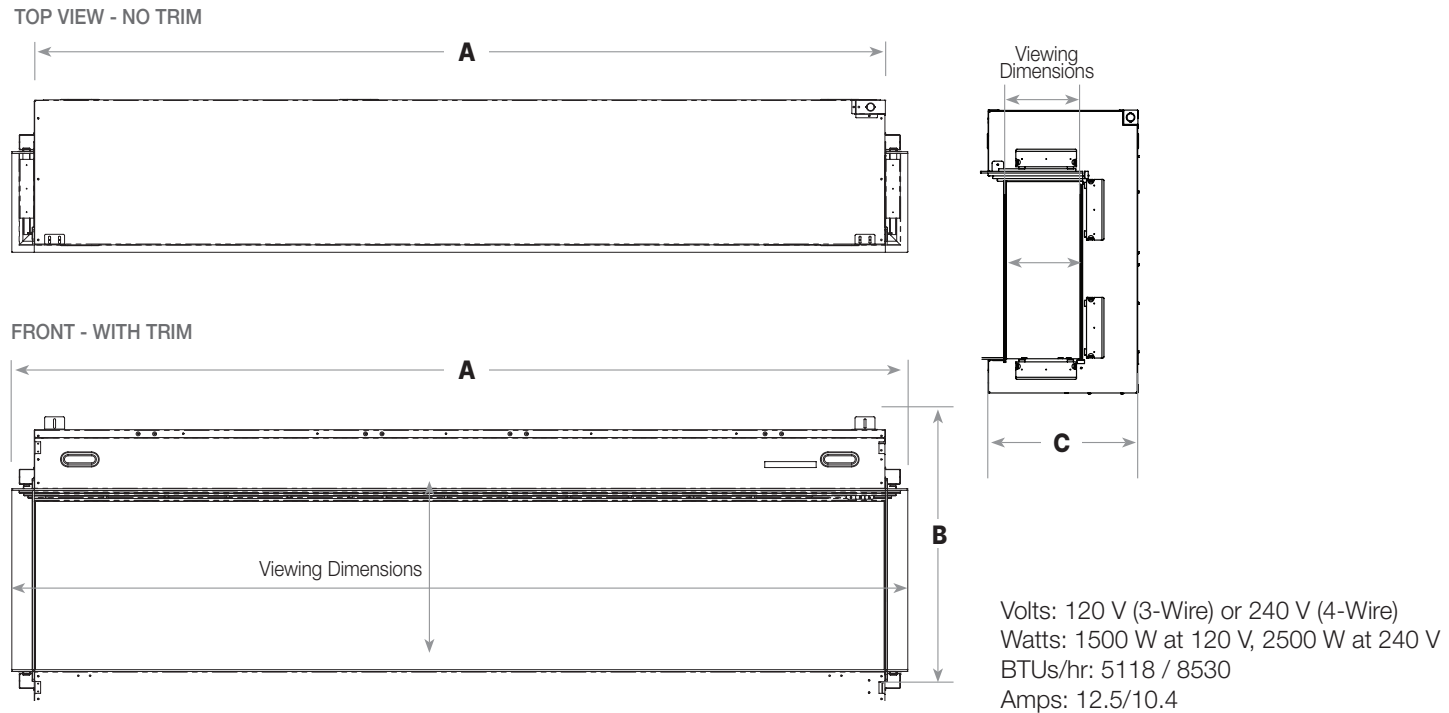

Product	ULT100	A WIDTH (in/cm)	B HEIGHT (in/cm)	C DEPTH (in/cm)	VIEWING DIMENSION - WxHxD (in/cm)
Bay Install with Trim		92-5/8 (265.8)	27-1/2 (69.9)	14-1/2 (36.9)	88 x 17 x 7-11/16 (254 x 42.9 x 19.5)
Front Install		88-5/8 (255.5)			

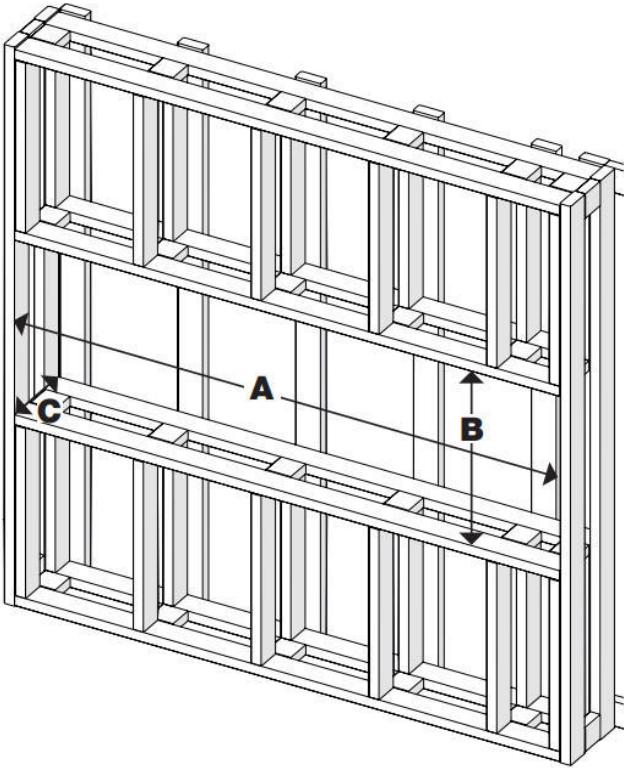

Framing Dimensions

Model	Width	Height	Depth
	A	B	C
ULT50	50-3/4" 12.9 cm	28" 71.2 cm	15" 38.2 cm
ULT60	60-3/4" 154.4 cm		
ULT74	74-3/4" 189.9 cm		
ULT88	88-3/4" 225.5 cm		
ULT100	100-3/4" 256 cm		

Open-sided install	
D	E
3-1/2" 9 cm	1" 2.5 cm

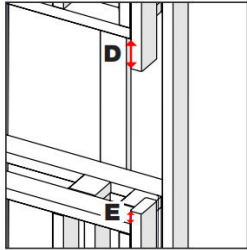

Alternate view for open-sided installation

Prepare a wall with a framed opening, following the dimensions in the table. For linked installation, add widths of fireplaces used.

CAUTION: This fireplace is NOT load-bearing. Ensure the opening for the fireplace is framed in such a way that the weight of the building materials will not create pressure on the top of the fireplace.

NOTE: Wiring connections are located at the back of the firebox, in the top right corner.