

## Quick Start Guide : Aquafire Lite Series

### 1. Install Aquafire Lite Into Its Enclosure

- 1 Remove the top plate.
- 2 Connect the 24V power adapter (located on the back side of the unit).
- 3 Install Aquafire Lite into its housing, as shown in example below.
- 4 Reinstall the top plate of the fireplace and install is complete.

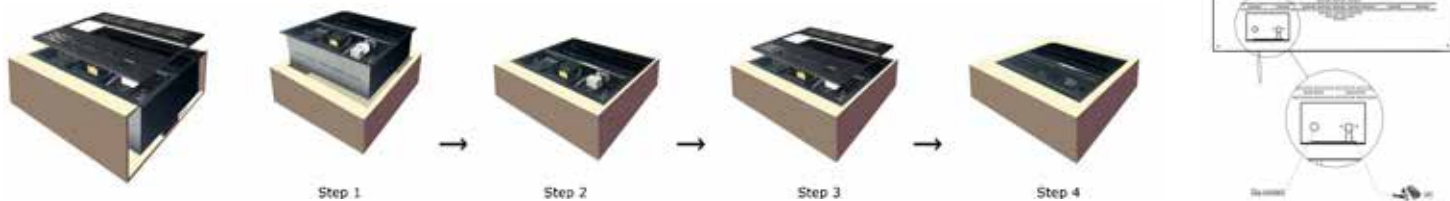

### 2. Fill Aquafire Lite With Tap Water

#### Option 1: with Automatic Pump

- 1 Place the filter end of the fill tube in your water source.
- 2 Connect the other end of the fill tube to the water inlet port.
- 3 Press and hold the "B1" button for 5 seconds to begin fill.
- 4 The pump will stop automatically when the tank is full.

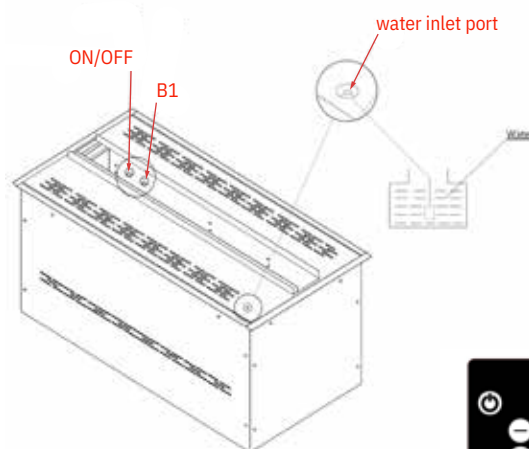

#### Option 2: with Remote Control

- 1 Place the filter end of the fill tube in your water source.
- 2 Connect the other end of the fill tube to the water inlet port.
- 3 Press and hold the 'filling' button on the remote for 5 seconds to begin.
- 4 The pump will stop automatically when the tank is full.



### 3. How to Pair Remote

- 1 Press and hold the Power button on the unit for 5 seconds or until the button will begins flashing.
- 2 Press any button on the remote, you will hear a beep.
- 3 Beep confirms the control is paired to the fireplace unit.



### 4. How to Drain Fireplace

- 1 Prepare a water bucket under the bottom of the device.
- 2 Remove the drain plug located under the fireplace.

