

LIQUIDAIDER INSTALLATION

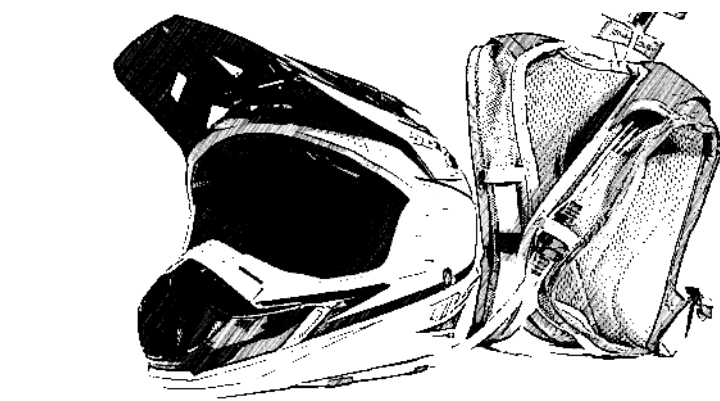

COMPLETED HELMET PUMP

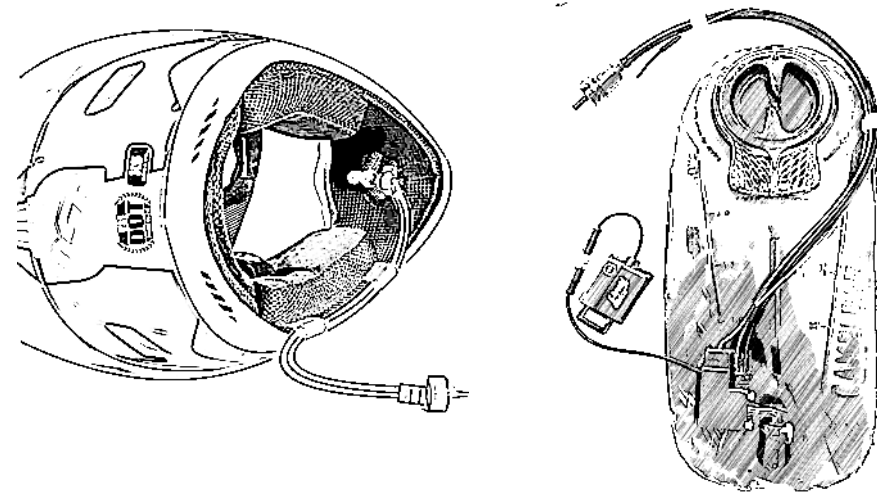

THANK YOU FOR YOUR SUPPORT. WE THINK YOU'LL BE HAPPY AND WE HOPE YOU LET US KNOW ABOUT YOUR EXPERIENCE USING LIQUIDAIDER.

PLEASE READ ALL THIS BEFORE STARTING. RELAX AND TAKE YOUR TIME INSTALLING.

ALTHOUGH HIGHLY DETAILED HERE, THE INSTALLATION IS VERY STRAIGHT FORWARD.

YOU CAN PROBABLY SEE FROM THE "COMPLETED" PICTURES ABOVE THAT THE END RESULT IS ACTUALLY SIMPLE.

CHECK LIQUIDAIDER.COM FOR INSTALL VIDEOS AND OPERATIONAL VIDEOS.

IF SOMETHING IS NOT WORKING OUT, PLEASE EMAIL "SUPPORT@LIQUIDAIDER.COM"

BUTTON INSTALL

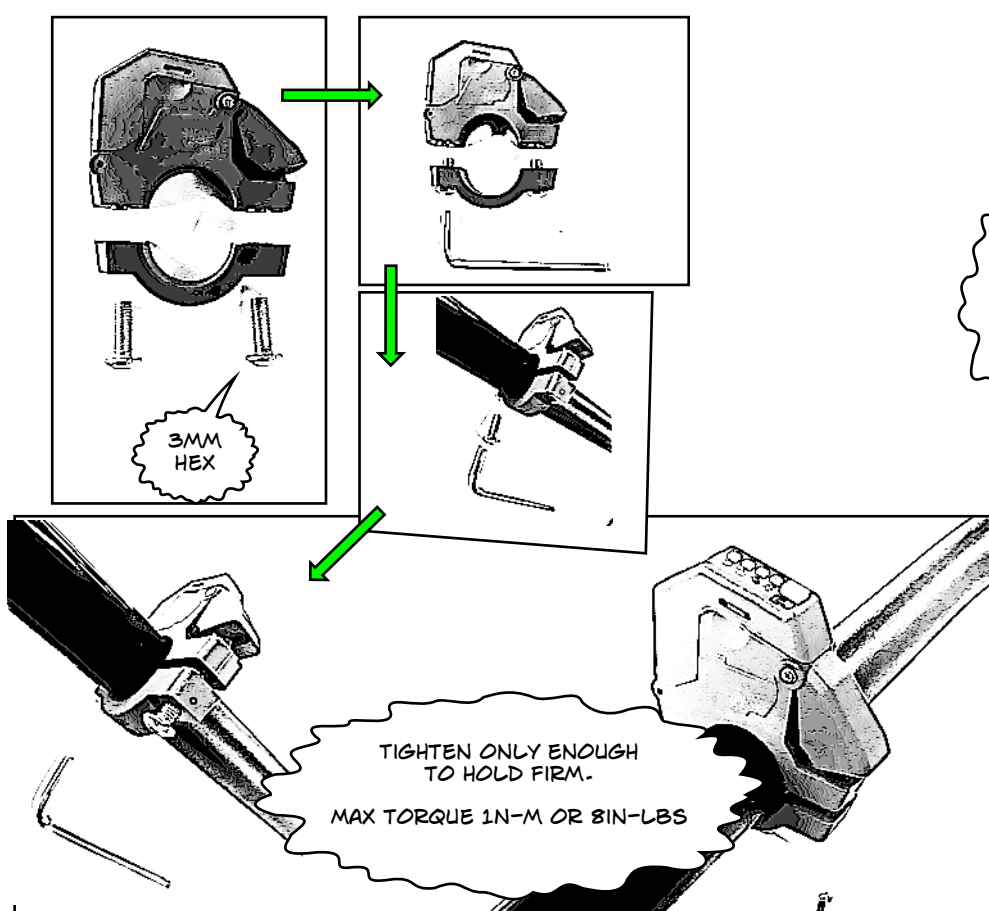

NOZZLE INSTALL

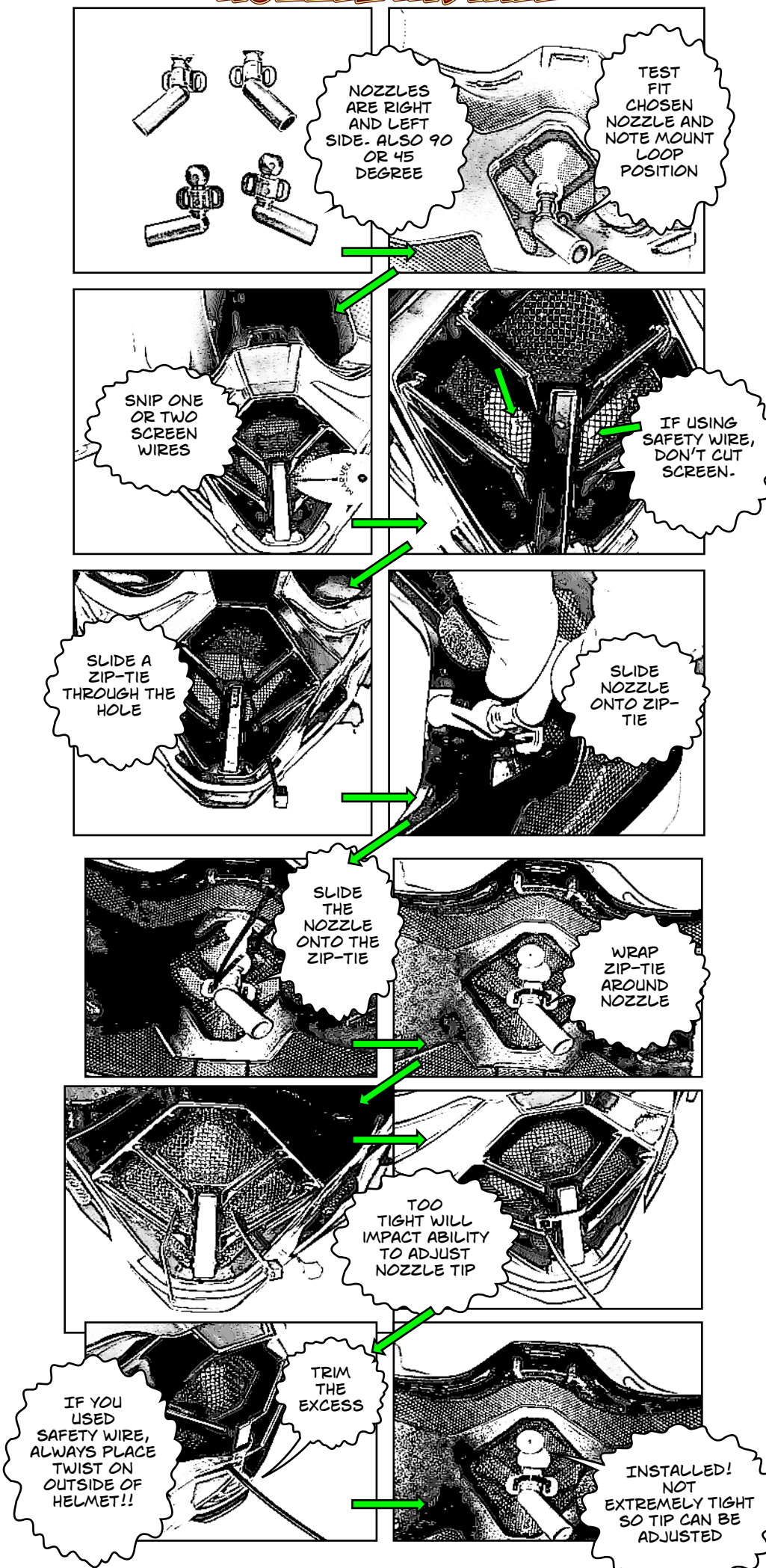

GUARD INSTALL

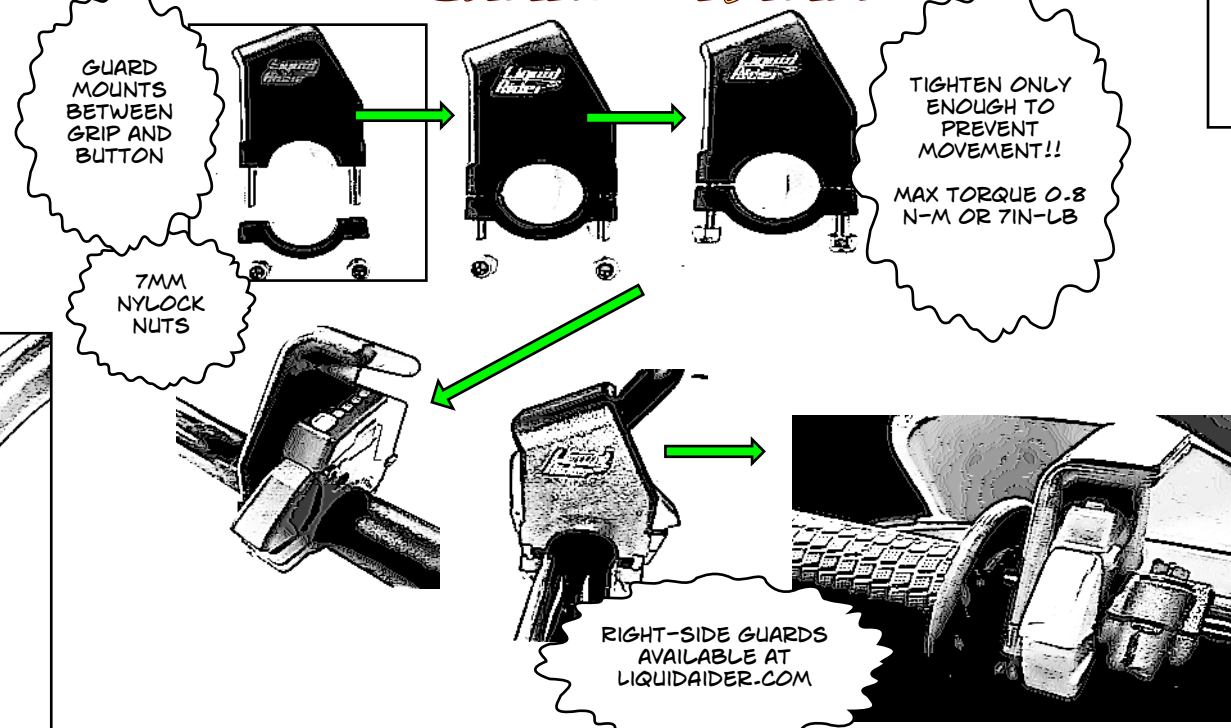

HELMET CLIPS AND TUBE

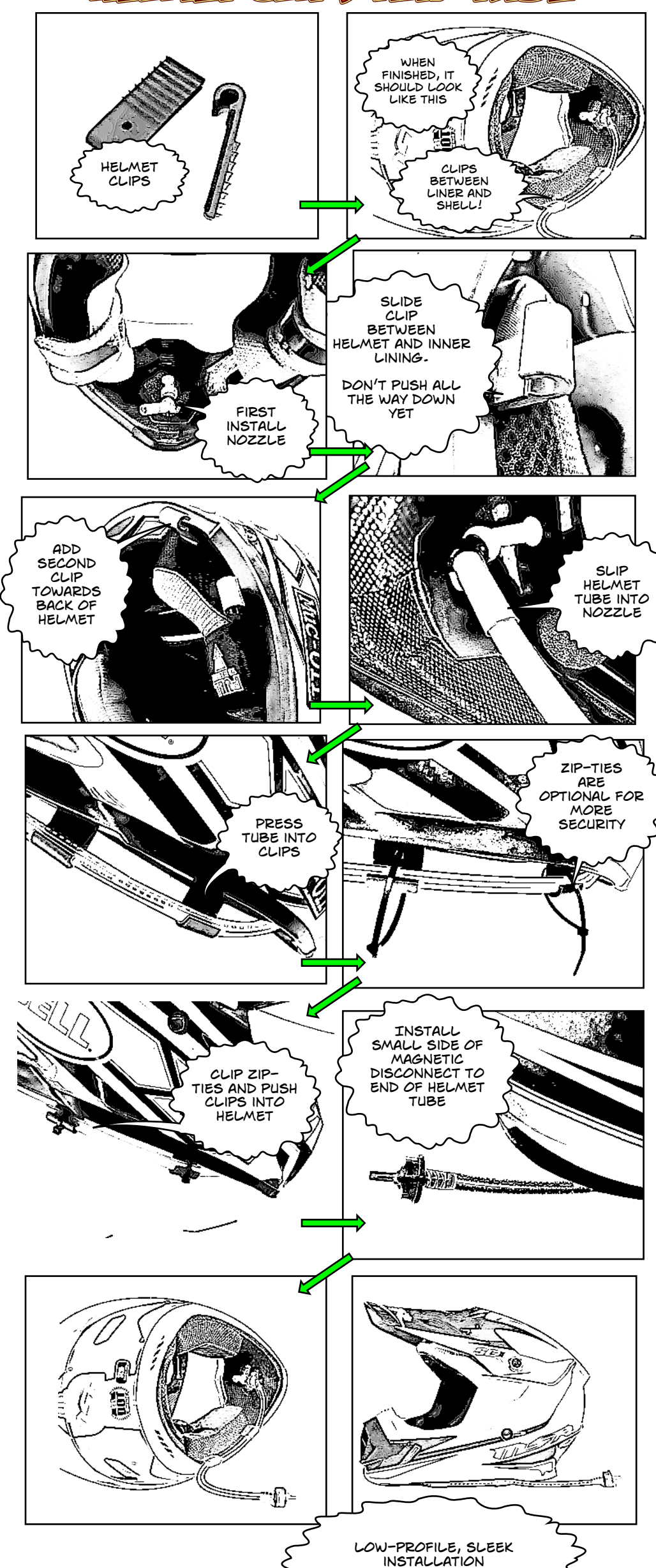

PUMP TUBE & ANTENNA

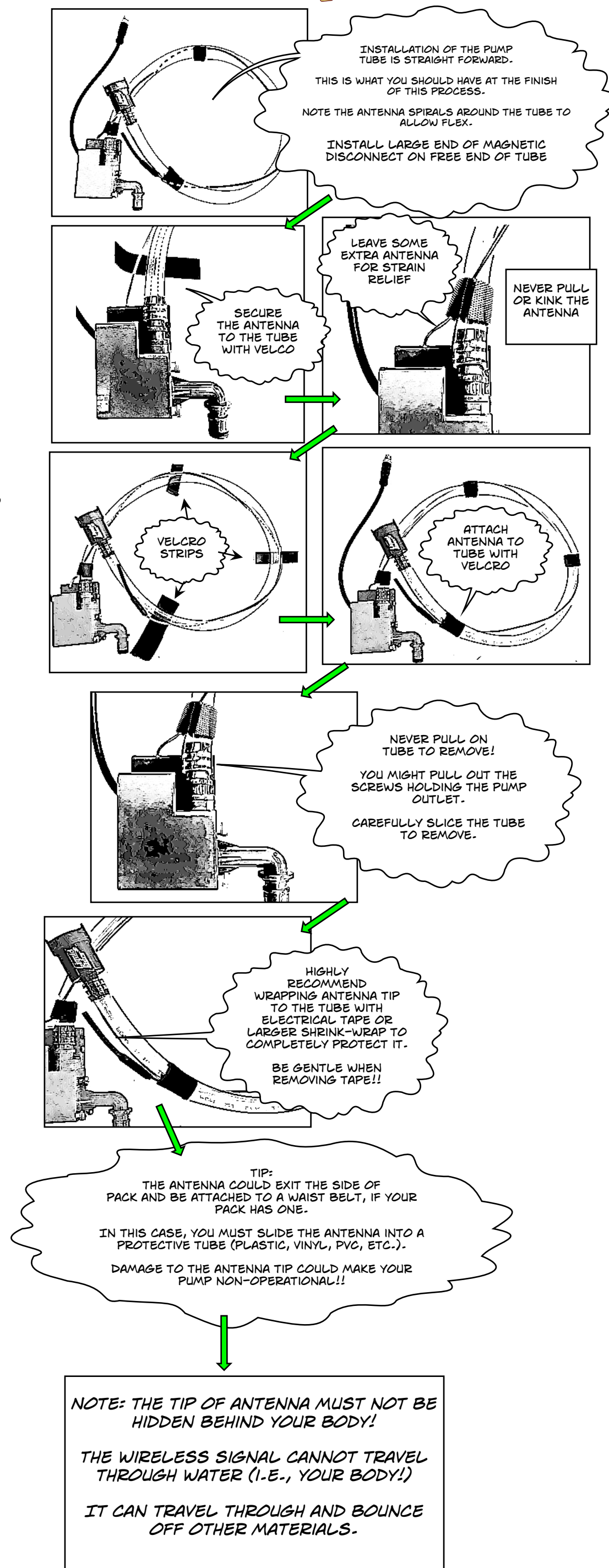

COMPLETED PUMP ASSEMBLY

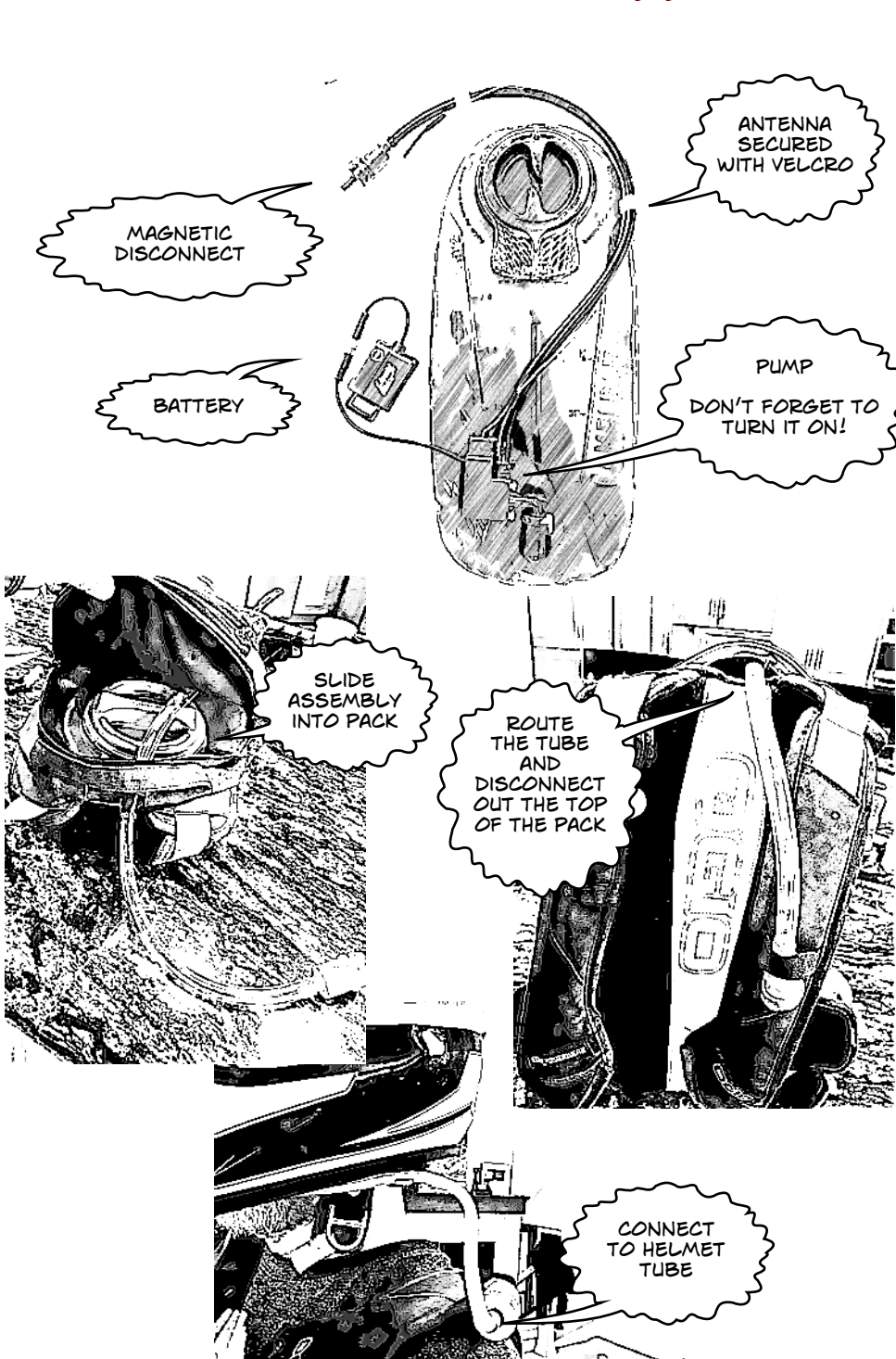

ACTIVATION AND USE

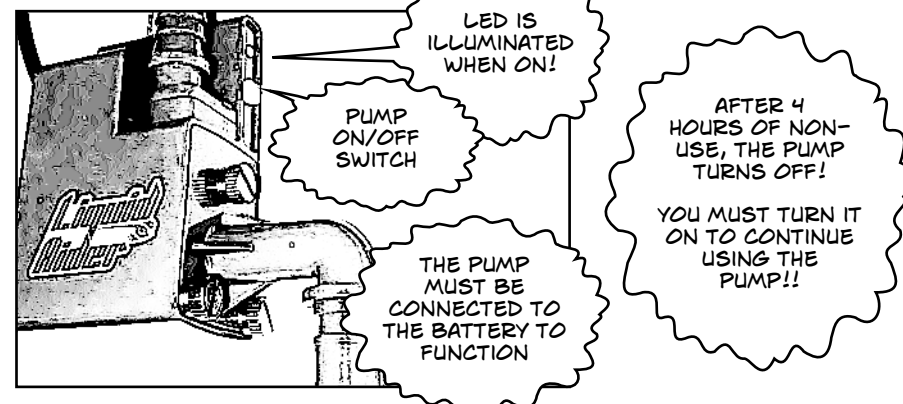
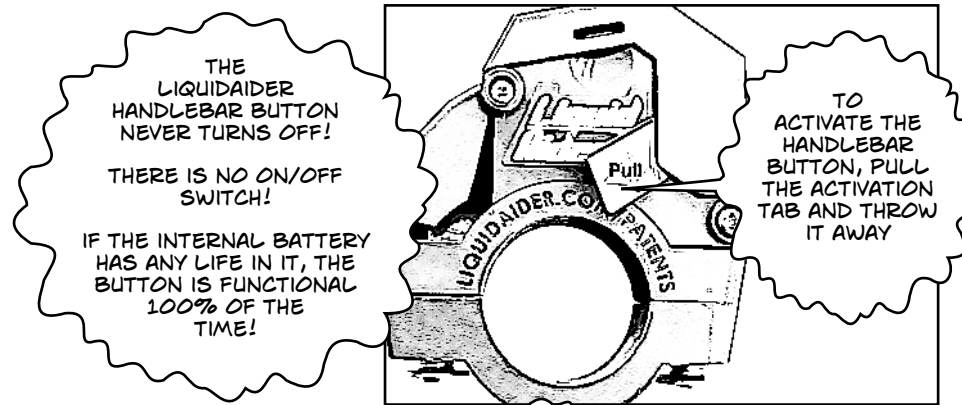

PRIME THE PUMP BEFORE USING IT!!
FAILURE TO PRIME THE PUMP WILL DAMAGE IT!!

TO PRIME THE PUMP, PULL THE HELMET TUBE FROM THE NOZZLE AND SUCK ON IT TO GET WATER INTO THE TUBES.

OR PULL THE HELMET TUBE FROM THE DISCONNECT AND SUCK ON THE DISCONNECT EXIT BARBS.

OPERATIONAL MODES

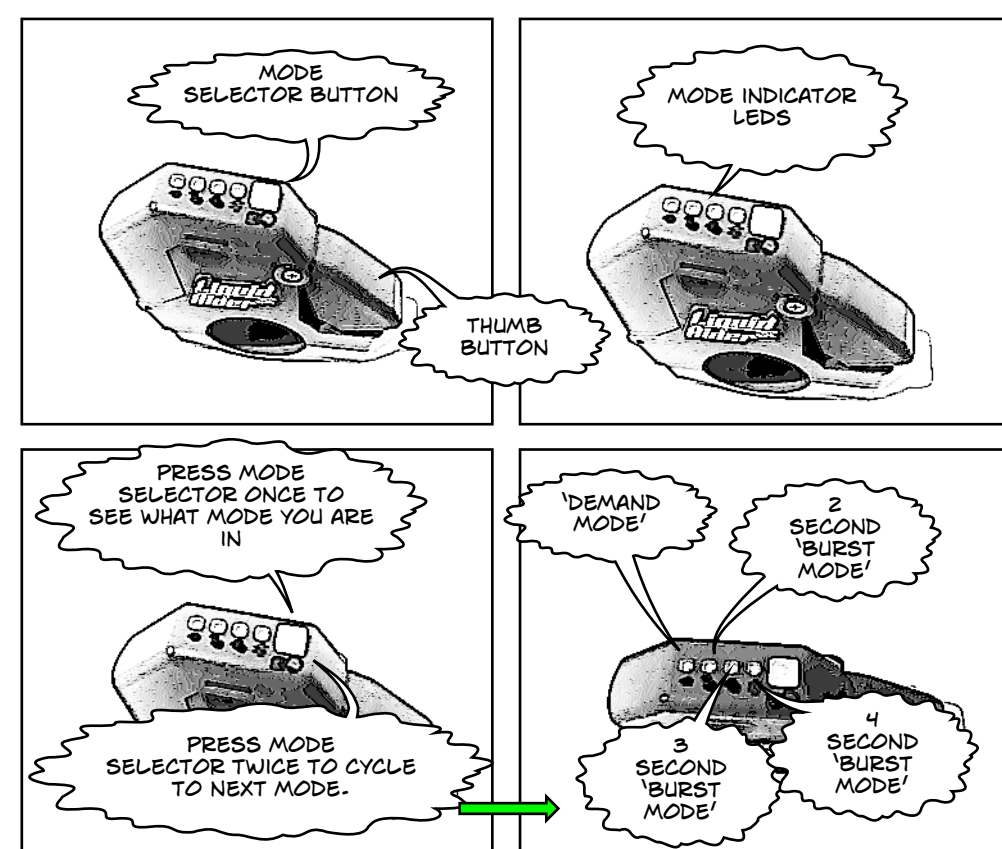

DEMAND MODE:
 AS LONG AS YOU PRESS THE THUMB BUTTON, WATER WILL SQUIRT.

BURST MODE:
 A SINGLE QUICK PRESS OF THE THUMB BUTTON WILL SQUIRT WATER FOR 2, 3, OR 4 SECONDS!

CHANGE MODES ANYTIME!

NOTE THAT THE MODE SELECTOR BUTTON IS ONLY USED TO PAIR THE BUTTON TO THE PUMP OR TO CHANGE MODES.

IT HAS NO OTHER FUNCTION

BATTERY STATUS

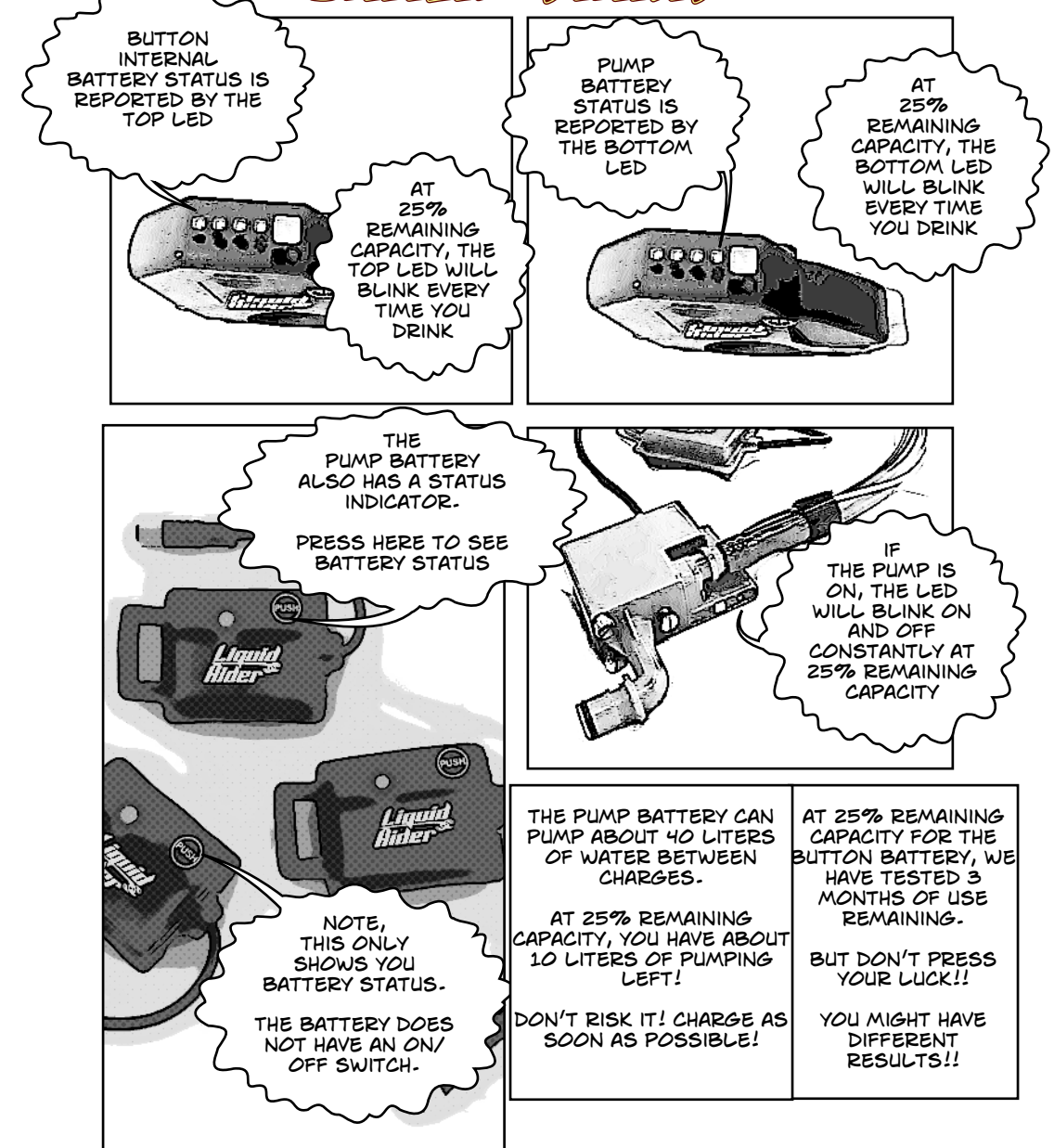

REPLACE BUTTON BATTERY

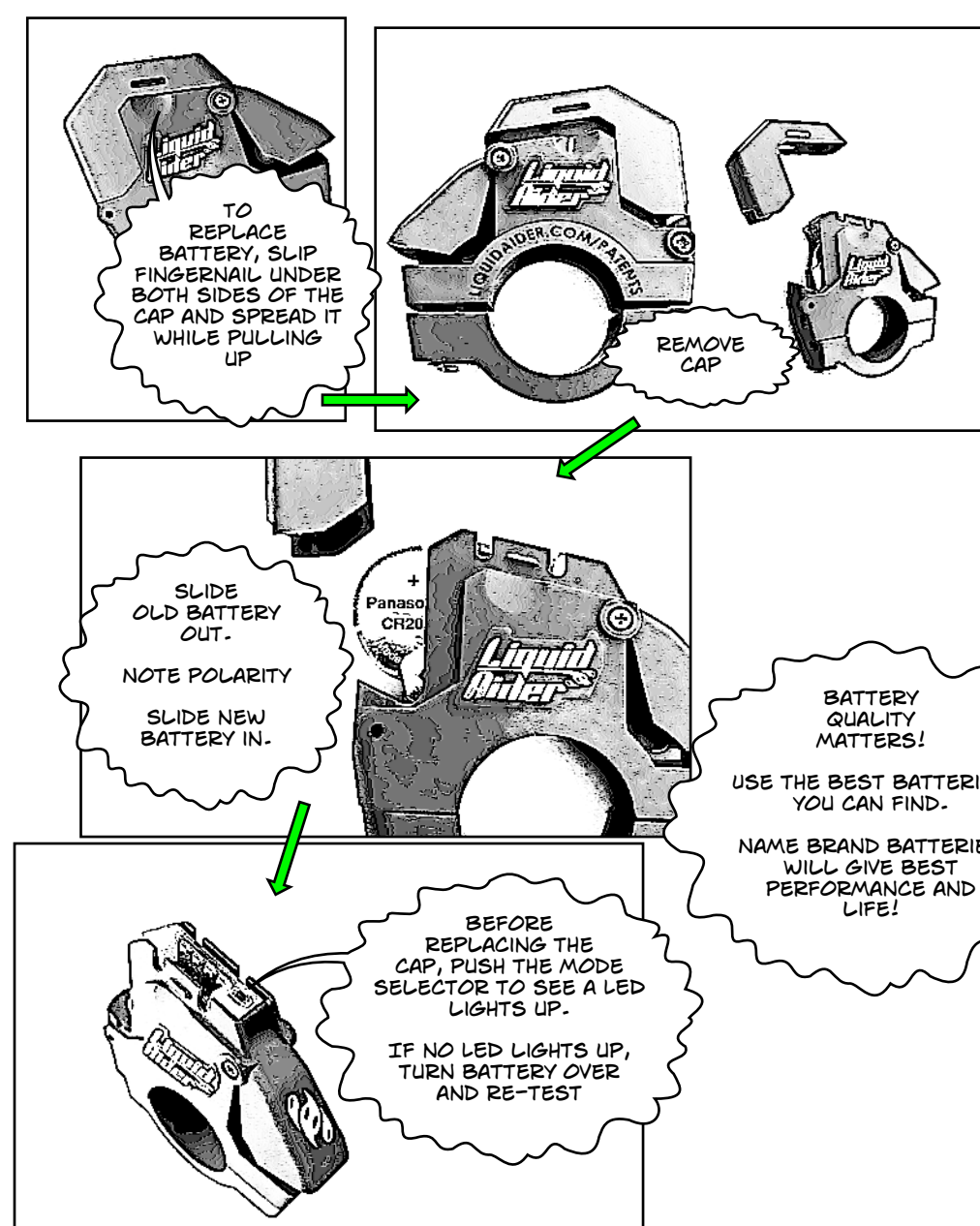

CHARGING PUMP BATTERY

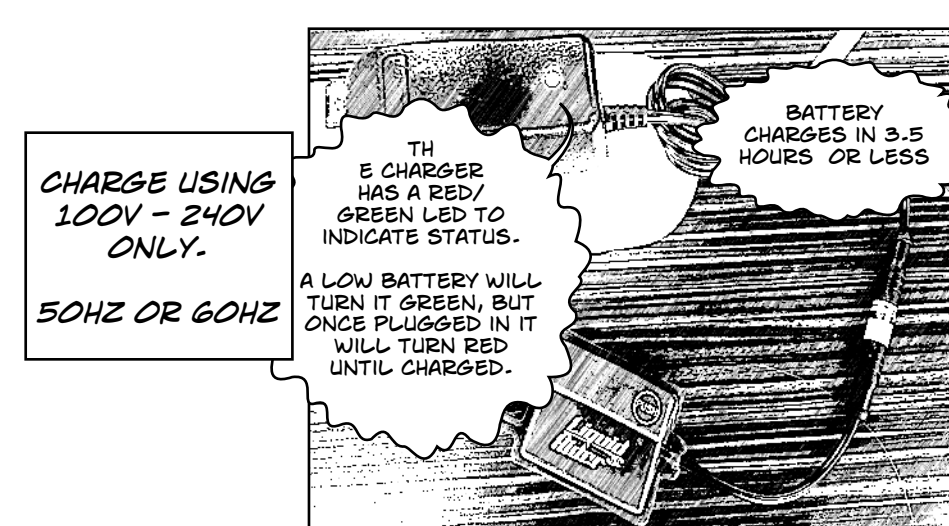

ONLY USE THE CHARGER SUPPLIED IN THE KIT!!

DO NOT LEAVE THE BATTERY IN THE SUN OR OTHER HOT ENVIRONMENT.

NEVER CHARGE A DAMAGED, DEFORMED, OR BULGING BATTERY.

DO NOT LEAVE BATTERY UNATTENDED WHILE CHARGING.

THE RISK OF FIRE AND EXPLOSION IS REAL!!

DO NOT LEAVE THE BATTERY AND CHARGER CONNECTED WHEN NOT CHARGING!

IT WILL DRAIN THE BATTERY EVENTUALLY!

SPARE BATTERIES AND CHARGERS ARE AVAILABLE ONLINE AT LIQUIDAIDER.COM

PAIR PUMP TO BUTTON

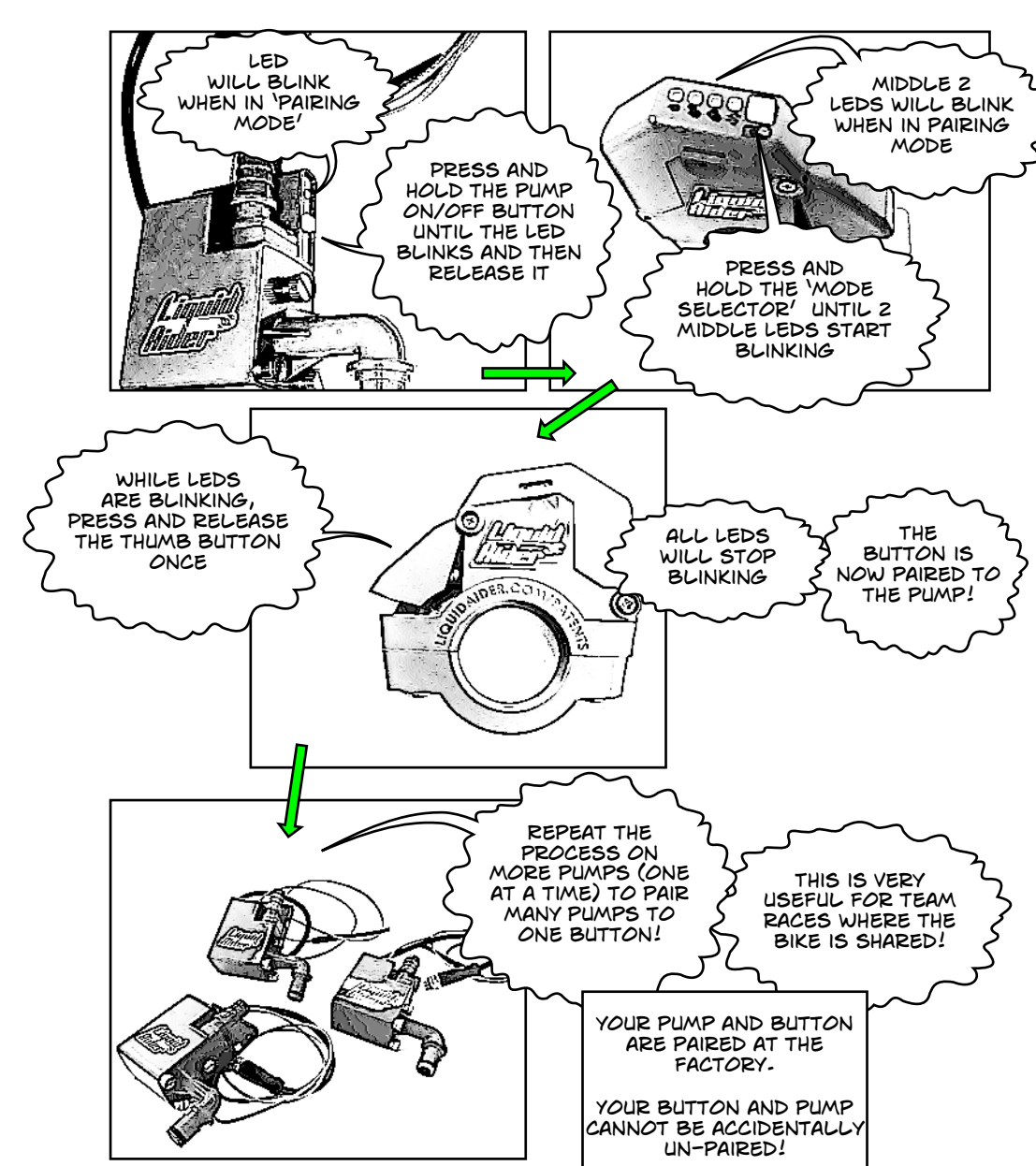

WARRANTY

We offer a "Crash Replacement Program" on Guard, Button, and the Pump. Photo evidence of a broken part is required. Each part in the replacement program is 1/2 price of MSRP. "Crash Replacement" includes water damage and any cause whereby the product stops working. We reserve the right to withhold replacement until damaged part is returned. Shipping is not included on the replacement parts.

Our product guarantee is 90 days on the battery, battery charger, disconnect/backflow preventer, helmet clips, nozzles, tubes. This does not cover damage. We reserve the right to withhold replacement until damaged part is returned and inspected for damage and misuse. Shipping is not included on the replacement parts.

Defective button and pump is replaceable within 30 days on a case by case basis upon return and inspection. Misuse or damage is not covered except by the crash replacement program. If user damage is detected you will be offered a replacement under the "crash replacement program". Shipping is not included on the replacement parts.

The LiquidAider kit itself is returnable within 30 days, only if unopened, with seals intact, unused and original packaging is suitable for resale.

PLEASE NOTE: LiquidAider is splash resistant, but not guaranteed to be submersible! We did everything in our power to ensure that normal use in tough environments will not harm your button or pump. We have ridden in hard rain and dropped parts in streams. But as we cannot control your actions, we do not guarantee the product as "waterproof".

ALL RETURNS MUST HAVE A RETURN MERCHANDISE AUTHORIZATION (RMA) ISSUED BY US. WE WILL NOT PROCESS ANYTHING SENT TO US WITHOUT ONE.

Pump: LAP-001, FCC ID: 2ASWZ-LAP001, IC: 24916-LAP001

Button: LAB-001, FCC ID: 2ASWZ-LAB001, IC: 24916-LAB001

Battery: Model LABat-001, UN38.3 certified by Intertek AUG 2019

FCC, CE/RoHS, IC, UN38.3 CERTIFICATIONS ON FILE AT LIQUIDAIDER.COM/PAGES/CERTIFICATIONS

LiquidAider is a registered Trademark of Arapaho Technologies Inc.

4756 McKinley Drive, Boulder, Colorado. 80303 USA

Copyright Arapaho Technologies Inc. 2019

Patented and other patents pending