

Fixed Spindle Installation Instructions

Contents

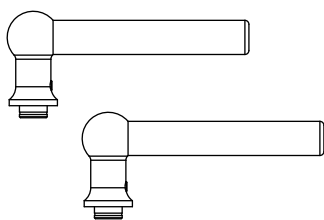

Handles



Wood Screws

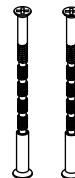

M4 Through Bolts

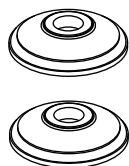

Roses



Thread Lock



Grub Screws

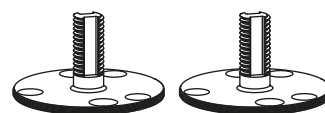

Fixed Spindles

Tools you'll need

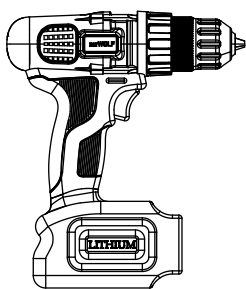

Drill

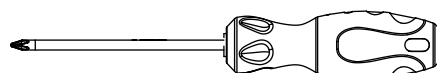

Cross head Screw Driver



8mm Drill Bit



2mm Drill Bit

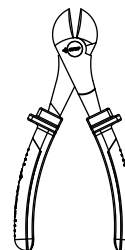

Pliers

Fixed Spindle Installation Instructions

1 Mark the centre lines and hole spacings on both sides the door. Make sure the they are vertically flipped on each side

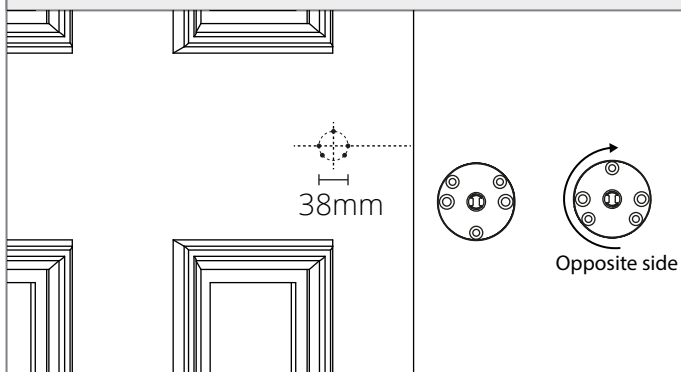

2 Drill holes through the door for the through bolts with the 8mm drill bit

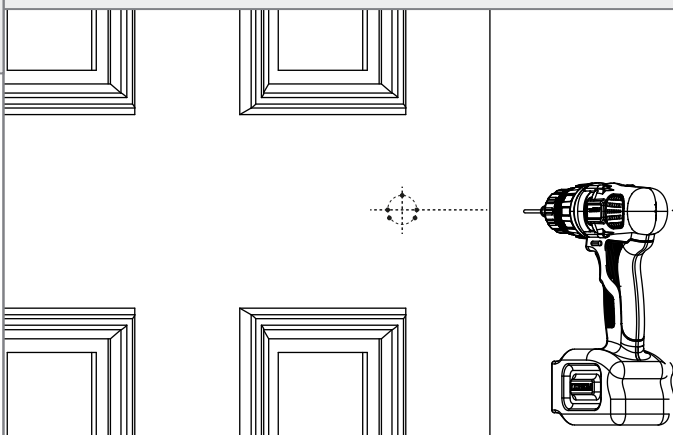

3 Drill pilot holes for the wood screws with the 2mm bit

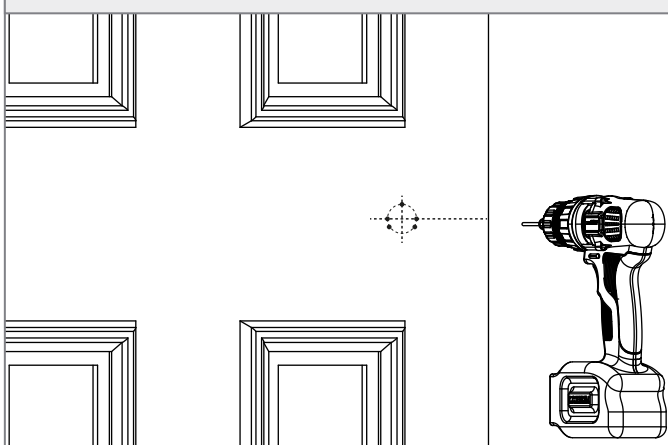

4 Clip snap off screws to size so that they are smaller than the depth of the door

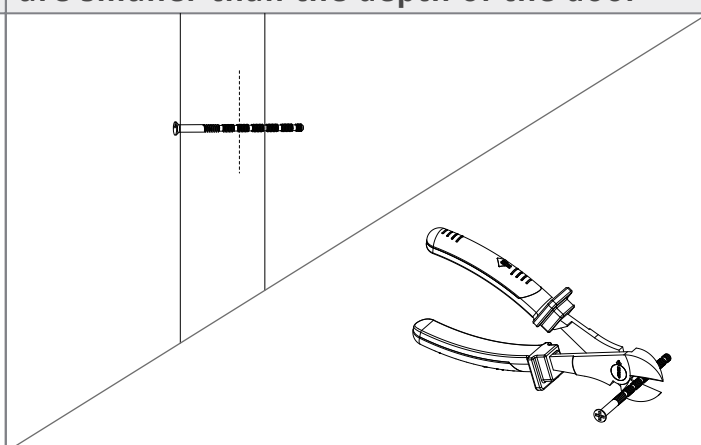

5 Screw the fixed spindles to the door with the through bolts

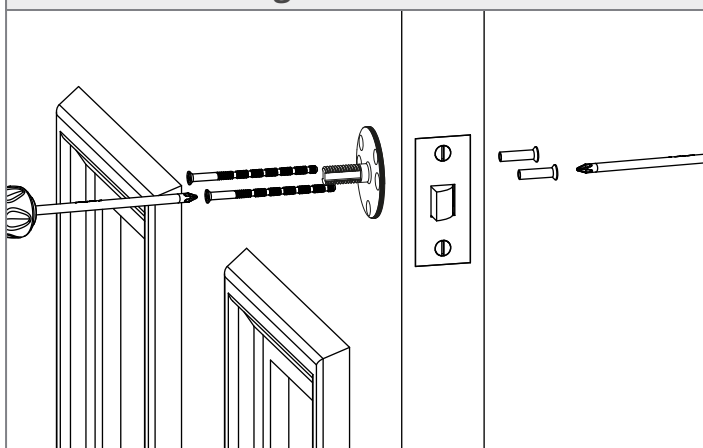

6 Drive the wood screws in to the door

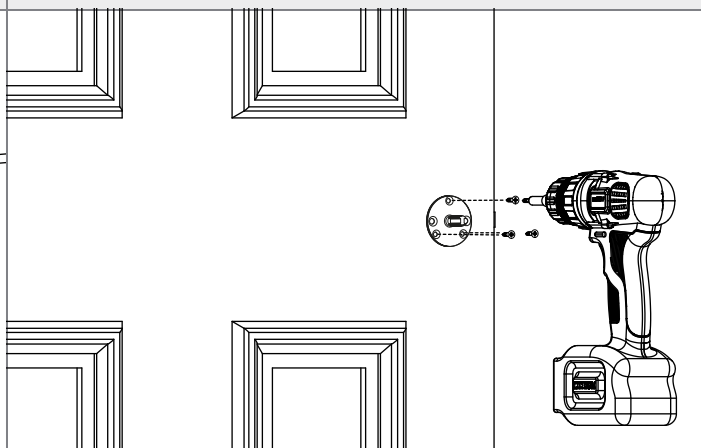

Fixed Spindle Installation Instructions

7 Screw the roses and the handles on to the Fixed Spindle

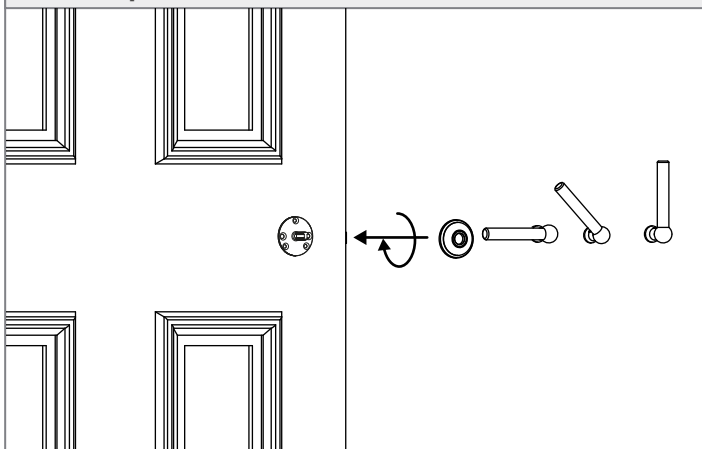

8 If after screwing the handle on there is a gap bigger than a 1mm between the handle and rose, use the washer to fill the gap

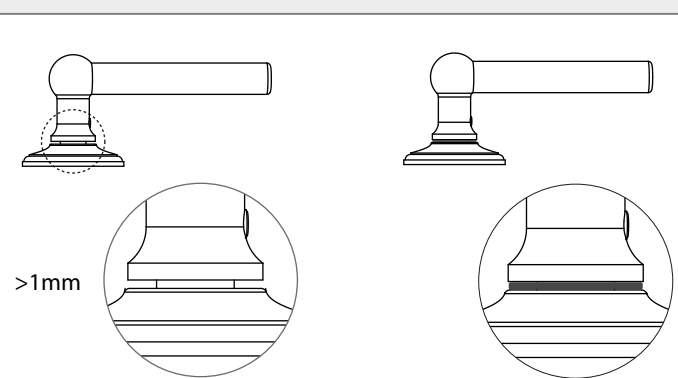

9 Replace the grub screw in the handle with the grub screws with pre-applied threadlock

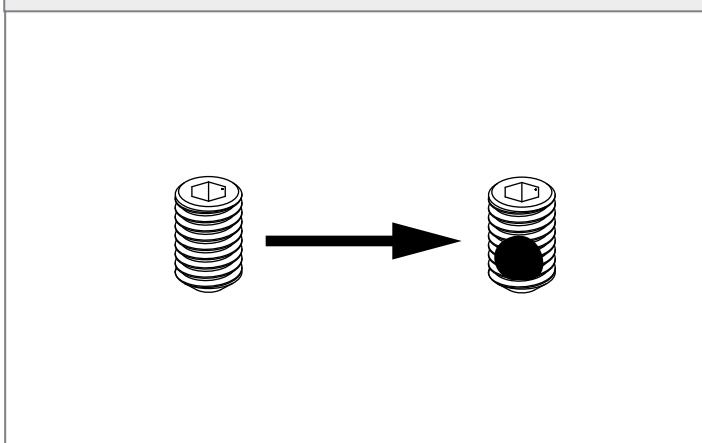

10 Screw the grub screw in to the handle and make it it is level

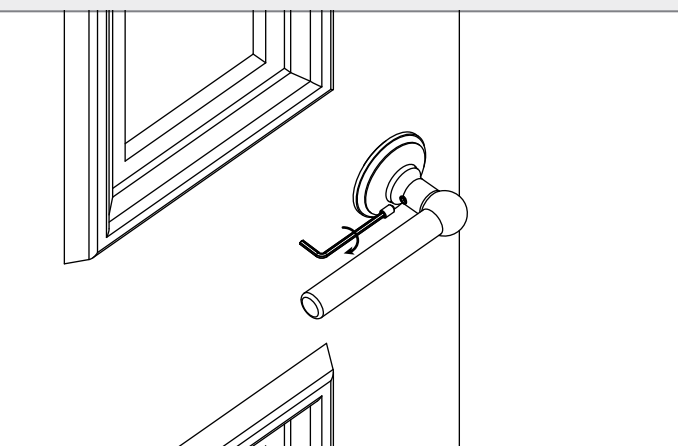

11 Wait 45mins for the threadlock to fully set

