

Furniture Handle Installation Instructions

Furniture Handle

Furniture handles are supplied with an M4 screw. If fitting handles to a door for the first time, a 5mm drill will need to be used.

For two screw handles, the hole positions are 128mm apart.

When replacing old handles, remove the existing handle. Then check that the door surface is in good condition for the new handle. Make good if necessary.

Pay attention to handles that have a spike on the back. – This is there to dig into the door surface and prevent it changing position over time. Press the handle into the door in the correct orientation and tighten the screw.

Do not turn the handle onto a stationary screw. – This is likely to damage the face of the door. Instead keep the handle in the correct position and tighten the screw with a screwdriver.

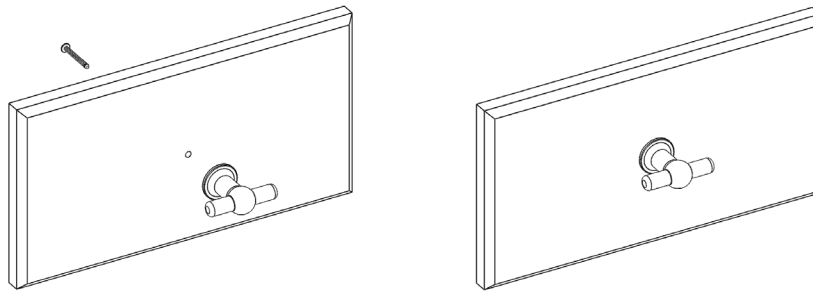

Care Instructions

Use mild detergent and a damp cloth to maintain the hardware, avoiding chemical cleaners. All finishes will age and develop over time.

Touching the hardware with another metal or hard object is likely to scratch and/or damage it. If brass chemical cleaner is used it will remove the protective lacquer. Only do this if an aged brass patina is desired.

Contact

If you have any questions or queries, contact the Corston team who would be happy to help