

Element Lite

OWNER'S MANUAL



Actual product appearance and functionality may vary from photographs, illustrations and descriptions included in this manual.

Table of Contents

Safety Precautions and Usage Statements	1-4
Parts List	5
Base and Remote Overview / Quick Reference Guide	6-7
Installation Guide	8-9
Remote Control	10-11
Remote Control - Preset Programming	12
Remote Control Pairing	13
Syncing Two Bases	14
Connecting Straps	15
Emergency Battery Backup Strap	16
Bluetooth® Remote Control Setup	17-18
Troubleshooting	19
Notes	20-21

Safety Precautions and Usage Statements

Attention: Important Safety Disclaimers

Read all instructions before using your adjustable base. Save these instructions.

WARNING

Always unplug the base from the electrical outlet before servicing any part of the base. To reduce risk of electric shock, unplug the base before cleaning. To safely disconnect, ensure the base is in a flat position with all motors off, and unplug from power source.

SAFETY:

TO REDUCE THE RISK OF SHOCK, BURNS, FIRE OR INJURY:

For optimal safety and operation, plug bed base into a surge protector (not included). The bed base should only be plugged directly into a wall outlet or surge protector (strongly recommended). Always unplug the base from the electrical outlet before servicing any part of the base. To reduce risk of electric shock, unplug the base before cleaning. To safely disconnect, ensure the base is in a flat position with all motors off, and unplug from power source. Keep the power cord away from heated surfaces. Never operate the base when the air openings are blocked. Keep air openings free of lint, hair and the like. Do not drop or insert any object into any opening. Discontinue use of the bed base and contact a qualified service center if: it has a damaged cord or plug, if it is not working properly, or it has been dropped into water. Only use this bed base for its intended use as described in this manual. Do not use accessories/ attachments that are not recommended by the manufacturer. Close supervision is required when the bed base is used by or near children, convalescents, disabled persons or pets. Improper connection of the equipment can result in the risk of electrical shock, electrical fire or faulty operation of this bed base. If the plug does not fit your outlet, contact a qualified electrician to install a suitable

outlet. Unauthorized modification or failure to use a wall outlet or surge protector could void the electrical portion of your warranty.

WARNING

- Keep bed in a flat position when not in use.
- Stay clear of moving parts while in motion.
- Before adjusting, make sure children and pets are clear of moving parts and are not under bed base.
- Do not allow children to operate bed base without adult supervision

PETS AND CHILDREN:

Immediately dispose of all packing materials as it may pose a smothering risk to small children and pets. To avoid injury, it is not advised to allow children and small pets to play on or under the bed. Children should not operate the bed base without adult supervision.

PACEMAKERS:

Some products contain Neodymium MAGNETS which may interfere with devices such as pacemakers, ICD's and any other device sensitive to magnetic fields. It is STRONGLY recommended that owners of such medical devices consult their physician prior to using products that contain Neodymium MAGNETS. It is also possible that some pacemakers may falsely interpret the optional massage feature vibrations as movement/exercise. This is a common occurrence with any product that creates a vibrating movement and may not affect the pacemaker. Please consult your physician before using the massage feature.

Safety Precautions and Usage Statements

! WARNING

For optimal safety and operation, plug bed base into a surge protector (not included). The bed base should only be plugged directly into a grounded wall outlet or surge protector (strongly recommended). Improper connection of the equipment can result in the risk of electrical shock, electrical fire or faulty operation of this bed base. If the plug does not fit your outlet, contact a qualified Electrician to install a suitable outlet.

IN-HOME USE AND HOSPITAL STANDARDS:

Ergomotion adjustable bed bases are designed solely for in-home use. This base was not designed as a hospital bed and is not designed to meet hospital standards. Do not use this base with TENT TYPE oxygen therapy equipment or near explosive gases.

ADDITIONAL SAFETY FEATURES

Casters (optional leg accessory) are equipped with locking wheels to prevent unwanted movement. Even when locked and unable to roll, it is possible for the casters to slide. Free release head and foot motors are designed to lower the mattress by retracting only with gravity, never pulling downwards, which minimizes pinch points.

ACOUSTICS

LIFTING/LOWERING MECHANISMS

The lift/lower feature will emit a minimal humming sound during operation. This is normal. During operation, the lift arm wheels make contact with the platform support of the base. This contact may result in metal on metal or metal on plastic contact. This applies slight tension on the moving components and resonance is reduced to a minimum level. If excessive noise or vibration is experienced, reverse the movement action (up or down) of the base with the remote control. This should realign the base's activating mechanisms to the proper operational

position. In normal base operation, the wheels which allow the bed to maintain its distance from the wall, will make contact with the steel platform supports of the base creating a contact noise. When entering, exiting or shifting weight on the base, this contact noise may be audible as the wheels make contact. This is normal.

MATERIALS

Ergomotion adjustable bases are constructed from various materials including woods, metals, plastics and fabrics. Tension, pressure or movement applied to the frame, platform or shroud through general use may create an audible sound.

MASSAGE OPERATION AND LOCATION ENVIRONMENT

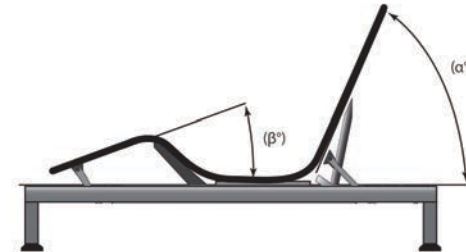

The massage feature will emit a tone during operation. This is normal. As the massage intensity level is increased, the tone will intensify. The volume of this tone is directly related to the location environment. For example, when demonstrated in a show room, the surrounding environmental noise will cover some of the massage noise. However, when installed in a home setting with wooden floors, carpeted or not, the massage volume will be more noticeable. To minimize this resonance, place a piece of carpet, or rubber caster cups, under each leg or caster of the base. It is possible to experience vibration or noise from the exterior bed frame, headboard brackets, headboards or footboards if mounting bolts are not

Safety Precautions and Usage Statements

firmly tightened.

Levels 1-3 massage intensity represent the amount of electrical power delivered to the massage transducer. Level 3 provides the max power delivered to the transducers. Depending on the mattress material, thickness, and positioning of the user, the feeling of vibrations will differ. We encourage the user to find the massage intensity setting that suits them best.

TOLERANCE

All Ergomotion adjustable foundations, depending on make and model, are designed and manufactured to perform and function within designated quality control parameters. Bases are subject to meticulous and rigorous inspections during the quality control process to ensure bases will operate within these standards during normal operating use. Normal operating use is defined as the following: Adjustable foundation is to be operated with a mattress and load. Testing procedures require lifetime cycle tests with up to 120kg distributed load. The angle (designated “a” in figure 1) between the back section and the flat section for various configurations of the mattress support platform shall be $\pm 3^\circ$, which translates to a tolerance of up to $1\frac{1}{2}''$.

The angle (designated “b” in figure 1) between the flat section and foot section for various configurations of the mattress support platform shall be $\pm 3^\circ$, which translates to a tolerance of up to $\frac{3}{4}''$.

Any adjustable foundation deemed to be within these allocated tolerances is considered to have met the manufacturer’s quality control standards.

THAT “NEW PRODUCT” SMELL:

Some people notice a slight odor to their new adjustable base—this can come from our material manufacturing process. This smell is normal and usually disappears before the product reaches you. Sometimes, however, this smell may still be noticeable. It usually disappears after a few weeks, providing adequate ventilation of the product and the environment.

BREAK IN PERIOD:

You can speed up the break-in period by simply spending time in the adjustable bed through activities such as reading, watching TV or playing with the kids or grandkids. The extra movement will help the adjustable base respond to weight and temperature changes. Some of the materials in our adjustable bases such as the woods, metals and plastics used in the platform, frame and components are sensitive to moisture content and temperature and may make sounds in colder environments.

PAIRED OPERATION:

When operating a “paired” split base setup there may be a time latency up to 1.5 seconds between each bases articulation.

WEAR AND TEAR:

Wear and tear is damage that naturally and inevitably occurs as a result of normal use or aging.

FABRIC CARE:

To prolong the life of your fabric, protect from direct sunlight whenever possible. For spot cleaning, wipe area with a light damp sponge or vacuum with a soft brush attachment to remove particles. Keep at a minimum of 30cm (12 inches) away from direct heat sources. For a deeper cleaning, blot liquid spills with a clean dry cloth. Wipe with a clean cloth dampened with warm water. Do not wet excessively. A soft bristle brush may be used to remove ingrained soil. Avoid scratching by gentle brushing. Wipe with a clean cloth dampened with warm water to remove residues. Dry in shade away from direct heat. If persistent marks remain visible after cleaning, seek professional advice.

PRODUCT RATINGS:

The lift motors are not designed to operate continuously for more than [2] minutes in an [18] minute time period or approximately 10% duty cycle.

Safety Precautions and Usage Statements

Attempting to circumvent or exceed this rating will shorten the life expectancy of the product and may void the warranty. The massage motors are not designed to operate continuously for more than 30 minutes at a time. Please allow the massaging system to rest for 30 minutes after automatic massage shut off before restarting.

WEIGHT LIMITS:

This product is not rated to support weights in excess of 650 pounds inclusive of the mattress and bedding. The base will structurally support this weight, provided it is evenly distributed across the bed base. The adjustable base is not designed to support or lift this amount in the head or foot sections alone. Exceeding this weight restriction could damage the bed and/or cause injury and will void the warranty.

IMPORTANT DO'S AND DON'TS:

DO:

- Plug your adjustable base into a power surge protector.
- Evenly distribute weight when sleeping in a split setup. Uneven distribution of weight can cause the base to raise unevenly.
- Call Customer Service for any technical issues. Do not try to force the base down, this can damage the motors or frame.
- Use mild soap and water to clean your adjustable base if staining occurs.
- Keep in mind that adjustable bases are recommended to be used with adjustable friendly mattresses
- Lower to the flat (horizontal) position after use and in between presets.
- Register your warranty as soon as your adjustable base has been delivered.

DON'T:

- Sit on corners/edges of base, this may warp the frame, struts or foam.
- Tilt the base on its side. This can damage the legs and/or leg screws.

- Stand or jump on the adjustable base at any time, this can damage the frame and motors.
- Drag the base to move it. Dragging the base could damage the frame, strip the nut/bolts or break the legs. Purchase castors if you plan on moving your base routinely.
- Enter and exit the adjustable base with the head and/or foot in the articulated position. Enter or exit your adjustable in the flat (horizontal) position.
- Tinker with or modify base. This will void the warranty.
- Press down on the head or foot while actuated can damage frame and motors.

FCC Compliance:

This device complies with part 15 of the FCC Rules. Operation is subject to the following two conditions: (1) This device may not cause harmful interference, and (2) this device must accept any interference received, including interference that may cause undesired operation.

To comply with the FCC RF exposure requirements, no change to the antenna or the device is permitted. Any change to the antenna or the device could result in the device exceeding the RF exposure requirement and void user's right to operate the device.

Radio Frequency: 2.4 GHz

SAVE THESE INSTRUCTIONS.

Parts List

Before discarding the packing materials, ensure all the parts are accounted for.

All electronics and components that need to be installed are located in boxes under the base or attached to the frame.

(Remote varies based on model.)

- A) Wireless Remote Control and (3) AAA Batteries
- B) Legs (6) ♦
- C) Mattress Retainer Bar *
- D) Power Cord
- E) Power Supply
- F) Battery Backup Strap
- G) Sync-Cord †
- H) Connecting Strap †*
- I) C Clamps (2)
- J) Long Bolts (4), Washers (8), Nuts (4)
- K) 5 mm hex wrench (1), 13 mm wrench (1)

Misc. Parts (not included):

- Surge Protector
- 9 Volt Batteries

* These items are attached to the base for shipping purposes. Carefully remove from base and set aside.

† Only included in Twin Long and Cal King Split bases.

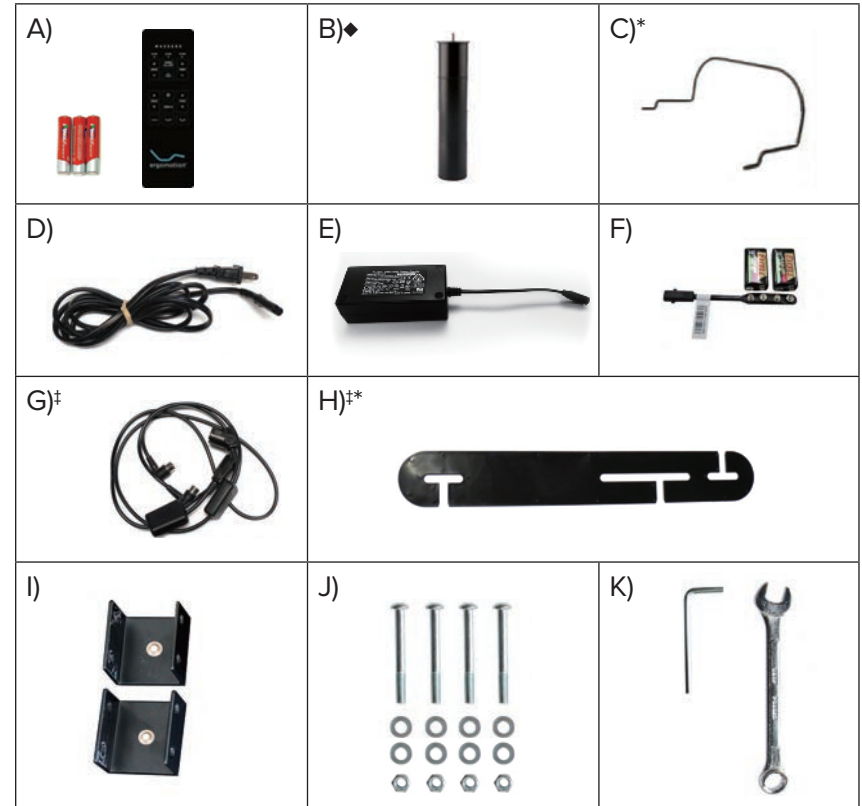

Base and Remote Overview

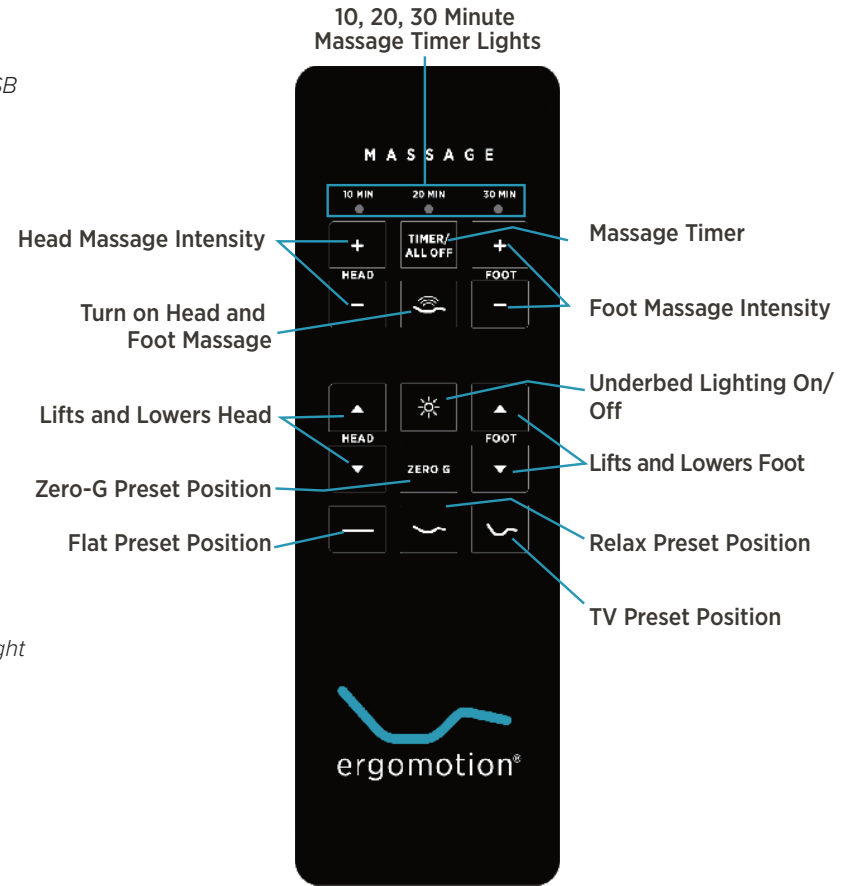
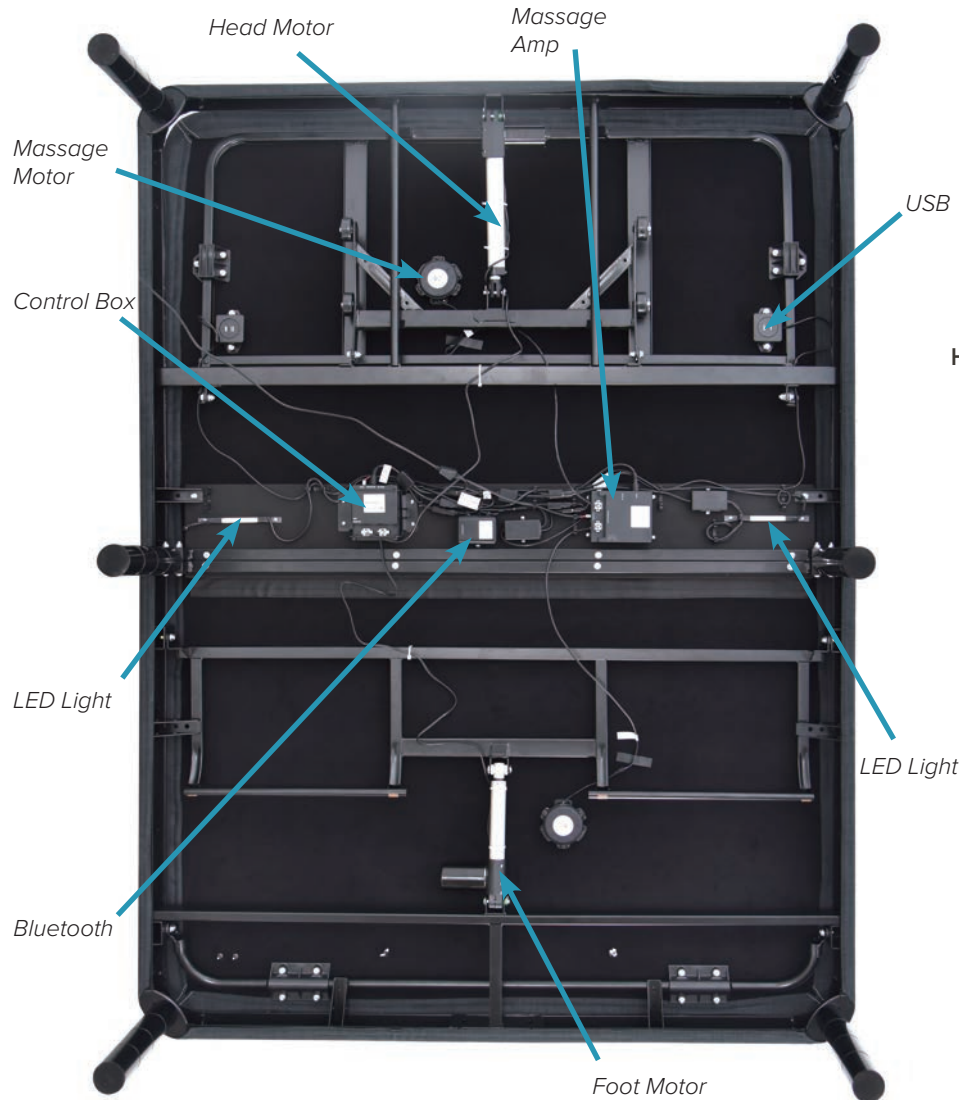

Quick Reference Guide

Not to scale. For illustration purposes only. Read all instructions before beginning installation.

CONTROL BOX OVERVIEW

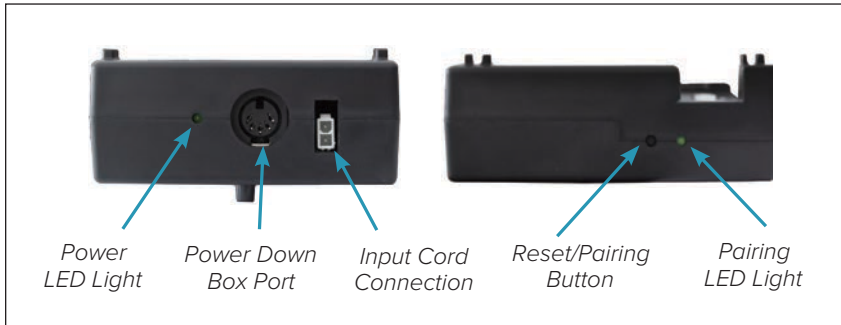

To remove control box, release metal clip and unplug cords.



ELECTRONICS OVERVIEW

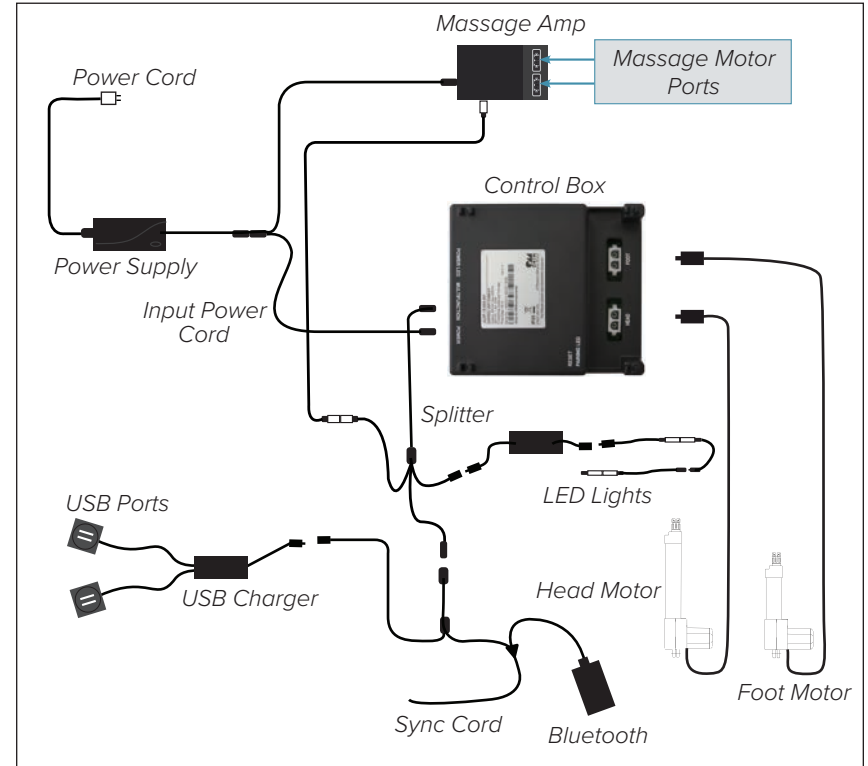

Installation Guide

Always use two people when setting up the base.

STEP 1

Place the bed base box in a desired location with the top of the box facing up. Remove the binding straps and packing materials, making sure not to puncture the box with any sharp objects.

STEP 2

Remove the bed base from the box and unfold the base, keeping the bottom-side facing up.



STEP 3

To secure the frames together, slide C-clamp over the frame connections (Refer to Fig A) in the middle of both sides of the base.

Fig A

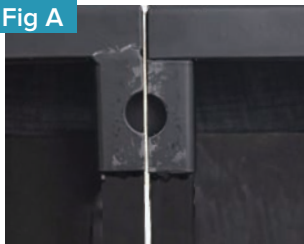
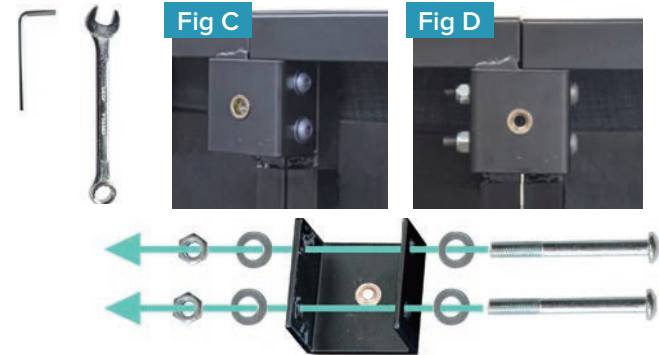

Fig B



STEP 4

Insert two long bolts through a washer before inserting them through the holes on the side of the C-Clamp. Secure the ends of the long bolts with another washer and a nut using the provided wrenches. Repeat this step for the other side of the base.



STEP 5 (Optional)

Legs will be installed on all four corners and on each C-Clamp in the middle (Refer to Fig D). To install the legs, thread the washer over the screw on the leg. Next, screw the leg into the nutsert on the frame. **Do not over tighten.**



Installation Guide

STEP 6

To sync two bases see detailed installation instructions on pages 14-15.

Locate the power down box and set it aside. Be sure that it is accessible after the base is set up.

STEP 7

Uncoil the input Power Cord (connected to Control Box's power port) and plug into Power Supply.



STEP 8

Uncoil the Power Cord and connect to the Power Supply. Place Power Supply on the ground and extend from the base. Ensure that the Power Supply and all attached cords are directed toward the desired surge protector.



STEP 9

Carefully flip the base over.

Important: Two people are required to move the bed base. Do not drag across the floor. Do not rest frame on its side, excessive pressure may damage the legs (if used).

STEP 10

Plug the power cord into a power source.
A surge protector is recommended.

STEP 11

Quickly test remote functions to verify proper setup before placing mattress on base. Return the base to a flat position before placing the mattress on top.

STEP 12

Install mattress retainer bars by inserting each end of the retainer bar into the holes at the foot of the base.



Setup is now complete! Test all functions on remote.

Remote Control

Remote Control arrives paired to the adjustable base.
Three (3) AAA batteries are required to operate the remote.

MESSAGE FEATURE



The HEAD + and - buttons adjust the head massage intensities. Levels 1-3.



The FOOT + and - buttons adjust the foot massage intensities. Levels 1-3.



The TIMER/ALL OFF button selects a 10, 20 or 30 minute message interval. Pressing a fourth time will turn off message.



The MESSAGE button activates head and foot massage to level 2. A second press turns message off.



The light on the top of the remote indicates a 10, 20 or 30 minute timer setting. Massage will automatically shut off after 10 minutes if the massage timer isn't set.

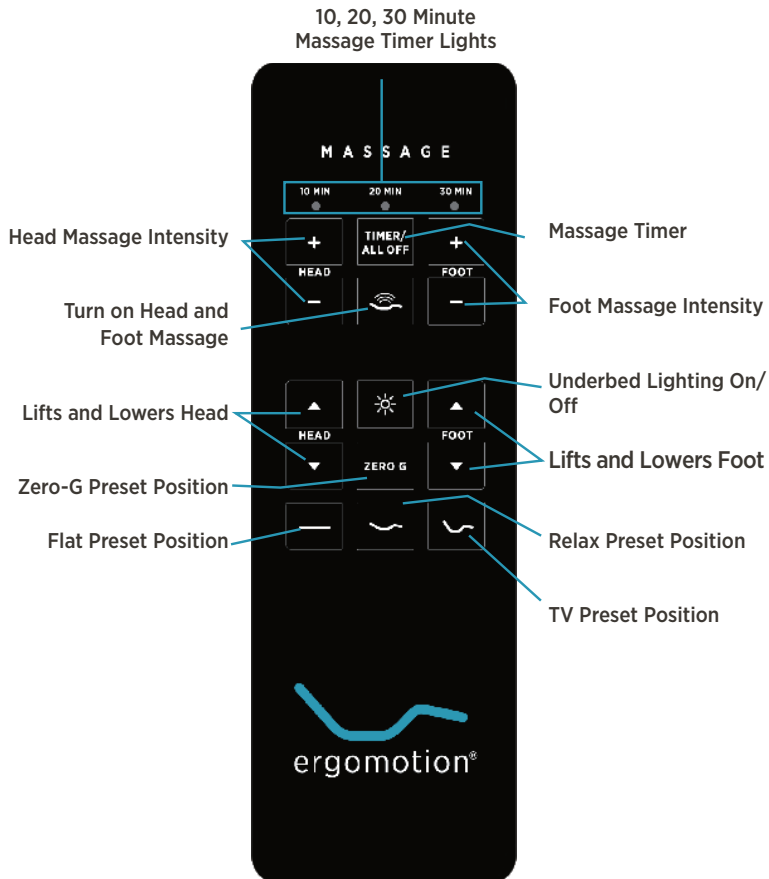
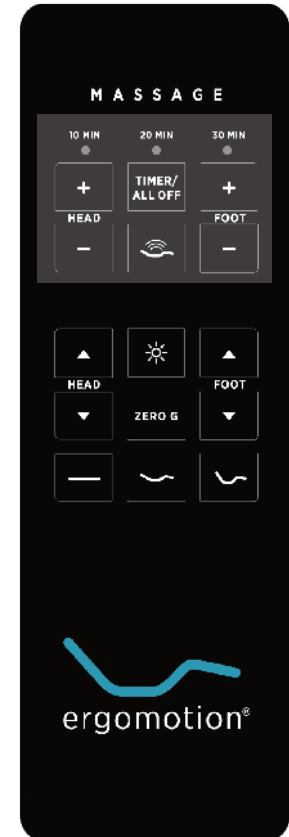

Remote Control

ADJUST

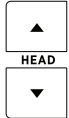

The HEAD ▲ ▼ arrows lift and lower the head section of the base.

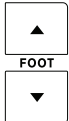

The FOOT ▲ ▼ arrows lift and lower the foot section of the base.

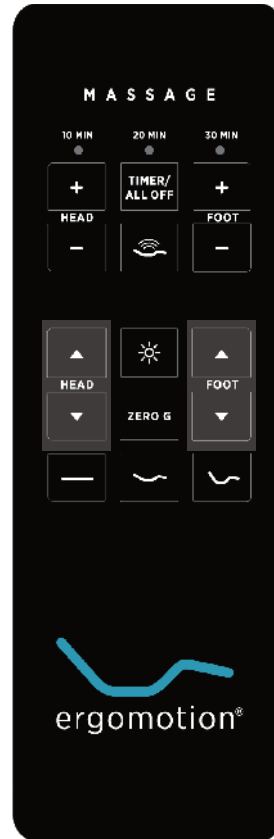

ONE TOUCH BUTTONS



One touch LIGHT button activates and turns off the safety lighting feature.



One touch ZERO G® preset position. Zero G® adjusts your legs to a higher level than your heart helping to relieve pressure off the lower back and promote circulation.



One touch FLAT preset position.



One touch RELAX preset position.



One touch TV preset position.





Remote Control - Preset Programming

The programmable feature allows you to save two custom positions.
Please read all the instructions below before setting your custom presets on the remote.

STEP 1

Articulate the head and foot to your desired position.

STEP 2

Press and hold one of the picture pre-set buttons
[ ] The LED lights at top of remote will flash in succession 3 times.
Position is now saved.

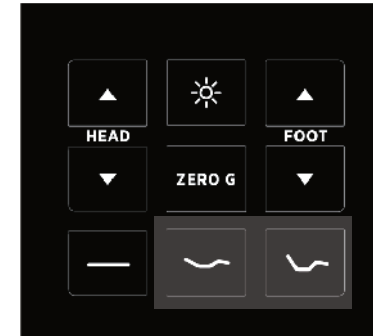

NOTE: To restore the preset buttons back to their original factory settings, hold **FLAT** and **ZERO-G** simultaneously for at least 5 seconds. The original presets will be restored.

To adjust the saved position, repeat steps 1 and 2 and the new position will be stored.

Remote Control Pairing

Remote Pairing

The original remote that comes in the box is already paired to the adjustable base. No further action is required. In the event that the remote is not paired with the base, follow the steps below.

STEP 1

Unplug the Power Cord from your power outlet. Wait 1 minute, then plug it back in to your power outlet. Perform Step 2 within 10 seconds, while the control box light is flashing.

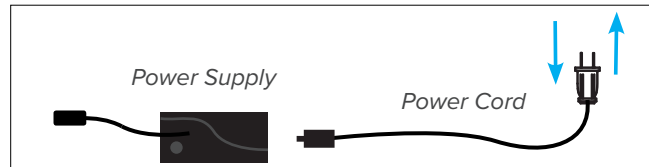

STEP 2

Press and hold the PAIR button on the back of the remote. The PAIR button will illuminate and start to flash. When the PAIR button stops flashing, the LED light on the control box will stop flashing. Release the PAIR button.

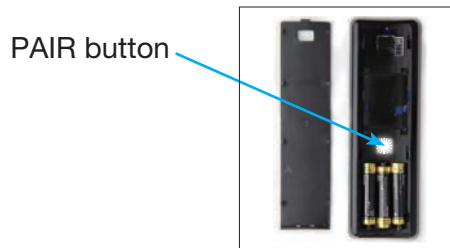

STEP 3

The remote is now paired to the adjustable base. Test all remote functions. If the remote buttons do not impact the adjustable base movements, please repeat the process again.

Syncing Two Cases (Optional)

A Sync Cord is included with the base. Not available on Queen, Full or Full-Long size bases.
The Sync Cord connects the two control boxes to a single remote for the synchronization of two bases.

STEP 1

Unplug bases from power source.

STEP 2

Connect the Sync Cord to the Multifunction port of each Control Box.

STEP 3

Plug the bases back into the power source.

STEP 4

Double click the Reset button on the control box.

STEP 5

Press and hold the Pair button on the back of the remote until the light stops flashing.

The system is now linked. Pressed buttons on either remote will control the two bases simultaneously.

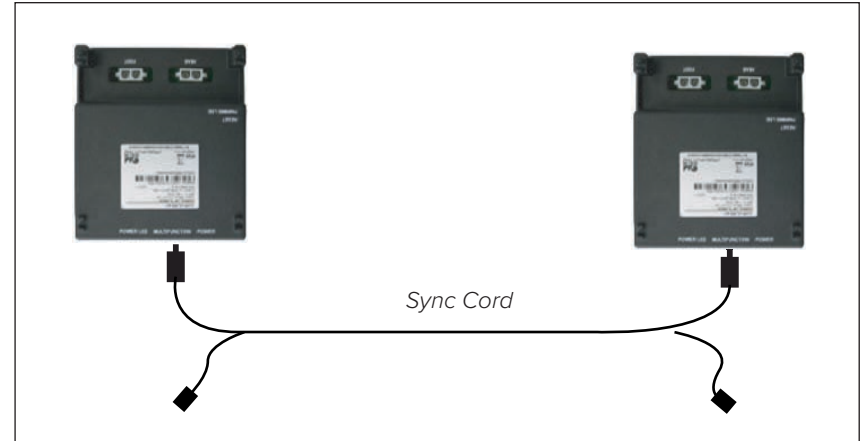

PERFORMANCE NOTES

If bases become mismatched, returning the bases to the flat positions will re-sync the mechanical positions.

Connecting Strap (Optional)

Connecting straps are secured to the base frame upon delivery.

Legs are required for the installation of the connecting straps.

STEP 1

Legs are required for the installation of the headboard brackets. To purchase legs, please contact **Ergomotion Customer Service** by calling 1-888-550-3746.

With the bases in their desired location, slightly loosen both legs to allow the strap to fit on the leg bolt, between the leg washer and frame.



STEP 2

Slide side (a) of the connecting strap onto leg bolt. Swing the strap and connect side (b) to the leg bolt. Secure the strap by shifting to the left.



STEP 3

Re-tighten legs. Do not over tighten. Use the remaining strap and repeat on other end of the base.

Emergency Battery Backup Strap

For emergency use only, in case of a power outage.

STEP 1

Disconnect the Power Supply from the input power cord.

STEP 2

Connect the Battery Backup Strap to the (2) Alkaline 9 Volt batteries. Do not mix brand name Batteries.



STEP 3

Connect the end of the Battery Backup Strap to the input power cord that is attached to the control box.

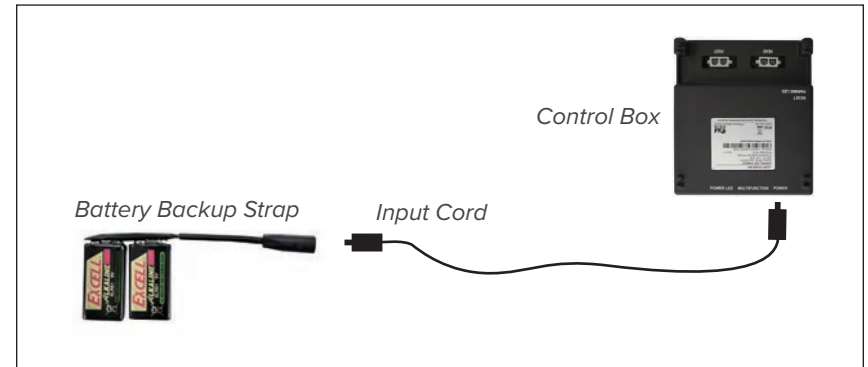

Note: Detach the Battery Backup Strap after the emergency is over, as the system will continue to draw power from the batteries even if not in use.

Bluetooth® Remote Control Setup

To operate the base from a smart device, the “ Ergomotion ” application must be downloaded to the desired smart device from the App Store (Apple) or Google Play Store(Android).

STEP 1

Plug the bed into power supply.

STEP 2

Open the menu by hitting the  button in the top left hand corner.



STEP 4

Once in Settings, please choose V4.0 Bluetooth version.

BEFORE YOU BEGIN THE PAIRING PROCESS, please make sure the blue indicator light on your Bluetooth® dongle is blinking, indicating that it is discoverable. If the blue indicator light is not blinking, please unplug your base from its power source (a surge protector is recommended) for 10 seconds and plug it back in.



STEP 3

Select **Settings**.

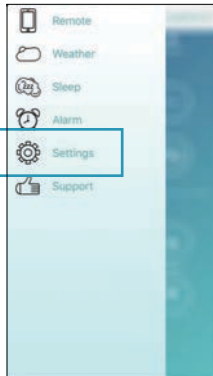

Bluetooth® V4.0 Pairing Instructions

1. Tap **Select Device**.
2. Select the device that begins with **BASE-i4#####**.
3. Once you are successfully connected, you will be brought back to the remote page and may now operate your adjustable base.

Bluetooth® Remote Control Setup

STEP 5

To choose the Remote style that most reflects the options on your physical handset, please cycle through options A-D. Selecting each option will prompt a pop up showing you an example of each remote style option and will give you the option to accept that style or not.

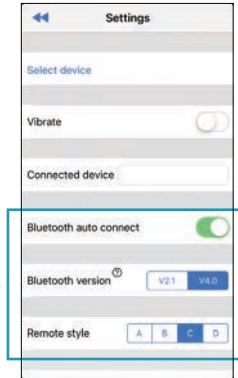

STEP 7

You can opt to have Bluetooth auto-connect by turning **Bluetooth auto connect** to the On or Off position.

You can choose to turn haptic feedback on or off by turning **Vibrate** to the On or Off position.



NOTES:

- If operating multiple bases: the Unique ID number will be listed on the sticker located on the adapter
- Press and hold RESET for 5 seconds to reset customized presets back to factory default settings.
- To disconnect: Turn off the Bluetooth® function on your device.
- For assistance establishing a Bluetooth® connection please refer to your device's owners manual or contact the manufacturer directly.

For assistance setting up a Bluetooth connection, refer to your smart device's owners manual or contact the manufacturer directly.

STEP 6

Once you have chosen the correct remote style please select the back button “” to go back to the remote screen.



Troubleshooting

- Check under the bed base to verify that the wired connections are secure and that there are no cords or bedding obstructing the movement of the base.
- Check to ensure the blue LED light is illuminated on the control box. If there is no light, verify that the input and power cords are properly connected.
- Unplug the base for 1 hour to reset the electronic components.
- Plug bed base into a different electrical outlet, or test current outlet with another working appliance (a grounded, electrical surge protector is recommended).
- Remove and replace full batteries in the remote control and re-pair the remote to the base (see page 13).

If issue is not resolved by following the instructions above, locate serial number on warranty card or back of remote and call

Ergomotion Customer Service: 1888-550-3746

US Customer Service

Phone US 1-888-550-3746
Fax US 1-805-979-9399
Email info@ergomotion.com
Web www.ergomotion.com

©2019 Ergomotion Inc
V001__12/2019
35009292

Serial Number:

+

+

+

+