

JENSEN[®]

EHT-909

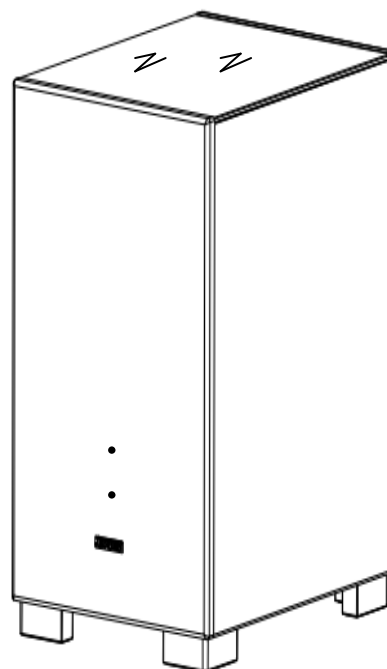

Your JENSEN EHT-909 is an extremely powerful Active Subwoofer powered by an on-board 280 Watt RMS amplifier. Twin 10" heavy duty "monster" drivers – one down-firing and one rear-firing will spread Bass throughout your room.

Floor Positioning: Best room location is in, or across a corner. Bass response can vary slightly as Subwoofer frequencies are mainly non-directional, and room acoustics may differ from one corner to the next. Therefore we suggest trying two or three locations before settling on a permanent location. This location of course, will need a Power Point.

Subwoofer amplifier features.

LEDs on front panel are Purple when active and Red when on standby. Standby mode, like on a TV draws next to no power.

OFF/AUTO/ON switch: Leaving your EHT-909 **ON** permanently will remain ON and continue to draw power and purple LEDs will continue to glow. Switch to **OFF** when not using for long periods or when on holidays (RED LEDs). We recommend switching to **AUTO** permanently so your EHT-909 will activate automatically when incoming signal is received (PURPLE) then revert to standby (RED) when signal is ceased. When powering down, it is not uncommon to take between 15 and 40 minutes for LEDs to revert to RED from PURPLE. AUTO can be left on indefinitely.



PHASE Switch: Once your entire speaker system is completely set-up, flick this switch from "0" to "180" and leave on setting that provides the most Bass. Leave switch on "0" if no audible increase is detected. If running multiple EHT-909's, ensure all are set to same position. This will ensure all woofers are operating together in the same room so that Bass cancellation does not occur.

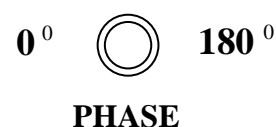

FREQUENCY Knob: This adjusts how low (in frequency terms) you wish your EHT-909 to operate at. In other words, 40 Hz is a way lower and deeper frequency than 100Hz. So if you set at say, 70Hz you will be amplifying all music **70Hz and below** and filtering out everything above which is the correct intention of a Powered Subwoofer. Take care not to advance this control too far as overloading may occur (see below setting recommendations).

VOLUME Knob: Advance this Volume control to harmonize your EHT-909 with Front / Center speakers etc. DO NOT set this on maximum (see below setting recommendations).

LOW LEVEL IN and OUT sockets: Connect to IN (red) socket from your AV Receiver. The OUT (black) socket is to connect additional EHT-909's using a 1RCA to 1 RCA lead. You may add as many EHT-909's as you are game (see page 3). You can buy these leads in 2,5 or 10 mtr lengths from our website.

Connections.

Option A. Using with AV Receiver in 5.1, 7.1, 9.1 etc.

Connect a 1RCA to 1RCA lead (available from our website) from SUB-OUT on your AV Receiver to LOW LEVEL IN (red socket).

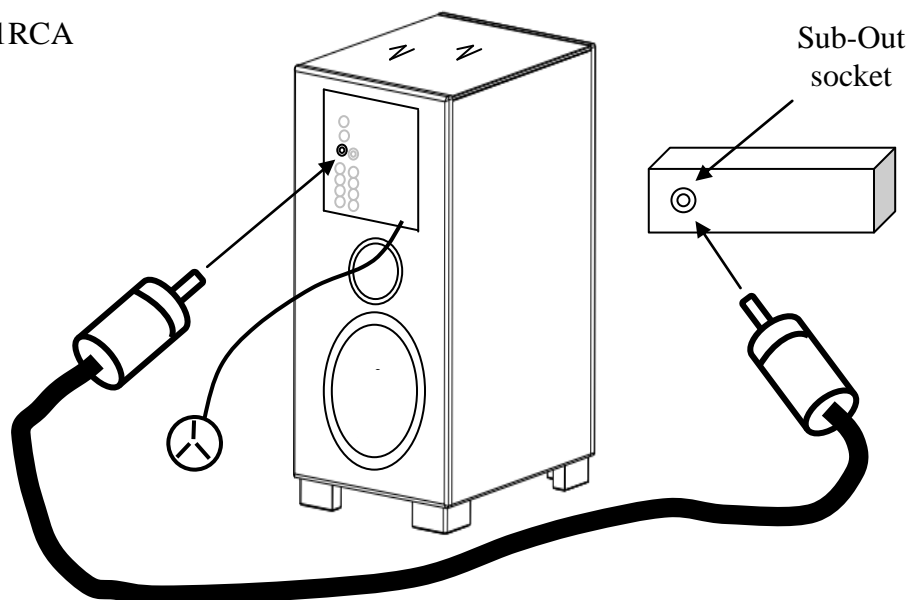

Option B. Using with Stereo amplifier.

To add an EHT-909 Subwoofer to your Stereo Speakers, run one pair Speaker Leads from your Stereo amplifier to HI LEVEL INPUT on EHT-909.

Then run another pair Speaker Leads from HI LEVEL to your existing Speakers. With EHT-909 set to "AUTO" your Subwoofer will activate and work in sync with your existing Speakers.

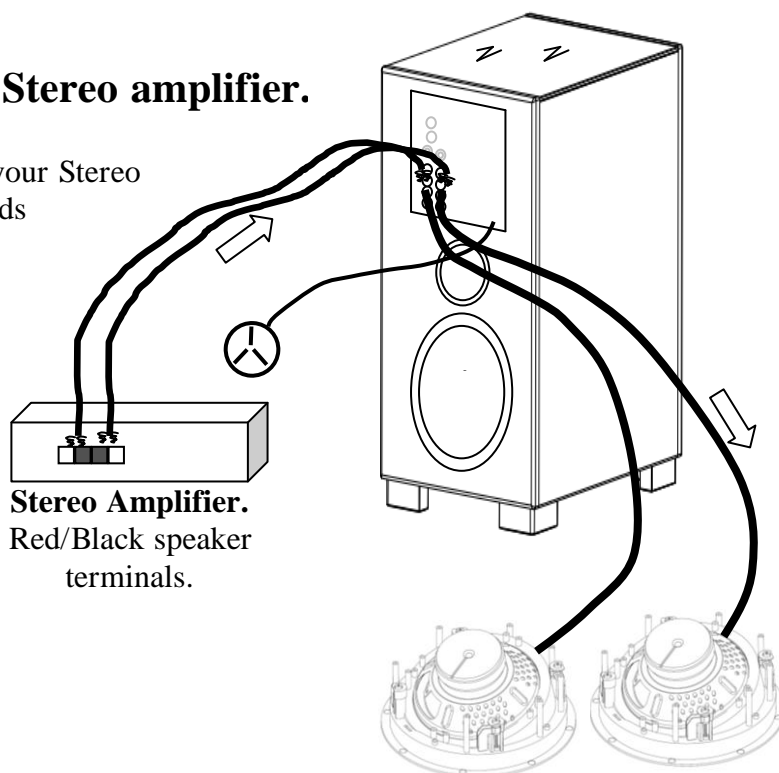

Note: there is no signal or power loss between amplifier and speakers, when "splicing-in" your EHT-909 Subwoofer.

Where should I set Volume & Frequency Knobs ??

Once you have your EHT-909 positioned and connected, we suggest experimenting with the Volume and Frequency knobs to suit the Volume and depth of Bass desired. Initially, try setting the **Volume knob at 1 o'clock** and the **Frequency at 9 o'clock (70Hz)**. This popular setting will boost Bass information 70Hz and below - which is deep, deep Bass at a strong (but not overpowering) level. This setting will suit 2-channel Stereo listening as well as Home Theatre so when dinosaurs, earthquakes and explosions kick-in, **they kick in !!** Refrain from turning Volume knob beyond 2 o'clock as Bass will then overpower all other music. Also, overpowering may incur amplifier damage, Cone damage or both.

Adding extra JENSEN subwoofers: With the purchase of a single 1RCA to 1 RCA lead (from our website) extra EHT-909's can be "daisy-chained" together to operate as one. All rooms have acoustic sweet spots as well as dead-spots. **Adding an extra EHT-909** will reduce the dead-spots as well as adding Bass resulting in exponentially enhancing overall Sub-Bass performance. **Switch them all to "AUTO"** and they will all activate together when an incoming signal is sensed. Add two, three or as many as you are game.

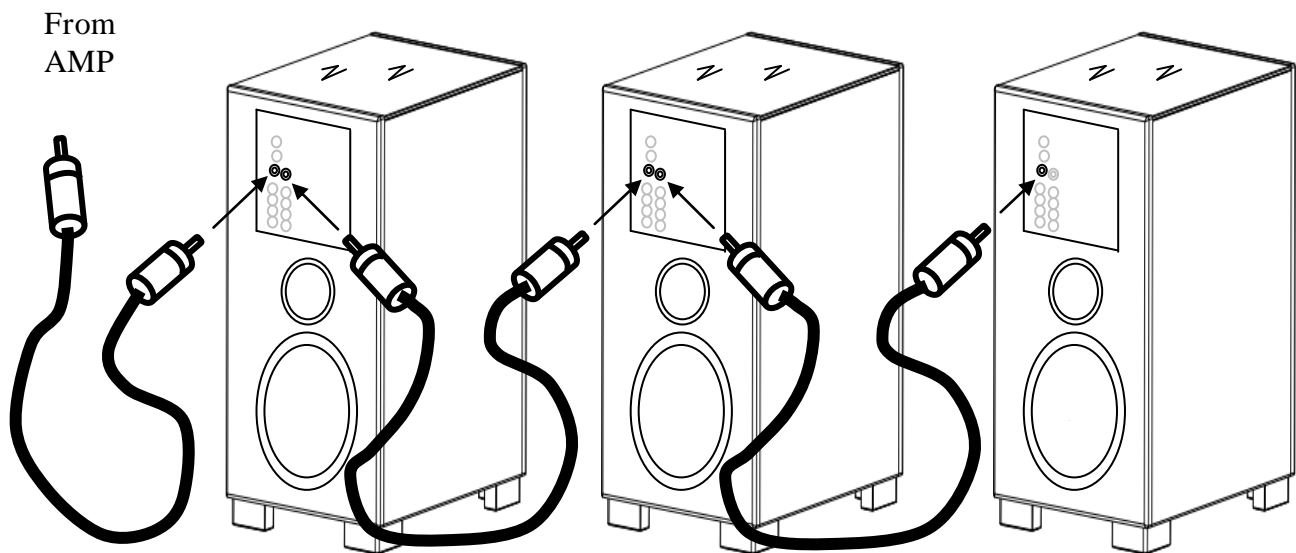

Warranty. Your EHT-909 is covered under **Warranty for 10 Years (amplifier module 1 Year)**. It is essential to register On-Line at [www.jensenspeakers.com.au / support / warranty](http://www.jensenspeakers.com.au/support/warranty) to validate your 10 Year Warranty. JENSEN Warranty database is vaulted confidential. For Warranty claim, please return this product back to your retailer or take directly to your closest Service Agent. To find closest Service Agent visit [www.jensenspeakers.com.au / support / service centres](http://www.jensenspeakers.com.au/support/service-centres).

Troubleshooting: Electrical storms and Power surges can blow the fuse of your EHT-909 Subwoofer. Symptom is no LED illumination on front panel (DEAD LED). Fuse holder is located at bottom of WD-280 amplifier module beside power input. Simply replace this with a **3.15 250V fuse**. Most hardware and electrical suppliers will have this standard type of fuse.

Specs:

Description	Power Output	SPL	Frequency Response	Driver	Dimensions	Kg	Colors	Warranty
Twin 10" 280W High-Powered Subwoofer	280 Watt RMS	BIG !	25-200Hz	Twin Monster 10" Sub Drivers	(H) 750 (W) 320 (D) 420/445	26 Kg	Matt Black w/Black Glass Top.	10 Years P&L (1 year on amp)

Notes:

*I must not forget to
Register Online
to validate my
10 Year Warranty
www.jensenspeakers.com.au*

**Customer Support: info@bdimports.com.au
1300-JENSEN (1300-536736) www.jensenspeakers.com.au**

Distributed in Australia by B.D Imports Pty Ltd. Victoria, Australia
under license from Audiovox, USA