

REVISIONS			
REV.	DESCRIPTION	DATE	APPROVED
A	INITIAL RELEASE	17/01/2019	C. SUTHERLAND

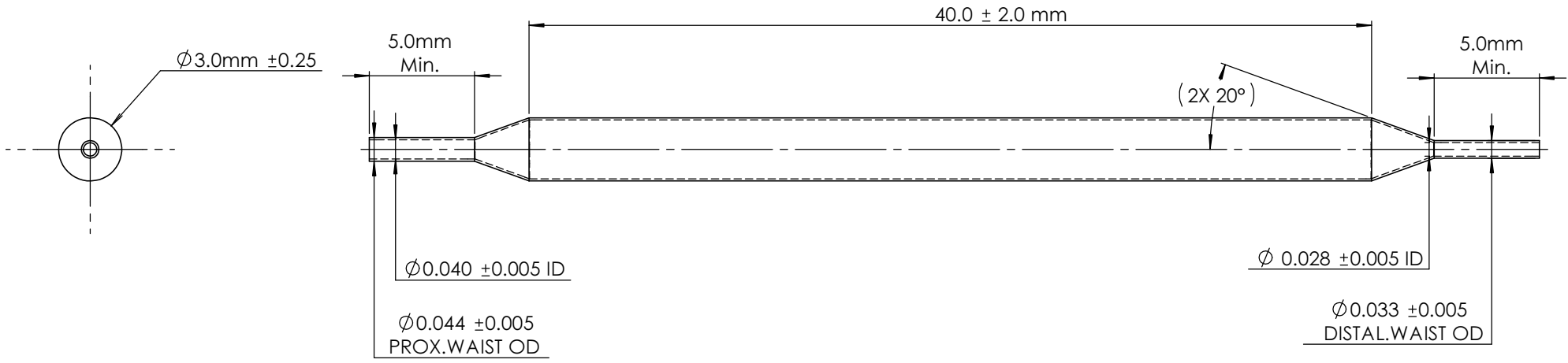

1. MATERIAL: CARE ML21.
2. BALLOONS ANNEALED FOR 1 HOUR AT 60C.
3. VISUAL INSPECTION: FREE OF VISUAL DEFECTS, FISHEYES AND GELS, NO PARTICALS GREATER THAN 0.5MM WHEN INSPECTED AT 12"-18" FROM EYE (100% VISUAL INSPECTION).
4. DIMENSIONAL INSPECTION:
 - 4.1 WALL THICKNESSES TO BE MEASURED WITH DROP GAUGE.
 - 4.2 LEG ID TO BE MEASURED WITH PIN GAUGES.
 - 4.3 LEG OD TO BE MEASURED WITH DROP GAUGE USING PIN GAUGE IN LEG ID TO PREVENT COMPRESSION.
5. COMPLIANCE AND PERFORMANCE TESTING:
 - 5.1 BALLOON LENGTH TO BE MEASURED AT 0ATM WITH RULER +/-0.25MM.
 - 5.2 COMPLIANCE AND OD TO BE MEASURED WITH HBLT MODEL 1000 IN WATER @37C.
 - 5.3 RATED PRESSURE AND AVERAGE BURST PRESSURE MEASURED WITH HBLT MODEL 1000 IN WATER @37C.
 - 5.4 PRODUCT NOT TO EXCEED THE RATED BURST PRESSURE (95%-99%) WITH AN AQL OF 1.0.
6. PACKAGING:
 - 6.1 PRODUCT WILL BE DOUBLE PACKED LABEL INFORMATION ON INNER PACK.
 - 6.2 PACKAGE WILL DISPLAY MANUFACTURERS LOT NUMBER, QUANTITY AND PART NUMBER.

RBP @ 99.9% RELIABILITY/ 95% CONFIDENCE	28.2 ATM
AVERAGE BURST PRESSURE	37.2 ATM
NOMINAL PRESSURE	8.0 ATM

NAME	SIGNATURE	DATE	 FIRST ANGLE PROJECTION	 Earnán™
DRAWN	B. Phelan	17/01/2019		
CHK'D	C. Sutherland	17/01/2019		
UNLESS OTHERWISE SPECIFIED: DIMENSIONS ARE IN MILLIMETERS			MATERIAL: CARE ML21	PROJECT: ONLINE STORE
			FINISH: Textured Finish	TITLE: 3.0x40mm TEXTURED BALLOON
				DWG NO. AME-N12-TB3040
				SHEET 1 OF 1
				REVISION A