

NEW WATER CONTROL VALVE - (TO FIT) ORIGINAL LID DESIGN

PLEASE NOTE - THESE INSTRUCTIONS ARE FOR USERS THAT HAVE PURCHASED THE ORIGINAL FRESH MINI (2019 VERSION) AND HAVE NOW PURCHASED THE NEW (2021) WATER CONTROL VALVE. THE NEW WATER CONTROL VALVE IS COMPATIBLE WITH THE ORIGINAL FRESH MINI, BUT REQUIRES SLIGHTLY DIFFERENT ASSEMBLY. PLEASE READ THE INSTRUCTIONS BELOW, OR CONTACT US AT WWW.COLAPZ.CO.UK SHOULD YOU REQUIRE FURTHER HELP.

ORIGINAL FRESH MINI LID DESIGN

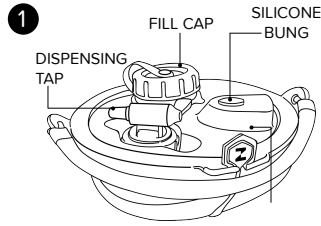

RELEASE THE RETAINING STRAP AND TWIST THE VESSEL INTO THE UPRIGHT POSITION.

TOP TIP! ADDING WATER AT THIS STAGE WILL SUPPORT THE VESSEL WHILE YOU ARE ASSEMBLING IT

NEW WATER CONTROL VALVE

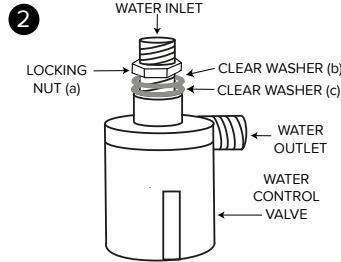

TAKE THE WATER CONTROL VALVE AND REMOVE LOCKING NUT (a) AND WASHER (b) BY UNSCREWING THEM FROM THE MAIN BODY OF THE VALVE. LEAVE WASHER (c) ON THE THREADED TUBE.

ORIGINAL BALL VALVE

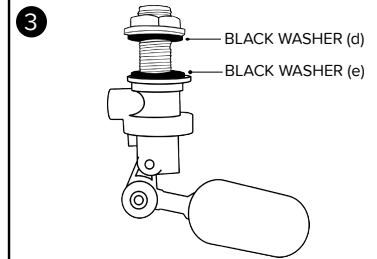

REMOVE BOTH WASHERS (d) AND (e) FROM THE ORIGINAL BALL VALVE. THESE WILL HELP PROVIDE ADDITIONAL CLEARANCE WHEN INSTALLING THE NEW WATER CONTROL VALVE

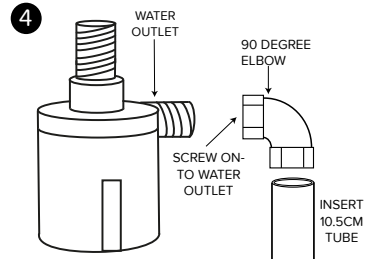

TAKE THE 90 DEGREE ELBOW AND SCREW TO THE WATER OUTLET. THEN PUSH THE 10.5CM TUBE INTO THE BOTTOM OF THE ELBOW. THIS WILL PREVENT ANY VIBRATION WHEN THE VESSEL IS RE-FILLING.

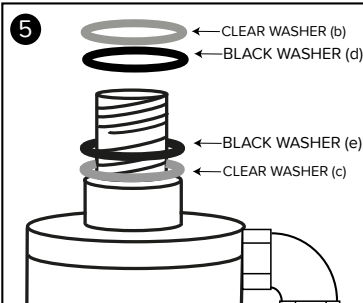

ENSURE THE BLACK WASHERS (d) AND (e) ARE POSITIONED EITHER SIDE OF THE FRESH MINI LID FOR A WATERTIGHT SEAL. DO NOT FIT WASHERS (b) AND (d) AT THIS POINT

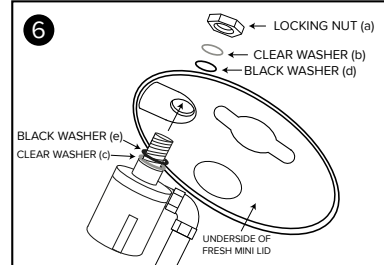

TAKE THE FRESH MINI LID AND INSERT THE WATER INLET TUBE INTO THE HOLE AND PUSH WASHERS (b) AND (d) ONTO THE WATER INLET TUBE AND TIGHTEN LOCKING NUT (a) UNTIL THE WATER CONTROL VALVE IS SEALED ONTO THE LID. CONNECT TO MAINS WATER

ONCE THE MAINS WATER IS TURNED ON THE VESSEL WILL FILL TO APPROXIMATELY 7 LITRES AND THE VALVE WILL AUTOMATICALLY SHUT OFF AND REFILL AS THE WATER IS USED. THE VALVE WILL NOT COME INTO CONTACT WITH THE SUBMERSIBLE PUMP