

 **Bellucci**
Slim Latte
Automatic Coffee Machine

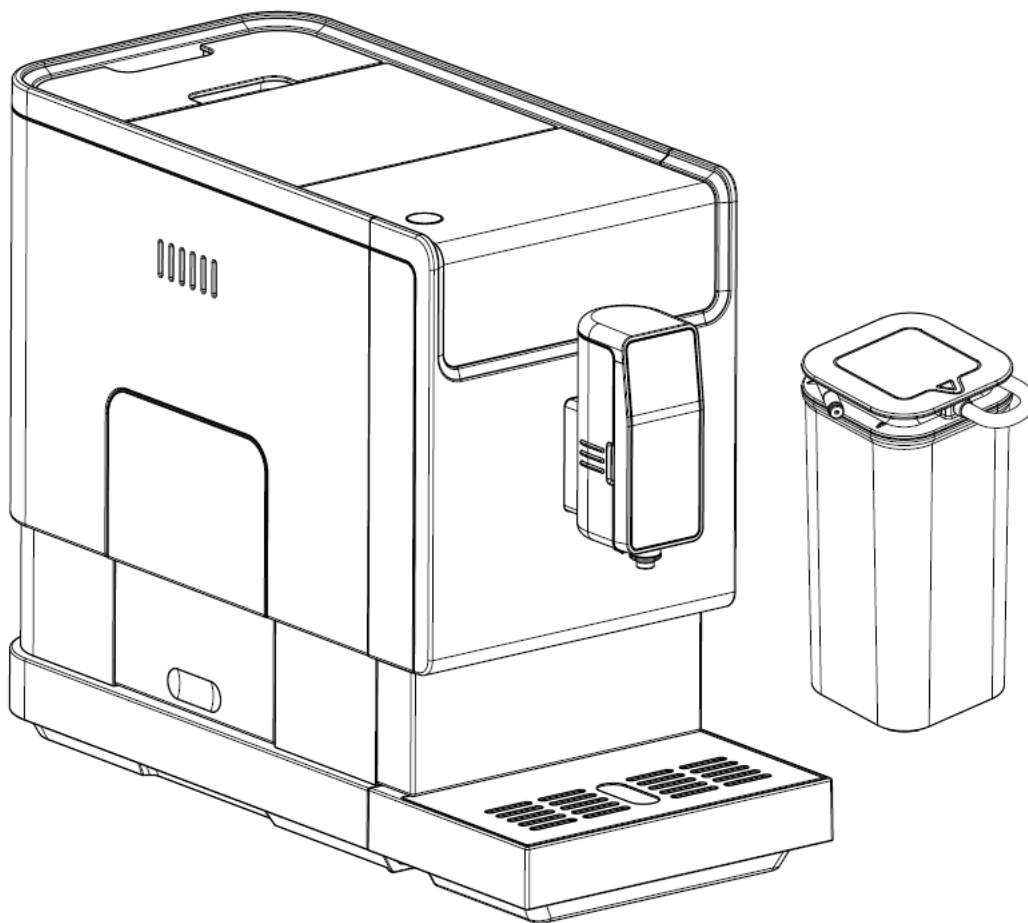

Instruction Manual

SAFETY PRECAUTIONS

These important safety precautions are critical part of the appliance. Please read them all carefully before using the appliance for the first time. You may keep the instructions for future reference or pass it to other users.

The appliance is designed for domestic use and may only be operated in accordance with these instructions for use.

Always handle with care and warn other users the potential danger.

DANGER: Misuse of the appliance can cause injury!

DO's

1. Check the mains voltage stated on the rating plate corresponds to the local electricity supply.
2. Unwind and straighten the power cord before using the appliance.
3. Place the appliance on a firm and steady surface.
4. The appliance must be used and rested on a stable surface.
5. Disconnect the appliance from mains supply outlet under the following conditions:
 - a. Before the water tank is filled with water
 - b. Before removing any parts from the appliance or refit any parts on the appliance.
 - c. Before cleaning or maintenance
 - d. When the appliance is not working correctly
 - e. After using the appliance
6. Empty the water tank, when the appliance unused for long period
7. Allow to cool before putting on or taking off parts, and before cleaning the appliance.
8. Always use cold water to make coffee. Warm water or other liquids could cause damage to the coffee maker.
9. If the power cord is damaged, it must be replaced by the manufacturer or its service agent or similarly qualified person in order to avoid any hazard.
10. Use the grinder for grinding coffee bean only.
11. Children shall not be playing with the appliance.
12. Always disconnect the appliance from the supply if it is left unattended and before assembling, disassembling or cleaning.
13. Appliance can be used by persons with reduced physical, sensory or mental capabilities or lack of experience and knowledge if they have been given supervision or instruction by a person concerning use of the appliance in a safe way and understand the hazards involved.
14. This appliance shall not be used by children. Keep the appliance and its cord out of reach of children.
15. This appliance is designed for household use only.

DO NOT's

1. Do not allow children to touch the appliance or the power cord during the operation
2. Do not use an extension power cord set unless competent authority has approved it.
3. Do not leave the appliance unattended, when it is connected to main supply.
4. Do not use the appliance in outdoor environment.
5. Do not use appliance for other than intended use.
6. Do not let cord hang over the edge of table or counter or touch hot surface.
7. Do not use or place the appliance on a wet or hot surface.
8. Do not use the appliance if the drip tray is improperly placed in position.
9. Do not immerse the appliance in water or any liquids.
10. Do not use the appliance when any parts of the appliance are damaged.
11. Do not use the appliance when it is not working properly.
12. Do not unplug the appliance by pulling the power cord.
13. Do not place the cord on a sharp edge of an item.
14. Do not attempt to open the main body or dismantle any parts from the appliance, there is no serviceable part inside.
15. 15. The appliances normally cleaned after use and not intended to be immersed in water for cleaning and the appliance must not be immersed
16. 16. The use of accessories not included in the box is not recommended. It might be dangerous and should be avoided.
17. 17. Do not place the appliance on or near hot gas or electric burner, or in heated oven.
18. 18. Do not operate the hot water function continuously for more than one tank of water.

A. Machine Overview

I. GENERAL DESCRIPTION

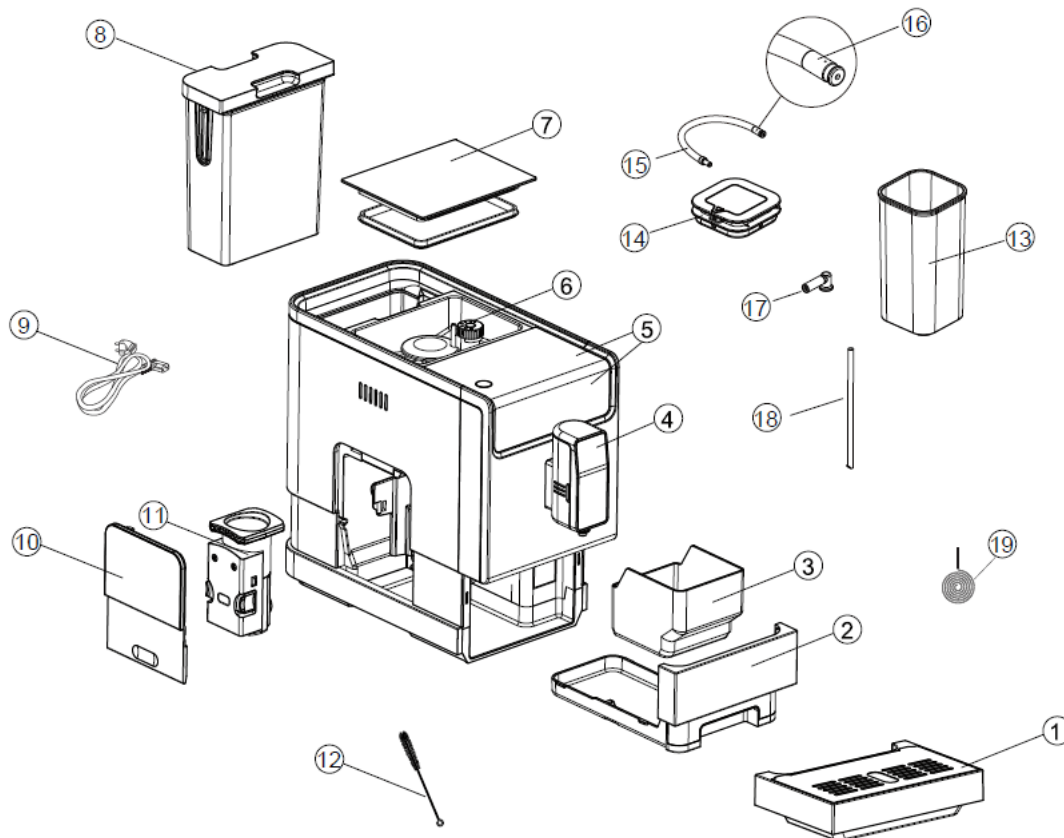







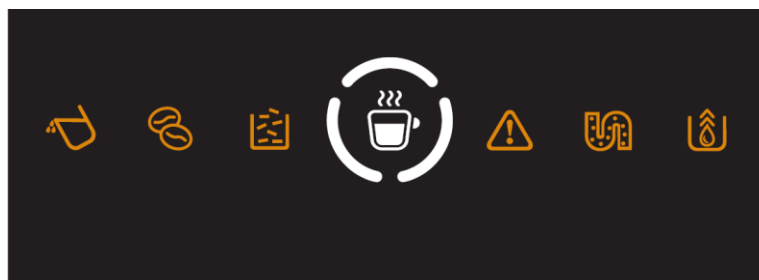
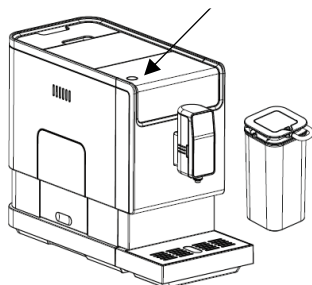





1. External Drip Tray	2. Internal Drip Tray
3. Coffee Grounds Container	4. Adjustable coffee spout
5. Control Panel	6. Coffee Bean compartment
7. Coffee Beans Container Cover	8. Water Tank
9. Power cord	10. Service Door
11. Brewer	12. Cleanness brush
13. Milk container	14. Milk container lid
15. Connection milk tube	16. Milk tube connector
17. Connection rubber	18. Container milk tube
19. Needle	

II. CONTROL PANEL& ON/OFF BUTTON

Power ON/OFF Button



	Flashing: Low water level/ Water tank missing
	Lack of bean
	Lights up stably: coffee grounds container is full Flashing: Internal Drip Tray/coffee grounds container is missing
	Lights up stably: Brewer is missing/ installed improperly Flashing: Service door is opened / installed improperly
	Lights up stably: Requires to do descaling Flashing: Descaling is under process
	Empty System Function is running
	Power ON/OFF Button
	Espresso Button
	Cappuccino Button
	Latte Macchiato Button
	Cleaning Button
	Hot water Button

ACCESSORY

In the box, three packs of cleaning agents are included for the process of self-cleaning.

MACHINE INSTALLATION

1. Choose a safe and stable surface with an easily reachable power supply and allow minimum distance from the sides of the machines (Figure 1).
2. Insert the external drip tray. Make sure it is inserted correctly.

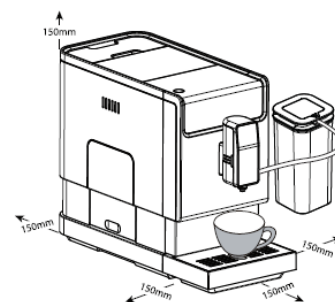

3. Lift the water tank by using the lid as the handle.

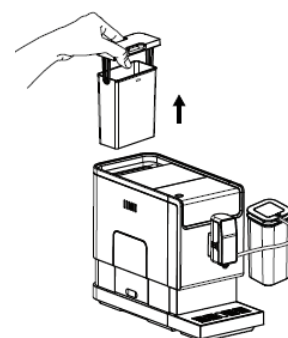
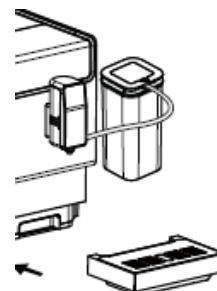

4. Fill the water tank with water to the Max level and place it back into the machine.

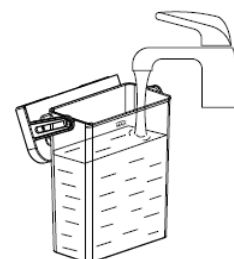

Note: To prevent overflow of water from the water tank, do not add water directly into the appliance with another container.

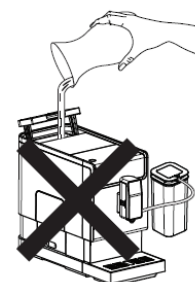

IMPORTANT: Never fill the water tank with warm, hot, sparkling water or any other liquid which might damage the water tank and the machine

5. Remove the bean container lid.



6. Fill the bean box with coffee bean.

IMPORTANT: Fill the coffee bean container with coffee beans only. Grounded coffee, instant coffee, caramelized coffee and any other objects may damage the machine



7. Install back the container lid.

8. Unwind and straighten the power cord and insert the plug into the socket located on the back of the machine. Insert the other end of the power cord into a wall socket with suitable power voltage.

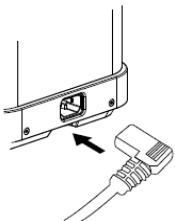

Espresso Americano preparation

1. Switch on the appliance by pressing the power on/off button and make sure the drip tray under the coffee spout and water tank with water inside. The appliance will perform auto-rinsing for a small cup of water, you can stop it by pressing Hot Water Button.
2. The appliance is then in the standby condition.
3. Place a cup under the coffee spout and adjust the height of the spout to fit the cup. Depending on the size of the cup (too tall or too wide) you can remove the drip tray or adjust the position of the drip tray as below:

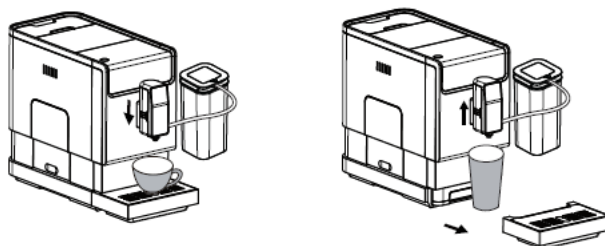

4. The Espresso or Americano button being pressed will light on and the illuminator will light up indicating that the appliance is preparing the cup of coffee.
5. When the appliance is back to standby condition, the coffee is ready to serve.

Tip: The auto rinsing would not appear if the appliance is just switch off for a while. You can deactivate this function by following steps and activate this function by same way.

Step1) remove the service door

Step2) press On/Off button until a bit sound appear.

Note: Press the hot water button to clean inside of the coffee maker before first use.

Preparing Latte Macchiato

Assembling the automatic milk froth system

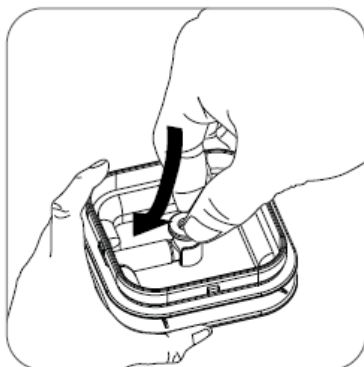

1. Place the connection rubber into the slot inside the lid

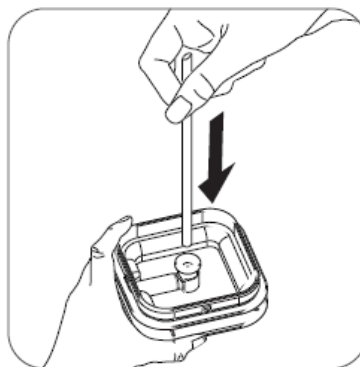

2. Insert the container milk tube to the rubber inside the lid.

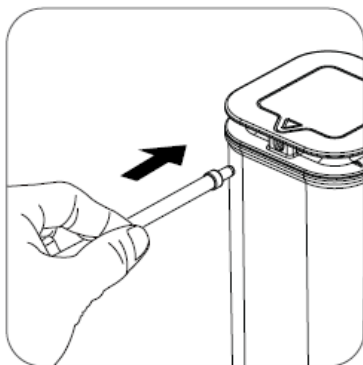

the rubber outside the lid

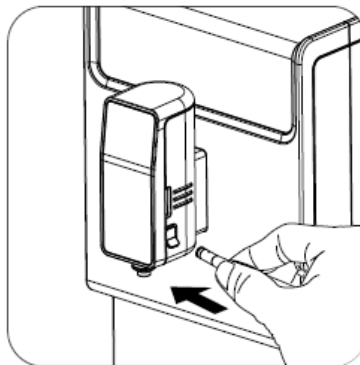

4. Insert the milk tube connector to the dispensing spout milk frother inlet (open the inlet cover first)

Note: There is a protective cover for the milk tube connector inlet, just take it off when you need to insert the milk tube connector

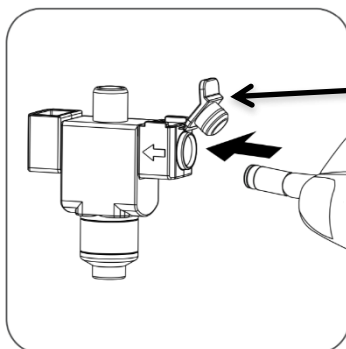

Protective cover

1. Fill the milk container with milk and close the lid. Switch on the appliance by pressing the power on/off button and make sure the drip tray under the coffee spout and water tank with water inside. The appliance will perform auto-rinsing for a small cup of water, you can stop it by pressing Hot Water Button
2. Place a cup under the spout
3. Press Latte Macchiato button, only Latte Macchiato button lights indicating Latte preparation. The indicator keeps on during preparation process.
4. The machine dispenses milk first and then coffee.
5. Preparation will stop automatically. If you want to stop, press the button again during the operation.
6. Remove milk container from machine and put it in the fridge.
7. After use, see chapter “Daily Cleaning of the appliance”, section *cleaning the automatic milk froth system*.

Note:

- *Cleaning the automatic milk froth system before first use.*
- *Use cold milk (at a temperature of approximately 5° C/41° F) with a protein content of at least 3% to ensure an optimal frothing result*

Warning:

- Steam and hot milk may spray out of the spout when starting the brewing.
- Place the connection milk tube around the milk container lid after use. Do not let it fall freely to prevent milk spray out caused by pressure difference

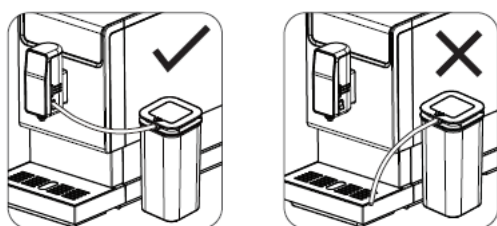

Preparing Cappuccino

Assembling the automatic milk froth system as described in preparing latte macchiato section.

1. Fill the milk container with milk and close the lid. Switch on the appliance by pressing the power on/off button and make sure the drip tray under the coffee spout and water tank with water inside. The appliance will perform auto-rinsing for a small cup of water, you can stop it by pressing Hot Water Button
2. Place a cup under the spout.

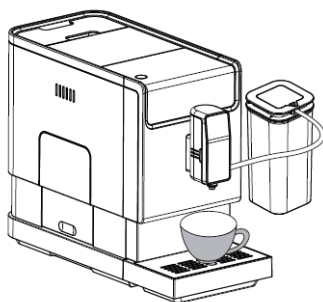

3. Switch on and press Cappuccino button, only Cappuccino button lights indicating coffee preparation. The indicator keeps on during preparation process.
4. The machine dispenses milk first and then coffee.
5. Preparation will stop automatically. If you want to stop, press the button again during the operation.
6. Remove milk container from machine and put it in the fridge.
7. After use, see chapter “Daily Cleaning of the appliance”, section *cleaning the automatic milk froth system*).

Note:

- *Cleaning the automatic milk froth system before first use.*
- *Use cold milk (at a temperature of approximately 5° C/41° F) with a protein content of at least 3% to ensure an optimal frothing result*

Warning:

- **Steam and hot milk may spray out of the spout when starting the brewing.**
- **Place the connection milk tube around the milk container lid after use. Do not let it fall freely to prevent milk spray out caused by pressure difference.**

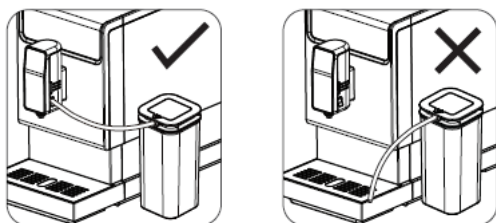

Preparing Milk Foam

Assembling the automatic milk froth system as describe in preparing latte macchiato section

1. Place a cup under the spout.

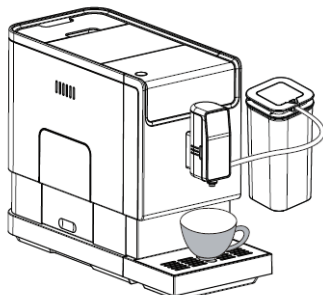

2. Fill the milk container with milk and close the lid.
3. Connect the milk froth system to the machine.
4. Press the Cleaning button  twice. The button light goes on during the preparation.
5. After use, see chapter “Daily Cleaning of the appliance”, section *cleaning the automatic milk froth system*).

Note:

- *Cleaning the automatic milk froth system before first use.*
- *Use cold milk (at a temperature of approximately 5° C/41° F) with a protein content of at least 3% to ensure an optimal frothing result*

Warning:

- Steam and hot milk may spray out of the spout when starting the brewing.
- Place the connection milk tube around the milk container lid after use. Do not let it fall freely to prevent milk spray out caused by pressure difference.

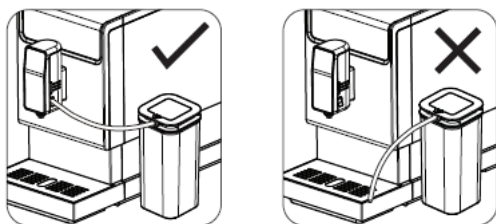

Hot water

1. Put a cup under the spout.
2. Press Hot water button, only Hot water button lights indicating the preparation. The indicator keeps on during preparation process.

DAILY CLEANING OF THE APPLIANCE

Timely cleaning and maintenance of the appliance is very important to prolong the life of the appliance.

Cleaning the drip tray and coffee grounds container

Empty and clean the drip tray every day.

1. Pull the external drip tray out of the machine.
2. Empty the water inside the drip tray in the sink and wash it with fresh water. Dry it afterwards.
3. Slides open the internal drip tray and the coffee grounds container.
4. Empty the coffee grounds container and rinse it with fresh water. Dry it
5. Place the coffee grounds container back in the drip tray.
6. Place the external drip tray at its original position.

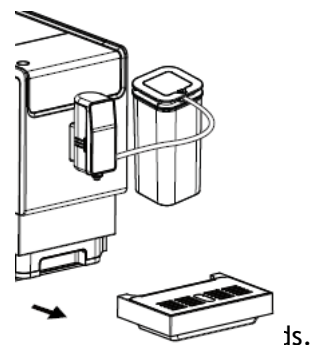



Tips: When  lights up, the coffee grounds container needs to be empty.

Cleaning the brewer

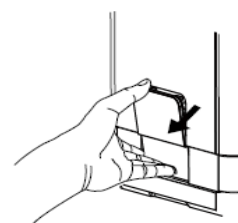
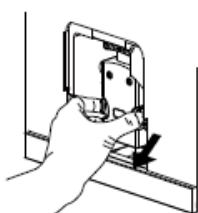
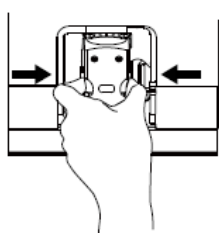
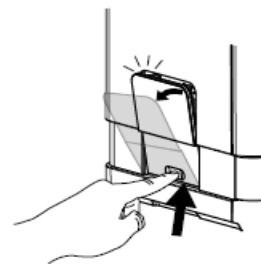
1. Slightly press the bottom of the service door to open it.
2. Remove the service door.
3. Press the release knob.
4. Remove the brewer and rinse it under tap.
5. Insert back the brewer to its original position and install back the service door in its original position.



Tips: When  lights up stably, it indicates that the brewer is missing / installed improperly. When  is flashing, it indicates that the service door is missing / installed improperly.

Note: When  is flashing, the coffee grounds container is missing

Cleaning the water tank

1. Lift the water tank out of the machine and clean it with fresh water.
2. Fill it with drinkable water up to the MAX level indication and place it back in the machine.

Cleaning the automatic milk froth system

Note: it is important to do this step daily to make sure the function of automatic milk frother running in good condition

1. Place a cup under the spout.
2. Fill the milk container with fresh water.
3. Connect the milk container to the coffee machine as describe in “*Preparing Latte Macchiato*” section
4. Press the Cleaning button .
5. The machine dispenses hot water and steam to wash the dispensing tube and milk spout.
6. Touch the button again to stop the water.
7. Take apart the milk frother by following procedure. Clean them with fresh water. Then insert the milk frother into slot. (see below step)

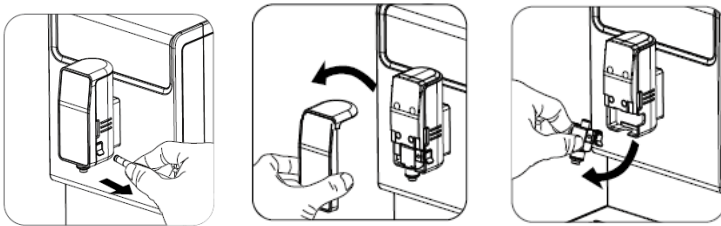

Step 1: take out the spout cover and then take out the milk frother

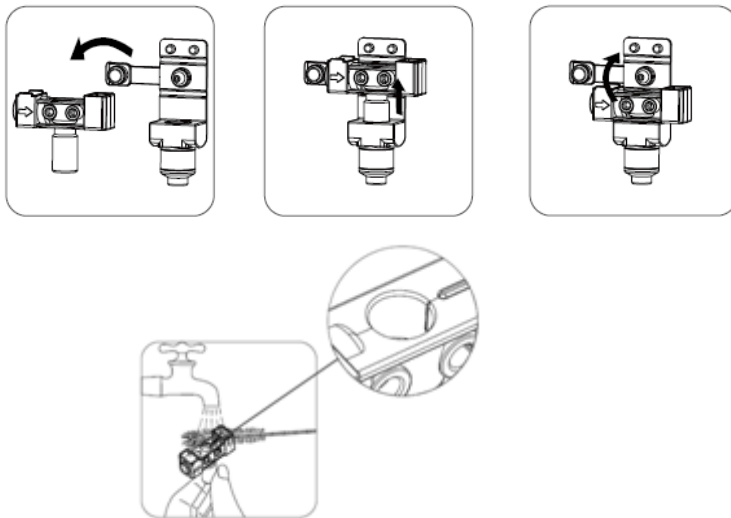

Step 2: Take apart the milk frother into two parts and clean with fresh water
You can use bristle of brush to clean the above circle area to ensure no residual

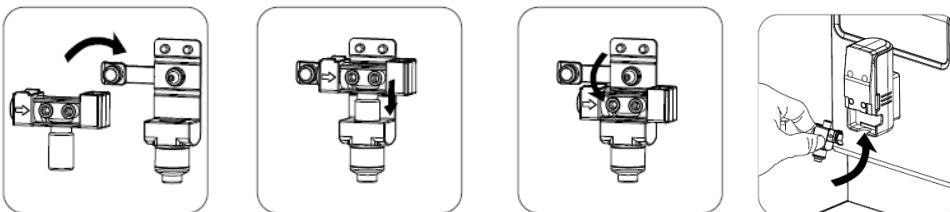

Step 3: Assemble the milk frother back to original position



Step 4: Insert the milk frother to the slot of machine.

Cleaning the milk container and connection milk tube

Note: it is important to do this step daily to make sure the function of automatic milk frother running in good condition.

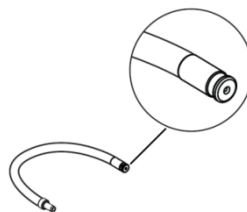
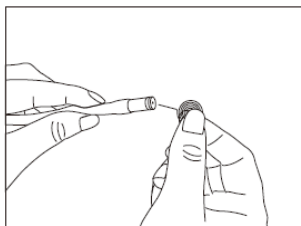
1. Empty the milk inside the milk container and wash it with fresh water, take out the connection rubber and container milk tube to wash it with fresh water too, then assemble them to the lid again (make sure the connection is fit and correct)
2. Clean the both end of milk connection milk tube with fresh water, to make sure the hole on the milk tube connector is clean(see picture),you can use needle or bristle of brush to clean the hole.



3. Fill the milk container with fresh water and connect to the machine with container milk tube
4. Using Frothing milk function by pressing the Cleaning button , the water in milk container can clean the connection tube internal. You can stop the cleaning by press the Cleaning button  again.

Turning Off the machine

Switch off the appliance by pressing the power on/off button.

Auto-Shut off

The Appliance is equipped with auto-shut off. Depending on the mode you have selected the appliance will have different auto-shut off timing(SEE “Further Setting - III Mode Selection”).

FURTHER SETTING

I. ADJUSTING THE QUANTITY OF YOUR COFFEE/ MILK FOAM/HOT WATER

The machine can memorize your desired volume of coffee, milk foam and hot water.

Preparing quantity for Espresso / Latte Macchiato /Cappuccino/milk foam /Water

1. Place a cup under the spout
2. Switch on the machine, all buttons lights on.
3. Press Espresso / Latte Macchiato /Cappuccino/milk foam /Water button, only your desired one illuminates.
4. If machine dispenses milk, press and hold the button to continue and release the button when milk froth reaches your desired volume. Milk froth stops with two beep sounds and the volume is now stored.
5. If machine dispenses coffee, touch and hold the button to continue and release the button when coffee reaches your desired volume. Coffee stops with two beep sounds and the volume is now stored.
6. If machine dispenses water, touch and hold the button to continue and release the button when water reaches your desired volume. Water stops with two beep sounds and the volume is now stored.
7. Then Espresso/ Americano/ Latte Macchiato /Cappuccino/milk foam /Water button is programmed: every time it's pressed, the machine will brew the same amount set.

*Note: To reset the factory setting quantity of coffee/milk foam /hot water, press and hold the on/off button and cappuccino button together for 5 seconds.

GRINDING ADJUSTMENT

You can adjust the grinder to suit the roast of your coffee by turning adjuster knob in the bean container:

1. When the grinder is grinding the coffee bean when it is making the coffee, you can turn the adjust knob to do the adjustment (CAUTION: Never do the grinding adjustment when the grinder is not operating. It may damage the grinder.)
2. The dots on the adjuster knob indicate the fineness of the grind.

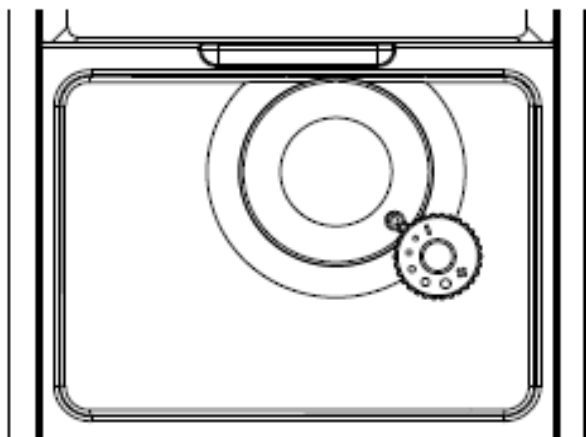





MODE SELECTION

The machine has three different setting: default setting, ECO mode and speed mode. In ECO mode, the appliance helps to save more energy. In speed mode, the user can make their coffee faster than in default setting.

	ECO Mode	Speed Mode	Default Setting
Illumination Light	No	Yes	Yes
Pre-brewing*	Yes	No	Yes
Auto shut off time	10mins	30mins	20mins
Cup Volume memory	Yes	Yes	Yes

*Note: The pre-brewing function moistens the grounded beans in the brewer with a small amount of water before full extraction. This expands the coffee grounds to build up a greater pressure in the brewer which help extraction of all the oils and full flavor from the grounded beans.

1. When the machine is in standby condition, press and holds the  for 5 seconds.
2. The following button will have the following indications in different settings:

	Cappuccino button 	Latte Macchiato button 	Espresso button 
In ECO Mode	Flashing	Lights ON	Flashing
In Speed Mode	Flashing	Flashing	Lights ON
In Default Setting	Lights On	Flashing	Flashing

Press the Cappuccino button for ECO mode, Latte button for speed mode and Espresso button for default setting. Two Beep sound will be heard indicates that the mode is being selected. (Note: If you are pressing the relative lights on button for each mode, the machine will not response).

3. If you would like to remain the setting unchanged, press  again or wait for 5 seconds for the machine to return to the standby condition.



CLEANING & MAINTENANCE

SELF-CLEANING



When  lights up stably, it indicates that the appliance needs to undergo self-cleaning. The appliance will remain in the best condition if this function is performed at least once a month or more regularly depending on the hardness of water used. It is also suggested that to

1. Fully fill the water tank.
2. Adding one pack of cleaning agent included in the box to the water tank.

IMPORTANT: Do not use vinegar or other cleaning agent to do self-cleaning of this appliance. The cleaning agent might damage the appliance.

3. Plug in the appliance.
4. Place a sufficient large container under the coffee spout.
5. In standby condition, press and hold  and Espresso button for 5 seconds. A beep sound will be heard with  and Espresso button will be flashing.
6. Press Espresso button to confirm undergoing the self-cleaning process. To resume back to the standby condition, press .





7.  will be flashing indicates that the appliance is undergoing the self-cleaning process. **(Caution: Keep skin/body away from the hot water.)**

8. When all the water in the water tank is being dispensed out,  and Espresso button will be flashing. Remove all the remaining solution in the water tank and fill the tank with normal tap water until the max position. When water is filled into the water tank,  will go off. Then the appliance will continue the self-cleaning process, there is a waiting period for this process, please be patient and let the machine complete the process and don't stop manually.

9. When the self-cleaning process is completed, **the appliance will switch off automatically.**

EMPTY SYSTEM FUNCTION

The empty system function is recommended to use before long period of non-use, frost protection and before talking to repair agent.

1. In standby condition, press and hold the  and the Latte Macchiato button  together for 5 seconds.
2.  will then be flashing.
3. Remove the water tank from the appliance.  will light up stably indicates that the empty system is under process. You can press  before removing the water tank to resume back to the standby condition.
4. When the empty system function is completed, the appliance will switch off automatically

Important: After perform EMPTY SYSEM FUNCTION; press the hot water button until water can come out from spout when the coffee maker is reused again.

MANUAL RINSING

You can perform a manual rinsing cycle to clean the coffee nozzle after use. It is also suggested to perform a manual rinsing if the appliance has not been used for a long period of time.

1. In standby condition, press and hold the  and hot water button together.
2. All button will then goes off. The coffee nozzle will then dispense a small amount of water which is used for the rinsing.

Danger: Water comes out of the coffee nozzle is hot and is collected in the drip tray underneath. Avoid contact with splashes of water.

3. After rinsing, the appliance will return to the standby condition.



CLEANING THE APPLIANCE

1. Disconnect the power cord from the mains supply outlet.
2. Pour away all the water in the internal and external drip tray
3. Use a damped cloth or non-scratching cleaner to clean the water stains on the appliance.

IMPORTANT: Never use any abrasive, vinegar or descaling agents not included in the box to clean the appliance.

Cleaning coffee powder outlet

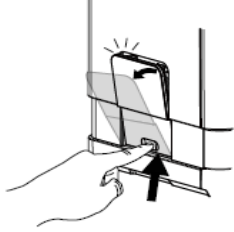
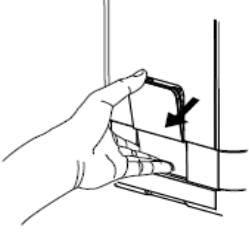
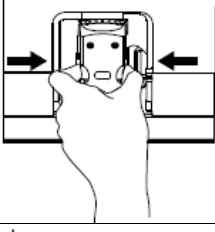
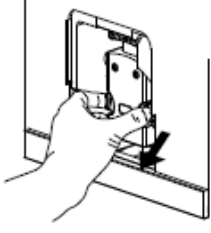
Coffee powder may stick on the wall of powder outlet for appliance after used a long period of time. It is suggested to clean the outlet by following step to ensure that coffee powder can come to brewer.

1. Push the service door recess area	 A line drawing showing a hand pushing a small rectangular recessed area on the front panel of the coffee machine. An arrow points to the right, indicating the direction of the push.
2. Take out the service door	 A line drawing showing a hand pulling the service door outwards from the machine. An arrow points to the right, indicating the direction of removal.
3. Press the release knob of brewer	 A line drawing showing a hand pressing a knob on the front of the brewer. Two arrows point outwards from the knob, indicating its movement.
4. Take the brewer out	 A line drawing showing a hand pulling the brewer out of the machine. An arrow points to the right, indicating the direction of removal.
5. Use Cleanness Brush to clean the powder outlet	 A line drawing showing the interior of the coffee machine with the brewer removed. A brush is being used to clean the powder outlet area. The brush is positioned against the outlet, and an arrow indicates the cleaning motion.

TROUBLESHOOTING

PROBLEM	CAUSE	SOLUTION
The appliance does not work.	The appliance is not connected to the mains.	- Plug in and press the switch. - Check the cable and the Plug
No or delayed response in several trials of pressing on function key on the panel	- Appliance is under an electromagnetic interference - Dirt over the panel	- Unplug the appliance. Restart after few minutes - Clean the panel with the cloth provided
The coffee is not hot enough.	- The cups have not been preheated. - The brewing unit is too cold.	- Rinse the appliance at least 3 times before making the coffee.
The coffee cannot come out from spout.	Empty system function maybe used before.	Press the hot water button until water can come out from spout.
The first cup of coffee is poor quality.	The first run of grinder does not pour sufficient quantity coffee power into the brewing unit.	Throw the coffee away. The other coffees will always be of good quality.
Coffee has no cream.	- Coffee bean is not fresh.	Change or using appropriate brand of coffee bean.
The touch buttons are not sensitive	Not pressing the touch button from the front direction of the appliance	Press the lower bottom part of the icon of the touch button from the front direction of the appliance.
The appliance takes too long time to warm up.	Excessive scale has built up.	Descale the appliance.
The water tank is removed / the water level is very low in the water tank but  have no alert.	The area near the water tank connector is wet.	Wipe the water around the water tank connector
Internal drip tray is filled with a lot of water.	Coffee powder too fine which block the water to come out.	Adjust the coffee fineness to bigger dot during grinder operation.
Coffee is delivered too slowly or a drop at a time.	Coffee powder too fine which block the water to come out.	Adjust the coffee fineness to bigger dot during grinder operation.
Lack of bean indicator flashes but there is still a lot of coffee bean inside the container.	Internal coffee powder outlet is blocked.	To follow the steps of section E (V. Cleaning coffee powder outlet).
No milk foam out from the machine	The automatic milk frother is dirty or not assembled or installed correctly	Clean the automatic milk frother and make sure it is correctly assembled or installed.
No milk foam out from the machine	The hole of the Milk tube connector is blocked by milk residues	Refer to section “Daily Cleaning of the appliance”, follow “cleaning the milk container and connection milk tube”, Clean the connector and make sure all the hole on the connector is clean, use needle or bristle of brush to clean the hole.
The hole of the Milk tube	The milk tube connector has	Soaking the connection milk tube into warm

connector is blocked by milk residues which are hard to clean	not be cleaned for a long time	water for an hour, follow the “cleaning the milk container and connection milk tube” in section “Daily Cleaning of the appliance”, keep using frothing milk function to clean until water come from dispenser smoothly. Use needle or bristle of brush to clean the hole
	The type of milk used is not suitable for milk frothing	Different types of milk result in different amounts of froth and different froth qualities. Semi-skimmed or full-fat cow’s milk gives good results.
	The temperature of the milk is too high	No milk foam out from the machine
Milk spray out the table	Milk dispensing tube is not put in place	Milk foam spray out from dispenser
Descaling indicator keep flashing even after the descaling process	Decaling process is not completed	Please be patient and wait for the process finish. The machine will auto shut off automatically , don’t switch off the machine manually