

WHELEN[®]

ENGINEERING COMPANY INC.

Route 145, Winthrop Road,
Chester, Connecticut 06412
Phone: (860) 526-9504
Fax: (860) 526-2009
Internet: www.whelen.com
Sales/Service e-mail: aviation@whelen.com

Installation Guide: Model 90088()-series

Models 9008811, 9008812, 9008813,
9008814, 9008815, 9008816
P/N:01-0790088-11, 01-0790088-12,
01-0790088-13, 01-0790088-14
01-0790088-15, 01-0790088-16
LED Anti-Collision Light Assembly

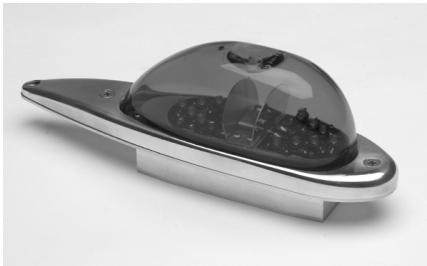

TSO-C96a
CLASS III
APPROVED

OPERATING INSTRUCTIONS:

Operational Voltage:28 VDC (nominal)

Average Input Current:0.56 Amps / 3 Amps Peak @ .25 Sec.

The conditions and tests required for TSO approval of this article are minimum performance standards. It is the responsibility of those installing this article either on or within a specific type or class of aircraft to determine that the aircraft installation conditions are within the TSO standards. TSO articles must have separate approval for installation in aircraft. The article may be installed only if performed under 14 CFR part 43 or the applicable airworthiness requirements.

CONTINUED AIRWORTHINESS: The 90088 series led anti-collision light assembly is designed with 2 banks of 7 leds. Should any one led or bank fail, the unit must be repaired or replaced. Inspect the lens for excessive scratches or pitting. Replace if necessary.

EQUIPMENT LIMITATIONS: The Class III anti-collision system must produce a minimum of 100 effective candelas in aviation red or white, 360° around the vertical axis. A single beacon on the topside of the fuselage and a single beacon on the underside of the fuselage will meet this requirement.

INSTALLATION PROCEDURES: The following information is to assist in the installation of a Whelen LED Anti-Collision Light Assembly.

1. Choose the appropriate 90088() replacement light assembly which is most applicable to your aircraft. Lower mounts have a drain hole in the lens.
2. The installation procedure described in the following text will be confined to a single light installation, but is identical for multiple light installations.
3. Remove old light, locate and save the existing +28VDC lead and (-) ground lead. Clean and prep lead ends as required.
4. Use existing mounting holes and hardware.
5. Connect the +28 VDC and (-) ground leads equipped with an appropriate sized breaker to the LED Light. Both leads must be connected by an approved FAA connection.
6. Install light assembly and insure that the wire leads are clear of any obstructions and ty-wrap as required. Use lock washers and/or thread lock on all threaded fasteners.
7. Check all avionics systems for interference from the installation.
8. A flight check should be performed by a properly certified pilot.
9. Update aircraft records, complete Form 337 and obtain FAA field approval for installation.

Model(s): 01-0790088-11, 01-0790088-12, 01-0790088-14

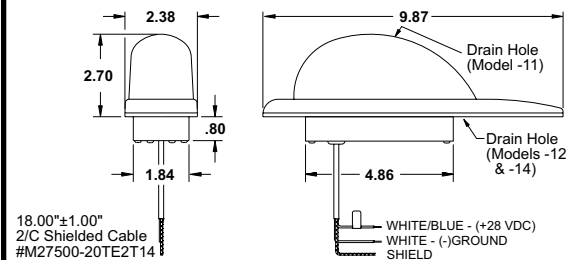

Model(s): 01-0790088-13

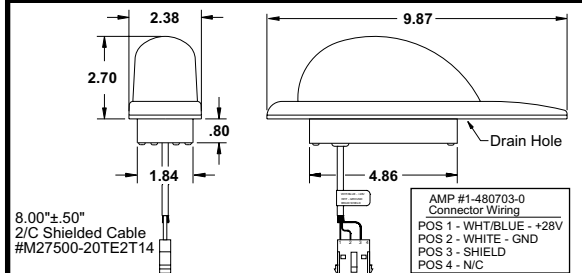

Model(s): 01-0790088-15, 01-0790088-16

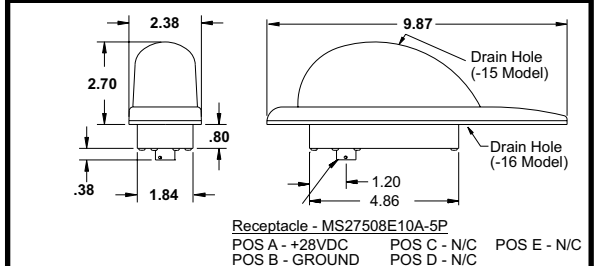

Model(s): All

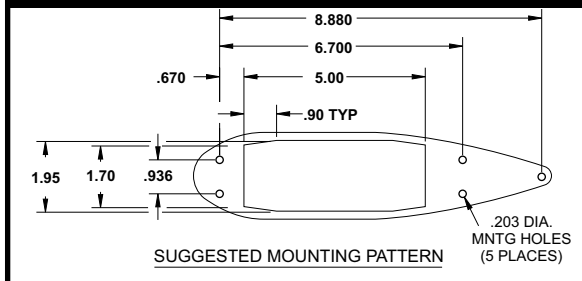

**Models:
9008811, 9008812, 9008814**

**Model:
9008813**

**Models:
9008815, 9008816**

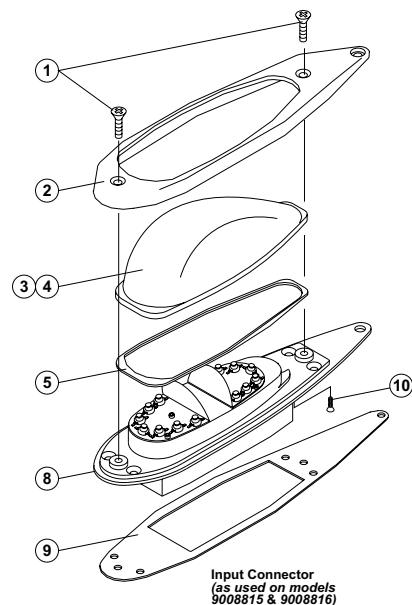
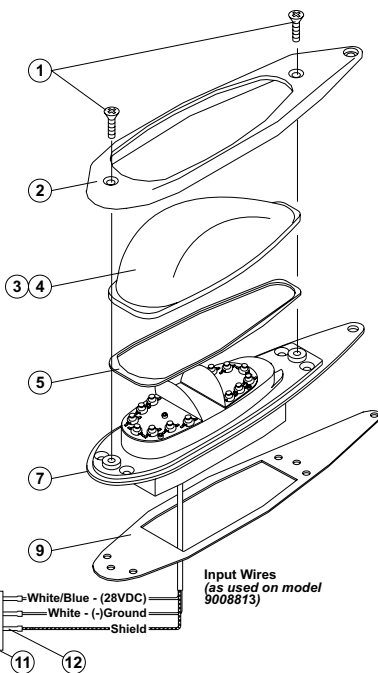
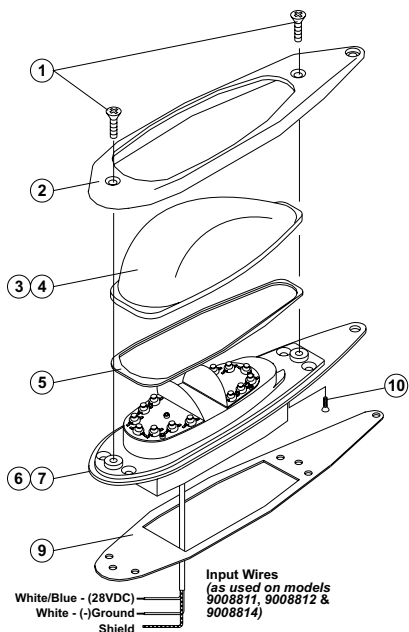

QTY	QTY	QTY	QTY	QTY	QTY	QTY	ITEM	PART NUMBER	DESCRIPTION
					*			01-0771021-11	9008811 Final Assembly (Lower Mount)
					*			01-0771021-12	9008812 Final Assembly (Upper Mount)
				*				01-0771021-13	9008813 Final Assembly (Upper Mount)
		*						01-0771021-14	9008814 Final Assembly (Upper Mount)
	*							01-0771021-15	9008815 Final Assembly (Lower Mount)
*								01-0771021-16	9008816 Final Assembly (Upper Mount)
2	2	2	2	2	2	2	1		#10-32 X 1/2 Phillips FHMS
1	1	1	1	1	1	1	2	19-171019-00S	Lens Retainer - polished (w/seal)
1	-	1	1	1	-	3	3	68-4270579-30	Lens (clear)
-	1	-	-	-	1	4	4	68-4270579-31	Lens (w/drain hole (clear))
1	1	1	1	1	1	1	5	38-0270584-00	Lens Gasket
-	-	-	-	1	1	6	6	01-0271022-01	LED Assembly (90088-series)
-	-	1	1	-	-	7	7	01-0271022-02	LED Assembly (90088-series)
1	1	-	-	-	-	8	8	01-0271022-03	LED Assembly (90088-series)
1	1	1	1	1	1	9	9	38-0270864-00	Baseplate Gasket
-	1	-	-	-	1	10	10	14-0050509-15	Screw #4-40 X 3/8 PFH MS51959-15
-	-	-	1	-	-	11	11	39-0404014-14	4-Pos. Pin Housing (Mate-N-Lok)
-	-	-	3	-	-	12	12	39-0500315-18	Pin, 20-14 AWG, .084 (Mate-N-Lok)