



WHELEN AEROSPACE TECHNOLOGIES

Phone: (860) 526-9504

Internet: www.flyWAT.com

Sales/Service e-mail: info@flyWAT.com

## Installation Guide/ICA:

Model 9076950

P/N:01-0790769-50

## LED Anti-Collision/Ground Recognition Light Assembly (Lower Mount)

TSO-C96a  
CLASS II;  
APPROVED

The conditions and tests required for TSO approval of this article are minimum performance standards. Those installing this article either on or within a specific type or class of aircraft must determine that the aircraft installation conditions are within the TSO standards which include any accepted integrated non-TSO functions. TSO articles and any accepted integrated non-TSO function(s) must have separate approval for installation in an aircraft. The article may be installed only according to 14 CFR part 43 or the applicable airworthiness requirements.

**WARNING:** This product can expose you to chemicals including Lead which is known to the State of California to cause cancer and birth defects or other reproductive harm. For more information go to www.P65Warnings.ca.gov.

### SPECIFICATIONS:

**Nominal Operational Voltage:** ..... 28 VDC  
(Operation from 22-32 VDC)

### Input Current:

**LED Anti-Collision Light (Pulse@.25 Sec.)** ..... 3.2 Amps

**LED Ground Recognition Light (Pulse@.25 Sec.)**... 1.0 Amps

**Flashrate** ..... 45 ±5 / Min.

**EQUIPMENT LIMITATIONS:** An approved Anti-Collision light assembly should be located so that the light will not impair the crews vision or detract from the conspicuity of the position lights. The baseplate must be mounted parallel to the vertical and horizontal centerlines of the aircraft to project the patterns properly. Model 9076950 is designed to be mounted to the underside of the fuselage.

Model 9076950 is designed for use with anti-collision lights with a SYNC output.

Certain types of aircraft may require additional testing.

**AIRWORTHINESS LIMITATIONS:** The Airworthiness Limitations section is FAA approved and specifies inspections and other maintenance required under §43.16 and §91.403 of the Federal Aviation Regulations, unless an alternative program has been approved.

No airworthiness limitations are associated with the installation of the LED anti-collision/ground recognition light.

**CONTINUED AIRWORTHINESS:** The anti-collision light is designed with 24 outboard forward-facing white LEDs. the ground recognition is designed with 18 red LEDs. Should any one white LED fail, the unit must be repaired or replaced. **Note:** To reduce eye strain use an optical filter such as dark glasses or a blue covering dome during LED inspection.

Inspect the lens, replace if there is excessive scratching, pitting, discoloration or cracking.

**PERIODIC INSPECTIONS:** An annual inspection shall be performed unless the OEM specifies a shorter interval.

**INSTALLATION PROCEDURES:** The following information is to assist in the installation of a WAT LED Anti-collision Light.

- Using the mounting detail information provided, prepare the aircraft for means to secure the LED Light assembly.
- Connect the light inputs according to the chart shown. Connect the power lead to an appropriately sized breaker. Connections to be in accordance with FAA approved methods.
- Carefully remove the Phillips screw and lens retainer. **CAUTION:** Do not touch the LEDs with either fingers or sharp objects. This could soil and/or damage the LEDs and effect the optical performance of the light.
- Using the appropriate hardware install the baseplate gasket and LED assembly to the aircraft. Insure that all leads are clear of any obstructions and secured as required.
- Reinstall gasket, lens and retainer. Confirm proper gasket fit. Reinsert screws and tighten firmly.
- Check all avionics systems for interference from this installation.
- A flight check should be performed by a properly certified pilot.
- If required, update aircraft records utilizing FAA Field Approval (Form 337) or equivalent.

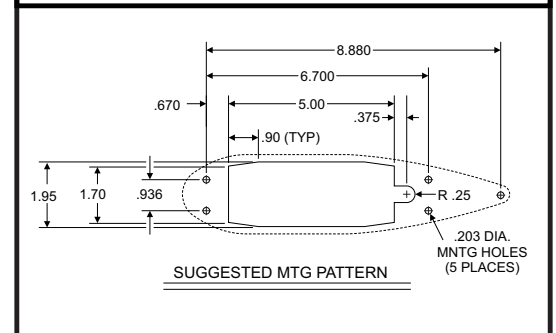
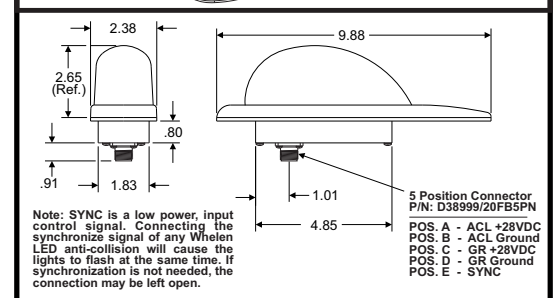
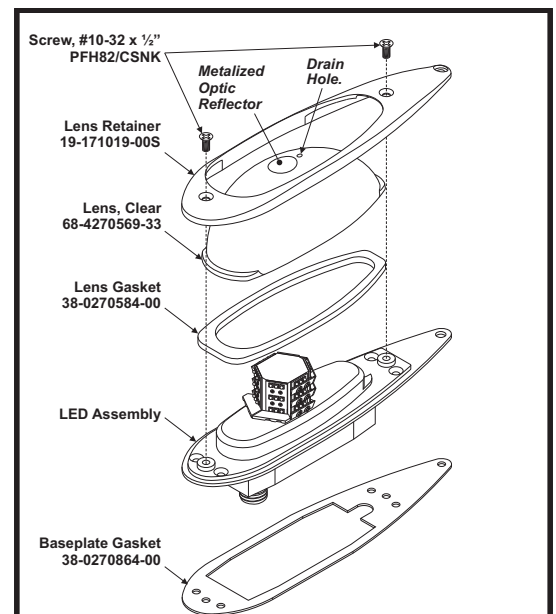

Aviation