



WHELEN AEROSPACE TECHNOLOGIES

Phone: (860) 526-9504

Internet: www.flyWAT.com

Sales/Service e-mail: info@flyWAT.com

Installation Guide:  
Model 7089600  
P/N 01-0770896-00  
APU Fire Warning Horn

**INSTALLATION PROCEDURES:** The following information is to assist in the installation of a Whelen APU Fire Warning Horn.

- Using approved connectors, wire the unit as shown (Fig.1). Tighten the hardware until a maximum torque value of 6 in./lbs. is achieved.
- Install the unit using the mounting diagram shown (Fig.2). Insure that the wire leads are clear of any obstructions and ty-wrap as required.
- Check all avionics systems for interference from the installation.
- A flight check should be performed by a properly certified pilot.
- If required, update aircraft records utilizing FAA Field Approval (Form 337) or equivalent.

Fig. 1

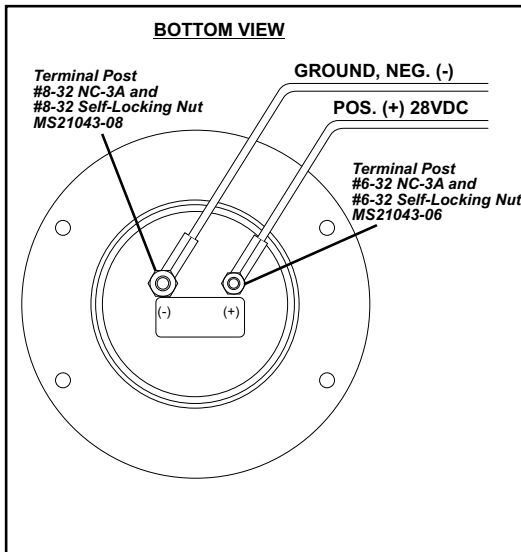

Fig. 2

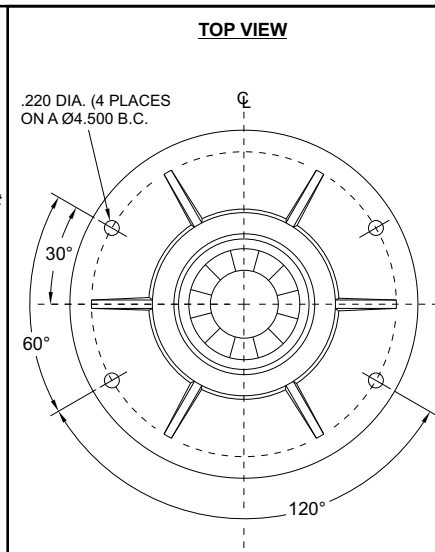
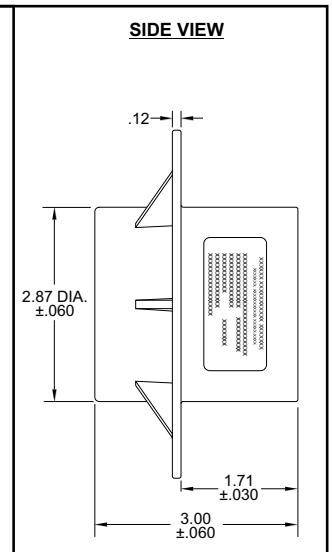

Fig. 3



**GENERAL NOTES**

- VOLTAGE - 28V NOM. (18VDC MIN TO 32VDC MAX.)
- CURRENT @ 28V - 55ma TYP. / 600ma MAX
- SOUND INTENSITY - The signal provides a sound intensity of 106dB (+10dB - 3dB) as indicated on a standard meter at a distance of 3 feet when operated at 28VDC under conditions encountered in a sound-proof room.
- FREQUENCY - 25-20,000 HZ
- WEIGHT - 1.25 lbs.

Aviation