



WHELEN AEROSPACE TECHNOLOGIES

Phone: (860) 526-9504

Internet: www.flyWAT.com

Sales/Service e-mail: info@flyWAT.com

Installation Guide/ICA:

Aviation model 9066700

P/N 01-0790667-00

LED Tail Position and Anti-Collision Light Assembly

TSO-C30c
TYPE III
APPROVED

TSO-C96a
CLASS II
APPROVED

The conditions and tests required for TSO approval of this article are minimum performance standards. Those installing this article either on or within a specific type or class of aircraft must determine that the aircraft installation conditions are within the TSO standards which include any accepted integrated non-TSO functions. TSO articles and any accepted integrated non-TSO function(s) must have separate approval for installation in an aircraft. The article may be installed only according to 14 CFR part 43 or the applicable airworthiness requirements.

WARNING: This product can expose you to chemicals including Methylene Chloride which is known to the State of California to cause cancer, and Bisphenol A, which is known to the State of California to cause birth defects or other reproductive harm. For more information go to www.P65Warnings.ca.gov.

SPECIFICATIONS (with Flasher Model 7123407):

Nominal Operational Voltage:..... 28 VDC
(Operation from 24-32 VDC)

LED Position Light:.....0.2 Amps
LED Anti-Collision Light (Average):0.6 Amps
LED Anti-Collision Light (Pulse@0.25 sec.):3.2 Amps
Flashrate45± 5 per min.

EQUIPMENT LIMITATIONS: An approved lighting system consists of three lights, one located on the tail and one located on each wingtip. Model 9066700 is a tail position and anti-collision light. A separate flasher assembly such as model 7123407 is required. The assembly should be mounted as far aft on the aircraft as practicable on a thermally conductive surface. The baseplate must be mounted parallel to the vertical and horizontal centerlines of the aircraft to project the patterns properly.

Certain types of installations may require additional testing.

AIRWORTHINESS LIMITATIONS: The Airworthiness Limitations section is FAA approved and specifies inspections and other maintenance required under §43.16 and §91.403 of the Federal Aviation Regulations, unless an alternative program has been approved.

No airworthiness limitations are associated with the installation of this light assembly.

CONTINUED AIRWORTHINESS: The tail position light is designed with 6 LEDs. The anti-collision light is designed with 24 LEDs. If any one LED fails the unit must be repaired or replaced.

Note: To reduce eye strain, use an optical filter such as dark glasses or a blue covering dome during LED inspection. Inspect the lens. Replace if there is excessive scratching, pitting, discoloration or cracking. For additional lens maintenance detail, see SAE ARP5637.

PERIODIC INSPECTIONS: An annual inspection shall be performed unless the OEM specifies a shorter interval.

INSTALLATION PROCEDURES: The following information is to assist in installing a WAT light system.

- Using the mounting detail information provided, prepare the aircraft for means to secure the LED light assembly.
- Carefully remove and save the #4 Phillips screws (qty. 2).
- Install the unit to the aircraft. Insure that all leads are clear of any obstructions and secured as required. Note that proper orientation is achieved with the drain hole down.
- Connect the light inputs to flasher Model 7123407.
- When necessary, seal the light base to aircraft. Apply sealant around the perimeter of the base. Do not cover the drain hole.
- Check all avionics systems for interference from this installation.
- A flight check should be performed by a properly certified pilot.
- If required, update aircraft records utilizing FAA Field Approval (Form 337) or equivalent.

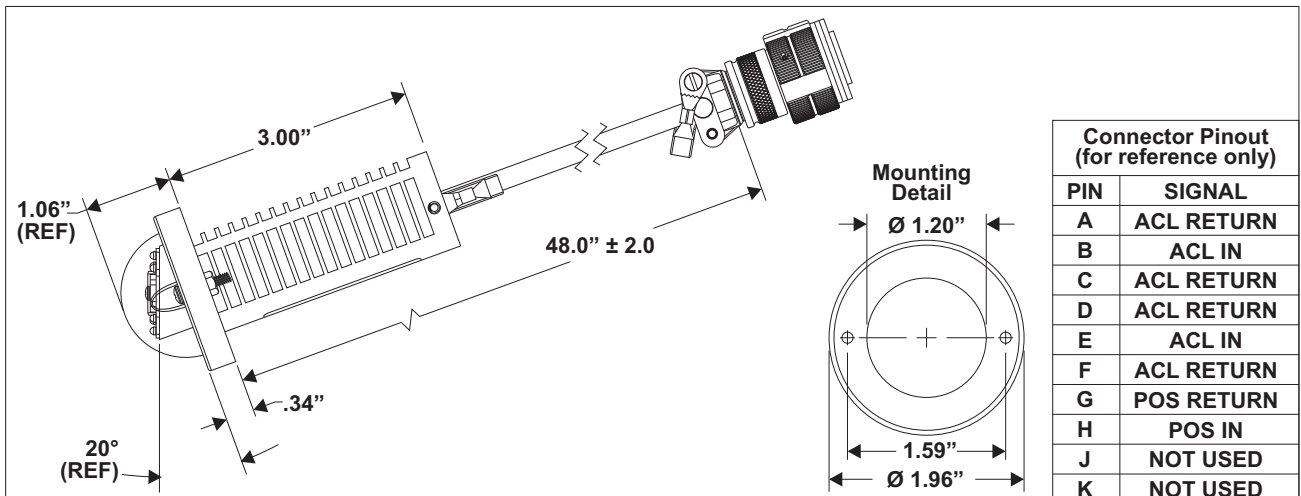

CAUTION! Do not touch the LEDs with either fingers or sharp objects, as this could soil or damage the LEDs and effect the optical performance of the light.

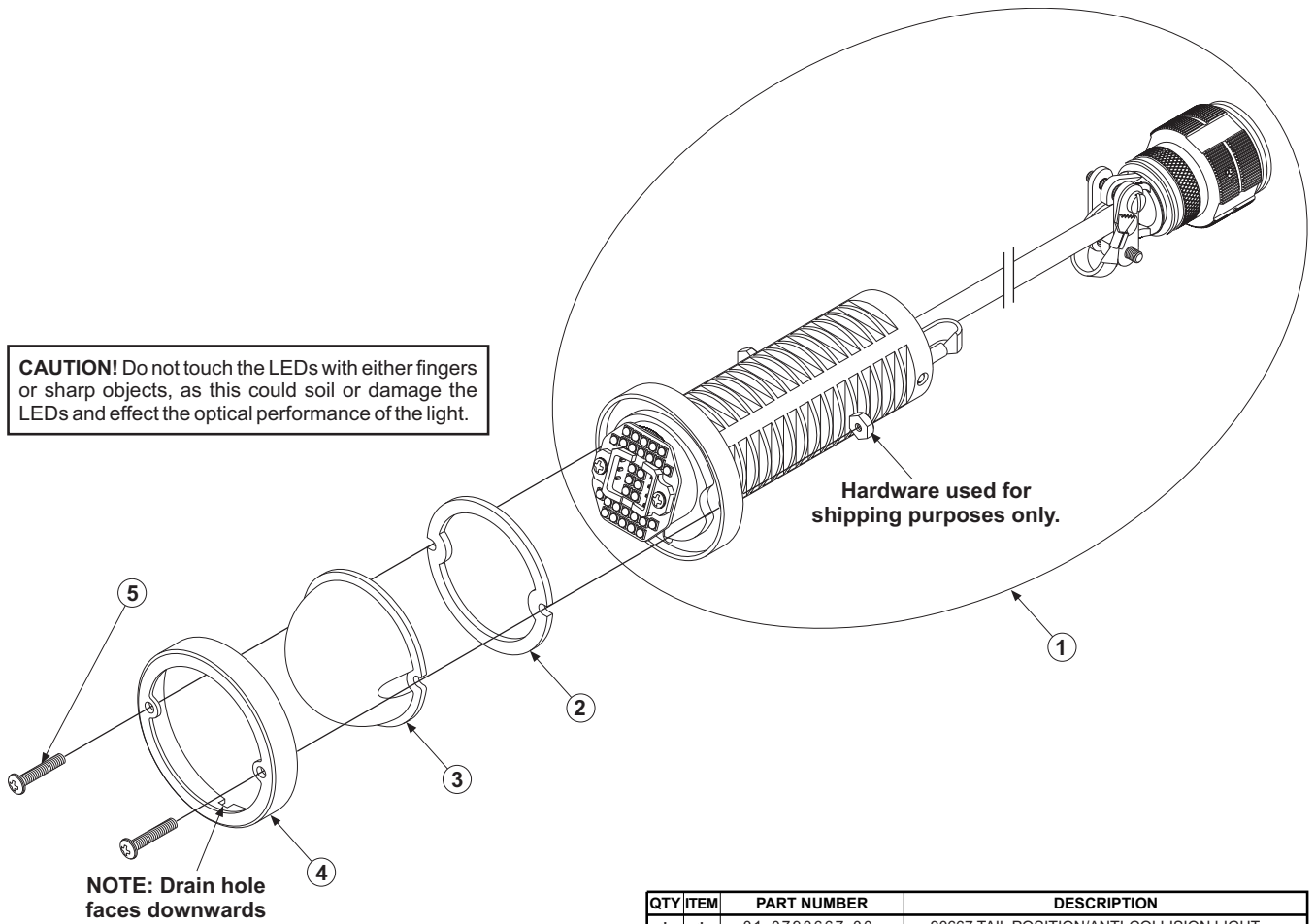

QTY	ITEM	PART NUMBER	DESCRIPTION
*	*	01-0790667-00	90667 TAIL POSITION/ANTI-COLLISION LIGHT
1	1	_____	SUB-ASSEMBLY, MODEL 90667
1	2	38-0231346-00	GASKET, LENS, MODEL 90667
1	3	68-3951061A31	LENS, MODEL 90667
1	4	19-151062-100	RETAINER, LENS, MODEL 90667
2	5	14-0050505-18	SCREW, 4-40 x 5/8 PPHMS (MS51957-18)