

truweigh 



STORM

USER GUIDE

Thanks for purchasing the STORM Digital Mini Scale! This User Guide is designed to get you up and running quickly with your scale. Scales are precision instruments and require proper care and skill to get the best results. If you have questions or need support, visit us at <http://www.truweigh.com/support> or scan the QR Code on the back of this manual using your smartphone.

What's In The Box

User Guide

Two AAA
Batteries

Plastic Cover /
Weighing Trays

STORM Digital
Mini Scale

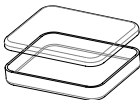

Key Descriptions

ON/OFF - Press to turn the scale ON or OFF.

TARE - Zero's the scale. Also subtracts the weight of an empty container or tray (see Tare Function).

C/M: CAL/MODE - Tap to change the weighing unit. Hold for 3 sec. to enter Calibration(see Calibration). Hold for 4 sec. to temporarily disable the auto-off function.

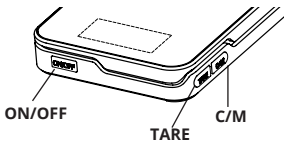

Weighing Your First Item

1. Press the **ON/OFF** key to turn the scale on.
2. Place the item on the center of the weighing platform.
3. The display will show \uparrow when the weight is stable.
4. Take your reading from the display. You can press the **C/M** key to convert between weighing units.
5. The scale's auto-off function will turn the scale off after 3 minutes of inactivity or you can press the **ON/OFF** key to turn the scale off.

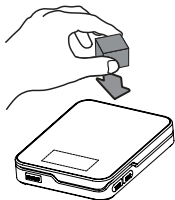

AUTO-OFF Setting: You can temporarily disable the auto-off feature by holding **C/M** for several seconds until the display shows "AUTOFF" then release. The scale will now remain on until powered off manually. The AUTO-OFF feature will be restored the next time you use the scale.

Things To Avoid



Unlevel Surfaces



Radio Frequency Interference



High Humidity



Air Currents



Vibration



Extreme Temps

Tare Function

The Tare function allows you to subtract the weight of a container so that the display only shows the weight of the contents.



Place an empty tray or container on the platform.



Press the **TARE** key to subtract the container's weight.



Add items to the container to see their weight on the display.



NOTE: The weight of the container will subtract from the available capacity and will leave a negative value on the display once the weight is removed. Press **TARE** again to return the display to zero.

Accuracy

Your scale comes calibrated from the factory and most users won't need to calibrate their scale for a long time. You should check your scale's accuracy periodically using calibration weights and perform calibration if necessary.



NOTE: Only use trusted calibration weights. Household items such as bottles and cans with weights printed on the side are not suitable for checking accuracy as these values are approximate and don't include the container weight (Net Weight).

Calibration

Our scales ship pre-calibrated and ready to weigh. You should periodically check accuracy using calibration weights and perform a calibration adjustment if necessary. Calibration is permanent and should only be performed using accurate calibration weights that match the requirements for your scale (see the chart on back). Do not use coins or other household items to calibrate.

1. Prepare the required weight for your scale. (see chart on back)
2. Find a flat and level surface to perform calibration and let the scale adjust to room temperature.
3. Press **ON/OFF** to turn the scale on and wait for the scale to stabilize.
4. Make sure nothing is on the platform then press and hold the **C/M** key until the display shows 'CAL'.
5. The display will then flash the required calibration weight.
6. Place the required calibration weight on the center of the platform.
7. The display will show 'PASS' then return to normal weighing mode. You may now turn the scale off or continue weighing.

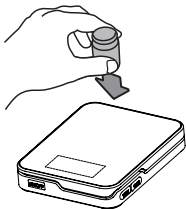

Specifications

ST-200-01

Max Capacity

200 g / 7.055 oz / 6.430 ozt/ 128.60 dwt / 1000.00 ct / 3086.4 gn

Readability

0.01 g / 0.001 oz / 0.001 ozt / 0.01 dwt / 0.05 ct / 0.2 gn

Weighing Units

g, oz, ozt, dwt, ct, gn

Dimensions

Overall: 3.0 in x 3.8 in x 0.6 in
Platform: 3.0 in x 3.8 in
Display: 0.6 in x 1.3 in

Calibration Weight

200g

Power

2 x AAA Batteries

Warranty

10 Year Limited Warranty

For more information, including weighing tips and support, scan this code with your smartphone

Or visit us online at truweigh.com/support/

