

The background features abstract, curved shapes in shades of green and grey. A thick grey curve starts from the top left and curves towards the center. Another thick grey curve starts from the bottom right and curves towards the center. There are also green shapes in the top-left and bottom-right corners, separated from the grey curves by white space.

novostella

Smart LED Flood Light User Guide

THANK YOU for choosing Novostella. It is pretty easy to set up this light by taking a few minutes to watch the step-by-step tutorial video. And for those who prefer to have a manual at hand for set-up, you may also read the rest pages for details.

Video Guide

Please scan the left QR code below, choose the language to watch the installation on Youtube.

Before installation, please note:

- This product only supports 2.4GHz WiFi network, not 5.0GHz.
- Make sure to keep an interval over 2 seconds between each turn-on and turn-off during the set-up.

General Troubleshooting

Scan the right QR code below for FAQ. If your problem is not yet solved, please write us email via support@novostella.net.



Contact Us

Have some issue? No worries! Please reach us via these channels.
Our customer services team is more than happy to help.



support@novostella.net



www.novostella.net



We are social. Get connected!



@Novostella_US



@novostella_official



@novostella_official



fb.com/novostella.fans



@Novostella_official

Smart LED Flood Light User Guide

Before installation, let's know how the whole thing works.

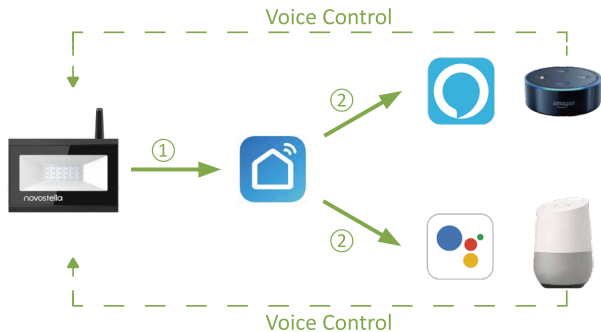

Step One: Install the smart flood light.

Step Two: Fundamental set-up - Connect smart LED flood light to Smart Life App.

Step Three & Four: Optional set-up - Connect Smart Life App to Amazon Alexa or Google Assistant.

After completing Step Two, you can remote control the light on Smart Life App. After completing Step Three and Four, you can voice control the light with Alexa or Google Assistant. This manual consists of Four parts.

Part One - How to install the light ?	3 - 7
Part Two - How to pair the light to Smart Life app?	8 - 11
Part Three - How to control the light with Amazon Alexa?	12 - 14
Part Four- How to control the light with Google Assistant?	15 - 16

Part One - How to install the light ?

Warning

- (1) Please check if the light and the parts are intact before installation.
- (2) Make sure to cut off power before installation.
- (3) Please do not place this light in corrosive conditions.
- (4) If there is any damage to the cord, please cut off the power and stop using it immediately.
- (5) Please do not retrofit the light within the warranty period.
- (6) To ensure the light works properly, please use the voltage indicated on the packing.

1. Parameters

Model	NTF80	NTF81	NTF82
Wattage	25W	60W	100W
Input Voltage	US: 100-120V AC		
Color	RGB		
Frequency	50/60Hz		
Waterproof Rating	IP66		
Beam Angle	120°		
Working Temperature	-20~40°C		

P/N: NTF80B/NTF81B/NTF82B-RGB

Wireless Control Specification:

Wireless Frequency Range: 2.412-2.472 GHz

Wireless Communications Protocol: IEEE 802.11b/g/n

Wireless Conducted Power: 13-16 dBm

2. Components

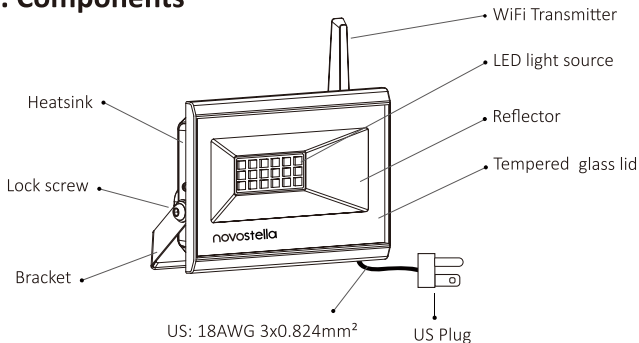

Note: Cord - type Y attachment.

For type Y attachment: If the external flexible cable or cord of this luminaire is damaged, it shall be exclusively replaced by the manufacturer or his service agent or a similar qualified person in order to avoid a hazard.

3. Dimension

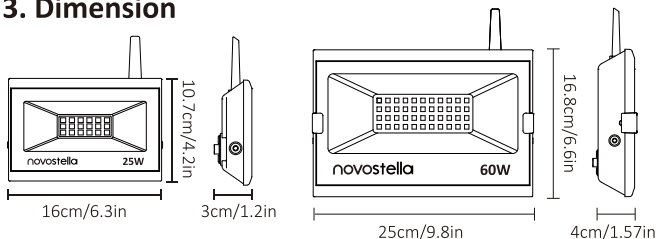

NTF80

Weight: 1.21lb/0.55kg
Max Projected Area: 30m²

NTF81

Weight: 2.97lb/1.35kg
Max Projected Area: 50m²

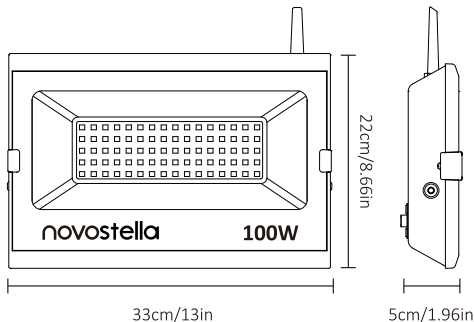

NTF82

Weight: 5.5lb/2.5kg

Max Projected Area: 80m²

4. Installation

Step A: According to the spacing of two screw bits on the bracket, drill two holes on the mounting panel.

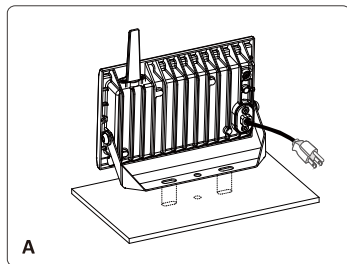

Note: Maximum mounting height is over 5m.

Step B: Aim the bracket at the holes and fix it with two bolts.

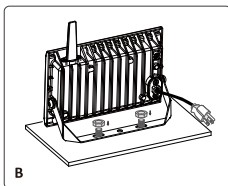

Step C: Adjust the lighting direction up or down as per your need and plug in to power the light on.

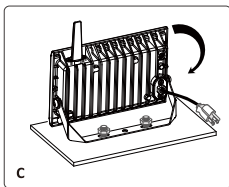

Note:

Limitation of Indoor and Outdoor Use

- (1) This light is waterproof and damp proof. It is protected against the rain, but it cannot be immersed in water.
- (2) The mounting position of this light should be able to bear at least 10 times as heavy as the light.
- (3) This light should be used in condition that is good for heat dissipation. Its working temperature should be less than 40°C Too high the working temperature will cause serious lumen depression and affect lifespan of the light.

The light source of this luminaire is not replaceable, when the light source reaches its end of life the whole luminaire shall be replaced.

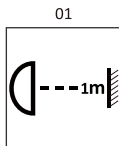
Note:

01 Make sure that the distance between the light and the object being lit is more than 1 meter, so as to avoid high temperature caused by short distance.

FCC ID: 2AWONNTF80

Federal Communication Commission(FCC)Statement for Users Warning:
Changes or modifications not expressly approved by the party responsible for compliance could void the user's authority to operate the equipment.

This device complies with part 15 of the FCC Rules.

Operation is subject to the following two conditions:

- (1) This device may not cause harmful interference, and
- (2) this device must accept any interference received, including interference that may cause undesired operation.

This equipment complies with FCC radiation exposure limits set forth for an uncontrolled environment.

NOTE: This equipment has been tested and found to comply with the limits for a Class B digital device, pursuant to part 15 of the FCC Rules. These limits are designed to provide reasonable protection against harmful interference in a residential installation. This equipment generates, uses and can radiate radio frequency energy and, if not installed and used in accordance with the instructions, may cause harmful interference to radio communications. However, there is no guarantee that interference will not occur in a particular installation. If this equipment does cause harmful interference to radio or television reception, which can be determined by turning the equipment off and on, the user is encouraged to try to correct the interference by one or more of the following measures:

- Reorient or relocate the receiving antenna.
- Increase the separation between the equipment and receiver.
- Connect the equipment into an outlet on a circuit different from that to which the receiver is connected.
- Consult the dealer or an experienced radio/TV technician for help.

Part Two – How to pair the light to Smart Life app?



Step A : Smart Life app installation

Please choose either way below to download and install the app.

(1) As per your phone system, choose the QR code to scan.



iOS



Android

(2) Search keyword 'Smart Life' in Apple Store or Google Play.

Step B: Create an account on Smart Life and login.

Note: Please keep your account and password in mind for Alexa or Google Assistant App pairing later.

Step C : Add the light to Smart Life App

1. Tap '+' button on top right corner to add device, then tap 'lighting' to enter next page.

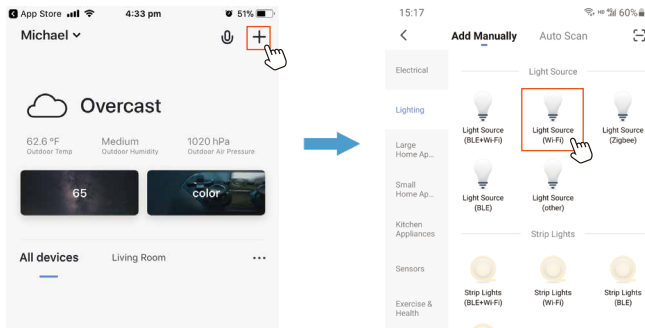

2. WiFi Connection

This smart light only supports 2.4GHz WiFi network, not 5.0GHz. Please make sure your working network is 2.4GHz, and your phone is connected to the required WiFi network.

(1) Power on the light with your own switch.

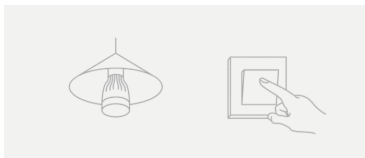

(2) Observe how frequently the light blinks to identify which mode it is in.

- Smart Life App supports two WiFi connections, EZ (Easy) Mode and Access Points (AP) mode. When in EZ Mode, the light blinks rapidly (about 0.5s per blink); when in AP mode, the light blinks slowly (about 3s per blink).

- EZ Mode is the easier way for WiFi connection. When the light is in AP Mode, you can change it to EZ Mode by repeatedly turn on-off-on-off-on the switch to activate the light into rapid blinking status (about 0.5s per blink). And please make sure to keep an interval over 2 seconds between each turn-on and turn-off.

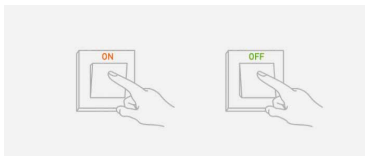

(3) Confirm the light is in EZ Mode, then tap 'confirm' button to proceed. If you need help, tap 'view help' for more details.

Step D : Give a name to the light.

- A simple name is recommended for easier voice recognition with Alexa or Google Assistant.
- The name given to the light will be the same for voice control on Alexa or Google Assistant. For example, the light is named 'smart light' on this user guide.

Step E : The named light will be shown on the app homepage. Now you can control the light (turn on/off, change colors, adjust brightness ect) with Smart Life on the setting page. Turn on or off the light by tapping the bulb icon.

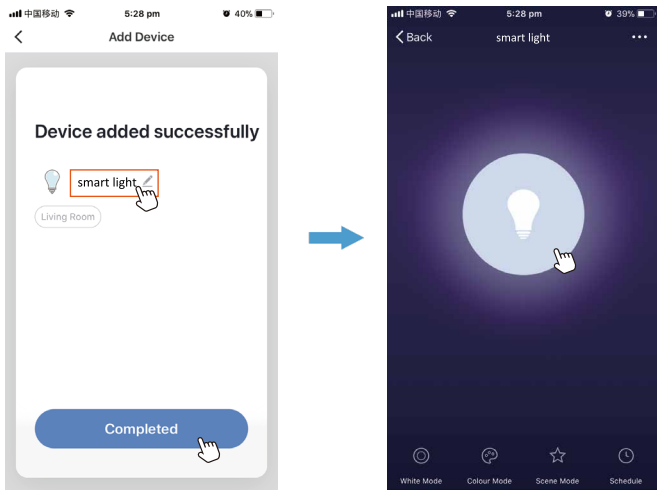

Note: To control the light with Amazon Alexa, please read Part Three. To control the light with Google Assistant, please read Part Four directly.

Part Three – How to control the light with Amazon Alexa?



Please make sure that your Alexa app is connected to Echo, and both work well under your WiFi network.

Step A : Log in your Alexa App, tap top left corner, and tap 'Skills'.

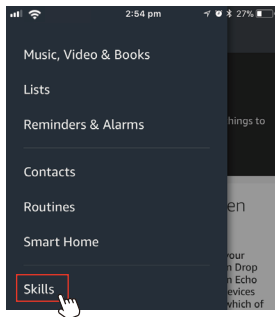
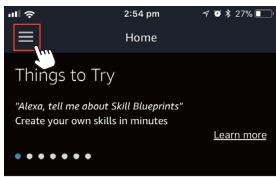

Your Alexa settings have been updated

Household Drop In was enabled from one of your Echo devices or from the Alexa app. The opt-in Drop In feature lets you automatically connect to an Echo device for a voice or a video chat. Your Echo devices with a screen and the Alexa app will indicate which of

Step B : Type 'Smart Life', find 'Smart Life' from the search result and tap it to enable the skill.

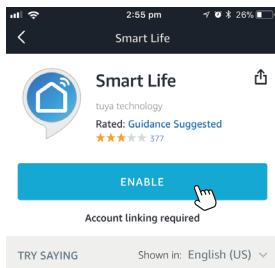
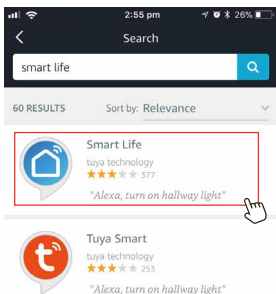

Step C : Enter your Smart Life App account and password. Tap 'Link Now', then tap 'Authorize' on the next page to bind Smart Life account to Alexa.

Step D : When your Smart Life account is bound to Alexa, tap 'DISCOVER DEVICES' to detect the light.

Step C

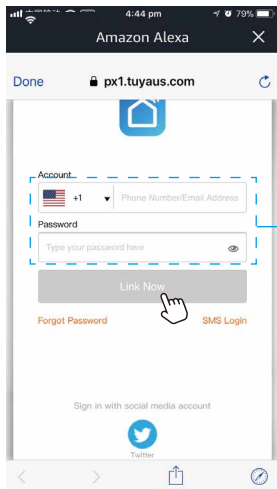

Same account and password
as Smart Life App

Step D

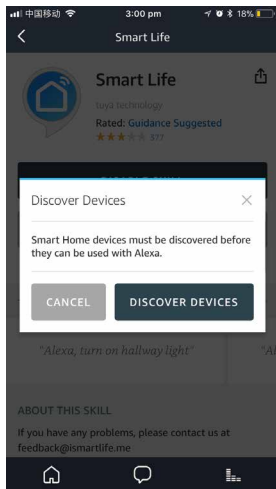

Step E : When the named light is paired to Alexa from Smart Life, it will show on the device page (see the 'smart light' example).

Step F : Now you can control the light with Alexa App on the setting page. To turn on or off the light, simply tap the bulb icon.

Step G : You can also voice control the light with Alexa by giving these commands: “Alexa, turn on ‘device name’ ”, “Alexa, set ‘device name’ to ‘color’ ”, “Alexa, set ‘device name’ to ‘number’ ”. Device name is the one you give to the light. The light is named ‘smart light’ in this user guide. For example, “Alexa, turn on ‘smart light’ ”, “Alexa, set ‘smart light’ to ‘blue’ ” etc.

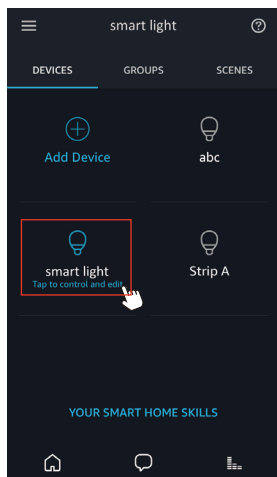

Note: To control the light with Google Assistant, please continue to read Part Four.

Part Four – How to control the light with Google Assistant?



Step A : Login Google Assistant App, tap 'Home Control' on the left side bar page.

Step B : Tap '+' button on the bottom right to enter next page.

Step C : Find 'Smart Life' from side bar list.

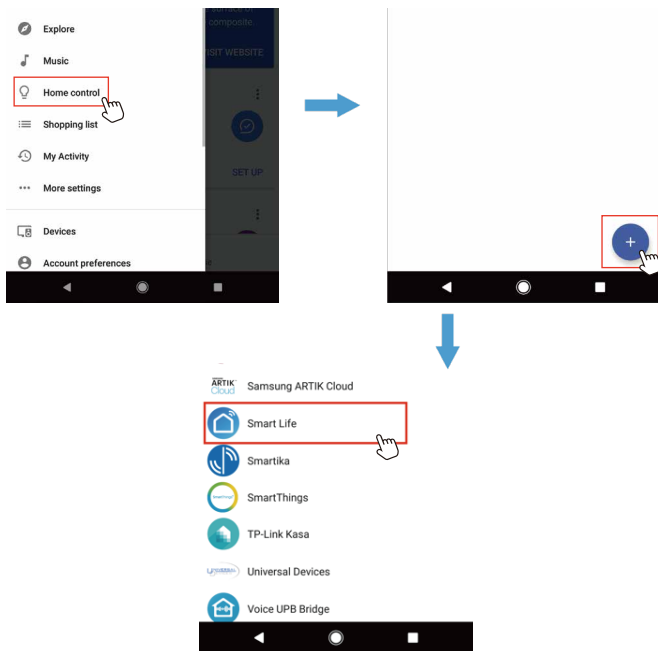

Step D : Enter your Smart Life App account and password to bind Smart Life account to Google Assistant.

Step E : You will find the named light shows on the Home Control page. Now you can control the light on Google Assistant App, or voice control it by giving these commands: “ok Google, turn on ‘device name’ ”, “ok Google, set ‘device name’ to ‘color’ ”, “ok Google, set ‘device name’ to ‘number’ ”.

Device name is the one you give to the light. The light is named ‘smart light’ in this user guide. For example, “ok Google, turn on ‘smart light’ ”, “ok Google, set ‘smart light’ to ‘blue’ ” etc.

Step D

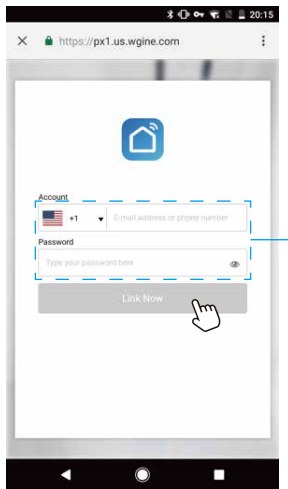

Same account and password
as Smart Life App

Step E

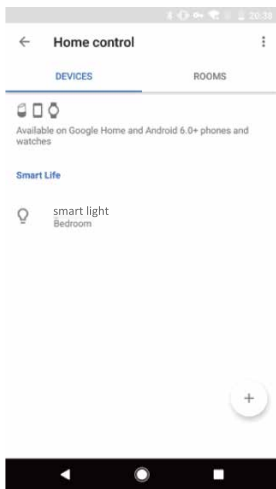

novostella

E-manual

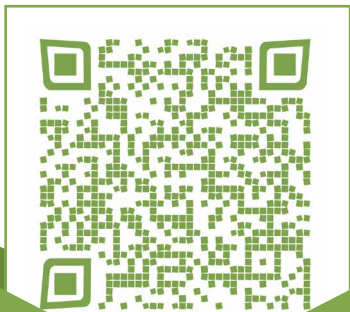

Step 1: Scan the QR code

Step 2: Click E-manual PDF file

Step 3: Read file online or download



Go paper-free, make life easier, and do something good for the environment.



FC IP66 (----)1m

MADE IN CHINA