

Battery Powered LED Security Light

Product Manual

MODEL: 3-LBG10DB

SAFETY INFORMATION

Please read the following content carefully before using the device!

- This product is not a toy. Keep it out of reach from children.
- This product is battery powered, please keep it away from high temperature objects, especially the environment with temperature greater than 85°C.
- The light is weather-resistant.
- Please do not use this product in the environment where with corrosive gas or humid;
- If you do not use the product for a long time, please remove the battery and put it in the dry environment.
- Please pay attention to anti-static during the installation and use of the product. Don't touch the product with sharp tools.
- Do not install the unit on (normally) flammable surfaces.
- The light source of this luminaire is not replaceable; when the light source reaches its end of life the whole luminaire shall be replaced.
- This light is a non-dimmable product. To avoid failure, please don't connect it with the dimming controller.
- Never look directly into the motion light when illuminated.

Battery Replacement Instructions

When replacing the batteries, be sure to Use D batteries only (not included Batteries) Do not mix old and new batteries.
NOTE: Dispose of the D batteries in accordance with local, state
 The battery cannot be treated as household waste and needs to be disposed of separately

COMPONENTS AND STRUCTURE

3-LBG10DB

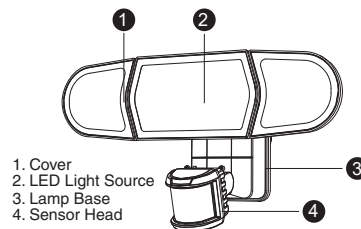
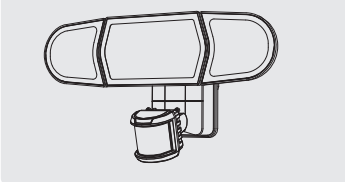

PARTS LIST

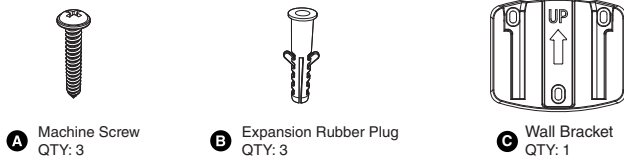

SPECIFICATIONS

Battery Powered LED Security Light	
Model	3-LBG10DB
Input Voltage	5V ⁻⁻⁻
Input Current	1.41A
Rated Power	7W
CCT	6500K
CRI	≥80
Beam Angle	120°
t _a	-20-40°C/-4°F-104°F
Luminaire Location	SUITABLE FOR WET LOCATIONS
DIMENSIONS	
Model	3-LBG10DB
Dimensions (LxHxW)	364x153x205mm / 14.33x6.02x8.07in
Weight	0.58 kg / 1.28 lb
Note:	The testing standard of the product's luminous flux: Place the three/two lights on the same horizontal surface for testing, and the tested luminous flux is the accurate luminous flux.

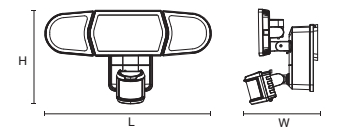

OPERATION INSTRUCTIONS

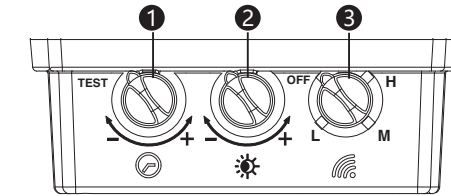

Test Mode :

Adjust knob 1 to "TEST" to confirm whether the light can work normally. After the light detects motion, it will turn on for 5 seconds and then turn off.

Turn the knob to TEST mode, the light can work no matter in day or night.

Setting The Light Activation Time

It can be set according to the consumer's desire. The "-" position (min) is 5sec. The "+" position (max) is 30sec. Time-delay is added continually: When it receives the second induction signals after the first induction, it will compute time once more on the rest of the first time-delay basic (set time).

Knob 2 - Illumination Adjustment

Set the luminance detection. Choose how dark the lights will turn on automatically.

Setting The Motion Detection Distance

It can adjust the installed angle of the sensor to adjust the sensitivity of the sensor. When the knob adjusts to "L", the detection area is very small (about 19.7ft), When the knob adjust to "H", the detection area is large (about 72ft)

L: 19.7-26.2ft
 M: 26.2-39.3ft
 H: 39.3-72ft

Operation Instructions

Detection Range: 180°

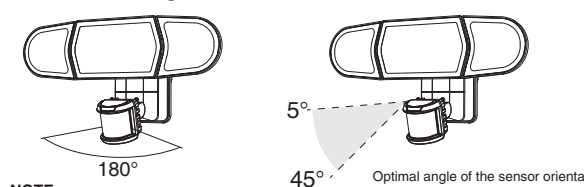

NOTE:

1. The PIR sensor shall always be tilted slightly downward.
2. The orientation angle of the sensor shall be between 5-45°.

RECOMMENDED INSTALLATION HEIGHT: 6.5-13.1 feet above the ground.

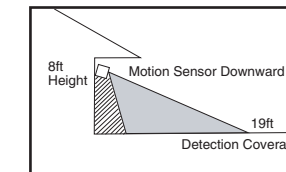
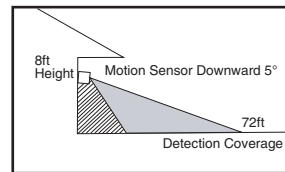

When mounted 8ft above the ground and the sensor is 5° down, the maximum sensing distance is about 72ft.

When mounted 8ft above the ground and the sensor is 45° down, the minimum sensing distance is about 19ft.

Note: The detection distance of the sensor is the farthest when the ambient temperature is 25°C. Any temperature fluctuations above or below 25°C will affect the detection distance. If the light continues to detect motion while it is on, it will remain on until the motion stops.

The sensor will be more sensitive to motion across the motion towards it directly.

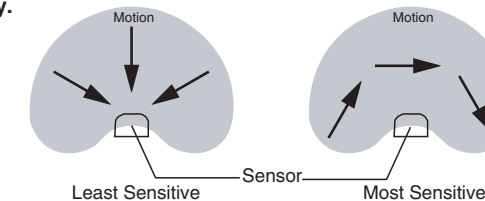

PREPARATION

NOTE:

Before beginning assembly of product, make sure all parts are present. Compare parts with parts list. If any part is missing or damaged, do not attempt to assemble the product. Estimated Assembly Time: 30-60 minutes.

Recommended to be installed on the ground above 2.5m (8.2 ft) and no higher than 5 m (16.4 ft).

Product appearance may vary from image shown.

TOOLS REQUIRED (not included)

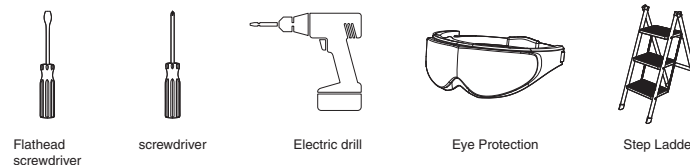

WARNING:

THIS PRODUCT MUST BE INSTALLED IN ACCORDANCE WITH THE APPLICABLE INSTALLATION CODE BY A PERSON FAMILIAR WITH THE CONSTRUCTION AND OPERATION OF THE PRODUCT AND THE HAZARDS INVOLVED.

CAUTION:

PLEASE MAKE SURE YOUR WALL SWITCH AND POWER AT MAIN CIRCUIT BREAKER BOTH ARE OFF.

IF IN DOUBT ABOUT ELECTRICAL INSTALLATION, CONSULT A LICENSED ELECTRICIAN.

7



PREPARATION

RISK OF SHOCK:

BEFORE BEGINNING INSTALLATION, TURN OFF ELECTRICITY AT THE CIRCUIT BREAKER BOX OR THE MAIN FUSE BOX.

NOTE:

BE SURE TO USE WIRE NUTS/CONNECTORS RATED FOR THE CORRECT GAUGE AND NUMBER OF WIRES USED.

MAKE SURE THERE ARE NO EXPOSED WIRE BUNDLES OUTSIDE THE WIRE NUT/CONNECTOR (IF APPLICABLE).

BE CAREFUL NOT TO DAMAGE OR CUT THE WIRE INSULATION (COVERING) DURING INSTALLATION. DO NOT LET THE WIRES TOUCH ANY SHARP EDGES.

WARNING:

DO NOT CONNECT THIS LIGHT FIXTURE TO AN UNGROUNDED ELECTRICAL SYSTEM. ATTACH GROUND FIXTURE WIRE TO EITHER GREEN GROUND SCREW ON MOUNTING PLATE OR THE GROUND WIRE IN THE OUTLET BOX.

INSTALLING THIS LIGHT IN AN UNGROUNDED ELECTRICAL SYSTEM MAY CAUSE THE METAL PARTS OF THE LIGHT TO CARRY CURRENT IF ANY WIRES OR WIRE CONNECTIONS ARE DAMAGED OR LOOSE. IN THIS CASE, ANYONE WHO TOUCHES THE LIGHT WILL RECEIVE AN ELECTRIC SHOCK, RESULTING IN INJURY OR DEATH.

8



INSTALLATION STEPS

1. Refer to the figure on the right to remove and replace the battery.

Note:

- Used batteries/accumulators and lamps should be separated from the equipment.
- The battery type is D battery. The battery cannot be treated as household waste and needs to be disposed of separately.

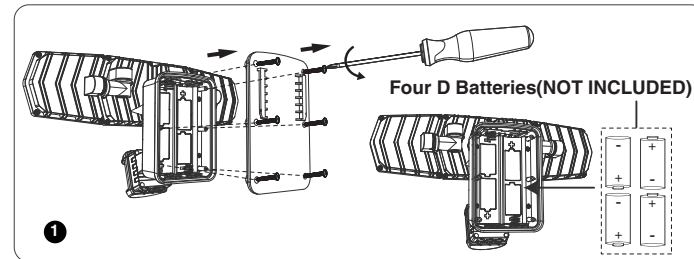

2. Punch holes in the wall, place expansion plugs.

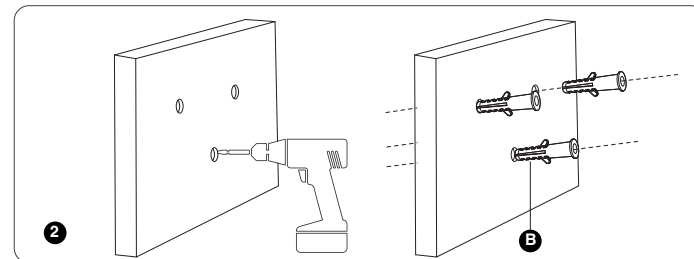

9



INSTALLATION STEPS

3. Screw the wall bracket to the wall.

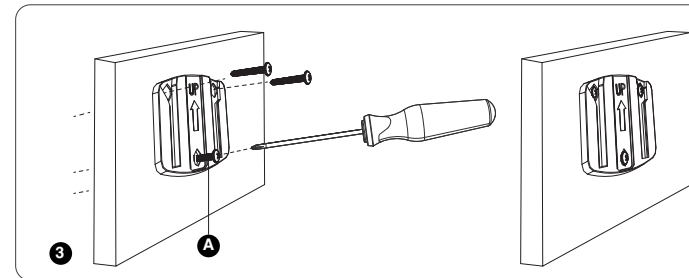

4. Fix the lamp on the wall frame and adjust the angle of the lamp according to your requirement. Installation complete.

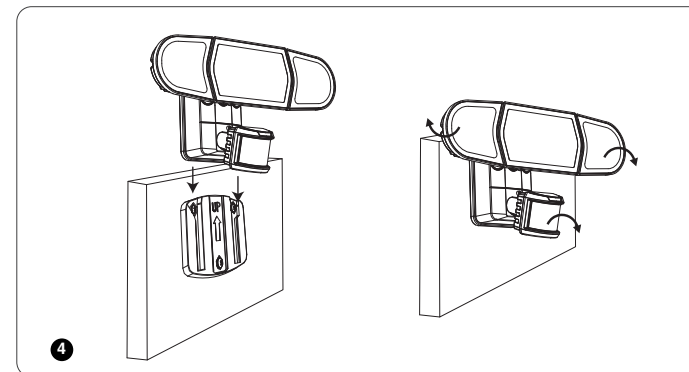

10



Troubleshooting

Malfunction	Cause	Remedy
LED senses a movement, the light does not light up	<ol style="list-style-type: none"> The light is not energized Other surrounding light sources make the light misjudge it as daytime During the day, the brightness is in night mode Internal wiring is loose 	<ol style="list-style-type: none"> Check power-on status Turn off the nearby lights or sensor head to other directions Reset Rewiring after power failure
LED sensor light did not go out, continued to light up	Continuous movement within the sensing range	Check the relevant area and return or override the sensor head if necessary
LED sensor light illuminates during the day	The shadows around the sensor make it mistakenly think it's night	<ol style="list-style-type: none"> Do not cover the sensor head Place the light in a place where the light is bright enough during the day
LED sensor light flashing	Surrounded by other unstable light sources shining onto the induction	Avoid being exposed to such light sources
LED lights turn on unexpectedly	<ol style="list-style-type: none"> Wind blows the branches and bushes within the sensing range Sensing cars on the road Sudden temperature change due to climate factors or fans, exhaust from open windows 	<ol style="list-style-type: none"> Adjust its scope Adjust its scope Change irradiation area

11



FCC Warning:

Any Changes or modifications not expressly approved by the party responsible for compliance could void the user's authority to operate the equipment.

This device complies with part 15 of the FCC Rules. Operation is subject to the following two conditions:

- (1) This device may not cause harmful interference, and
- (2) this device must accept any interference received, including interference that may cause undesired operation.

Note: This equipment has been tested and found to comply with the limits for a Class B digital device, pursuant to part 15 of the FCC Rules. These limits are designed to provide reasonable protection against harmful interference in a residential installation. This equipment generates uses and can radiate radio frequency energy and, if not installed and used in accordance with the instructions, may cause harmful interference to radio communications. However, there is no guarantee that interference will not occur in a particular installation. If this equipment does cause harmful interference to radio or television reception, which can be determined by turning the equipment off and on, the user is encouraged to try to correct the interference by one or more of the following measures:

- Reorient or relocate the receiving antenna.
- Increase the separation between the equipment and receiver.
- Connect the equipment into an outlet on a circuit different from that to which the receiver is connected.
- Consult the dealer or an experienced radio/TV technician for help.

HK JW Illumination Co., Limited
Unit 616, 6/F., Kam Teem Industrial Building,
135 Connaught Road West, Sai Wan Hong Kong

Manufacturer/Hersteller: MDH LIGHTING LTD
Suite 302, 292 Strovolos Avenue, 2048 Strovolos Nicosia,
Cyprus

UK Importer: MDH LIGHTING LTD
69 Aberdeen Avenue, Cambridge CB2 8DL,
United Kingdom

Made in China

✉ support@olafuslife.com 🌐 www.olafuslife.com

