

# User Guide

- Rotating View(capable of continuously tracking movement)

- Click the menu button to display the app features



This screenshot shows the KODAK camera app interface. At the top, there is a video preview window displaying a scene with a car and people on a lawn. Above the preview, the text 'Pixel Selection' points to the 'HD' indicator. To the right, 'Mute/Unmute' points to the speaker icon. Below the preview, a horizontal bar contains icons for switching between horizontal and vertical screens, taking a picture, recording a video, and accessing a menu. The 'Take a picture' label points to the camera icon. Below this bar is a grid of app features. The 'Horizontal screen' label points to the screen rotation icon. The 'Menu' label points to the menu icon. The 'Record a video' label points to the video recording icon. The 'Microphone' label points to the microphone icon. The app features include Playback, Gallery, Theme Color, Private Mode, Night Mode, Anti-Flicker, Device Volume, Motion Tracking, Motion Detection, Light, Gun Ball Linkage, and Edit. A red box highlights the bottom row of features (Motion Detection, Light, Gun Ball Linkage, and Edit), with a red arrow pointing to it from the text 'Swipe up on the interface to reveal the circled app features'. At the very bottom, there are icons for Messages, Direction, Cloud, and Features.

- Mute/Unmute

Take a picture .

– Menu

- Microphone

- Swipe up on the interface to reveal the circled app features

|              |   |
|--------------|---|
| Playback     | You can watch back the previous video recordings here.<br><b>Note:</b> Micro SD Card is required to watch back. |
| Gallery      | Check manual screenshots and recorded videos  |
| Theme Color  | Change the color of the APP interface   |
| Private Mode | Turn off the camera image   |



**Smart Mode:** When someone passes by, the floodlight automatically turns on for 30 seconds, and the video image is in color; after 30 seconds, the floodlight turns off, The infrared light turns on, and the video image is in black and white.

**Infrared Mode:** The infrared light is on, the floodlight is off, and the video image is in black and white.

**OFF:** Both the infrared light and the floodlight are off, and the video image is in color. However, please note that without additional lighting, the clarity of the image may be compromised.

**During the day**  
In all three modes, the floodlight and infrared light are both off, and the video image is in color.

### During the day

In all three modes, the floodlight and infrared light are both off, and the video image is in color.

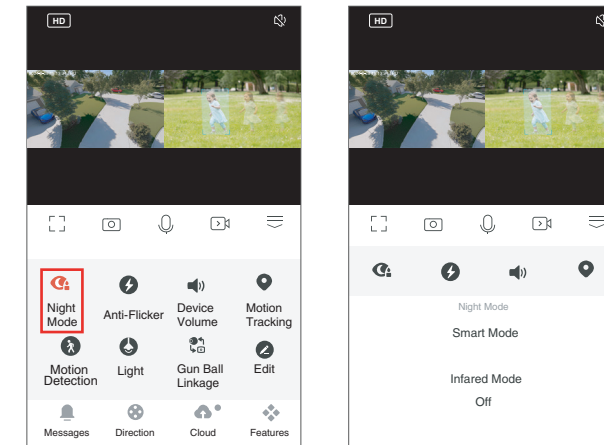

Click to start motion tracking - the camera dynamic tracking will follow the person, if there is no continuous movement after 1 minute, the camera will return to the original position.

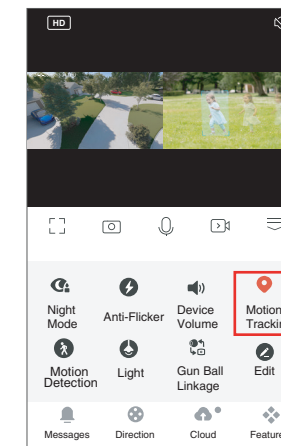

Start motion monitoring, when the camera detects the movement of an object, it will alert you via a message.  
After enabling Motion Detection, the camera will notify you of any movement, and the floodlight will automatically turn on at night when motion is detected, turning off after 30 seconds.

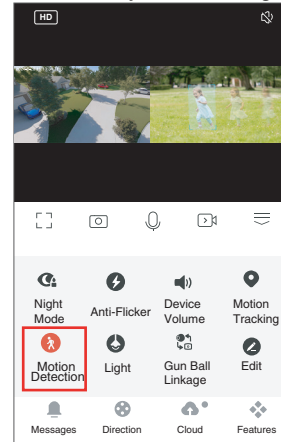

If there are too many notifications or the motion detection is too sensitive, you can set it as follows.

1. Turn off the motion detection alarm

1. Turn off the motion detection alarm

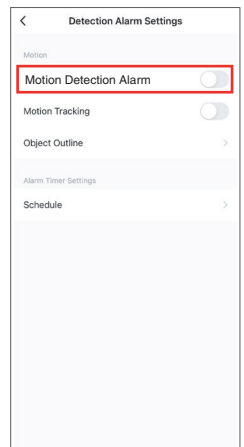
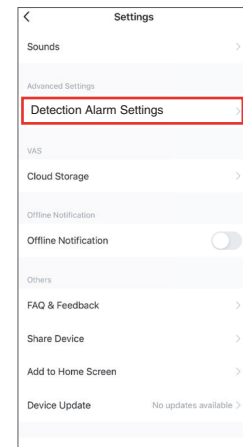
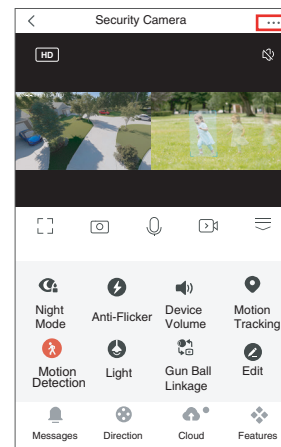

**Detection Alarm Settings**

Motion

Motion Detection Alarm ☒

**Alarm Sensitivity Level** Low >

Human Body Filtering ☐

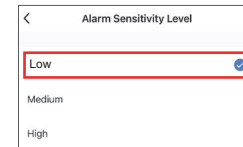

## HOW TO OPERATE THE APP

### 3. Enable Human Body Filtering

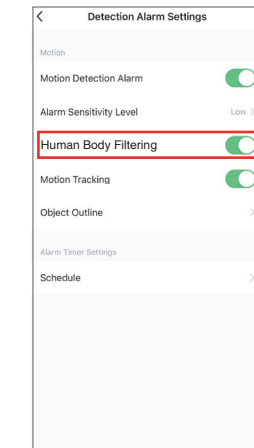

### 4. Set alarm timing

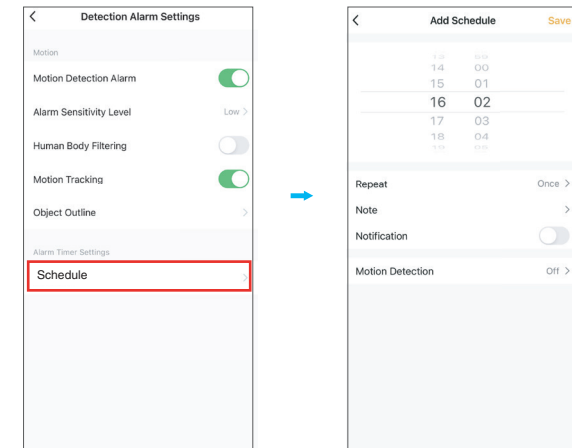

### Light Control

Click on Light, then you can control the light on/off, brightness, and timing.

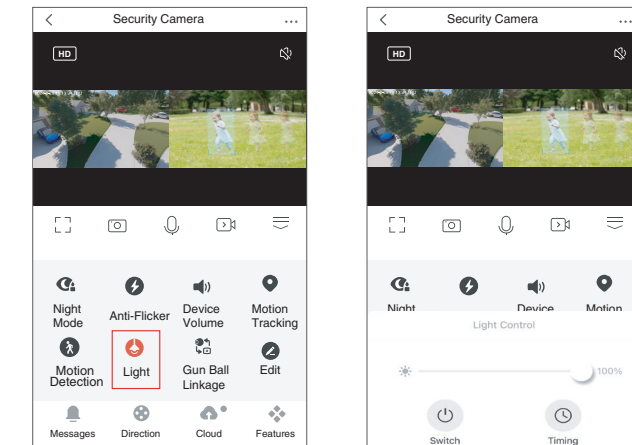

## HOW TO OPERATE THE APP

The angle of the camera can be manually adjusted.

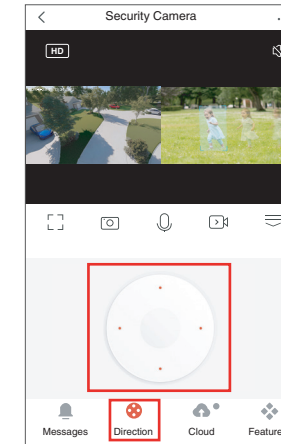

### One-way/two-way communication mode settings

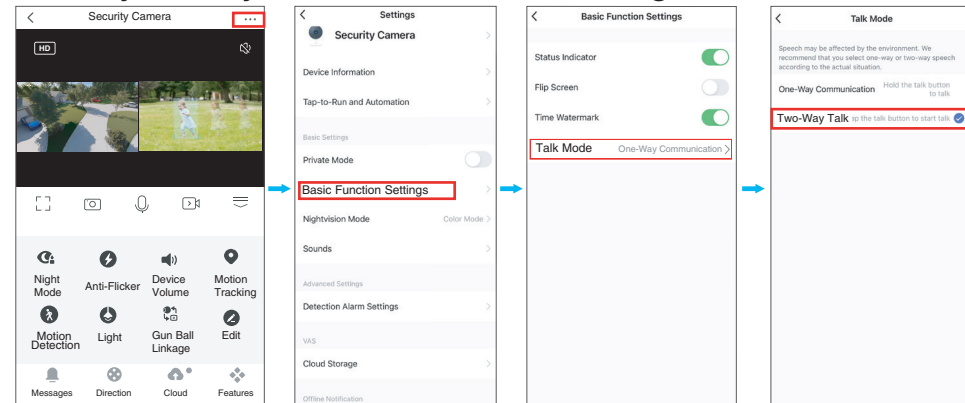

### Video Recording Settings

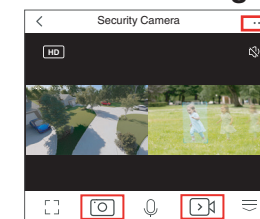

1. Without a Micro SD card, videos can't be auto-saved or replayed. Only manual photo capture or video recording is supported for storage on the phone.



## HOW TO OPERATE THE APP

2. Micro SD card not included and requires installation; installation instructions can be found on page 7 of the App Download and Quick Connection Guide.

1) After inserting the Micro SD card, you need to enable the local recording to support playback.

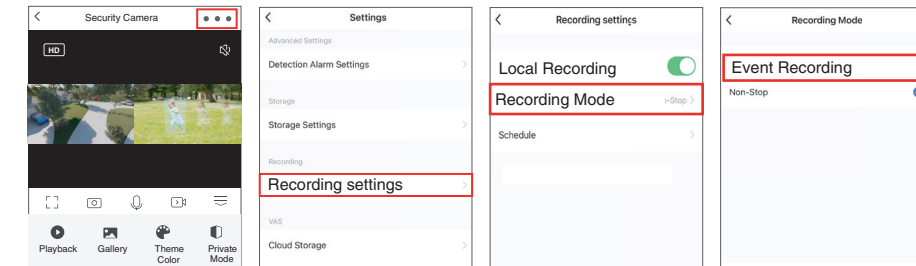

2) To ensure effective recording of the memory card, you can set the **Recording Mode to Event Recording**.

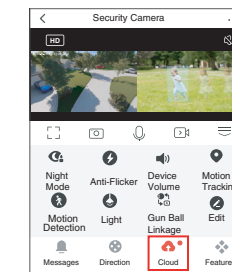

3. Cloud storage (requires subscription) allows video playback without a Micro SD card.



## HOW TO OPERATE THE APP

### Share the device

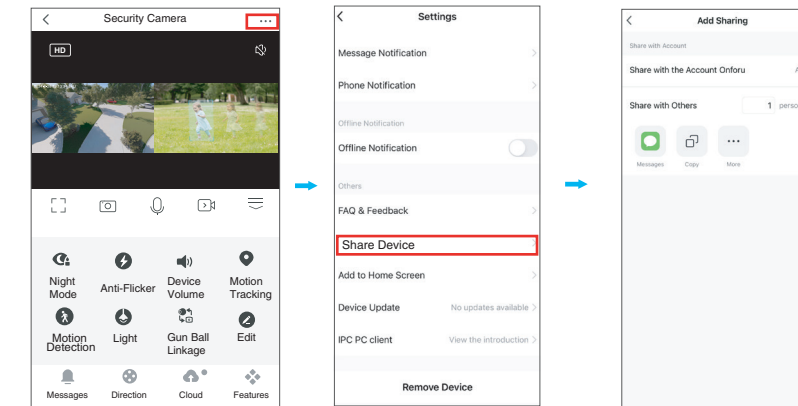

You can choose to share the device to other members of the family.

**Note:** Shared family members can only view monitoring and notifications, but cannot set up the monitor.

### Remove the device

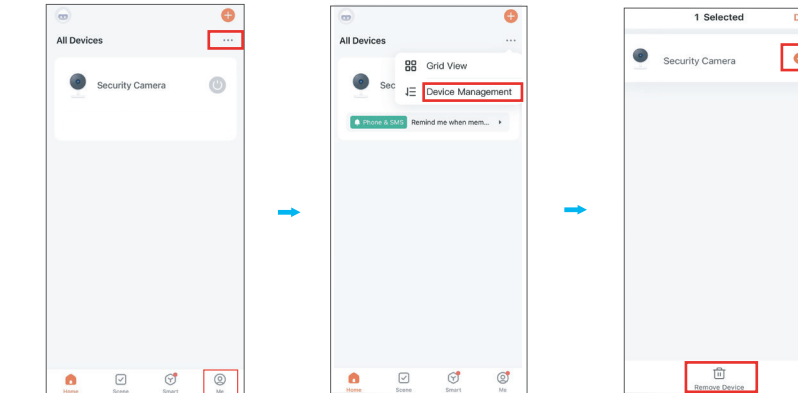

When you replace your phone, or someone else wants to connect to the device, be sure to remove the device from your old phone first.

**Note:** For security reasons, the device can only be connected by one person at a time. If someone else wants to see the camera information at the same time, you can refer to "Share the device".



## HOW TO CONNECT WITH ALEXA SHOW AND GOOGLE ASSISTANT APP

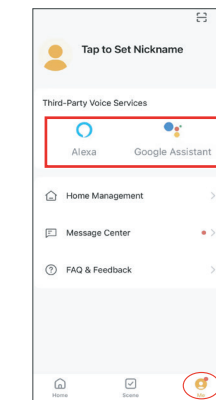

Tap "Me" and find the third-party voice device you want to connect to and tap it, then follow the steps to connect.

**Note: If Alexa fails to discover my devices?**

- Check if there are any Internet connection problems.
- Try to reboot the smart device and re-discover the device on Alexa.

