

BISSELL®

Experts In Home Cleaning™

CLEANview® REACH

USER'S GUIDE

14U6, 37Y8 SERIES 220-240V

- 2 Thank You
- 3 Safety Instructions
- 4 Product View
- 5 Assembly
- 6-10 Operations
- 11 Maintenance and Care
- 12 Troubleshooting
- 13 Replacement Parts
- 14 Accessories
- 15 Warranty
- 16 Consumer Care



Thanks for buying a BISSELL CleanView® Reach deep cleaner

We're glad you purchased a BISSELL CleanView® Reach deep cleaner. Everything we know about floor care went into the design and construction of this complete, high-tech home cleaning system.

Your BISSELL CleanView® Reach deep cleaner is well made, and we back it with a limited two year warranty. We also stand behind it with a knowledgeable, dedicated Consumer Care department, so, should you ever have a problem, you'll receive fast, considerate assistance.

My great-grandfather invented the floor sweeper in 1876. Today, BISSELL is a global leader in the design, manufacture, and service of high quality homecare products like your BISSELL CleanView® Reach deep cleaner.

Thanks again, from all of us at BISSELL.

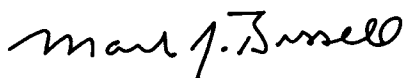

Mark J. Bissell
Chairman & CEO

IMPORTANT SAFETY INSTRUCTIONS

When using an electrical appliance, basic precautions should be observed, including the following:

READ ALL INSTRUCTIONS BEFORE USING YOUR DEEP CLEANER.

Always connect to a properly Earthed outlet. Unplug from outlet when not in use and before conducting maintenance or troubleshooting.

WARNING: To reduce the risk of fire, electric shock, or injury:

- Use indoors only
- Do not immerse; use only on surfaces moistened by cleaning process
- Do not leave machine when it is plugged in
- Do not service machine when it is plugged in
- If the supply cord is damaged, it must be replaced by the manufacturer or its service agent in order to avoid a hazard
- Do not use machine if it has been dropped, damaged, left outdoors or dropped into water
- Do not pull or carry by cord, use cord as a handle, close door on cord, pull cord around sharp corners or edges, run appliance over cord, or expose cord to heated surfaces
- Do not carry the appliance while in use
- Do not unplug by pulling on cord; unplug by grasping plug not the cord
- Do not handle plug or appliance with wet hands
- Do not put any object into appliance openings, use with blocked opening or restrict air flow
- Do not expose hair, loose clothing, fingers or body parts to openings or moving parts
- Do not pick up hot or burning objects
- Do not pick up flammable or combustible materials (lighter fluid, petrol, kerosene, etc.) or use in the presence of explosive liquids or vapours
- Do not use appliance in an enclosed space filled with vapours given off by oil base paint, paint thinner, some moth proofing substances, flammable dust, or other explosive or toxic vapours
- Remove plug from electrical outlet before cleaning or maintaining the appliance

- Not intended for use by persons (including children) with reduced physical, sensory or mental capabilities, or lack of experience and knowledge, unless they have been given supervision or instruction concerning use of the appliance by a person responsible for their safety
- Young children should be supervised to ensure that they do not play with the appliance
- Do not pick up toxic material (chlorine bleach, ammonia, drain cleaner, petrol, etc.)
- Do not modify the Earthed plug
- Do not use for any purpose other than described in this User's Guide
- Use only manufacturer's recommended attachments
- Use only cleaning products formulated by BISSELL for use in this appliance to prevent internal component damage
- Keep openings free of dust, lint, hair, etc.
- Keep appliance on a level surface
- Turn off all controls before unplugging
- Be extra careful when cleaning stairs
- Pay close attention when working around children

SAVE THESE INSTRUCTIONS FOR FUTURE USE

This model is for household use only.

WARNING:

This appliance must be Earthed.

IMPORTANT

FOR OPERATION ON A 220-240 VOLT A.C. 50/60 Hz POWER SUPPLY ONLY.

If your appliance is fitted with a nonrewireable BS 1363 plug it must not be used unless a 13 amp (ASTA approved to BS 1362) fuse is fitted in the carrier contained in the plug. (Spares may be obtained from your BISSELL supplier). If for any reason the plug is cut off, it must be disposed of, as it is an electric shock hazard should it be inserted into a 13 amp socket.

Product view



⚠ WARNING:
 To reduce the risk of fire and electric shock due to internal component damage, use only BISSELL cleaning formulas intended for use with the deep cleaner.

Cleaning formula:

Keep plenty of genuine BISSELL 2X cleaning formula on hand so you can clean and protect whenever it fits your schedule. Always use genuine BISSELL deep cleaning formulas. Non-BISSELL cleaning formulas may harm the machine and will void the warranty.



709 mL
 BISSELL
 2X Fibre-
 Cleansing
 Advanced
 Formula with
 Scotchgard™
 protector
#62E5-E



709 mL
 BISSELL
 2X Multi-
 Allergen
 Advanced
 Formula with
 Scotchgard™
 protector
#89Q5-E



709 mL
 BISSELL 2X
 Pet Stain
 & Odor
 Advanced
 Formula with
 Scotchgard™
 protector
#99K5-E



473 mL
 BISSELL 2X
 Hard Floor
 Solutions
#56L9-E



709 mL
 BISSELL 2X
 Natural
 Orange
 Advanced
 Formula with
 Scotchgard™
 protector
#83P3-E



709 mL
 BISSELL
 2X Lavender
 Essence
 Advanced
 Formula with
 Scotchgard™
 protector
#34B5-E



651 mL
 BISSELL
 Tough Stain
 Precleaner
#0400-E



651 mL
 BISSELL
 Pet Stain
 & Odor
 Remover
#790-E

NOTE: Additional BISSELL formula options may be available at your local retailer.

Assembly

Your CleanView® Reach assembles quickly and easily. The only tool you will need for assembly is a Phillips head screwdriver.

1. Locate the screw pack, which is taped to the upper handle.
 2. Slide the upper body onto the lower body, taking care not to leave a gap between the upper and lower body.
 3. Firmly holding the upper body, screw the 2 screws into the holes marked with arrows.
 - TIP:** If you are having difficulty tightening the screws, remove, re-insert, and tighten again.
 4. Slide the hose wrap onto the upper handle as pictured and push up until it snaps into place.
 5. Slide the upper handle into the upper body until it will not go any farther and secure it with a screw at the marked screw hole above the water tank.
 6. After tightening the screws, ensure proper fit between the upper and lower body by trying to separate the two. If assembled properly, there should be no gap. If a gap appears between the two (see picture at right), continue to tighten the screws until no gap is present.
 7. Place solution tank on back of unit.
 8. Wrap power cord and flex hose.
 9. Keep flex hose snugly in place by using the hose secure latch.
 10. Attach tool to end of hose.
- Assembly is now complete.**



3.

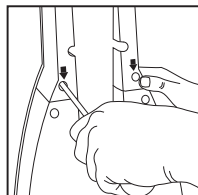

4.



5.



6.

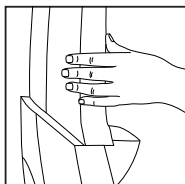

INCORRECT

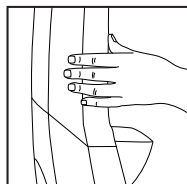

CORRECT

7.



8.



9.



10.

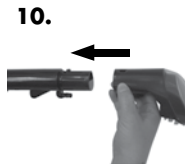

Operations

Special features

Your BISSELL CleanView® Reach is a home cleaning system that uses a combination of hand hot tap water, BISSELL cleaning formula, brush agitation and suction to safely clean carpets.

DirtLifter™ Powerbrush

The DirtLifter PowerBrush is designed to enhance cleaning performance. The bristle pattern safely lifts out the deep down dirt while gently grooming carpet fibers. The floating suspension self-adjusts to all carpet heights. When the power is ON and the machine is in the upright position, your carpet is protected because the brush is lifted up off the carpet.

ReadyTools™ Dial

The Ready Tools feature allows you to choose between FLOOR CLEANING or cleaning with TOOLS simply by turning the dial. The TOOLS setting allows for above floor cleaning of upholstery, stairs, creases along baseboards, and other hard to reach areas. Simply choose the tool that is appropriate for the job, attach to flex hose and you are ready to go.

Microban® antibacterial protection

Microban antibacterial product protection helps prevent the growth of harmful common household bacteria including E. coli, Salmonella and Staph. a. It helps to keep the unit fresher and cleaner between uses.

Scotchgard™ Protector

Carpet protection applied at the mill typically wears down over time from heavy foot traffic and everyday cleaning, including deep cleaning. To help restore this important protection, only BISSELL offers cleaning formulas with Scotchgard protector. This offers extra protection against dirt and tough stains to keep your carpets looking good longer.

Before you clean

1. Move furniture to another area if cleaning an entire room. (Optional)
2. Vacuum carpet thoroughly.
3. Plan your cleaning route to leave an exit path. It is best to begin cleaning in the corner farthest from your exit.

⚠️ WARNING:

To reduce the risk of fire, use only BISSELL deep cleaning formula for full size machines in your deep cleaner. Use of cleaning formulas that contain lemon or pine oil may damage this appliance and void the warranty. Chemical spot cleaners or solvent-based soil removers should not be used. These products may react with the plastic materials used in your deep cleaner causing cracking or pitting.



More than 7 million Australians suffer from asthma and allergies.

The Sensitive Choice program has been developed by the National Asthma Council Australia to help Australians and New Zealanders make better lifestyle choices that may help manage asthma and allergies more effectively.

The BISSELL range of deep carpet cleaners and deep carpet cleaning formulas has been approved by the National Asthma Council Australia's Sensitive Choice program, and carries the Sensitive Choice butterfly logo. The Sensitive Choice blue butterfly symbol is a way of recognising products and services that support asthma and allergy care. Products that carry the blue butterfly may be better choices for people with asthma and allergies.

To learn more about managing asthma and allergies, visit the Sensitive Choice website at: www.sensitivechoice.com.au

Operations

Before you clean continued

- 4. Pre-Treating** (optional) Pre-treat stubborn stains and highly soiled carpet in hallways and other high-traffic areas.
 - 4a.** Generously spray BISSELL Tough Stain Precleaner evenly over soiled area.
Caution: DO NOT OVER WET CARPET
 - 4b.** Wait 3-5 minutes before deep cleaning.

Fill the tank

1. Remove the solution tank by lifting it straight up, then away from the lower body.
2. Unscrew the black cap at the bottom of the solution tank.
3. Fill with hand hot tap water to the WATER line. Fill the rest of the tank with BISSELL 2X Formula to the FORMULA line. Replace and tighten the black cap.
4. Place solution tank on lower body.

Carpet cleaning

1. Set ReadyTools dial to "FLOOR CLEANING".
2. Plug into proper outlet.
3. Turn the power switch to the ON (I) position (located on the back of unit)
4. With foot, press the red recline lever (located on the back of unit).
5. **Cleaning Strokes.** While pressing the spray trigger, make one slow forward wet pass and another one back. **Caution: Do not overwet.**
6. Release the spray trigger and make one slow forward and backward pass over the same area.
7. Repeat steps 4 and 5 until solution being pulled up appears clean.
8. Empty the collection tank when dirty water reaches the full line, or when the solution tank is empty.

Empty the collection tank

1. Turn power switch OFF (O) and unplug power cord from outlet.
2. Remove the collection tank from base of unit.

⚠ ATTENTION:

Some Berber carpets have a tendency to fuzz with wear. Repeated strokes in the same area with an ordinary vacuum or deep cleaner may aggravate this condition.

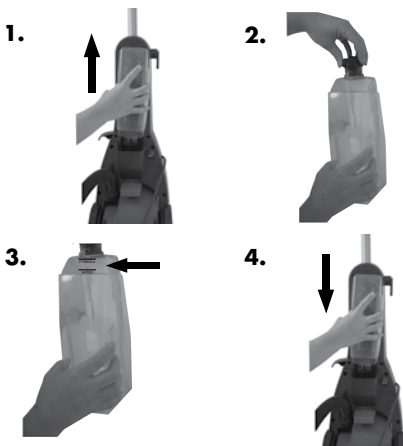

Operations

Empty the collection tank continued

- 2a.** Release collection tank latches (on each side) by pulling up from the bottom of latch and then out.
- 2b.** Carefully remove the top of the tank by lifting up on the tank handle.
- 3.** Carry collection tank to a toilet or sink. To empty, pour out contents using opening at back of tank.
- 4.** Rinse collection tank thoroughly and replace on unit.
- 5.** Refill solution tank and continue cleaning.

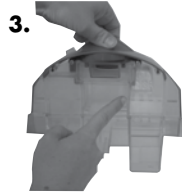
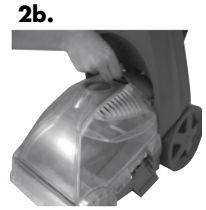

Cleaning with Attachments

Your CleanView Reach is equipped with a hose and at least one attachment for cleaning stairs, upholstery, and more.

- 1.** Important! If using to clean upholstery, check upholstery tags.
 - 1a.** Check manufacturer's tag before cleaning. "W" or "WS" on the tag means you can use your CleanView® Reach. If the tag is coded with an "X" or an "S" (with a diagonal stripe through it), or says "Dry Clean Only", do not proceed with any deep cleaning machine. Do not use on velvet or silk. If manufacturer's tag is missing or not coded, check with your furniture dealer.
 - 1b.** Check for colourfastness in an inconspicuous place.
 - 1c.** If possible, check upholstery stuffing. Coloured stuffing may bleed through fabric when wet.
 - 1d.** Plan activities to allow upholstery time to dry.
 - 1e.** Vacuum area thoroughly.
- 2.** Follow the instructions on page 7 for filling the tank.
- 3.** Set the ReadyTools dial to the "TOOLS" setting.
- 4.** Attach the cleaning tool to the end of the hose.
- 5.** Plug in and turn the power switch to the ON position.

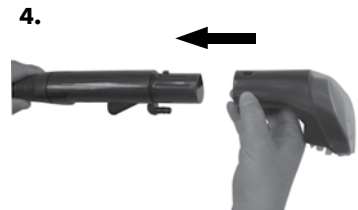

Operations

Cleaning with Attachments continued

6. Clean by pressing the spray trigger to spray solution onto the area to be cleaned. Slowly move the tool back and forth over the soiled surface. Release the spray trigger to suction dirty water. Continue to clean in the area, working in small sections, until dirt is removed.

Caution: Do Not Overwet.

7. When finished cleaning, remove and rinse tool(s) in clean, running water.

8. It is recommended that you suction clean water from a bowl to rinse out the hose.

9. Lift end of hose and stretch out to ensure all water is cleared from hose.

10. Wrap flex hose around hose wrap.

11. Empty collection tank and rinse out, following instructions on page 10 under "Cleaning after use."

12. Return ReadyTools dial to "FLOOR CLEANING" setting.



Deep reach tool attachment

(Select models only)

1. Follow the instructions on page 7 for Filling the tank.

2. Follow instructions 1-5 on page 8 under "Cleaning with attachments".

3. Set tool on stain and press the spray trigger to spray trigger solution onto the area to be cleaned.

4. Slowly move the tool back and forth over the soiled surface, keeping the tool in contact with the carpet.

5. Release the spray trigger and move tool slowly over the soiled area to suction up water and dirt.

6. Continue to clean the area, working in small sections, until no more dirt can be removed.

7. Remove tool from hose when finished. Clean under warm water before storing.

8. Follow cleaning attachment instructions on pages 8 and 9, instructions 8-12.

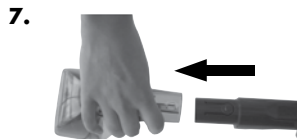

Operations

Hard floor cleaning

(Select models only)

1. Remove the collection tank (refer to steps 2a and 2b on page 8).
2. Attach the hard floor tool by hooking it into the front of the removable nozzle and rotate until it snaps firmly in place.
3. Replace the collection tank. Be sure to attach the two latches.
4. Fill the solution tank with warm tap water to the WATER fill line. Fill the rest with BISSELL 2X Hard Floor Solutions™ to FORMULA fill line.
5. Follow steps 1-8 under "Carpet Cleaning" on page 7 to continue cleaning.

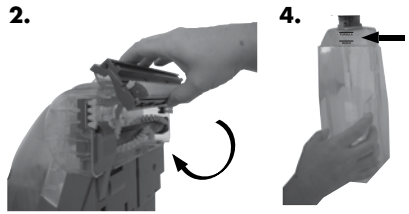

⚠ WARNING:

To reduce the risk of fire and electric shock- when cleaning a hard floor, the BISSELL hard floor tool (203-5548) must be used and it must only be used with BISSELL 2X Hard Floor Solutions cleaning fluid intended for use with this appliance.

Cleaning after use

1. Unplug the unit.
2. Rinse collection tank thoroughly.
 - 2a. Remove ReadyTools Dial by rotating it halfway between "TOOLS" & "FLOOR CLEANING."
 - 2b. Pop out knob by using the opening on the back of the tank. Rinse and replace knob and collection tank.
3. Remove tank vent & foam filter (located on top of the collection tank) and rinse.
4. Clean nozzle window by lifting latch and removing from machine. Rinse under running water.
5. When finished replace nozzle and secure with latch.

NOTE: For best results, it is recommended that the nozzle is cleaned after each use.
6. Remove lint and hair from red gasket in base of unit. (Do not remove gasket)
7. Replace the collection tank to the base of the machine and secure with latches.

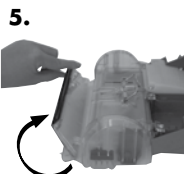

Maintenance and care

Machine storage

For best results, a few simple steps can assure your machine is well maintained after your cleaning is complete.

1. Wrap power cord around Quick Release Cord Wrap™ on side of the machine.
2. Wipe all surfaces with a soft cloth. Store cleaner upright in a protected, dry area.

NOTE: You may have cleaning solution remaining in the solution tank. You may store your machine this way for the next cleaning task, but never keep dirty water in the collection tank.



WARNING:

To reduce the risk of injury from moving parts and/or electrical shock, turn power switch OFF and disconnect plug from electrical outlet before performing maintenance or troubleshooting checks.



CAUTION:

Do not store unit where freezing may occur. Damage to internal components may result.

Troubleshooting

Reduced Spray OR No Spray in Upright Mode

Possible causes

1. Solution tank empty
2. Lint screen on solution tank cap clogged
3. Upper body not properly attached.

Remedies

1. Refill tank with water and formula
2. Soak solution tank cap in warm water and then rinse under running water
3. Repeat steps 2-4 on page 5.

Reduce Spray or No Spray Attachment

Possible causes

1. Solution tank empty
2. Spray nozzle clogged
3. Pump needs priming
4. Machine is reclined
5. ReadyTools dial is set to "FLOOR CLEANING"

Remedies

1. Refill tank with water and formula
2. Clean spray nozzle by rinsing tool under water
3. Place tool on floor and press spray trigger
4. Return machine to full upright position until it locks into place
5. Choose "TOOLS" setting on ReadyTools dial

Deep cleaner not picking up cleaning solution

Possible causes

1. Collection tank not aligned/secured
2. Collection tank full
3. Removable nozzle installed improperly
4. Removable nozzle full of debris
5. Red lint screen under collection tank clogged
6. ReadyTools dial not set properly

Remedies

1. Check tank alignment and secure with side latches
2. Empty tank
3. Unplug unit. Align four "hooks" into bottom first, then snap into place on top
4. Unplug unit. Remove nozzle and rinse under running water
5. Remove debris from lint screen
6. Choose either "FLOOR CLEANING" or "TOOLS" for desired cleaning method

Brush not turning

Possible causes

1. Handle not reclined.

Remedies

1. Press the red recline lever on the back of the unit to activate the brush. Follow step 4 under "Carpet cleaning" on page 7.

Other maintenance or service not included in the manual should be performed by an authorized service representative.

Thank you for selecting a BISSELL product.

Please do not return this product to the store.

Replacement parts

Below please find a list of common replacement parts. While not all of these parts may have come with your specific machine, all are available to you for purchase, if desired.

Item	Part No.	Part Name
1	203-8116	Handle Assembly (includes screws)
2	203-5661	Solution Tank (Includes Cap and Insert Assembly)
3	203-8117	Collection Tank (with diverter)
4	203-5680	DirtLifter™ PowerBrush
5	203-8118	Cord Wrap (upper)
6	203-8132	Hose Wrap Clip
7	203-8119	Upper body with Screws
8	203-5659	Lower Hose Wrap
9	203-8120	Nozzle
10	203-5541	Solution Tank Cap & Insert

*Not all parts are included with every model.

1



2



3



4



5



6



7



8



9



10



Accessories

Below please find a list of common replacement parts. While not all of these parts may have come with your specific machine, all are available to you for purchase, if desired.

Item	Part No.	Part Name
1	203-6651	3" Tough Stain Tool
2	203-6652	Powered TurboBrush™ Hand Tool
3	203-6653	4" Upholstery Tool
4	203-6654	6" Stair Tool
5	203-6655	Spraying Crevice Tool
6	203-7569	Deep Reach™ Tool
7	203-5683	Hard Floor Tool

*Not all parts are included with every model.

1



2



3

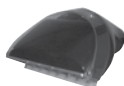

4



5



6



7



NOTE: Additional BISSELL formula options may be available at your local retailer.

2 Year GUARANTEE

This guarantee applies in Australia and New Zealand only. For the guarantee in another country, please contact your local retailer/distributor.

Your new BISSELL vacuum which has been fully tested, inspected and adjusted, carries in the case of domestic users, a one year parts and labour guarantee against defects. This product is warranted 90 days for commercial usage.

This vacuum is intended for domestic household use only. Do not use as dry Vacuum machine or on hard floors.

Brushes and filters, unless actually defective in manufacture are not subject to this guarantee since their length of life depends upon usage and care given. Any transportation costs involved in the repair of the appliance or the replacement of a defective part shall be borne by the claimant.

This guarantee commences from the date of purchase of the cleaner.

When properly use and cared for, your new vacuum will render excellent service, and therefore, the purchaser should carefully read the instruction book, as misuse or failure to follow the instructions makes this guarantee void.

It also becomes void if the product is used on an electric voltage other than that shown on the rating plate.

E.H.A Pty Ltd is unable to accept responsibility under this guarantee for damage from repair work carried out by other than authorised service retailers or centres, or from the use of other than genuine parts.

The guarantee does not apply to the cost of replacing any part of the product due to normal wear at tear, alteration, improper installation, physical abuse, misuse or accident.

In the event of service or advice being needed, please contact your retailer. The benefits conferred by this guarantee are in addition to all other rights and remedies in respect of the product which the consumer has under the Trade Practises Act and other State and Territory laws.

KEEP THIS GUARANTEE AND YOUR RECEIPT AS PROOF OF PURCHASE

Purchase Date/ /.....

Our policy is one of continuous development and accordingly we reserve the right to change specifications without prior knowledge.

e.h.a pty Ltd (ACN 007 539 577)

Locked Bag 120 Silverwater D.C. 1811 NSW

If your BISSELL product should require service:

Call BISSELL Consumer Care at the numbers below and we will give you the location of a BISSELL Authorized Service Center in your area. If you have questions about your warranty or need replacement parts please contact the numbers below.

For Australian inquiries:

Monday – Friday 9 am - 5 pm

BISSELL AUSTRALIA PTY LIMITED

42 Roco Drive

Scoresby 3179

Victoria

Australia

Telephone: 1-800-811-183

For all other inquiries:

Monday – Friday 8 am - 4 pm

BISSELL Homecare, Inc.

PO Box 1888

Grand Rapids, Michigan 49501 USA

Telephone: 01-616-453-4451

Fax: 01-616-453-1383

For New Zealand inquiries:

Monday – Friday 9 am - 5 pm

Parex Industries LTD.

5 Tolich Place

Henderson 0610

Auckland

New Zealand

Telephone: 0800-247-735

Or visit the BISSELL website - **www.bissell.com**

When contacting BISSELL, have model number of cleaner available.

Please record your Model Number: _____

Please record your Purchase Date: _____

NOTE: Please keep your original sales receipt. It provides proof of purchase date in the event of a warranty claim. See Warranty on page 15 for details.



Experts In Home Cleaning™

©2013 BISSELL Homecare, Inc.
Grand Rapids, Michigan
All rights reserved. Printed in China
Part Number 160-0793
Rev 12/12

Visit our website at:
www.bissell.com

Scotchgard is a trademark of 3M
Microban® is a registered trademark
of Microban Products Company