

TOP
scale 1:3

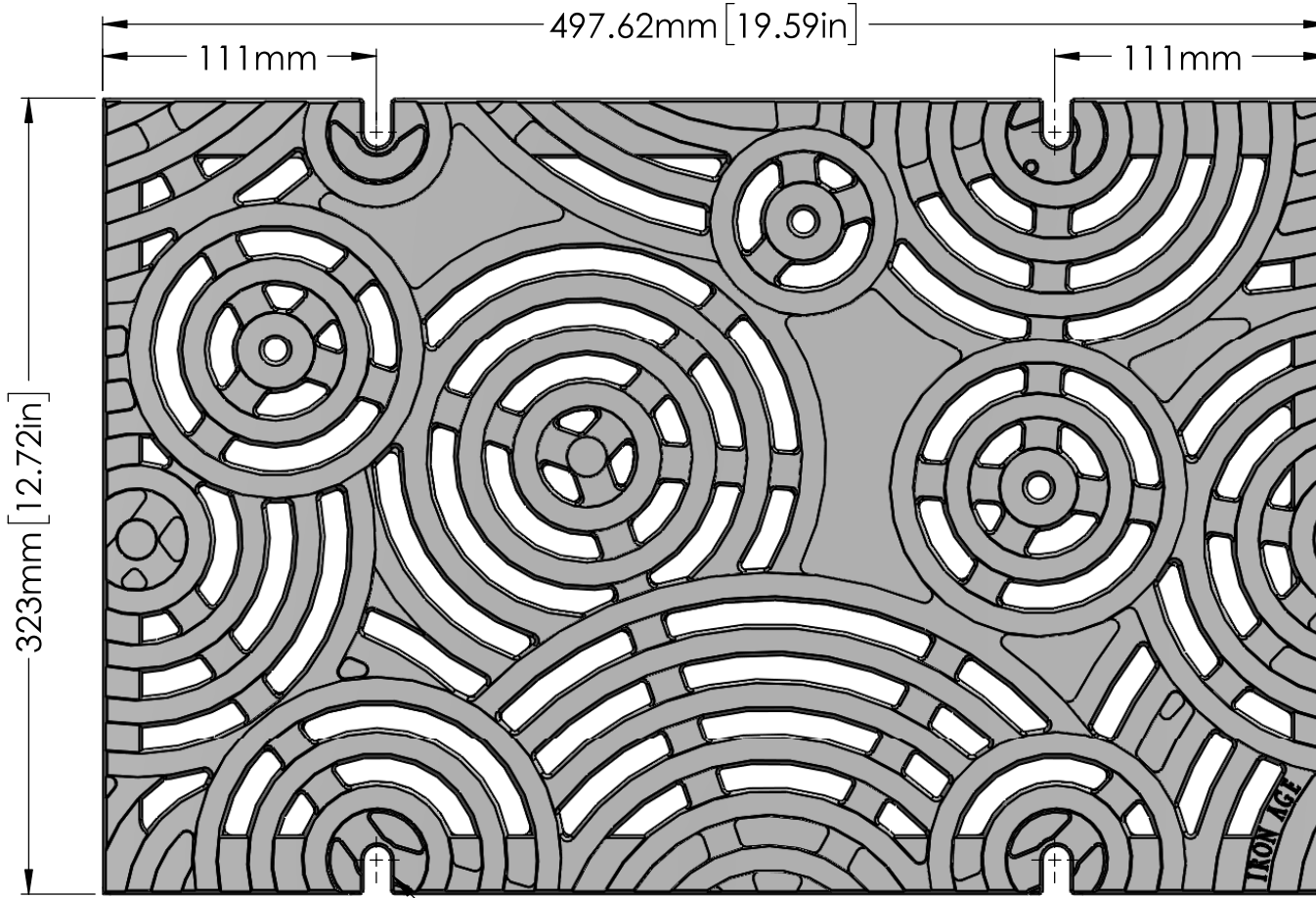

(4X) slotted holes for $\frac{5}{16}$ " bolts

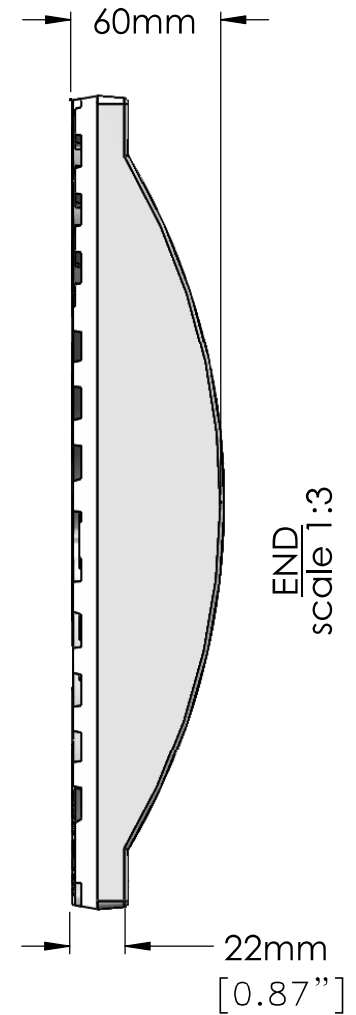

END
scale 1:3

EDGE
scale 1:3

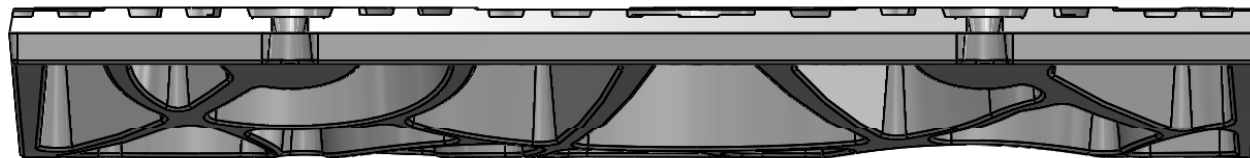

IRON AGE
DESIGNS

2104 SW 152nd st #4 TEL 206.276.0925
Burien, WA 98166 FAX 206.257.0318
www.ironagedesigns.com

NOTES:

1. Material: cast ductile iron
2. Finish: raw
3. No openings greater than $\frac{1}{2}$ "
4. Cast in 1 piece, 22mm (0.87") thick at edge.
5. E600 LOAD RATING; Approximate weight 21.3Kg (47lbs).
6. Due to casting inconsistencies, all dimensions are nominal.
7. Fits MEA® 3000 Channel

Oblio 13"x20" Trench Grate

JOB NO.

Drawn by: CD

DWG. NO. 001-OBL.MEA.E600.323x500

Date: 4/26/17

Scale: NTS

© 2017 Iron Age Designs