

3 ARRAY
scale 1:7

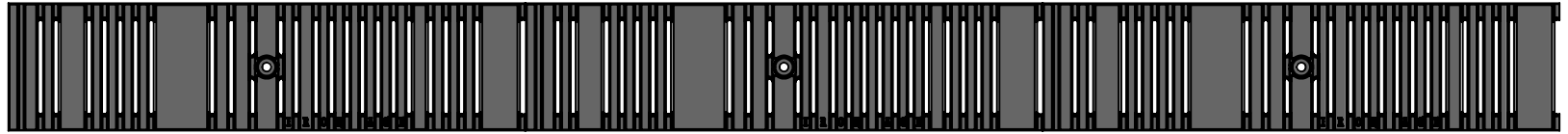

TOP VIEW
scale 1:3

19.563"

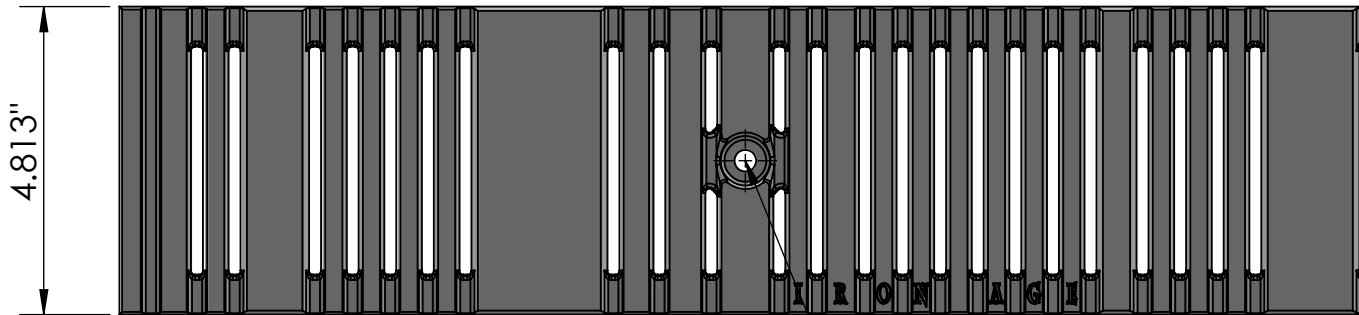

4.813"

5/16"-18
Pan Head
STD-Bolt

CASTING-ID
scale 1:2



SIDE VIEW
scale 1:3

0.250"

0.813"
EDGE

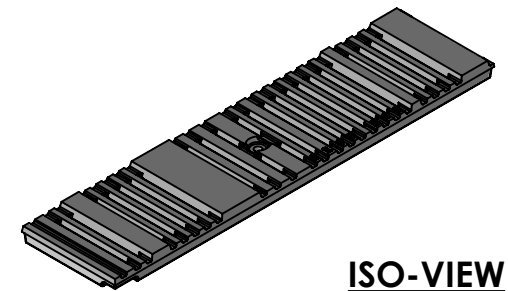
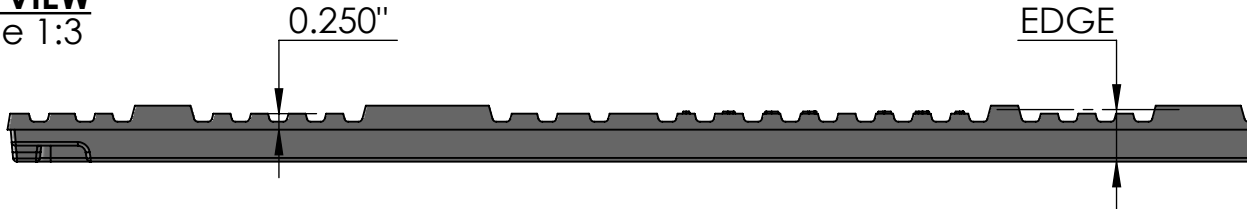

ISO-VIEW
scale 1:18

NOTES:

1. Heelproof: No thru openings greater than 1/4".
2. Ships in pieces: 1
3. Due to casting inconsistencies, all dimensions are nominal.

Made in USA ©2020 Iron Age Designs

Madras 5" x 20" Trench Grate Heel Proof



Material: Ductile Iron 65-45-12	Weight: 9.28 lbs.	Free Drain Area: 15.59 in/sq. 16.56 %	By: MS	Checked: MS	Date: 5-17-21
Finish: Raw	Edge: 0.8125"	Flow Rate: 20.42 GPM .045 CuFt./sec.	© Registration: VA 2-246-528		Scale: NTS
Fits: ABT® Polydrain® ACO™ K100/K1000 MEA® 1000 Series	Product ID: MDA5-20I21HP	Drawing Name: 01-MAD_A_5x20HP_TrenchGrate_Iron			