

# GENERAL INSTRUCTIONS

# FLOORmaps™ INCORPORATED

## Stencil Edition - Dry Method Install

(Read ALL of the instructions before beginning installation)

### ALWAYS TEST YOUR MATERIAL.

TEST for any reactions. If there are any, **STOP** and consult your product manufacturer. **If you have already installed you will need to call us to order another stencil.**

**NOTE:** Look for fraying of the material edges. If there is a reaction you will see it within minutes.

### KNOWN ACCEPTABLE PRODUCTS;

- Concrete Dyes/Stains
- Epoxy/Paint/Poly
- Etching Solutions
- Muriatic Acid
- Micro-toppings

### NO XYLENE/MEK

**PRO-TIP:** Allow your panel(s) to lay flat and relax for approx. 30 minutes in a climate controlled room after unpackaging.

(This will help release any wrinkling caused by rolling the panel(s) for shipping.)

### 1) INSPECT & CLEAN YOUR SURFACE.

Clean your area of dust and debris with a lightly dampened rag or auto scrubber. Allow time to dry before continuing.

(This allows for better adhesion of your stencil.)

### 2) FIND & MARK STARTING POINT.

Use a chalk line or tape measure/pencil to mark your desired starting point after locating. This typically is noted as the center of an area for logos or off key objects in a room for large designs.

**REFER** to your specs.

(For most designs you will start with **PANEL 1** which will come with centerlines.)

### 3) SECURE & STABILIZE YOUR PANEL.

#### 3A- "Bookspine" Method

Panels larger than 3ft, it is recommended to run a piece of tape through the middle of the design. Add another piece of tape running perpendicular on each side to aid in re-alignment in case your tape rips up during application. (see reference image)

#### 3B- "Hinge" Method

Panels 3ft or smaller, run a few strips of tape along the top/side of your panel. Add two more pieces running perpendicular. (see reference image)

### 4) PEEL & REVEAL YOUR DESIGN.

Fold one half of the design over with the backing paper side facing up. Start at the corners and peel the backing paper away at a 180 degree angle. Stop about 2 inches from the stabilizing tape. With larger designs 2 people are necessary.

The **FLOORmap** Design consists of THREE LAYERS



**TRANSFER TAPE** - Top layer, used to hold design together.

**DESIGN** - Middle layer, adhesive backed stencil or print material.

**BACKING PAPER** - Bottom layer, removed before applying to surface.



STEP 2

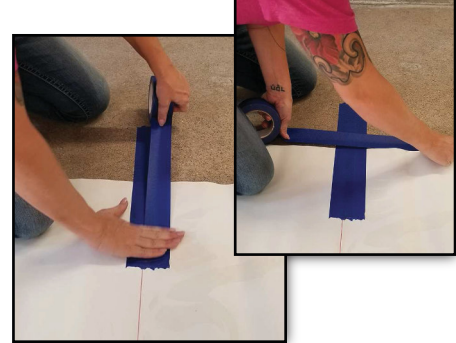

STEP 3

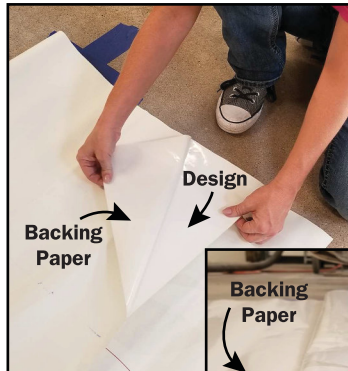

STEP 4

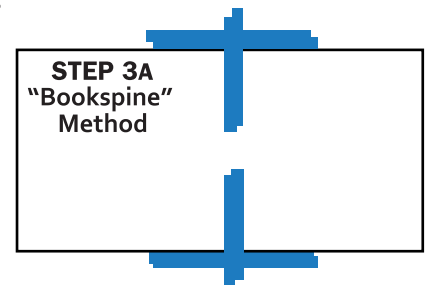
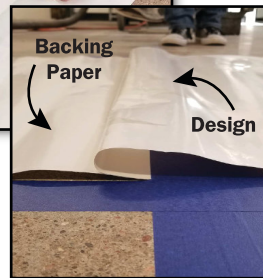

STEP 3A  
"Bookspine"  
Method



STEP 3B  
"Hinge"  
Method

**STEP 4 NOTE:** Occasionally, a small piece of your design will want to stay attached to the backing paper. This is normal. To fix this, roll your finger behind the backing paper, pressing the piece back onto the sticky transfer tape.

All projects come with a small sample for you to use for testing. We **ALWAYS** recommend testing your install process to ensure you do not come across issues that could have been prevented.

Visit us at [WWW.FLOORMAPSINC.COM](http://WWW.FLOORMAPSINC.COM)



## Stencil Edition - Dry Method Install

**IMPORTANT:** The vinyl is pressure sensitive. Make sure the vinyl is pressed firmly to the surface to allow for secure adhesion.

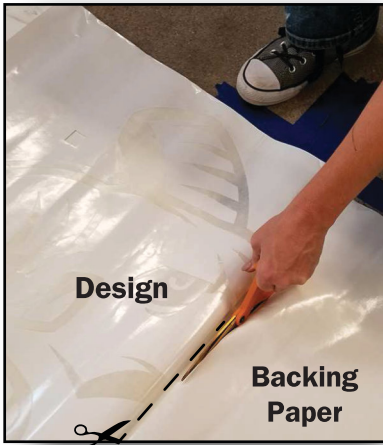

STEP 5

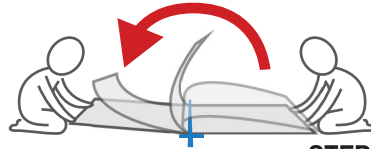

STEP 6A  
ILLUSTRATED



STEP 6A  
PRO-TIP

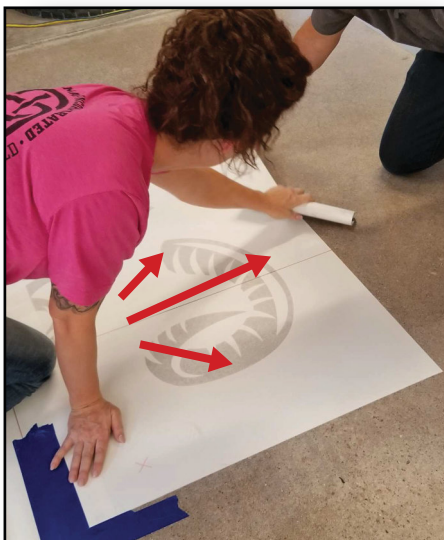

STEP 6B

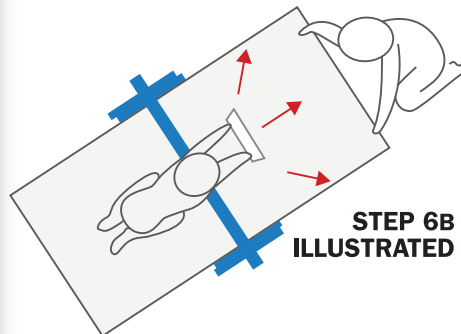

STEP 6B  
ILLUSTRATED

All projects come with custom reference documents pertaining specifically to your project. **ALWAYS** read through completely before continuing your installation.

**NOTE:** Humidity exposure can cause difficulty during installation of your design due to risk of adhesive release. Avoid if possible. If unavoidable after install you may find adhesive build up that will need to be removed. Acetone, a razor blade, and a little elbow grease will help get the job done.

### 5) CUT & REMOVE BACKING PAPER.

#### 3A- "Bookspine" Method (see pg.1)

Use scissors to cut away the exposed backing paper. Try to cut straight and at least 1" away from the design. Once you have one side applied to your surface, **REPEAT STEPS 4 & 6** on the other side of your panel.

#### 3B- "Hinge" Method (see pg.1)

Remove backing paper from the whole panel

### 6) HOLD & PULL EXPOSED DESIGN TIGHT.

**RECHECK** for dust and debris, clean before continuing.

**6A-** For large panels we suggest having someone hold the newly exposed portion of the design over the surface. They must maintain slight tension while you continue to **STEP 7.** (see reference image)

**PRO-TIP:** Take a squatting position and use your pinkies as kickstands while pinching the corners of the panel with your pointer and thumb.

For small panels you can manage this yourself by holding the middle edge of the the design with your dominate hand. Maintain slight tension while you continue to **STEP 7.**

**IMPORTANT:** Design must be held firm over the surface but NOT stretched.

**6B-** Using a felt tipped squeegee, smooth the exposed area onto the surface. Work in small sections, fanning out from the stabilizing tape to the edges.

### 7) REMOVE & DISCARD TRANSFER TAPE.

With a spray bottle or a lightly dampened towel, apply water and rub over the top of your transfer tape. This will release the water-soluble adhesive and assist in removing the tape easier. **DO NOT** over saturate. Too much and the adhesive will become stringy.

**PRO-TIP:** When removing the tape, pull away at a sharp 180 degree angle. **DO NOT** pull straight up as this can cause the design to release from your ground surface. If this happens press back the design before trying again.

### 8) MASK & PROTECT YOUR AREA.

Using tape and plastic sheeting, butcher paper, or your stencils backing paper (wax side down) and mask off the perimeter of your design. At least 16" out secures your area is protected from over application of color.

**IMPORTANT:** Ensure that you don't leave any voids in your masking and make sure your design is pressed firmly onto the surface to prevent any possible bleeding.



## Stencil Edition - Dry Method Install

### 9) TIME TO APPLY YOUR MEDIUM

It is always best to contact your manufacturer in the best method to apply and handle your product.

#### TIPS FROM EXPERIENCE;

(ALWAYS CONSULT YOUR MANUFACTURER FOR PROPER USE WITH STENCILS)

##### - FOR DYE/STAIN APPLICATIONS;

- Use your choice of solvent, or water mixture.
- In most cases you will start between 200 & 400 grit. Start with a water test to see if your surface will allow color penetration.

**OPTION 1:** Paint Sprayer, Pump Sprayer, Preval

**OPTION 2:** Microfiber Pads

**DO NOT** over saturate your color application or bleeding may occur. **PRO-TIP:** Many light coats are always better than one heavy coat. It is very important to remove all residual color from your surface before continuing to another color, sealing, or removing your stencil.

##### - FOR COATING APPLICATIONS;

- It is always recommended to start with a slight textured surface profile. This allows better grip. One way to achieve this is to etch your surface. If you need a stencil to assist with this step call us to order.

- When stacking colors allow your 1st coat to cure green before applying another coat.

- It is easiest to remove your stencil while your coating is still tacky to the touch.

- When dealing with layers allow your previous color to fully dry before continuing.

##### - ETCHING SOLUTIONS/ACIDS

- Allow medium to sit for at least 15 minutes to allow for better profiling.

- Always neutralize before continuing with colored mediums.

### 10) FINAL & FINISHING TOUCHES

After your final medium is applied and dried it is time to remove your stencil and dispose of all your excess trash. When pulling away your vinyl go slowly and at a sharp angle.

**NOTE:** If you see any areas that need touching up this is the time to do it. In most cases you can take a fine tipped brush and lightly apply color where needed.

#### Have Questions, Call Us!

Install Questions: | Office Phone:  
1-713-884-5182 | 1-832-329-3648

##### LIMIT OF LIABILITY:

Please read and understand the following statement.

FLOORmaps INC is liable for replacement of defective material only. We cannot control the use or method of application. We are not responsible for any claims, liability or damage(s) related to the use of this product either by mistakes in application, reactions of applied chemical products, environmental or structural conditions, surface conditions or misuse by consumer. We cannot guarantee that every structural surface or applied medium will satisfactorily work with this product. User assumes all risk and liability and is encouraged to test the compatibility of intended structural surfaces and mediums with the FLOORmaps INC product before project application.

### HANDLING PANELS.

If your design exceeds 57.5" we will provide you with multiple panels that overlap by .25" on all intersecting sides. **You will receive custom reference documents detailing your designs panels as well as other useful information.**

- Align your panels as accurately as possible to ensure a seamless design.
- Remove Transfer Tape after applying each panel.
- Ensure that all overlapped areas are sealed in.

**PRO-TIP** Use your fingernail or a card to firmly seal the edges.

### EXAMPLE PANEL OVERLAP

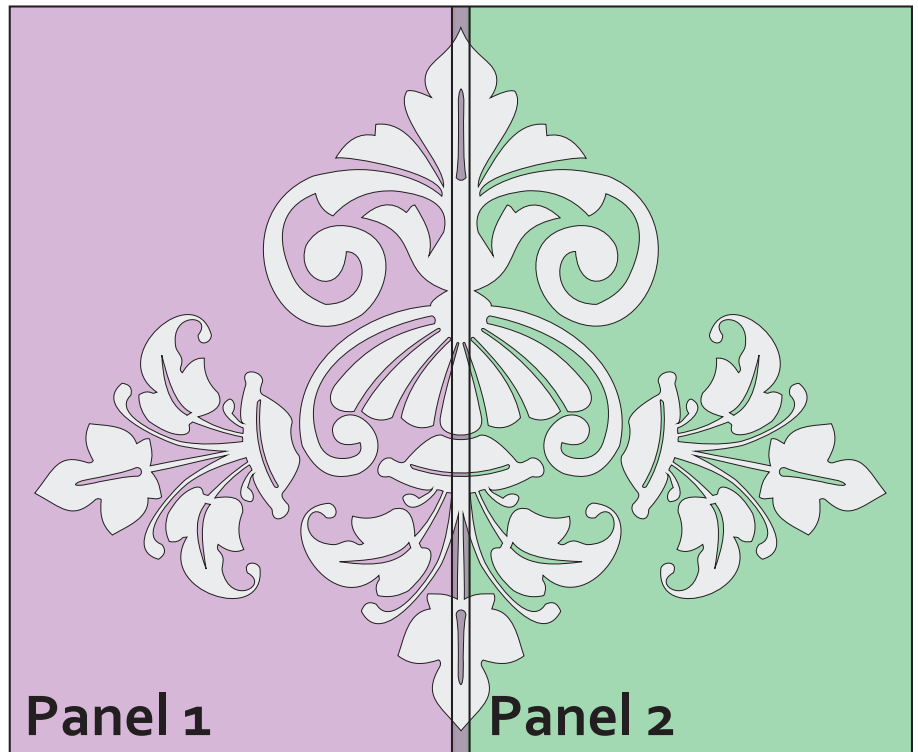

Coloring just for example, vinyl is white.

