

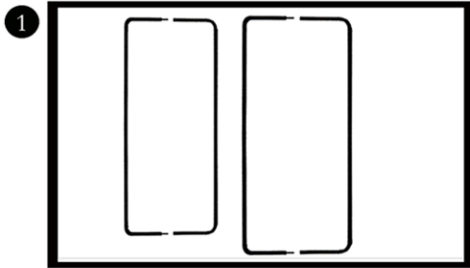

Purr...fect Gate

NOTE: If you ordered a 5' Gate, please see instruction on reverse side and follow the numbering.



Lay out matching parts of gate and frame.



Using enclosed stirring stick, mix Epoxy on a paper plate or piece of disposable cardboard.

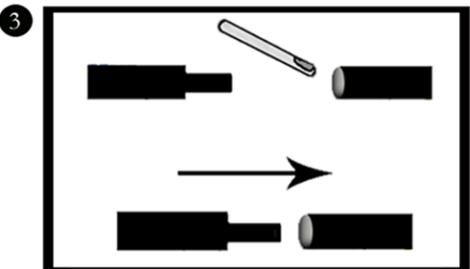

Put a thin layer of Epoxy on the inside edge of the unswaged gate halves. Slide halves together. Let dry for 15 minutes.

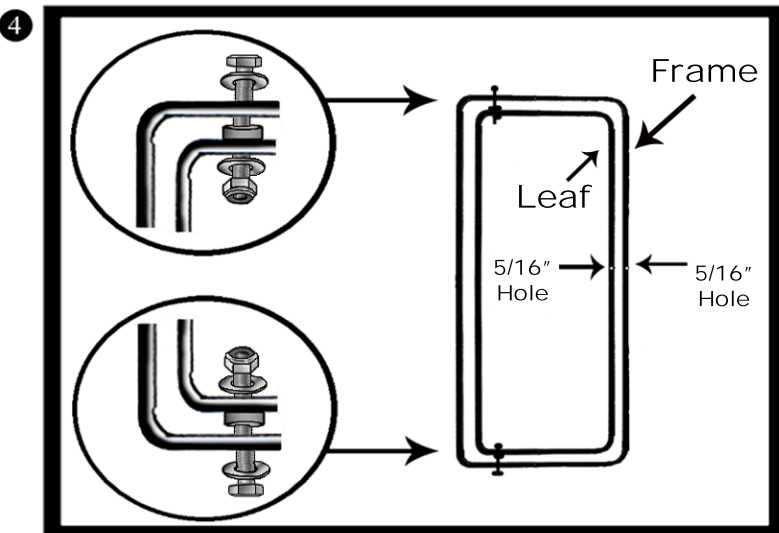

Install the hinge hardware as shown for the top and bottom of the gate. Please note: The two black spacers go between the Gate (inner) and Frame (outer).

DO NOT OVER-TIGHTEN.

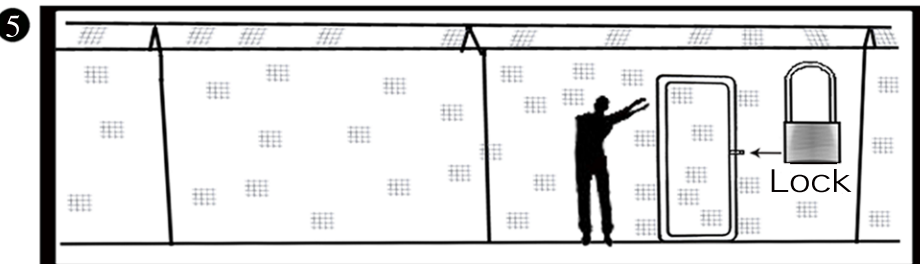

Using the included Ties, attach the gate to the installed fence. Cut the fence between the leaf and frame.