

Hologram Display

Model : Z1

User manual V1.1

Foreword:

Thanks for purchasing our hologram display, please read the user manual for the information on installing and operation.

一、 Product list:

Hologram display include :

No	Objects	Quantity
1	Z1 hologram display	1
2	Power adapter	1
3	Bracket	1
4	TF card	1
5	Card reader	1
6	Screws bag	1
7	Remote control	1

Please confirm whether your package is complete. please contact your supplier in time if there is any damage.

二、 Product Introduction:

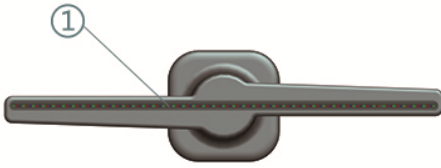

① LEDS

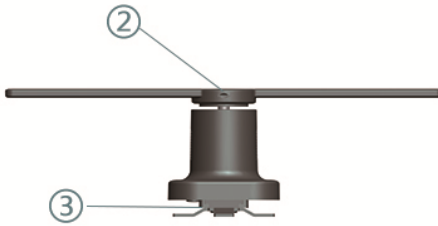

② TF card slot

③ Bracket

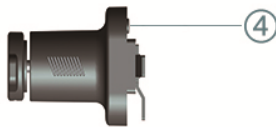

④ Power Port

Specifications:

Model : Z1	
Product weight : 1.5KG	
Pixel Resolution : 450x224	
Product Size : 434*110*128mm	
Revolution : 1100/minute	
Rated Voltage : 12V	Power : 10W-15W

三、 Installation:

1. Drilling 3 holes on the wall as diagram on the right.

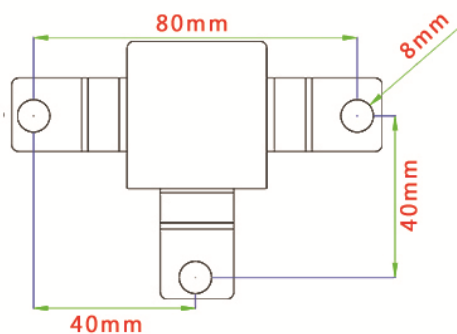

2. Mount the bracket on the wall by screws.

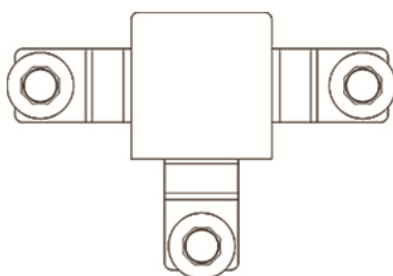

3. Connet the power cable and hang on the hologram display.

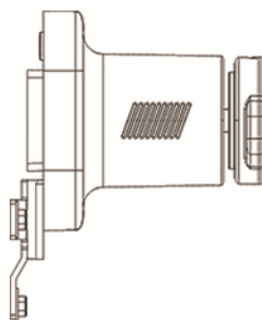

4. Turn the screw between fixed bracket and hologram display to avert fall off.

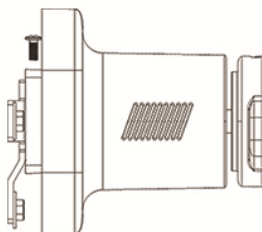

Notice:

Do make sure the device is installed on the place not touchable, or it must need a protection cover to keep safety.

Software :

1. Software interface instruction

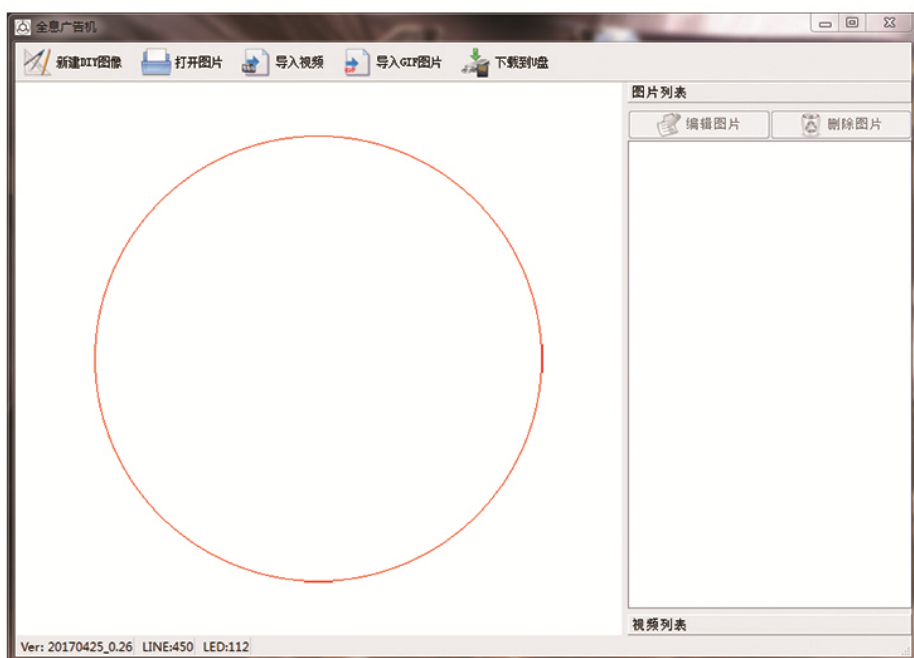

Drawing picture



Import JPG,BNP format picture



Import avi,mp4,rmvb format video



Import gif picture



Download content to the TF card

2. Video Import

Choose "import video" ,it will show you like following picture:



Select the video file from your PC ,
Red circle is cut out box,zoom in or zoom out your
video material,make sure it inside the middle of red
circle .Click ok come to below

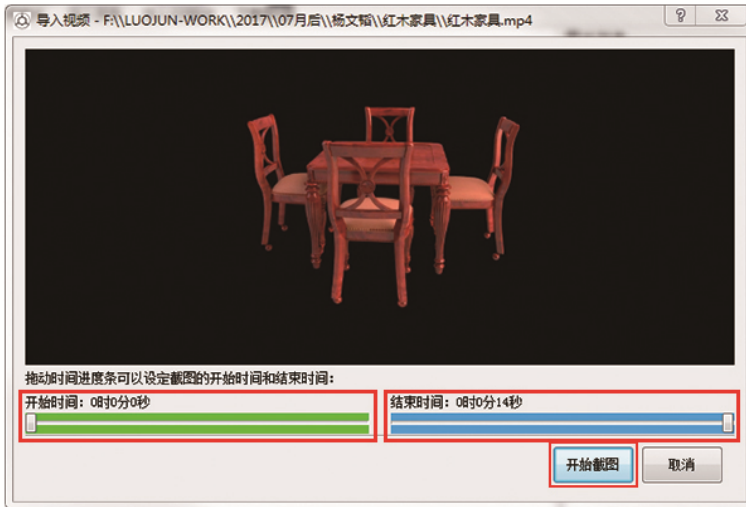

This window is used for choosing the time of video ,
then click start ,wait for transfer,when it finished ,
will show you like below



You can click the play button to preview the effect ,

3.Download content

Finally click download to your TF card,and rename for
it.(use your card reader connect TF card and computer)

四、 Failure analysis :

1. Display abnormal,such as blurred screen,picture with gap ;
Please formatting the TF card,re-download the content ;
2. Show an exclamation mark when you insert the TF card ;
It means the hologram display can't read the TF card;
Please check that the TF card has been inserted properly or if broken.
3. Hologram display work normally but show you nothing ;
Take out the TF card and formatting it,
then re-download the content.

五、 Notes :

Tear down or remould

The product is made up of high density components,prohibit tearing down,repair, refit or hard fall to avoid damage

Use and storage environment

The normal operating temperature of it is $-30^{\circ}\text{C}\sim 50^{\circ}\text{C}$,
Please be carefully use it if out of this range ;

Do not use or storage it under high temperature,
high pressure, strong magnetic field, dust and humidity.

Machine Maintenance

- 1.Do not use sharp objects to scratch on the surface of the machine.
- 2.Please wipe with a soft dry cloth if there is dirt, stain or water droplets on the surface of the machine.
- 3.Do not use volatile organic solvents to clean the machine surface,such as gasoline and alcohol.

WARRANTY CARD			
User	Name:		Product Model:
	Invoice Number:		Purchase Date:
	Address/Zip code:		
Service	The date of repair	Failure description and handling information	Service Person

*Under warranty, the product will get free repair if it be used normally. This warranty shall be rendered null & void if:

1. The product is physically damaged.
2. The product is installed, maintained and operated in ways other than as recommended by us.
3. The product is faulty or damaged due to other occasional problem that not related to manufacturing.
4. Turn the screw between fixed bracket and hologram display to avert fall off