

# Flexible Transparent Film Screen

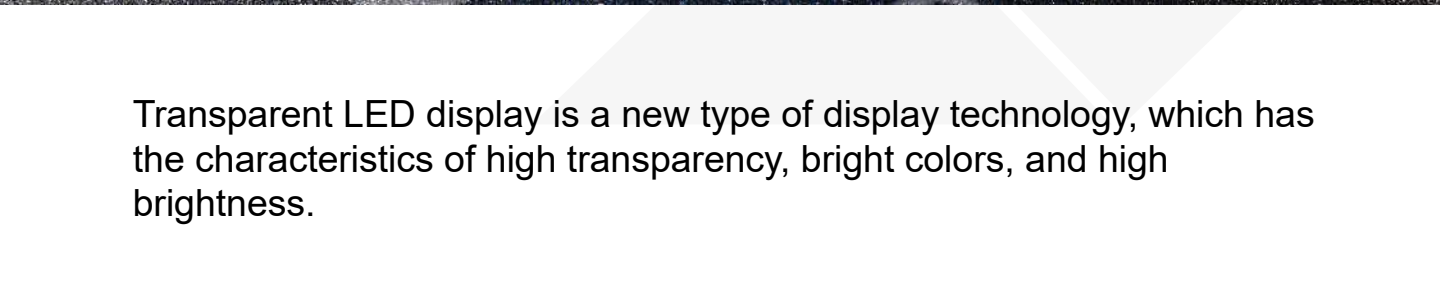

Transparent LED display is a new type of display technology, which has the characteristics of high transparency, bright colors, and high brightness.

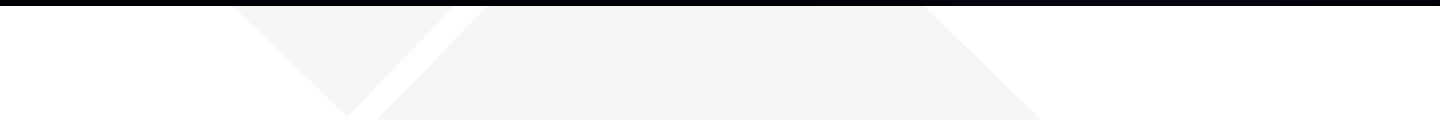



# Product Pictures

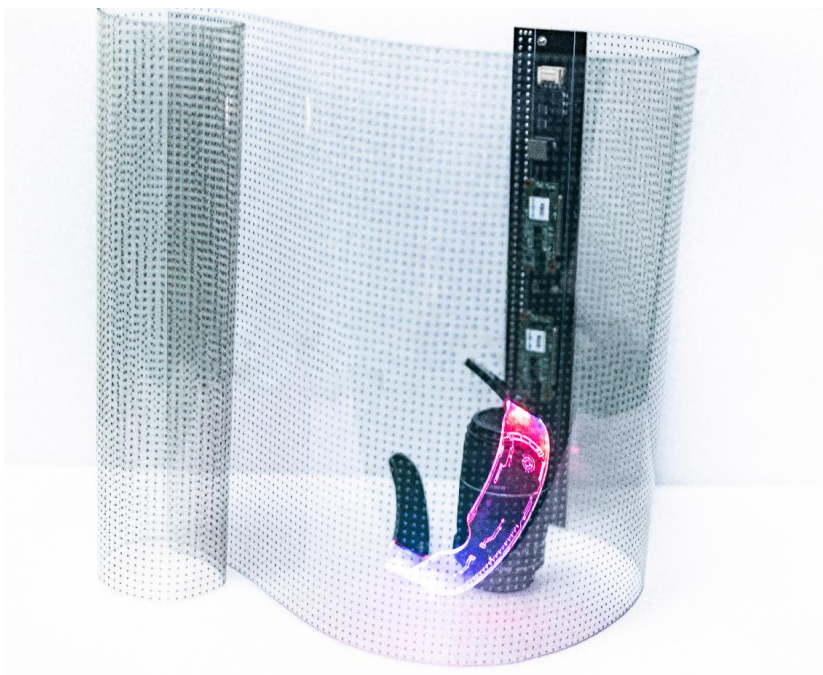
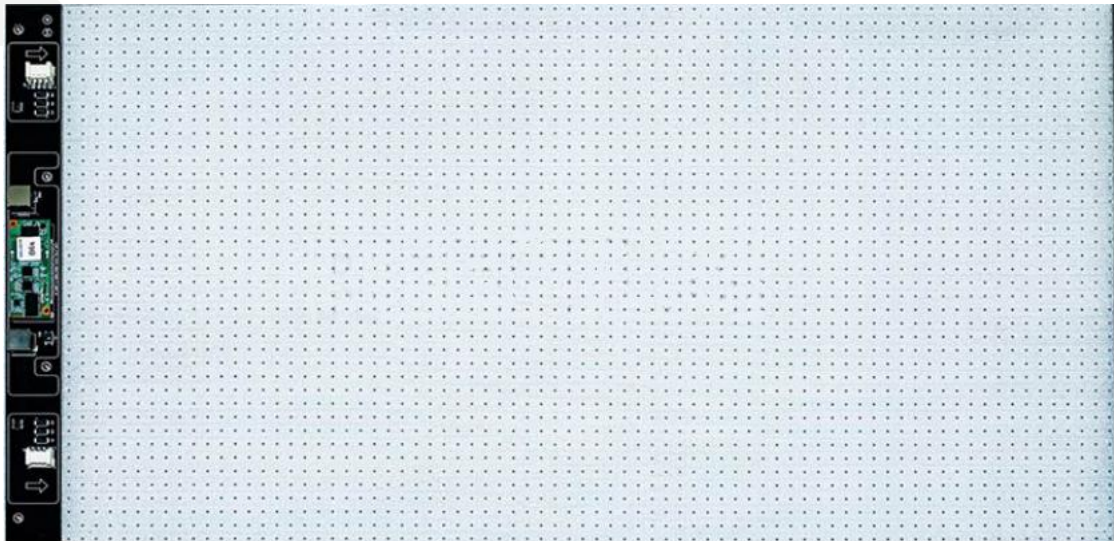

# Product Parameters

Model	P5	P6.25	P8	P10	P15	P20
PanelSize (mm)	1000*320	1000*400	1000*400	1000*400	990*390	1000*400
LED Model	EE1313	REE1515	REE1515	REE1515	REE2121	REE2121
Pixel Configuration	R1G1B1	R1G1B1	R1G1B1	R1G1B1	R1G1B1	R1G1B1
Pixel Pitch (mm)	5*5	6.25*6.25	8*8	10*10	15*15	20*20
Panel Pixels	200*64	160*64=10240	125*50=6250	100*40=4000	66*26=1716	50*20=1000
Pixel/m²	40000	25600	15625	10000	4356	2500
Brightness	2000/4000	2000/4000	2000/4000	2000/4000	2000/4000	2000/4000
Transparency	90%	90%	92%	94%	94%	95%
View angle°	160	160	160	160	160	160
Input Votlage	AC110-240V50/ 60Hz					
Peak Wattage	600w/m²	600w/m²	600w/m²	600w/m²	600w/m²	600w/m²
Average Wattage	200w/m²	200w/m²	200w/m²	200w/m²	200w/m²	200w/m²
Working Ambient		TEMP. -20~55 Humidity 10-90%				
Weight	1.2kg	1.3kg	1.3kg	1.3kg	1.3kg	1.3kg
Thickness	2.5mm	2.5mm	2.5mm	2.5mm	2.5mm	2.5mm
Driving Mode	static	Static	Static	Static	Static	Static
Controlling System	Novastar/Colorlight					
Typical Lifespan	100000H	100000H	100000H	100000H	100000H	100000H
Gray Level	16bit	16bit	16bit	16bit	16bit	16bit
Refresh Rate	3840HZ	3840 Hz	3840 Hz	3840 Hz	3840 Hz	3840 Hz

※Other dimension can be customized



# Products Features

## LED

Light drive in one, independent research and development, high reliability, mini LED device, industry leading

## High Transparency

Transparent Rate Up to 90% or more, do not affect glass lighting

## Smplified Installation

NO need steel structure, self-adhesive to glass and plug in power and signal

## 2 boards opposite to board splicing

## Flexble

Fit for all kind of curves

## Thin and light in weight

2.5mm thick, 5kg/m<sup>2</sup>

## UV Resistance

5~10Year not turn yellow

## Fire Resistance

V1 Grade

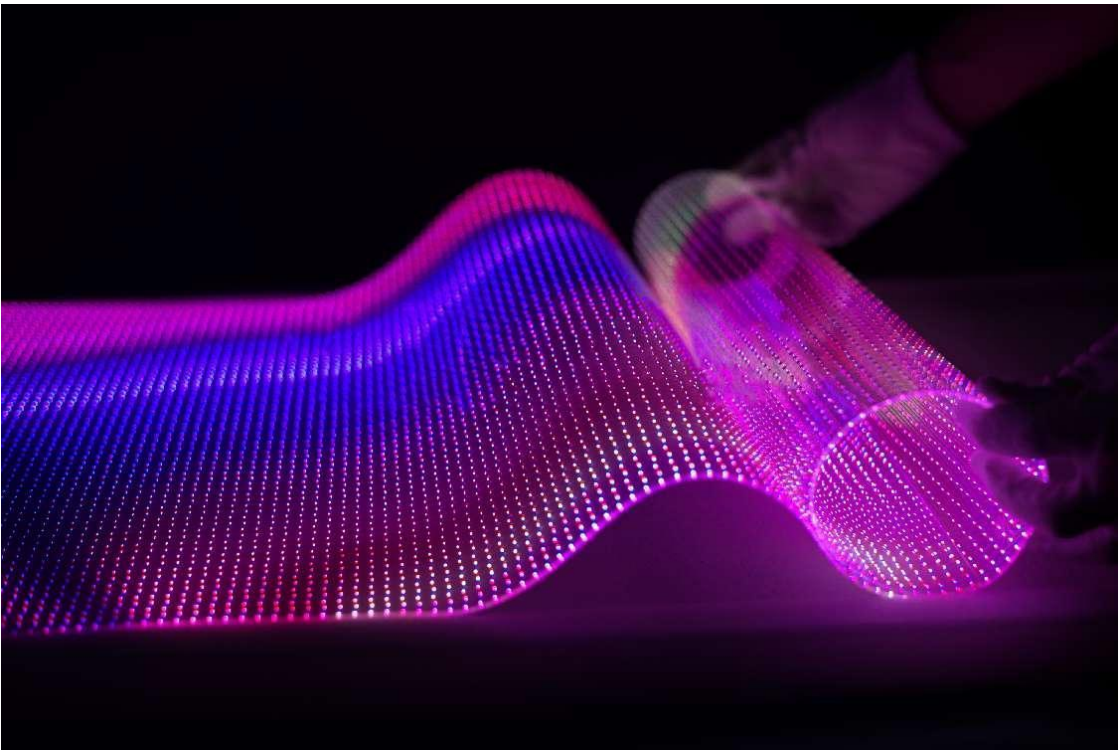
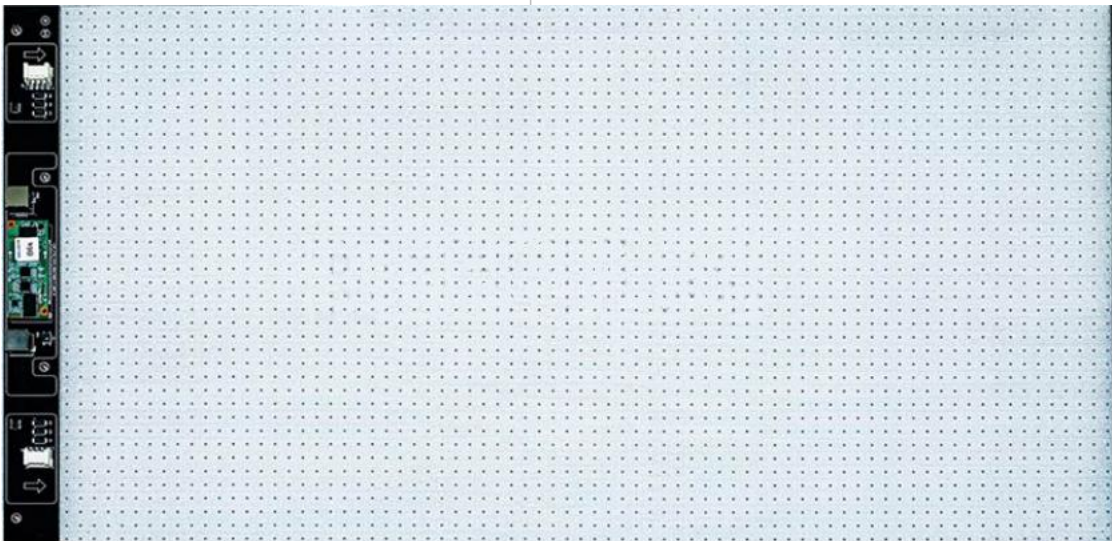



# Mini LED

## Models:

### Ree1313/1515/2222

#### 1、 Breakpoint continuation

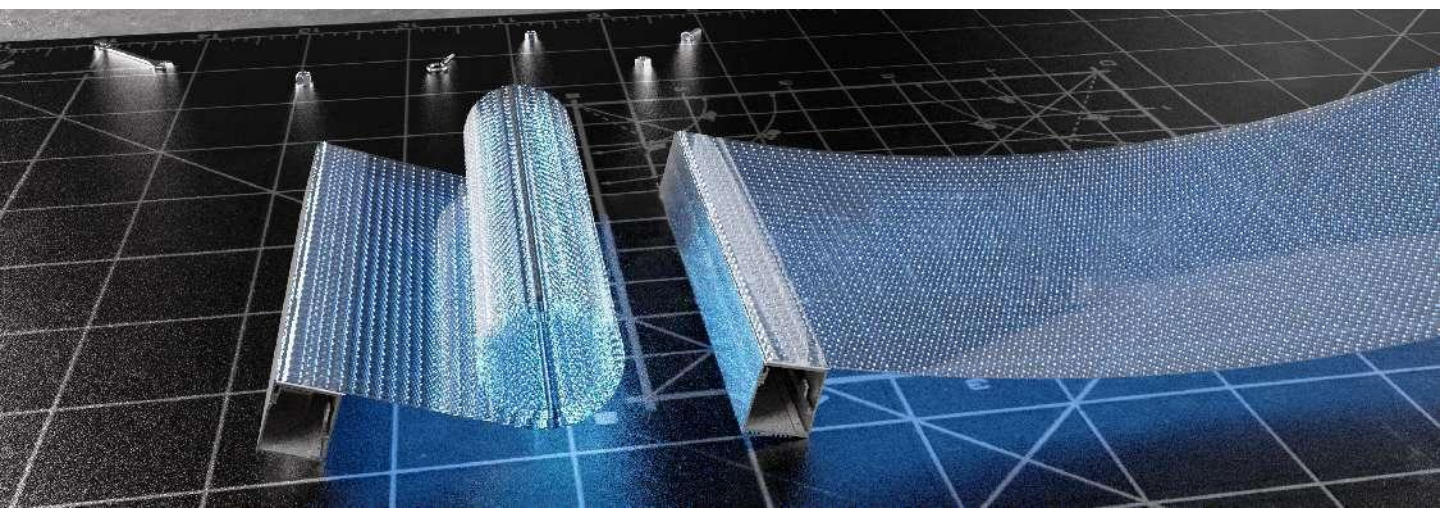

#### 2、 High gray scale display (true 16bit)

The RGB channel adopts 32-level current linear adjustment, and maintains 16bit gray display at any current, which is suitable for indoor, semi-outdoor and outdoor current requirements.

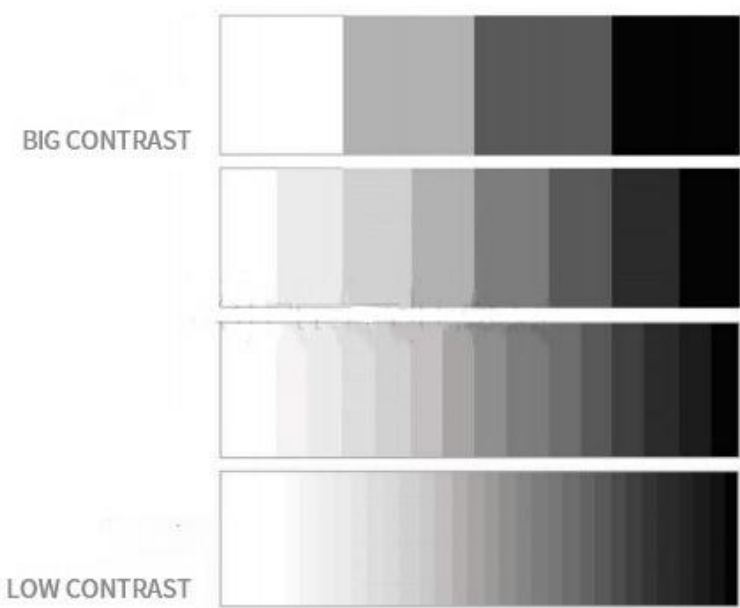

# Simple Installation

**No steel structure is required,just stick the thin screen slightly and connect the power signal**

Self-developed glue filling process (the screen body with its own viscosity can be directly attached to the glass surface, with strong colloid adsorption, and the viscosity will also increase with the passage of time due to the inherent characteristics of the colloid)

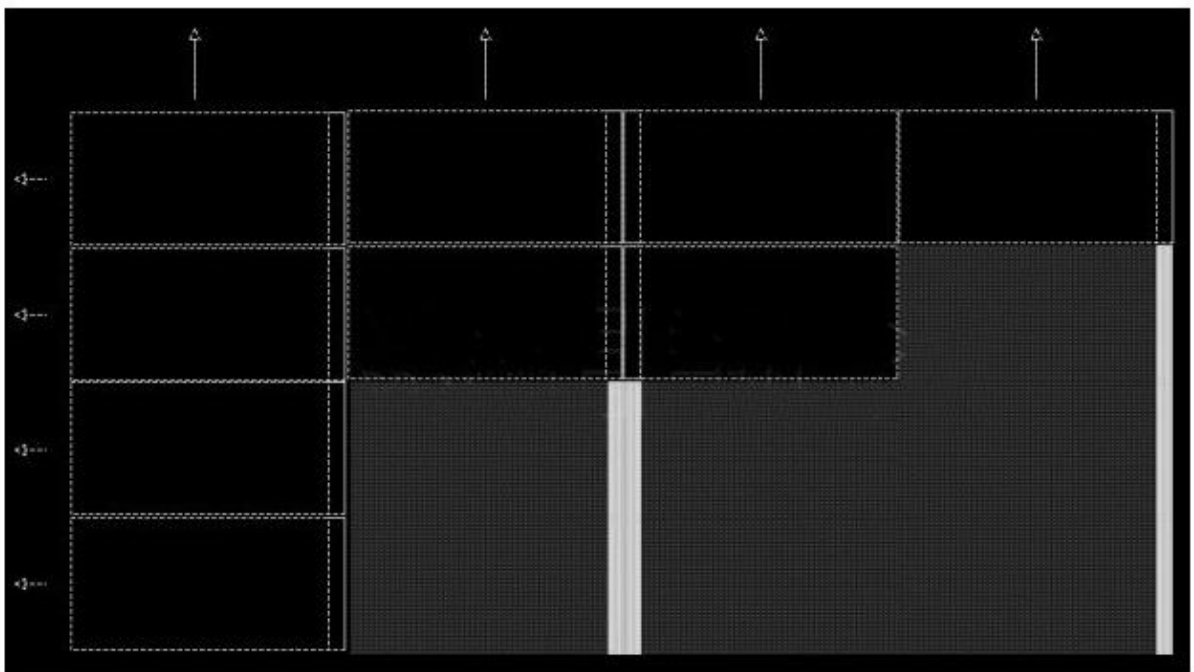
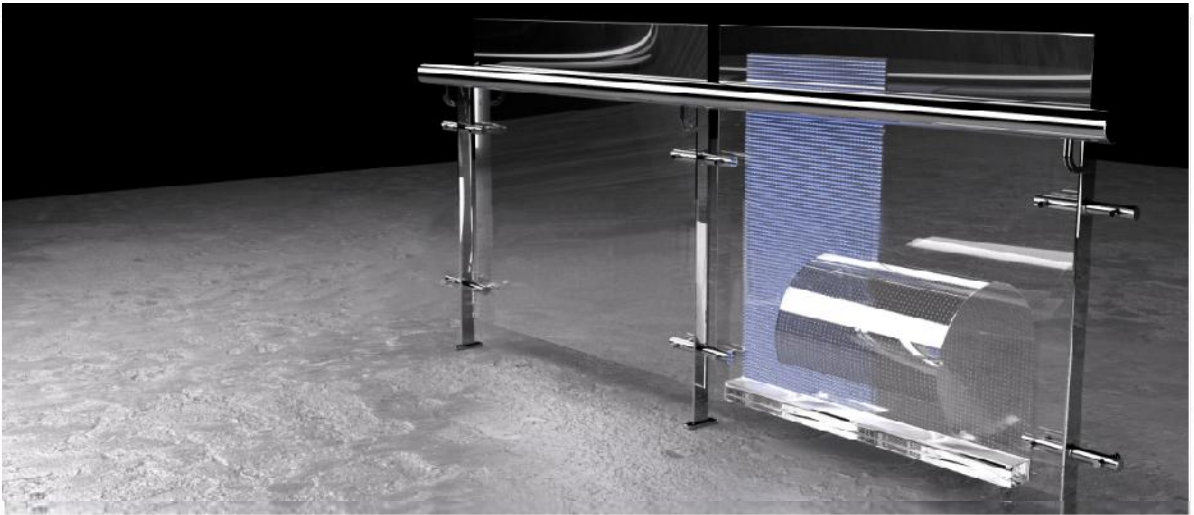

# High Transparency

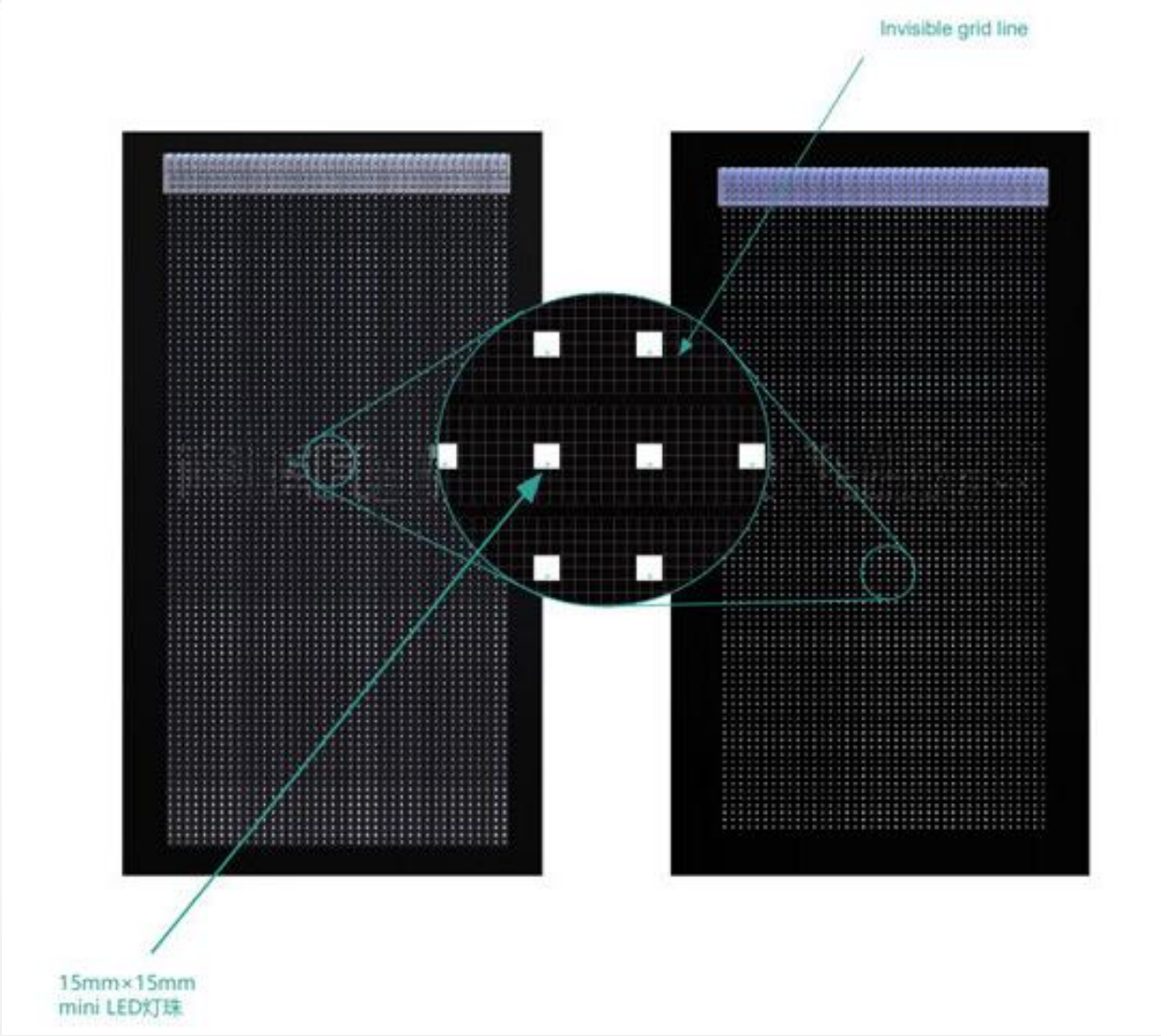

Use the integrated MiniLED lamp beads to improve its own permeability

Use invisible grid circuit to improve its permeability

- Self-developed chip puts the chip inside the LED beads, simplifying the circuit design and ensuring extremely high permeability.

Model	P6.25	P8	P10	P15	P20
Transparency	90%	92%	94%	94%	95%



# Flexible

- Fit for any kind of curve glass

Flexible design: Made of flexible materials it can be flexibly bent and curved with a minimum diameter of 6cm.

Adapting to various curved shapes, such as cylindrical, arc, etc this gives greater flexibility in design and installation.

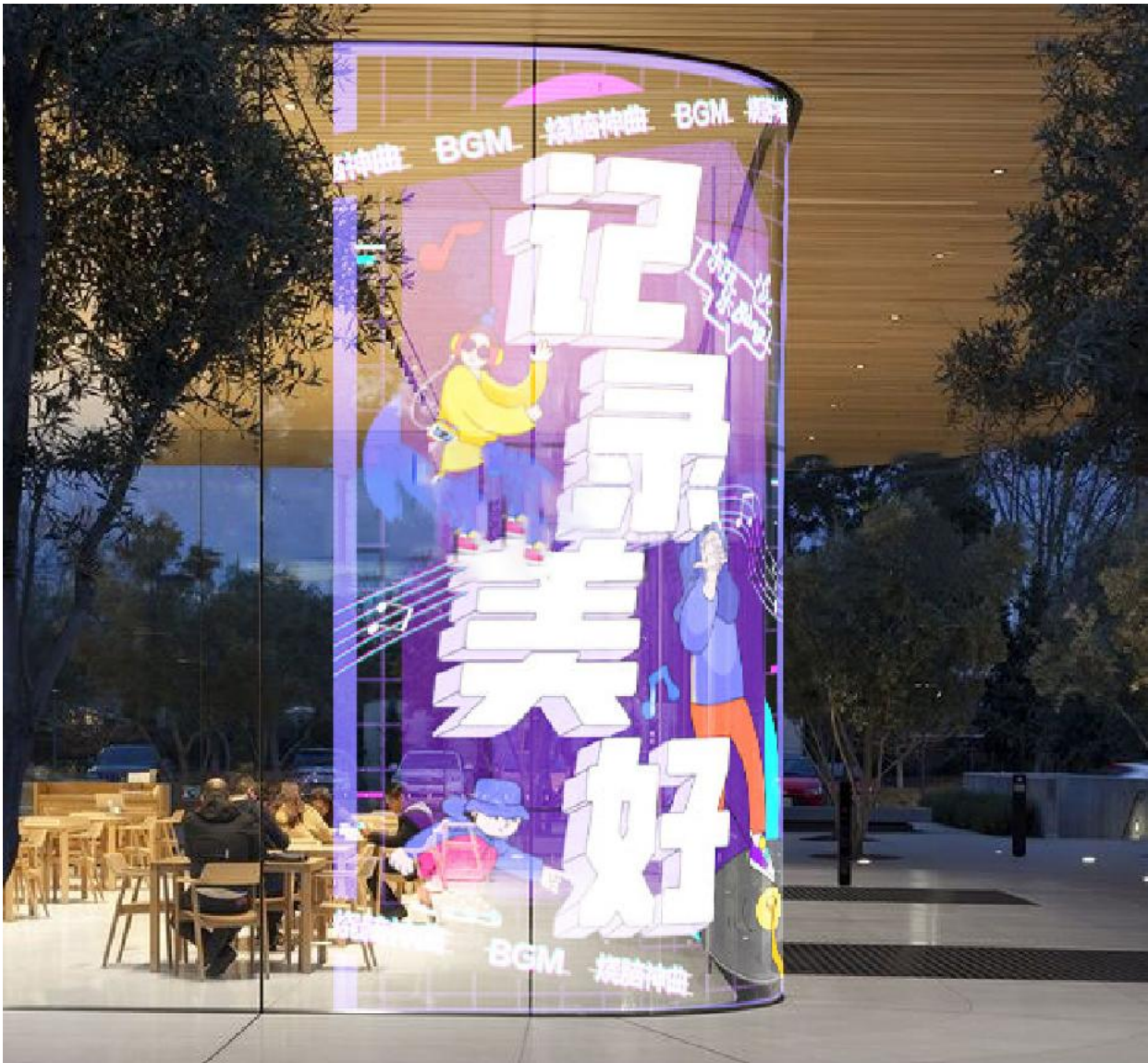



# Thin and light in weight

- Thickness: 2.5mm

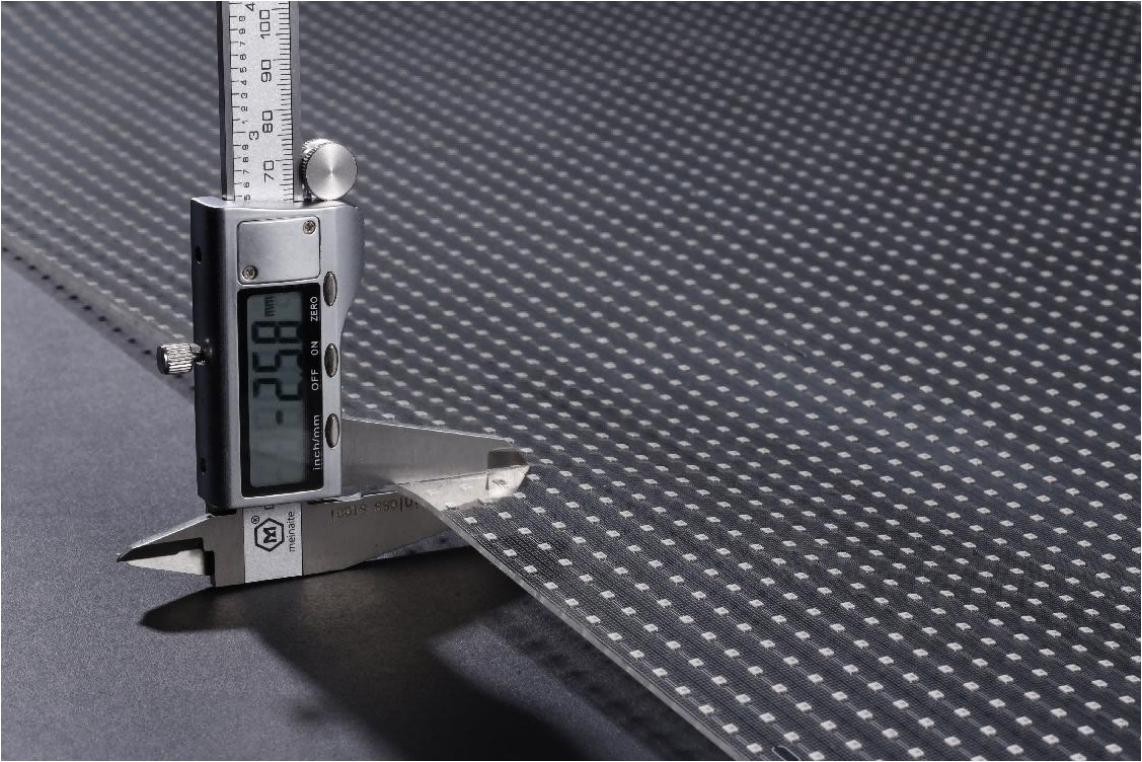

- Weight: 1.3kgs/pane, 5kgs/SQM



# Module explosion diagram (with power box))

## Hard Connection

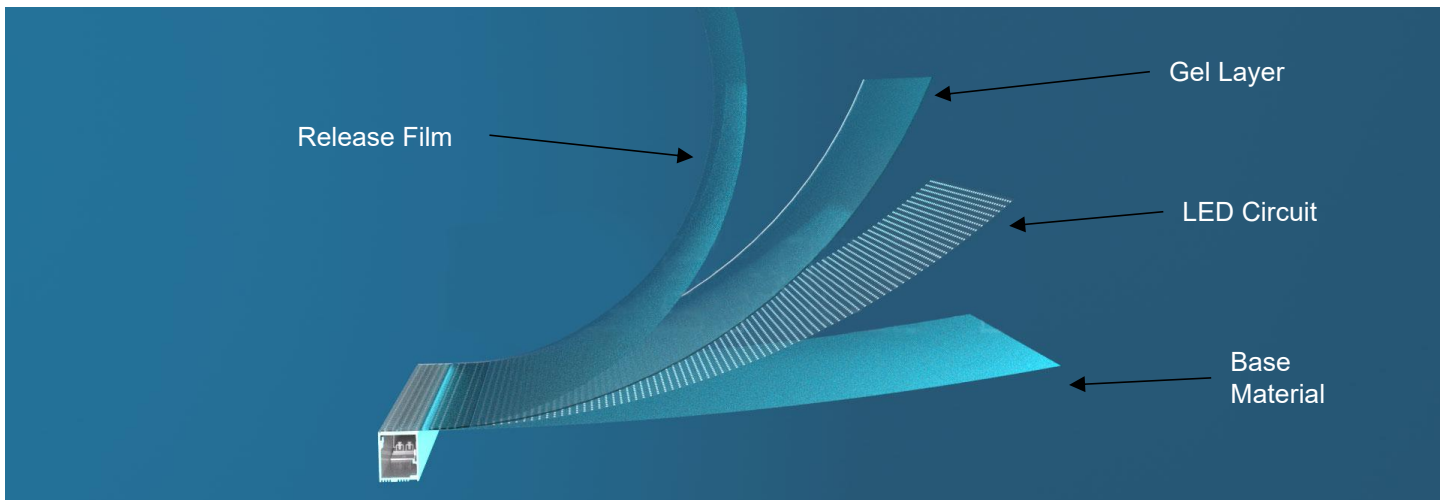

## • Soft Flat Cable Connection

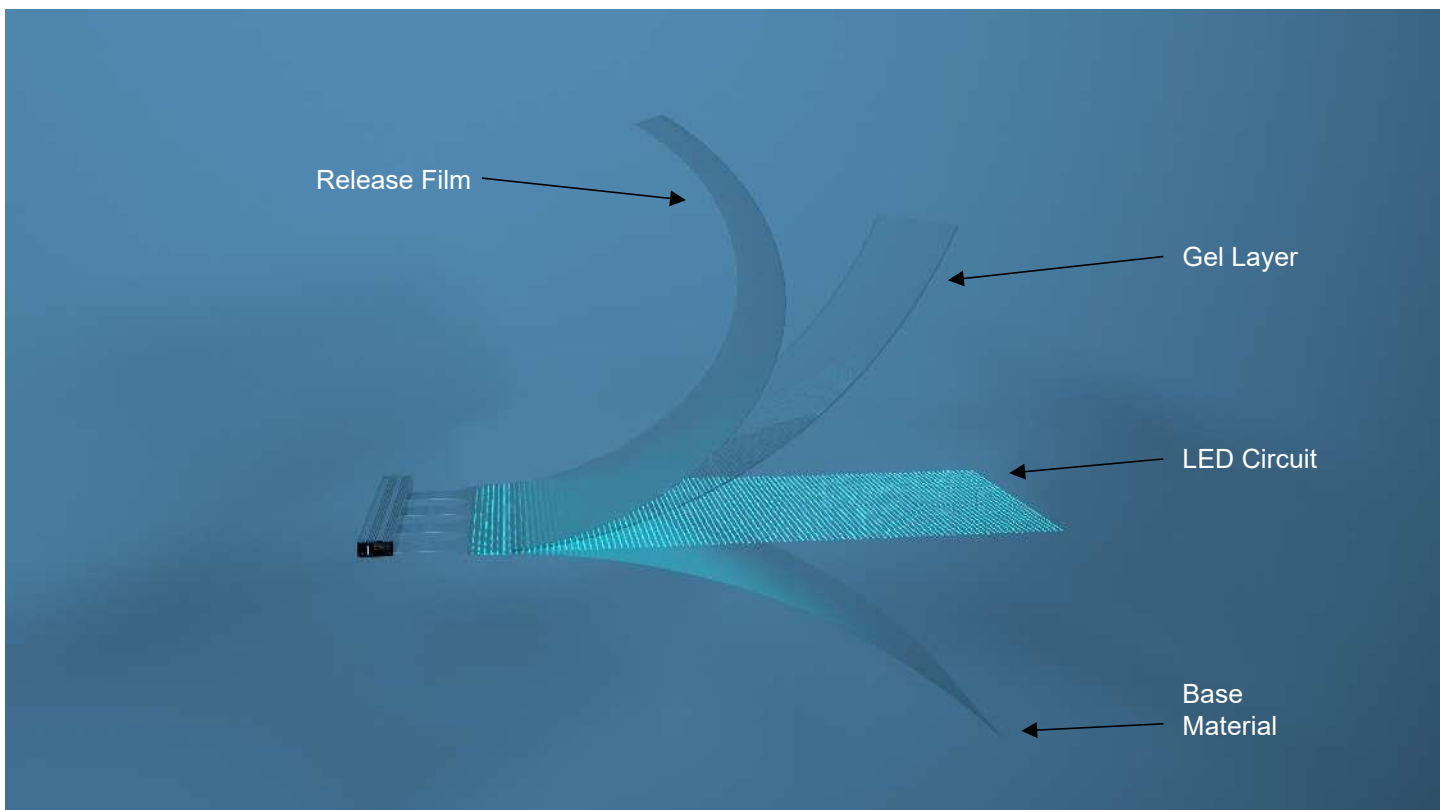



# Installation diagram and wiring diagram

(same as asynchronous configuration)

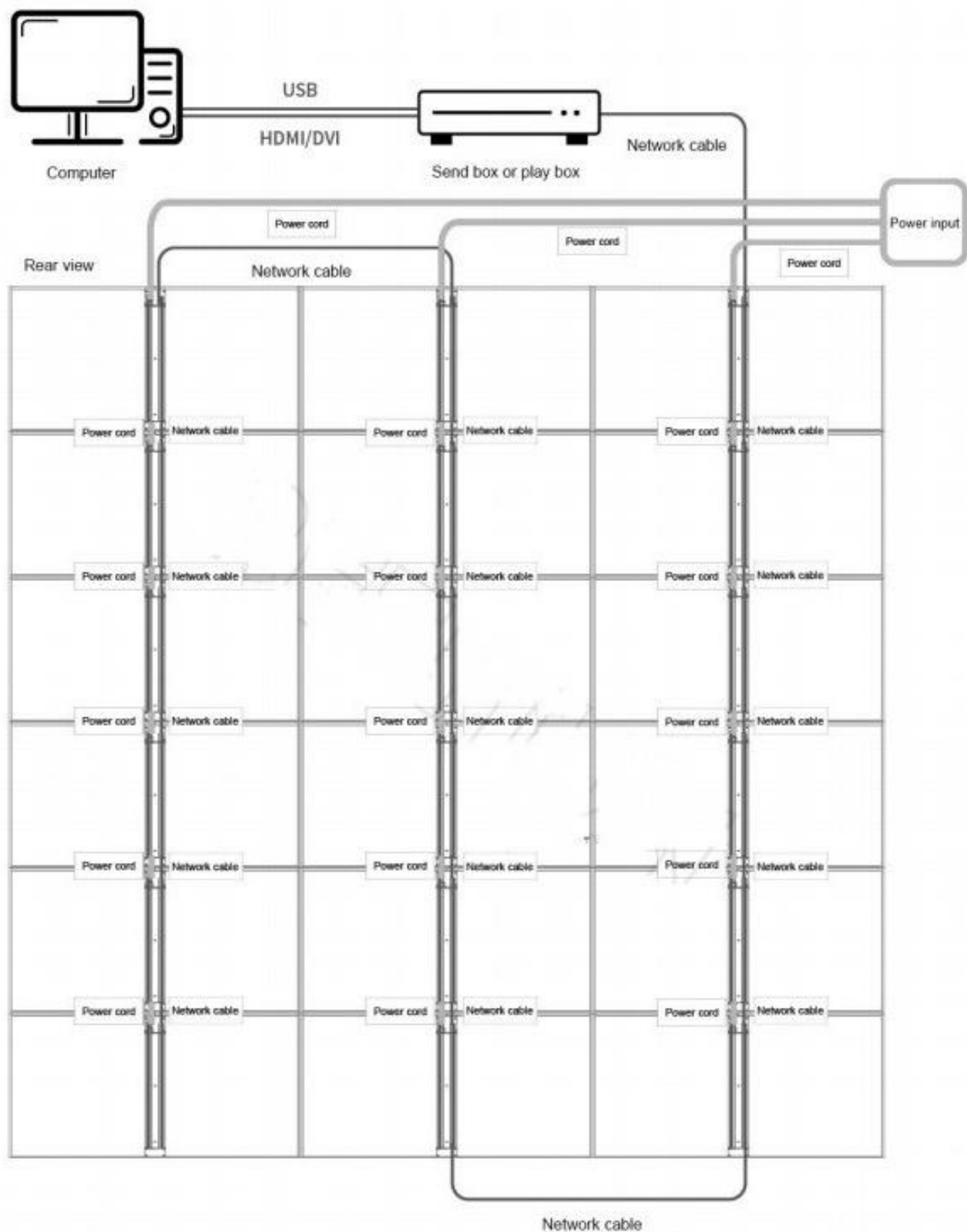

# Applications

- Curved Glass Video Wall



- Building Facade





# Application-Retail Store

## Store product display:

Transparent LED displays can be used to display store product information and promotional information to attract customers' attention.

## Branding:

Stores can use transparent LED displays to promote brand image and culture and enhance brand influence.

## Event promotion:

Stores can use transparent LED displays to promote various activities, such as new product launches, discounts and promotions.

In addition, this solution can also realize real-time update of information and improve the timeliness of store information. At the same time, it can also greatly improve the visual beauty and brand image of the store, making the store more attractive and modern.

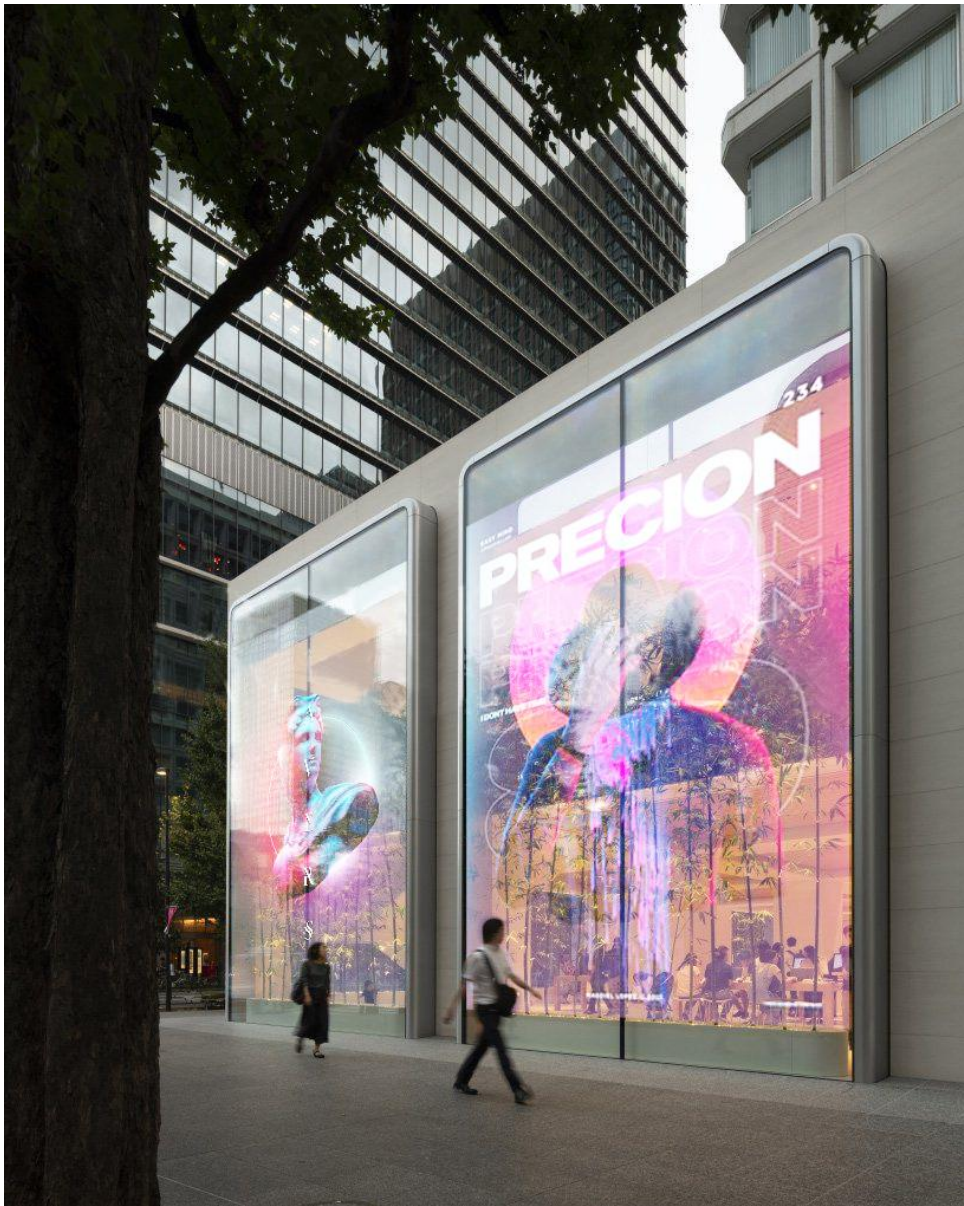

# Application-Glass railing

In shopping malls, transparent LED displays can be applied to the glass guardrails of shopping malls to attract customers' attention and improve the brand image of shopping malls. We propose an application scheme of transparent LED display in the glass guardrail of shopping malls. The solution uses transparent LED displays installed on the glass guardrail of the shopping mall, so that the shopping mall can display advertising information and attract customers' attention without occupying a large area of space.



## **Event promotion:**

Shopping malls can use transparent LED displays to promote various activities, such as new product launches, brand displays, etc.

## **Shopping mall advertising:**

The transparent LED display can be used to display the advertising information of the shopping mall, including the latest discount information, brand promotion, etc.

## **Navigation instructions:**

The mall can display the map and related information of the mall on the transparent LED display to facilitate customers' navigation and visit.



# Application- Escalator

In the escalator, the transparent LED display can be used to display various information and advertisements, so that passengers can more easily understand the elevator information and obtain useful information during the elevator ride. We propose an application scheme of transparent LED display in escalator. The solution adopts a transparent LED display installed on the escalator handrail, so that passengers can obtain useful information without affecting the transparency of the elevator.

## **Elevator running status display:**

The transparent LED display can be used to display the running status of the elevator, such as running speed, current floor, parking floor and other information.

## **Ad display:**

The transparent LED display can be used to broadcast advertisements, such as business advertisements on the floor where the elevator is located or related social public service advertisements.

**Other information display:** The transparent LED display can also be used to display other information, such as weather forecast, clock, etc.

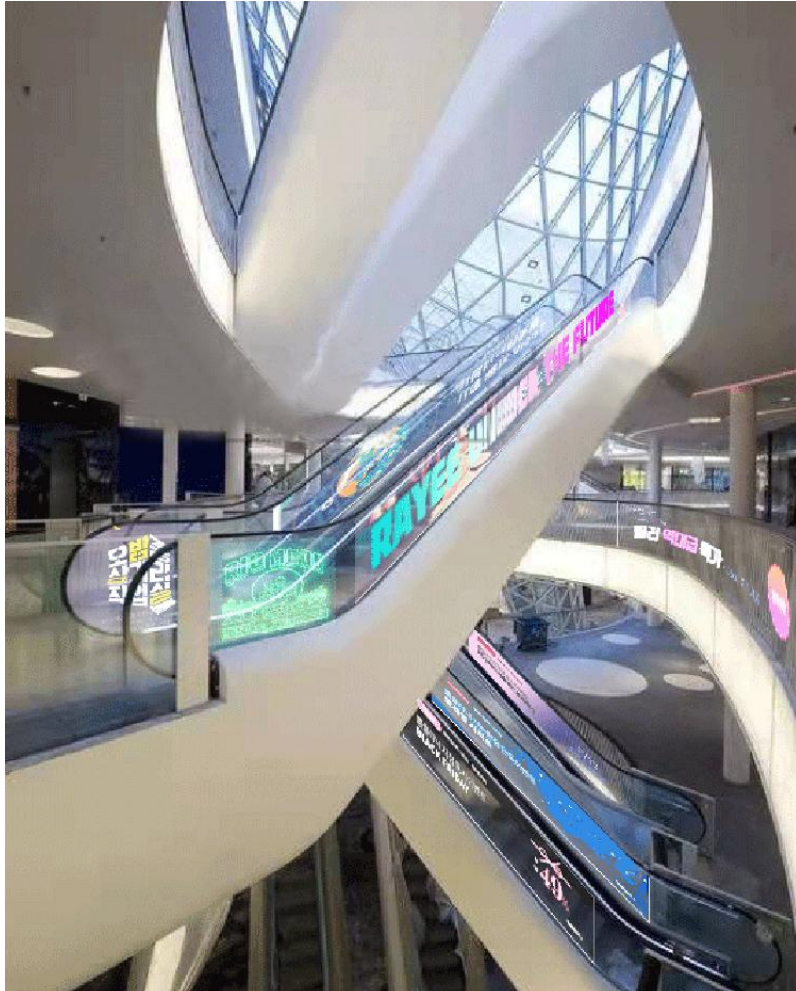

## Other Applications

