

Prior to installation, please check the items you have received against the packing list. Report any missing items to your local dealer immediately.

Protect all surfaces from sharp objects, high heat sources, direct prolonged sunlight and chemical hazards.

Professional installation is recommended.

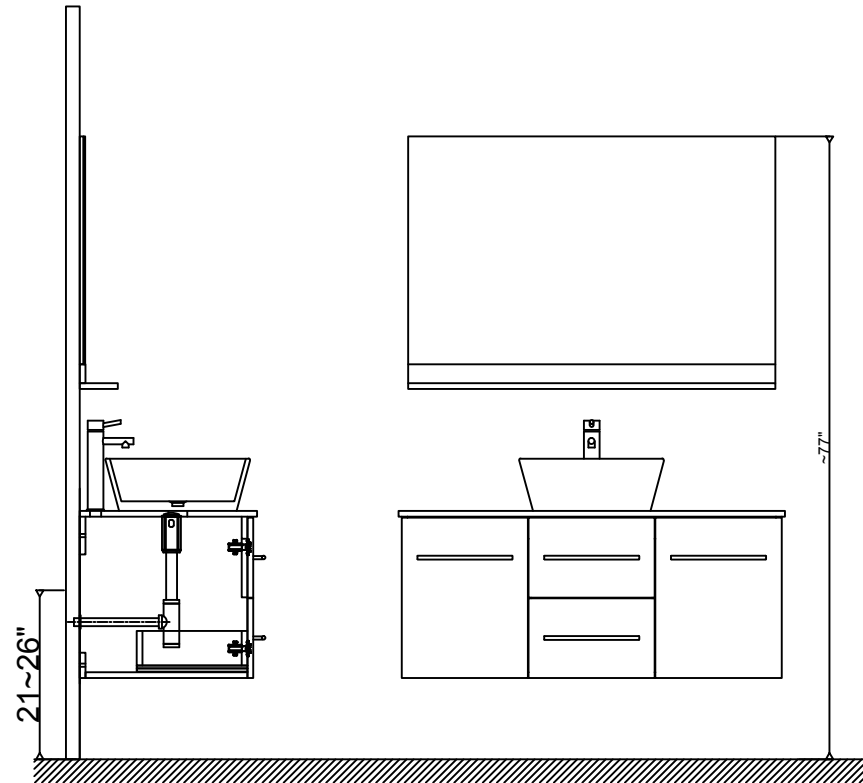

PARTS LIST (may differ depending on purchase)

Cabinet

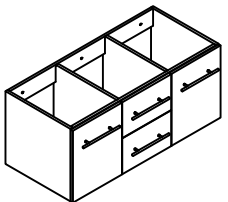

Mirror

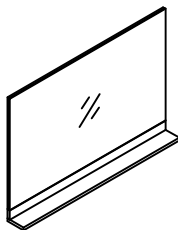

Basin

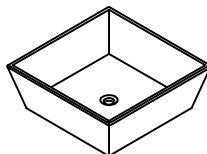

Top

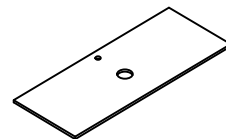

Screws



Install Screws



REQUIRED TOOLS

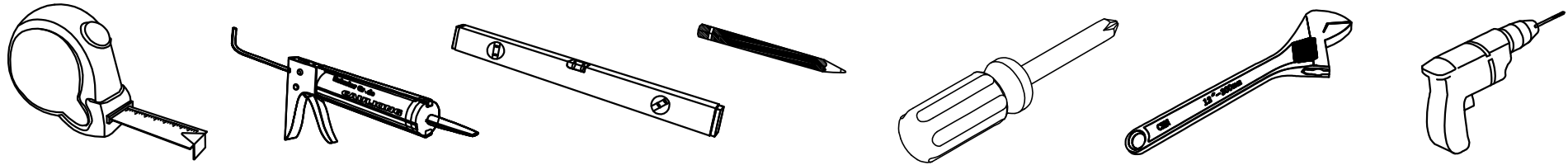

DRAWER REMOVAL

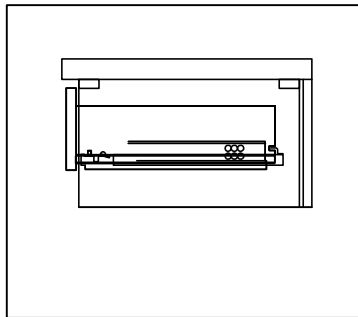

REMOVAL

1. Pull tabs toward center
2. Lift and pull drawer out

RE-INSTALL

1. Align drawer hole with slider stud
2. Push tabs back in to secure

DOOR ADJUSTMENT

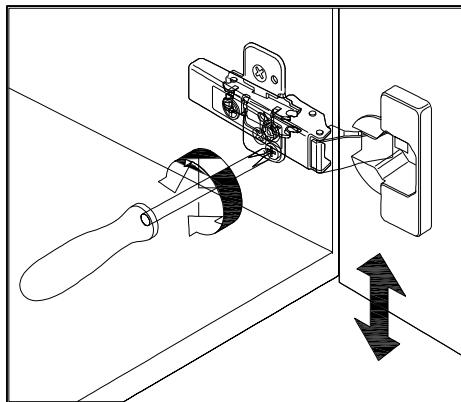

Adjusts the door vertically



Adjusts the door horizontally



Adjusts the door forward and backwards

Cabinet Installation

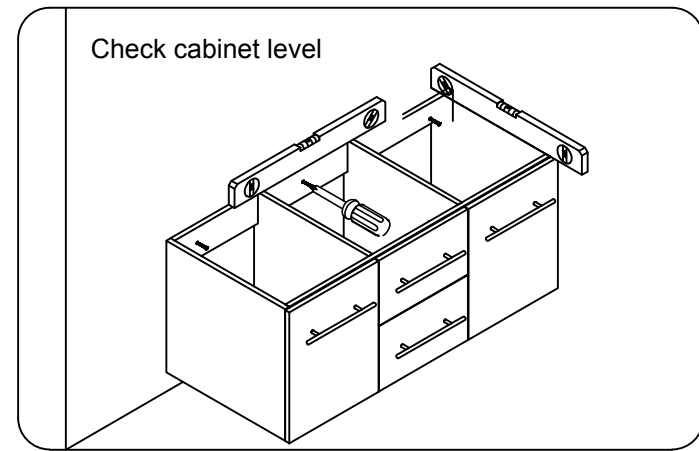
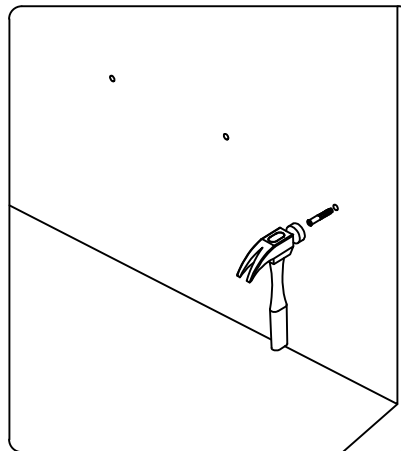
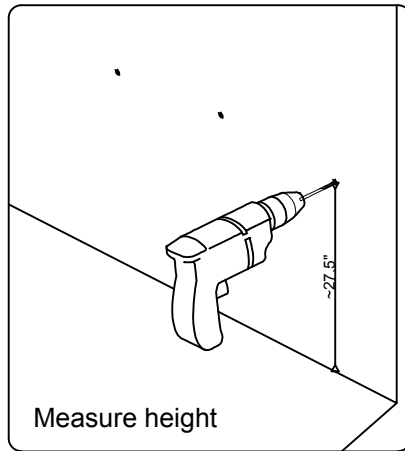

Top Installation

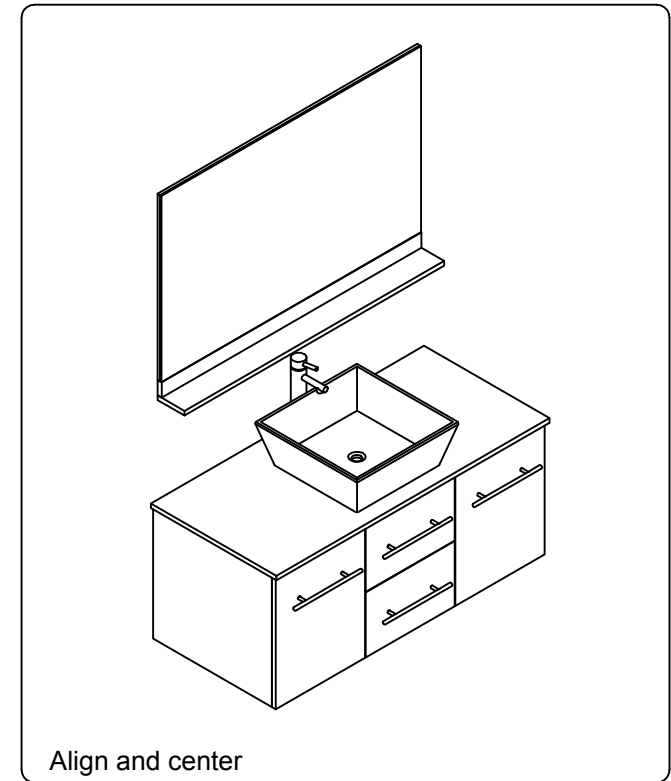
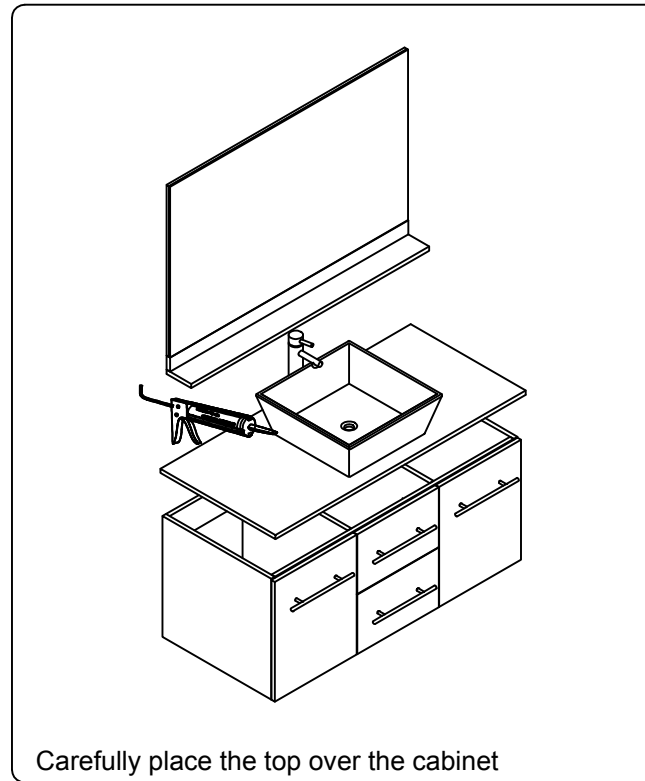
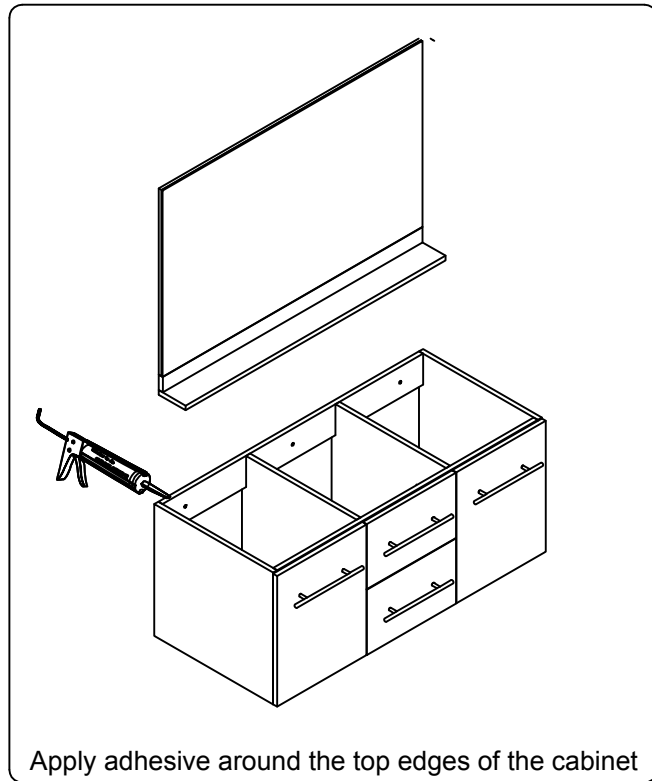

Mirror Installation

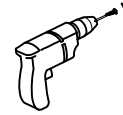
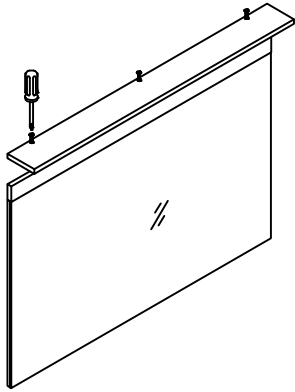

~71"

Measure desired mirror height and mark



Measure the distance between the mirror's hooks and make a second mark.

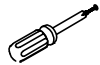

Install screws into stud or use drywall anchors.

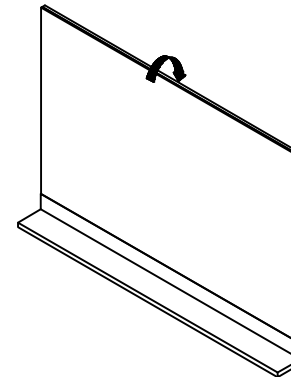

Lift and hang mirror