



Assembly and Installation Instructions for Model's

50091NL

CAUTION - RISK OF FIRE

Installation of this fixture should be done by a licensed electrician or by a person familiar with local electrical codes and the construction and operation of this fixture.

Warning please make sure the electrical breaker is shut off before commencing with this installation

Read and familiarize yourself with these instructions before commencing

This fixture is certified for wall mounting only and is suitable for Wet locations.

Package Contents

Part	Description	Qty
A	Fixture mounting bracket	1
B	Mounting bracket screws	2
C	Fixture assembly	1
D	Wire connectors	3
E	Fixture mounting screws	4
G	Black pad	1
H	Metal laser-cut number	2,3 or 4

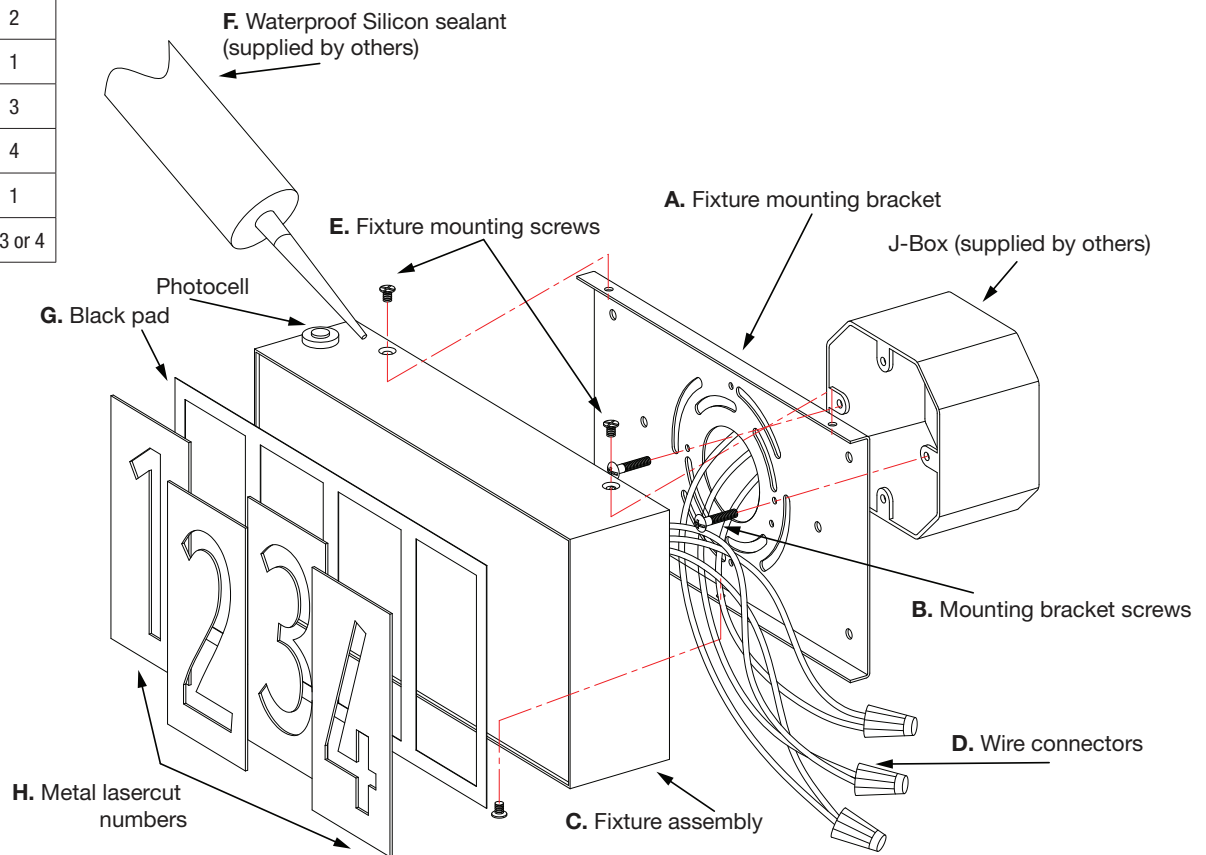

Installing the fixture *please ensure the electrical breaker is switched off before commencing*

- 1 Attach the supplied Mounting Bracket **(A)** with the two supplied Mounting bracket screws **(B)** to the Junction-Box.
- 2 Connect the supply wires to the fixture wires using the supplied electrical wire connectors **(D)**. White supply wire to the White fixture wire, Black supply wire to Black fixture wire and the ground Bare Copper or Green wire to the Green fixture wire. Once the electrical wire connectors are securely fastened it is recommended to tape these connectors with electrical tape.
- 3 Attach the fixture assembly **(C)** to the mounting bracket **(A)** with the Fixture mounting screws **(E)**
- 4 Using a high grade waterproof Silicon sealant caulk all four sides of the fixture assembly.
- 5 This fixture excepts two three or four Metal laser-cut numbers **(H)** and incorporates neodymium magnets, In order to alleviate light leakage make sure the supplied Black pad **(G)** is in place prior to attaching the Metal laser-cut numbers.
- 6 Switch on the electrical breaker and your new fixture is ready for many years of trouble free use

