

# PROMOTIONAL / PARTY PACK AND QUICK QUIP BOTTLE CARRIER INSTRUCTIONS

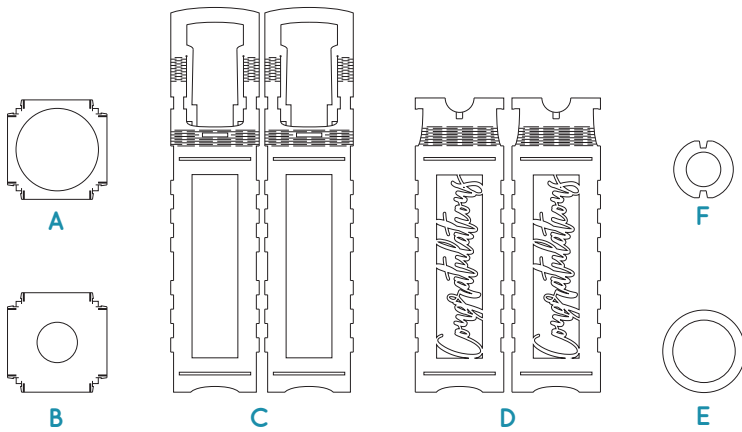

## PARTS LIST

- A** Center piece - upper (large hole)
- B** Center piece - lower (small hole)
- C** Tall side panels
- D** Short side panels w/message
- E** Bottle base guide (optional)
- F** Gift tag

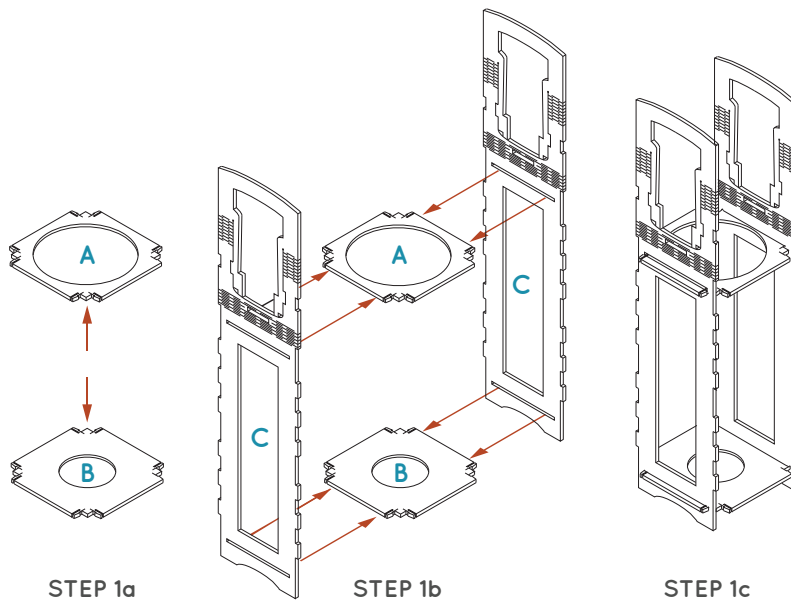

## ASSEMBLING THE CARRIER

### STEP 1

- 1a** - Position center pieces (**A** & **B**) accordingly (Upper piece (**A**) has the larger hole)
- 1b** - Insert and lock the center pieces into the slots of the tall panels (**C**) by lightly squeezing the end tabs together
- 1c** - Push the tabs through until snapped in place.

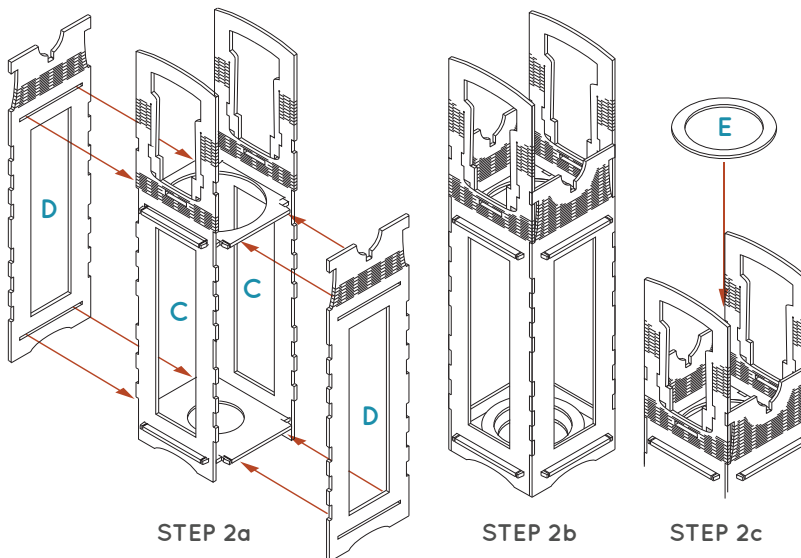

### STEP 2

- 2a** - Orient the short panels (**D**) with messaging or design outward and repeat the process: insert and lock the center pieces into the slots of the short panels by lightly squeezing the end tabs together.
- 2b** - Push the tabs through until snapped in place. The finger joints along the edges will be tight around the larger center section. Press all four sides together until closed and secure with no visible gaps.
- 2c** - (Optional for wine and smaller bottles) Drop in and rest bottle base guide (**E**) flat to the bottom of the carrier box.

**The carrier is now ready for your bottle!**

# LAYERMADE WORKSHOP

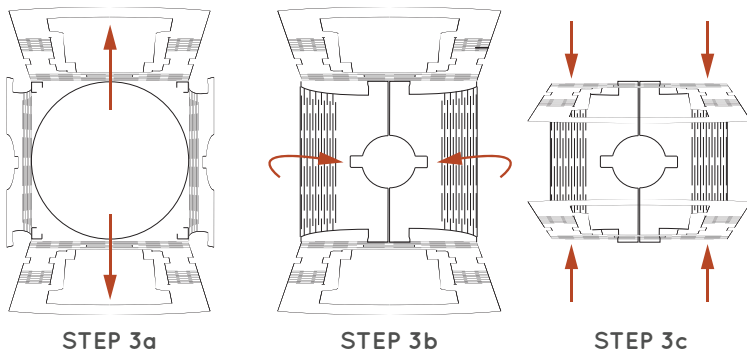

## FASTENING THE CARRIER

### STEP 3

- 3a** - Slightly bend out the tall panels.
- 3b** - Fold the short panels together inward so the tabs align with the slots on the tall panels.
- 3c** - Secure the tabs by bending the tall panels back toward each other.

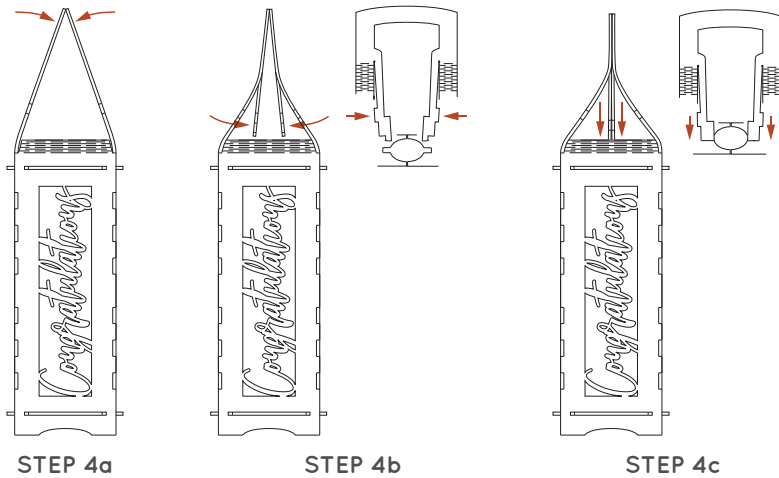

### STEP 4

- 4a** - Bend the tall panels together at the top.
- 4b** - Press together the inner prongs together while slightly squeezing inwards.
- 4c** - Push the prongs downward into corresponding slots and release. The box should now remain closed around the bottle.

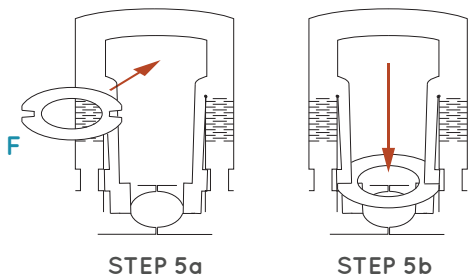

## ADDING THE GIFT TAG

### STEP 5

- 5a** - Insert the gift tag (**F**) into the upper larger part of the handle, aligning the tag slots with the handle sides.
- 5b** - Slide the gift tag down over the bottle neck.