

Starline XL

Heavy Duty Passthrough Dishwasher
W 750mm x D 765mm x H 1530mm

The Starline XL is a powerful, versatile, simple-to-use and easy-to-maintain passthrough dishwasher. With world class water consumption rates, high performance 1.5HP wash pump, and rapid rinse heating the Starline XL is highly productive, economical to operate and light on the environment.

The XL features Washtech hybrid controls which combine IP65 stainless switches and tried-and-tested switchgear with a customisable electronic timer. In addition it is equipped with a heavy duty stainless steel wash manifold and scrap trays, and is supplied suitable for connection to either single or three phase power supplies.

Since 1981 Washtech dishwashers have been constructed in New Zealand from heavy-duty stainless steel, and are engineered specifically for New Zealand conditions and regulations. Backed by the most extensive service network and spare parts inventory in the region, your XL will not let you down.

Standard Features

- 40, 60 and 90 second cycles – autostart upon hood closure
- Capacity of up to 1,620 plates per hour
- Low hot water consumption of 2.4 litres per cycle
- Heavy-duty stainless steel construction
- Heavy-duty stainless steel wash and rinse arms with precision stainless steel jets
- Heavy-duty stainless steel double filtration system with dual scrap trays and separate wash inlet filter
- Washtech hybrid controls
- Easy installation including:
 - Water supply hose
 - Detergent and rinse aid pumps with injector lines

Includes:

- 2 x 500mm dish rack (600 70028)
- 1 x 500mm cup rack (600 70029)
- 1 x cutlery basket (C660508)
- 1 x cutlery container (C660503)



Starline XL

washtech.co.nz

Washtech Limited

PO Box 90-548
Auckland 1142

414 Rosebank Road
Avondale
Auckland 1026
NEW ZEALAND

(09) 829 0930
info@washtech.co.nz

service@washtech.co.nz

For 24/7 service and support:
0800 WASHTECH

Washtech provides full service and support 24 hours a day, 7 days a week, with a comprehensive nationwide network of authorised service providers.

In line with policy to continually develop and improve its products, Washtech reserves the right to change specifications and design without notice.

© 2021 Washtech Limited
Version: SXL0030 2104

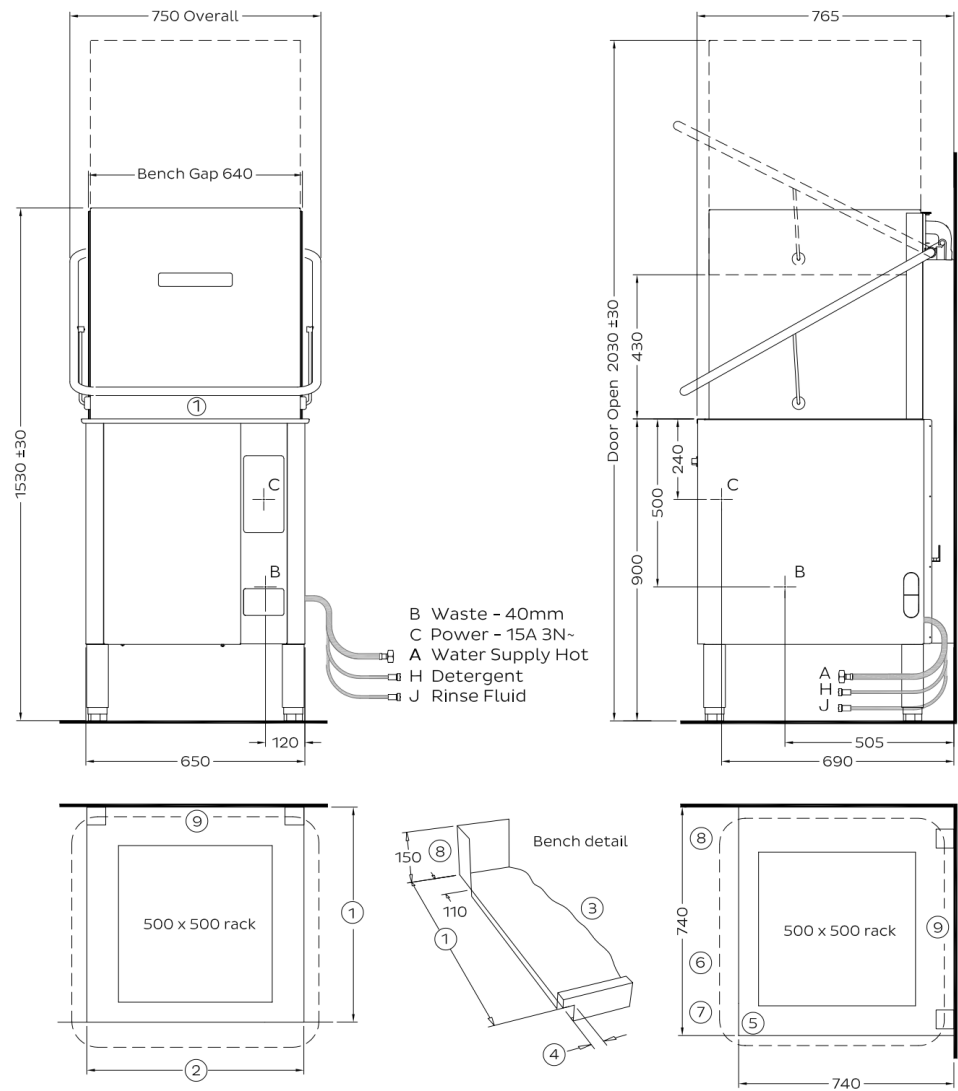

A - Hot Water

Temperature 65°C
Connection 3/4" male; hose supplied
Pressure 200-350kPa
Flow 20 litres per min
Quality Potable - refer table
Backflow Prevention AVB
Consumption 2.4 litres per cycle*

B - Waste

Connection 1.5" BSP
Line 2" BSP

C - Electrical	V	Hz	A/phase	Max kW
Single Phase	240	50	25	6.10
Three Phase	415	50	15	9.00

Dimensions

	Machine	Packed
Width (mm)	750	760
Depth (mm)	765	830
Height (mm)	1530	1450
Weight (kg)	120	141
Volume (m³)		0.92

Water Quality

	Min	Max
pH	7	8
Hardness (ppm)	20	100
Cl-		100
SO ₄		400
Fe		0.1
Mn		0.5
Cu		0.05
Cl ₂		0.1

Corner Installation Notes

- Machine must face left for easy access to controls
- Allow 300 clearance to front for service access
- Splashback return must be no higher than 150mm

Isolating switch must be within 1m of, and not directly behind the machine.

* Water consumption rates may vary based on site conditions.

Refer to operator manual for installation instructions.