

## Starline PW1

Front-Loading Warewasher  
**W 680mm x D 780mm x H 1790mm**

Wash Chamber  
W 565mm  
D 600mm  
H 750mm

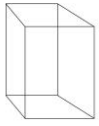

Washtech warewashers are built to improve the efficiency of operations washing oversized and/or heavily soiled items, from bakeries to production kitchens, supermarkets to hospitals. This is achieved with a continuous and consistent wash process throughout the day that is easy on your staff. With highly efficient water consumption rates, they are also light on the environment and operating costs.

The PW1 is a powerful, highly durable, simple-to-use and easy-to-maintain front-loading warewasher. It features Washtech hybrid controls which combine IP67 stainless switches, tried-and-tested switchgear, with a customisable electronic timer. Built with a large wash chamber and counterbalanced split door, the PW1 is ideal for washing bins, crates, bowls and other oversized items.

Since 1981 Washtech dishwashers have been constructed in New Zealand from heavy-duty stainless steel, and are engineered specifically for New Zealand conditions and regulations. Backed by the most extensive service network and spare parts inventory in the region, your PW1 will not let you down.

### Standard Features

- Versatile 2, 4 and 6 minute wash cycles
- Large internal wash chamber with useable area of W 565mm x D 600mm x H 750mm
- Low hot water consumption of 2.6 litres per cycle
- Washtech hybrid controls
- Easy installation supplied with:
  - Water supply hose
  - Detergent and rinse aid pumps with injector lines
- Internal upper rail with optional and adjustable tines suited for hanging ladles, whisks and/or washing up to 10 baking or GN trays (up to 40mm deep) per cycle
- High powered wash system
- Suitable for connection to low inlet water temperature and/or pressure (break tank and rinse pump fitted)
- Heavy-duty stainless steel construction and wash manifold
- Robust stainless steel wash and rinse arms with precision stainless steel jets
- Double heavy-duty stainless steel filtration system including dual scrap trays and separate wash inlet filter
- Wash chamber easily accessible via counter-sprung split door

### Includes:

- 1 x 500mm dish rack (600 70028)
- 1 x 500mm cup rack (600 70029)
- 1 x 435mm cup cover (K0452)
- 1 x cutlery basket (C660508)
- 1 x potwasher rack grid (824 30001)
- 1 x hanging rail with adjustable tines (824 10228)



## Starline PW1

washtech.co.nz

### Washtech Limited

PO Box 90-548  
Auckland 1142

414 Rosebank Road  
Avondale  
Auckland 1026  
NEW ZEALAND

(09) 829 0930  
info@washtech.co.nz

service@washtech.co.nz

For 24/7 service and support:  
**0800 WASHTECH**

Washtech provides full service and support 24 hours a day, 7 days a week, with a comprehensive nationwide network of authorised service providers.

In line with policy to continually develop and improve its products, Washtech reserves the right to change specifications and design without notice.

© 2021 Washtech Limited  
Version: SPW10020 2103

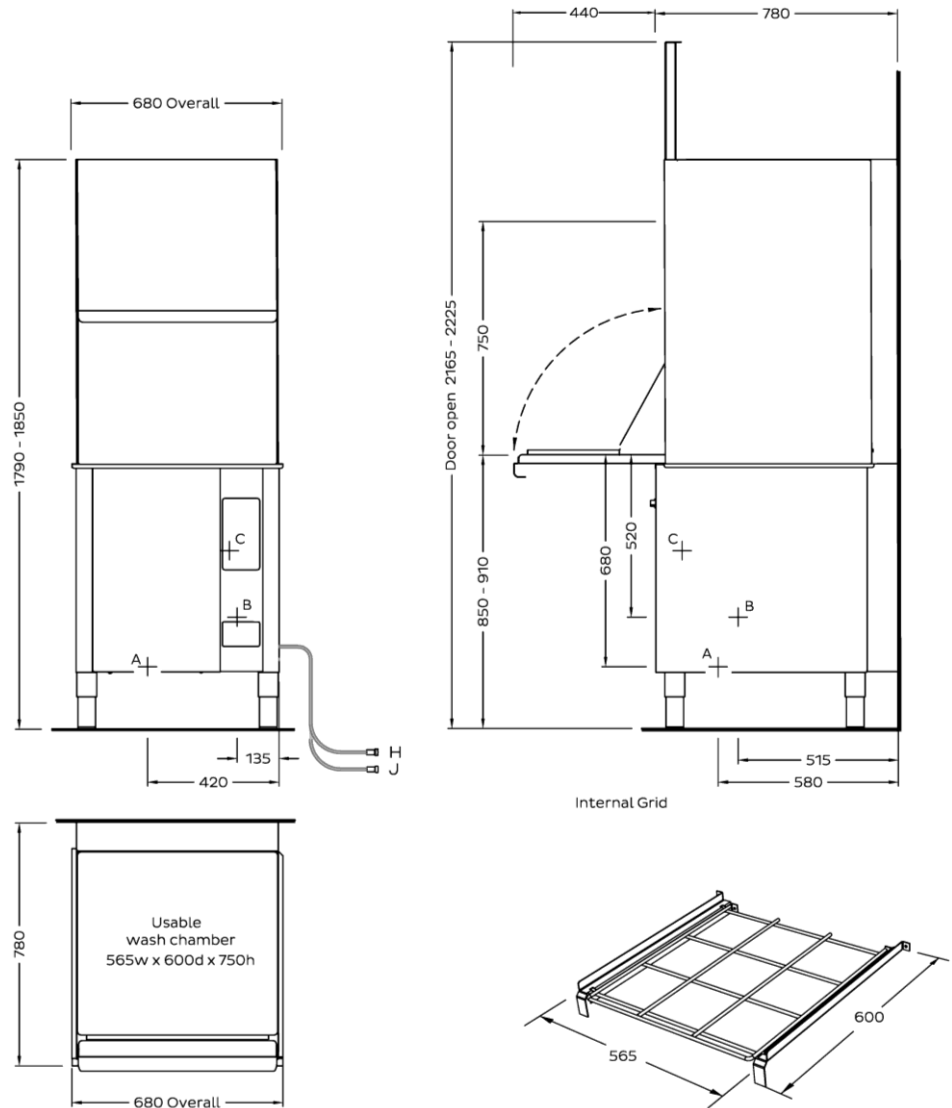

### A - Hot Water\*

Temperature 65°C  
Connection 3/4" male; hose supplied  
Pressure 100-350kPa  
Flow 10 litres per min  
Quality Potable - refer table  
Backflow Prevention AVB  
Consumption 2.6 litres per cycle

### B - Waste

Connection 1.5" BSP male  
Line 2.0" / 50mm minimum

C - Electrical	V	Hz	A/phase	Max kW
Three Phase	400	50	25	18.00
Three Phase	400	50	15	10.50

### Dimensions

	Machine	Packed
Width (mm)	680	770
Depth (mm)	780	870
Height (mm)	1790	1805
Weight (kg)	164	187
Volume (m <sup>3</sup> )		1.21

### Water Quality

	Min	Max
pH	7	8
Hardness (ppm)	20	100
Cl <sup>-</sup>		100
SO <sub>4</sub>		400
Fe		0.1
Mn		0.5
Cu		0.05
Cl <sub>2</sub>		0.1

Isolating switch must be within 1m of, and not directly behind the machine.

\* Suitable for connection to cold inlet water. For optimal productivity, use hot inlet water.

Refer to operator manual for installation instructions.