

PW1C

Front Loading Warewasher including Heat Recovery Unit W 680mm x D 780mm x H 2065mm

Starline warewashers are built to improve the efficiency of operations washing oversized and/or heavily soiled items, from bakeries to production kitchens, supermarkets to hospitals.

The PW1C is a powerful, highly durable, simple-to-use and easy-to-maintain front load warewasher. It features Starline hybrid controls which combine IP67 stainless switches, tried-and-tested switchgear, with a customisable electronic timer. Built with a large wash chamber and carefully counterbalanced split door, the PW1C is ideal for washing baking and GN trays, bins, bowls and other oversized items.

The PW1C also features a highly efficient heat recovery unit which ensures minimal energy consumption and steam emissions, for even lower operating costs and an improved working environment.

Since 1981 Starline dishwashers have been constructed in New Zealand from heavy-duty stainless steel, and are engineered specifically for local conditions and regulations. Backed by the most extensive service network and spare parts inventory in the region, your Starline PW1C will not let you down.

Special Features

- Suitable for installation without an extraction canopy in many situations*
- Integrated heat recovery unit which preheats the cold water supply, significantly reducing steam emissions, energy consumption

Standard Features

- Versatile 2.5, 4.5, 6.5 minute wash cycles
- Large internal wash chamber with useable area of W 565mm x D 600mm x H 750mm
- Low cold water consumption of 2.6 litres per cycle
- Starline hybrid controls
- Easy installation supplied with:
 - Water supply hose
 - Detergent and rinse aid pumps with injector lines
 - No commissioning required
- Internal upper rail with optional and adjustable tines suited for hanging ladles, whisks and/or washing up to 10 baking or GN trays (up to 40mm deep) per cycle
- High powered wash system
- Suitable for connection to low inlet water temperature and/or pressure (break tank and rinse pump fitted)
- Heavy-duty stainless steel construction and wash manifold
- Robust stainless steel wash and rinse arms with precision stainless steel jets
- Double heavy duty stainless steel filtration system including dual scrap trays and separate wash inlet filter
- Wash chamber easily accessible via insulated counter-sprung split door
- Comprehensive 12 month Starline warranty

Includes:

- 1 x 500mm x 500mm dish rack (600 70028)
- 1 x 500mm x 500mm cup rack (600 70029)
- 1 x cutlery basket (C660508)
- 1 x 435mm cup cover (k0452)
- 1 x potwasher rack grid (824 30001)
- 1 x upper hanging rail with adjustable tines (824 10228)

* Full certificate and conditions from SEED available on request

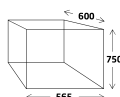

PW1C

Front Loading Warewasher including Heat Recovery Unit
W 680mm x D 780mm x H 2065mm

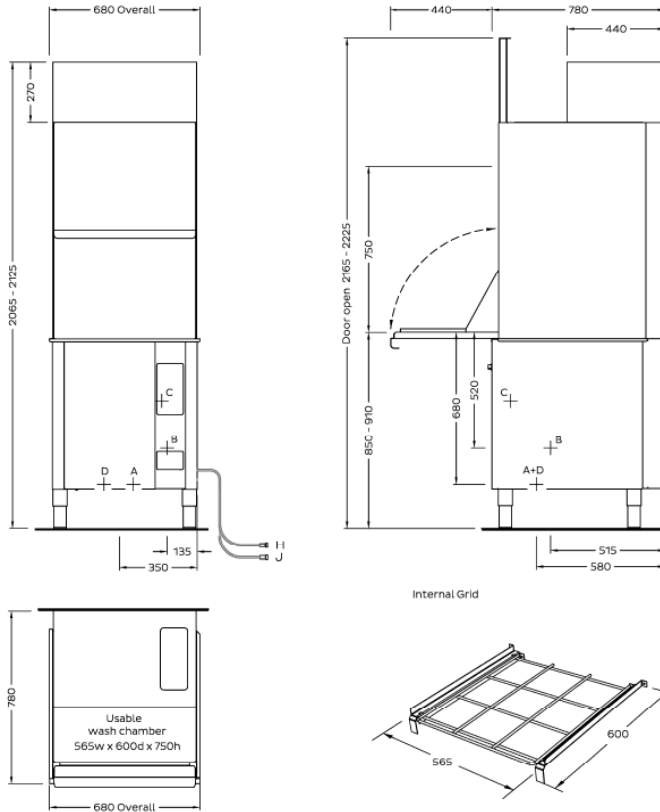

WASHTECH

WASHTECH LTD
PO Box 90-548
Auckland 1142
414 Rosebank Road
Avondale
Auckland 1026
New Zealand
Phone 09 829 0930
info@washtech.co.nz
www.starline.co.nz



ISO9001
All Starline products are designed and manufactured by Washtech using the internationally recognised ISO9001 quality management system, covering design, manufacture and final inspection, ensuring consistent high quality at all times.



Service and Support
On call service where you are. Washtech provides full service backup, 24 hours a day, 7 days a week with factory based technicians and a comprehensive nationwide network of independent service providers. STARLINE SERVICE 09 829 0923

In line with policy to continually develop and improve its products, Washtech reserves the right to change specifications and design without notice.

© Copyright Washtech 2016
Version 1907

D Cold water	Temperature	<25°C			
	Connection	3/4" male; hose supplied			
	Pressure	200-350kPa			
	Flow	10 litres per min			
	Quality	Potable - refer table			
	Backflow Prevention	Atmospheric Vacuum Breaker			
	Consumption	2.6 litres per cycle			
A Hot water (fill only)	Temperature	65°C			
	Connection	3/4" male; hose supplied			
	Pressure	200-350kPa			
	Flow	20 litres per min			
	Quality	Potable - refer table			
	Backflow Prevention	Atmospheric Vacuum Breaker			
B Waste	Connection	1.5" BSP male			
	Line	2.0" / 50mm minimum			
C Electrical	V	Hz	A/phase	max Kw	
	3P + N + E	400	50	25	18.00
	Option:				
	* 3P + N + E	400	50	15	10.50

Dimensions	Machine	Packed
Width	680	770
Depth	780	870
Height	2065	2090
Weight	186	209
Cubicmetres		1.40

Water Quality	Min	Max
pH	7	8
Hardness ppm	20	100
Cl-		100
SO ₄		400
Fe		0.1
Mn		0.5
Cu		0.05
Cl ₂		0.1

Refer operator manual for installation instructions. Isolating switch must be within 1m of, and not directly behind the machine.

* Connection on lower power rating will reduce the wash and rinse heating, and delay the operation of the machine.