

Customer/Wholesaler:	Date:	Job Name:	Model Specified:	Quantity:
Contractor:		Architect/Engineer:		

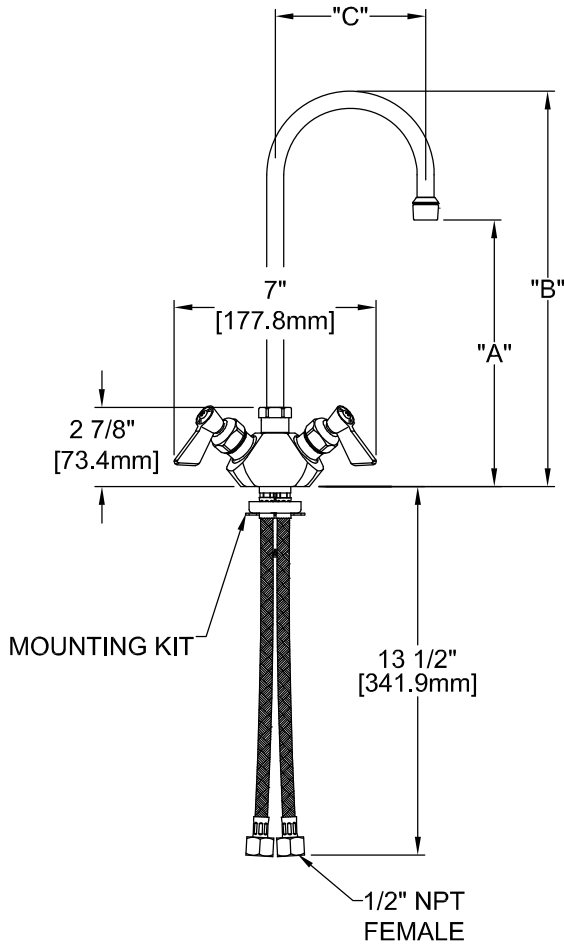

FOOTPRINT:

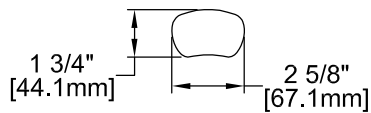

MODEL	DIM "A"	DIM "B"	DIM "C"
3115	10" [254.0mm]	14" [355.6mm]	5-1/2" [139.7mm]
1872	6" [152.4mm]	9-1/2" [241.3mm]	3-1/2" [88.9mm]

ROUGH-IN:

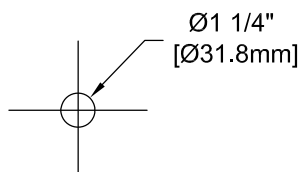

MODEL:

- 3115 FAUCET SDDLH 12SGN
- 1872 FAUCET SDDLH 06SGN

OPTIONS OR MODIFICATIONS:

- OTHER _____

FEATURES:

- * SINGLE DECK, DUAL CONTROL
- * SWIVELING SEAT DISKS
- * HOT SIDE STEM - RIGHT HAND
- * COLD SIDE STEM - LEFT HAND
- * STAINLESS STEEL SEATS
- * STAINLESS STEEL SEAT SCREWS
- * STAINLESS STEEL HANDLE SCREWS
- * FLEXIBLE INLET HOSES

SYSTEM LIMITS

- * TEMP: 40°F MIN. TO 160°F MAX.
- * PRESSURE 200 PSI MAX. STATIC
- * 2.20 GPM AT 60 PSI (8.3L/min @ 410 kPa)

SHIPPING WEIGHT

- * 4.75 LBS

PRODUCT COMPLIANCE:

- * ASME A112.18.1 / CSA B125.1
- * NSF 61 - Section 9
- * NSF 372 (Low Lead Content)

Replacement Parts for Single Deck Dual Mount Faucets

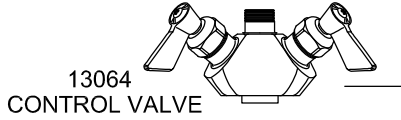

65944
SINGLE
DECK DUAL
CONTROL KIT
(Includes 2 Hoses)

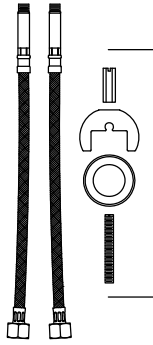

2000-7500
SCREW



2000-8000
RED BUTTON
AND
2000-8001
BLUE BUTTON

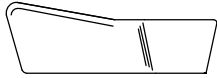

LEVER HANDLE

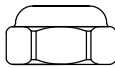

2000-3002
BIBB CAP



73657
DUCK GASKET



2000-5000
WASHER



3000-0010
LH SWIVEL STEM
OR
3000-0011
RH SWIVEL STEM

2000-5003
SEAT WASHER

1000-7502
SCREW



73521
LUBE

3968
6" SWIVEL
GOOSENECK SPOUT

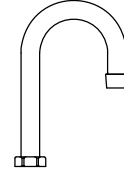

3965
12" SWIVEL
GOOSENECK SPOUT

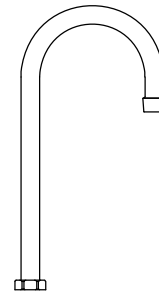

2000-0002
LEVER HANDLE KIT

12564
2.2 GPM
AERATOR

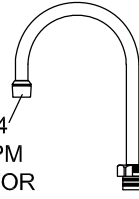

73684
SPOUT NUT



20020
SNAP RING



1600-5000
SPOUT
O-RING



73521
LUBE



19119
SWIVEL SPOUT
RETRO-FIT KIT

3000-0000
RH SWIVEL STEM
REPAIR KIT
OR
3000-0001
LH SWIVEL STEM
REPAIR KIT