

APPLICATION:

PRODUCT NAME:

REEL EXP 30 SV

JOB NAME:

MODEL:

QUANTITY:

ITEM NO.:

- ☐ 29801 REEL EXP 30 SV WITH PRO SPRAY VALVE  
☐ 75209 REEL EXP 30 SV WITH ULTRA SPRAY VALVE

OPTIONS OR MODIFICATIONS:

☐ OTHER \_\_\_\_\_

## FEATURES

## REEL

- \* SELF-LOCKING
- \* EXPOSED HOSE
- \* 30' LENGTH REEL HOSE
- \* 18" LENGTH INLET HOSE
- \* 3 PLY FIBER REINFORCED RUBBER HOSE
- \* ADJUSTABLE BALL STOP

## PRO SPRAY VALVE

- \* NOZZLE THREADED INTO VALVE
- \* 2.65 GPM AT 80 PSI
- \* SHOWER SPRAY PATTERN

## ULTRA SPRAY VALVE

- \* LOWEST ENERGY USER - 1.15 GPM @ 60 PSI
- \* CLEANS FASTER - TEST PROVEN
- \* ENGINEERED TO LAST - NO 'O' RINGS TO LEAK
- \* INTERCHANGEABLE - FITS ALL BRANDS

## SYSTEM LIMITS

- \* TEMP: 40°F MIN. TO 160°F MAX.
- \* PRESSURE: 200 PSI MAX. STATIC

- \* SHIPPING WEIGHT

## SHIPPING WEIGHT

- \* 34.0 LBS

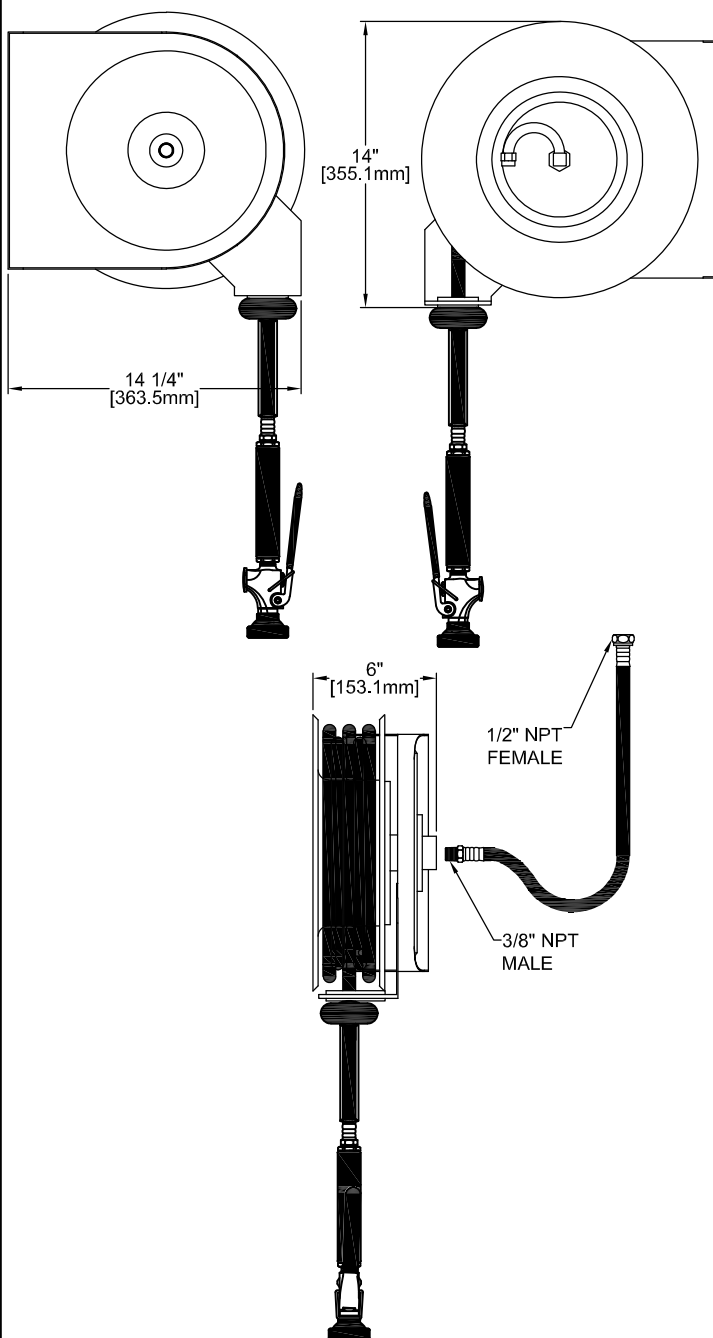

ROUGH-IN: SEE MOUNTING PLATE BELOW

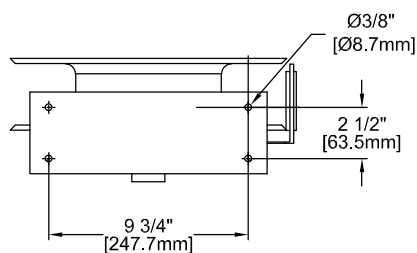

# FISHER

FISHER MANUFACTURING COMPANY  
TOLL FREE: 800-421-6162 - FAX: 800-832-8238  
information@fisher-mfg.com - www.fisher-mfg.com