

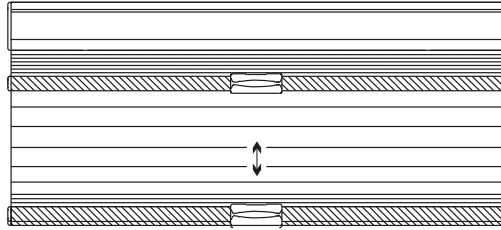



# CORDLESS DAY & NIGHT CELLULAR SHADES INSTRUCTIONS

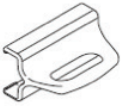
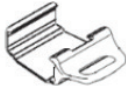
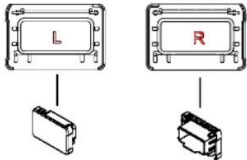
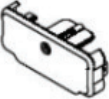

## PREPARATION

### 1 Check the Hardware

- |  |  |   |   |
|--|--|---|---|
|   |   |    |  |
| <b>A</b> Bracket<br>W < 38" = 2<br>W > 38" = 3                                     | <b>B</b> Middle Handle<br>W < 38" = 1<br>W > 38" = 2                               | <b>C</b> Bottom Handle<br>W < 38" = 1<br>W > 38" = 2                                | <b>D</b> Headrail Endcaps x 2   |
|  |  |  |   |
| <b>E</b> Bottomrail Endcaps x 2  | <b>F</b> Middlerail Endcaps x 2  | <b>G</b> Hex-Headed Screw<br>W > 38" = 4<br>W < 38" = 6                             |   |

### 2 Prepare Tools

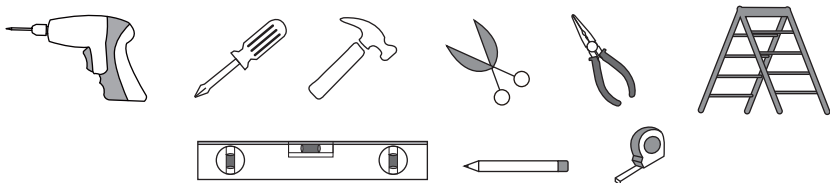

## INSTALLATION

### 1 Installing the Brackets

#### OUTSIDE MOUNT:

Position brackets **A** above window opening. Remember to leave the brackets few inches away from each side of your window. Spread them out evenly by having same distance from each side of the window. Make sure brackets are aligned. "L" shape opening should be facing down, with shorter side against the wall.

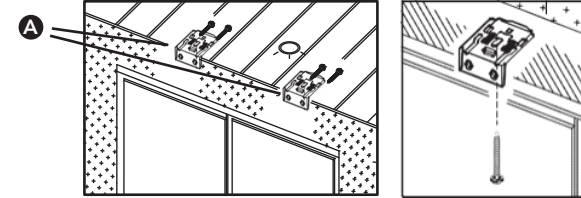

#### INSIDE MOUNT:

Position brackets **A** along the top of the window opening in the desired location. Remember to leave few inches away from each side of your window. Make sure both brackets are aligned. "L" shape opening should be facing down, with longer side against top of the window opening.

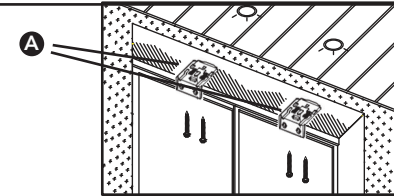

#### NOTE:

Insert 1 hex-head screws into oval opening, between 2 springs, and fasten.

**DO NOT** use hex-head screws for holes on the back of the bracket for inside mount. It will prevent your shade from clicking in place. These holes can be operated with 2 flat-head screws (Flat-head screws are not included in the package).

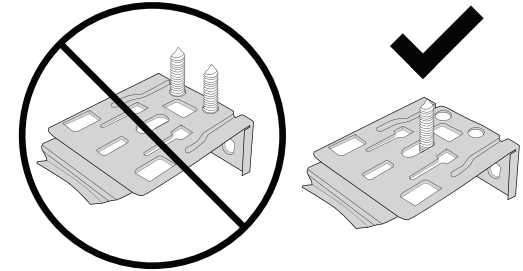

### 2 Prepping the Shade

Remove the wrap and install the headrail endcaps **D**, middlerail endcaps **F** and bottomrail endcaps **E** on each end.

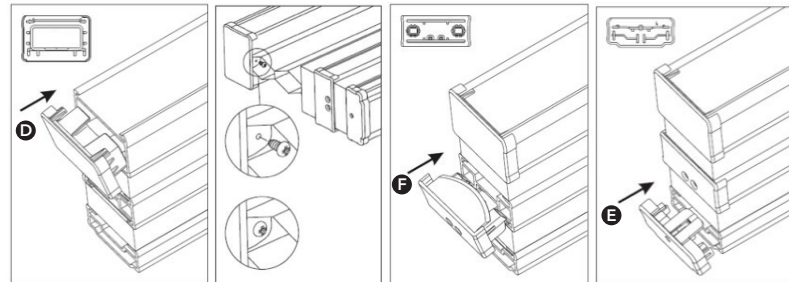

### 3 Mount Shade on Brackets

Install the headrail by hooking the front of the **bracket A** and push shade towards back of **brackets**, in a rolling motion, until clicks place.

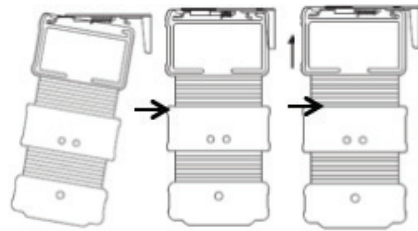

### 4 Installing the Handles

To insure proper usage of cordless shades, be sure to extend and retract shade steadily assuring the cord to stack evenly.

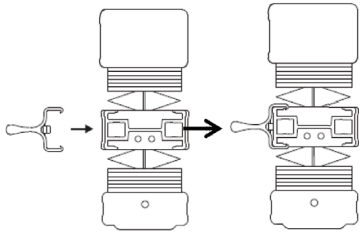

Install midrail handle **B**.

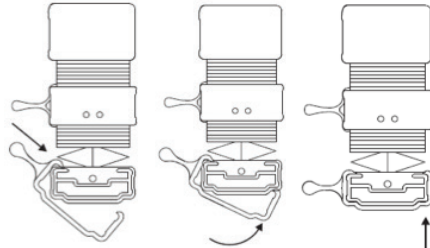

Install bottomrail handle **C**.

### Quick How-to-use Guide

#### Procedure of Operation

1. When the blind is lowered, please first down the bottom rail, then move the middle rail to the desired position.

2. When the blind is raised, please first move the middle rail upwards, then move the bottom rail up to the desired position.

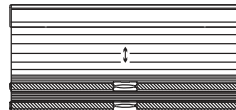
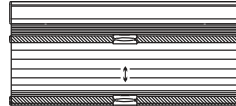

 Please allow 24 hours for your shade to drop to its actual height when first installed due to the nature of the fabric.

 For cordless cellular shade, it is recommended to operate every 5 to 7 days because if the fabric is in long-term stationary position, that will cause the operation to not function smoothly (raising and lowering), especially for opaque fabrics.

### Questions

**EMAIL**  
support@chicology.com

**HOW - TO**  
www.chicology.com/how-to

**PHONE**  
866-999-6188

**HARDWARE**  
www.chicology.com/missing-hardware



## Chicology Ready-Made Blinds and Shades Warranty

Limited One Year Warranty from the Date of Purchase

#### What is Covered :

- All of our shades are warranted against manufacturer defects in materials or workmanship provided that you are the original purchaser of the product, and the product was installed according to our instructions.

#### What is Not Covered :

- Normal wear and tear.
- Consumer damages caused by accidents, alterations, abuse of the product, exposure to salt air, misuse, or damages from pets or insects.
- Damages resulting from removal and reinstallation in the same or any other window or application, or failure to follow instructions, such as measurement, installation, cleaning, and maintenance.
- Any products that, with the passage of time, has yellowing or cracking of plastic parts
- Wrong measurements are not covered by the warranty and are not refundable.

#### To report shipping damages :

If damage occurred during shipping, please call 1 (866)999-6188 immediately and report within 14 calendar days or else you may be denied for your damaged product.

#### Obligations to the consumer :

The obligations of Chicology are limited to the repair or replacements of parts or products found to be defective. Chicology will determine if the product is defective or not and may replace the product. If the product is found to have manufacture defects, we will repair or replace the product. Colors do vary from lot to lot, and may not match original product exactly. Discontinued items will be replaced with the most current product of the same price.

#### Your Rights under State law :

This limited warranty gives you specific legal rights, and you may have other rights, which vary from state to state.

#### Contacting us :

If you believe your shade has a manufacturing defect, please call 1 (866)999-6188