

ACP Wall Mounted Poles

Ideal for gaining an elevated view point from existing structures.

ACP Part Numbering

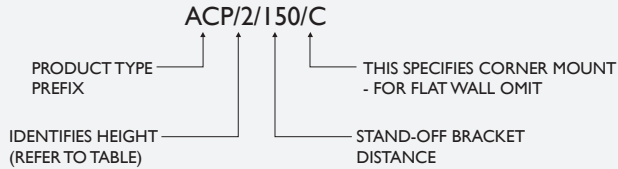

Stand-Off Bracket Options

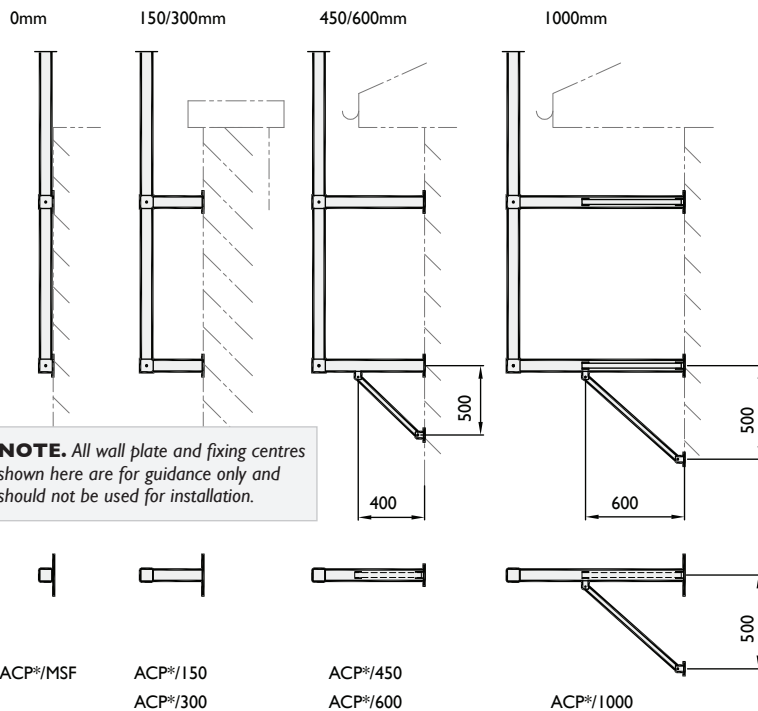

* INSERT MODEL NUMBER

Wall Plate Details

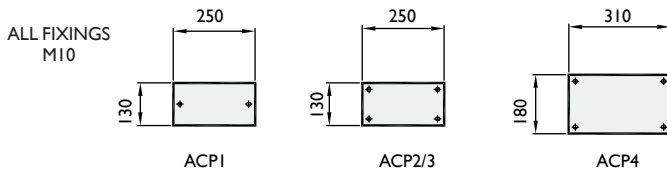

Corner Mount Bracket Details

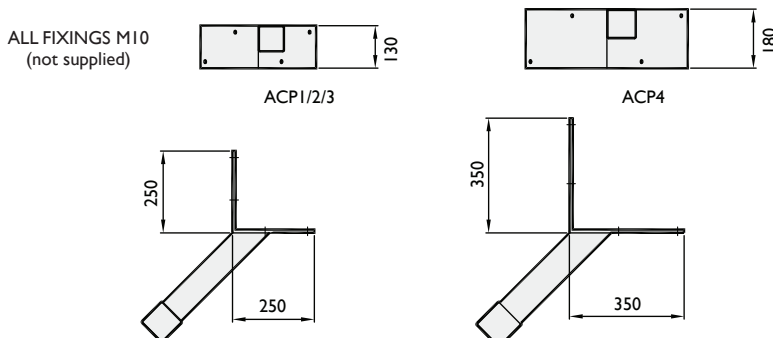

Features

- o Poles up to 6m shipped on carrier for overnight delivery
- o Rigid construction
- o Hot dip galvanised for longevity
- o Full range of accessories available

Model Number	H	B	A	C	D
ACP1	3m	70 ²	0.3m	1.7m	1m
ACP2	4m	80 ²	0.3m	2.2m	1.5m
ACP3	5m	80 ²	0.4m	2.6m	2m
ACP4	6m	90 ²	0.5m	3.5m	2m

• Most variations held in stock

- o Dimension 'A' to be maintained for upper bracket fixing strength
- o Dimension 'D' to be maintained for camera stability and strength of fixings into wall

Note ref wall construction. We have designed the loading and bolt fixing for our wall mounted poles for fixing into good brickwork with no less than the minimum spacing on wall brackets, as noted in the table above. For breeze block type walls and brick walls in poor condition, we recommend bolting through the wall and employing a structural engineer, to ensure that the wall is suitable.

PTZ MOUNTING PLATE WITH 8 No. ø8.5 HOLES EQUI-SPACED ON A ø101.6 PCD.

**Max headload
25 kgs - 0.25m²**

