

# LULANI

Faucet Co

## Installation Instructions

BA-420-01

Single Handle Bathroom Faucet

Thank you for selecting Lulani.

To ensure that your installation proceeds smoothly, please read these instructions carefully before you begin.

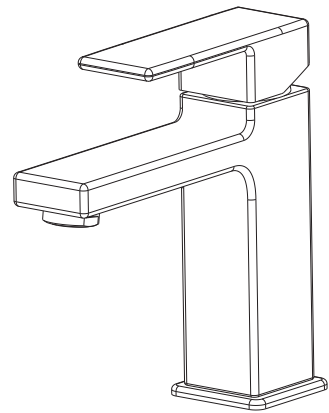

### Parts Included

1. Faucet
2. Above sink hardware: O-ring
3. Below sink hardware: rubber washer, metal washer, mounting nut
4. Pop-up drain

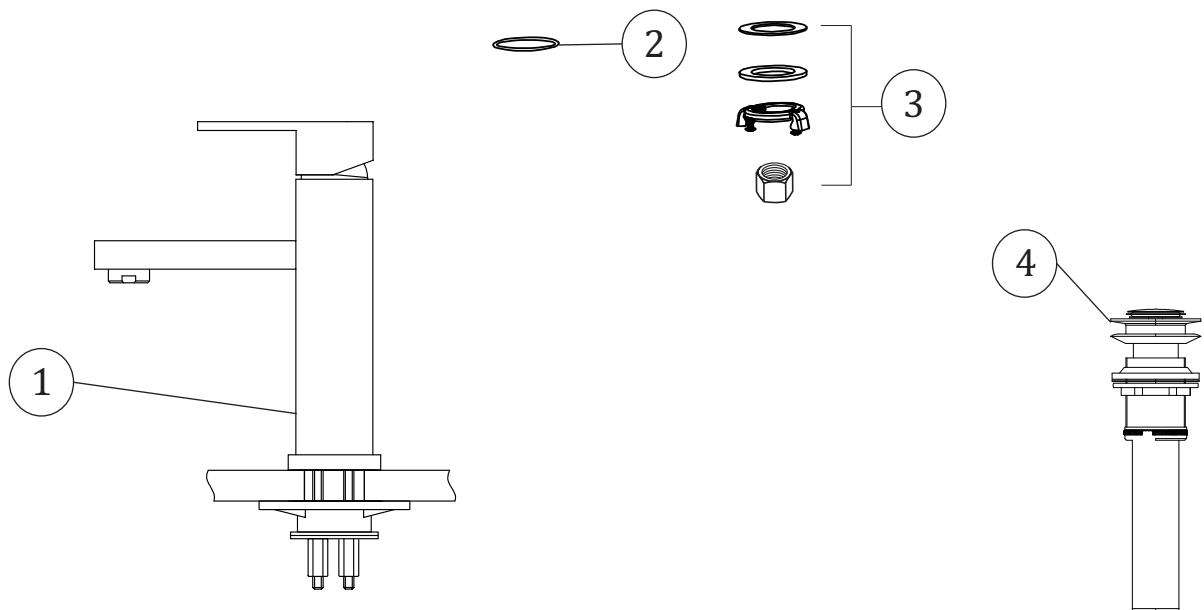

### Recommended Tools (not included)

- |                         |                     |
|-------------------------|---------------------|
| 1. Adjustable Wrench    | 6. Measuring Tape   |
| 2. Phillips Screwdriver | 7. Silicone Sealant |
| 3. Safety Goggles       | 8. Channel Locks    |
| 4. Flashlight           | 9. Allen Key        |
| 5. Plumber's Tape       |                     |



### Caution: Tips for removal of old faucet

Always turn off the water supply before removing the existing faucet or replacing any part of the faucet. Open the faucet handle to relieve water pressure and ensure that water is completely shut off.

### Maintenance

Your new faucet is designed for years of trouble-free performance. Keep it looking new by cleaning it periodically with a soft cloth. Avoid abrasive cleaners, steel wool, and harsh chemicals as these will dull the finish and void your warranty.

### Step 1

Place the faucet through holes on top of the sink.  
From under the sink, slide the washer onto the threads.  
Secure with washer and nut.

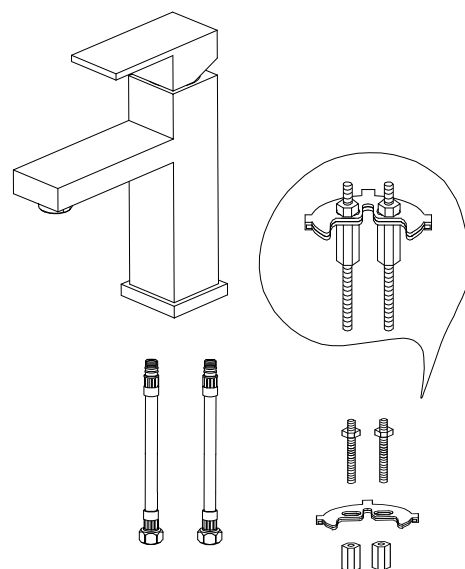

### Step 2

Connect the hot and cold water supply lines, then use  
1/2" I. P. S. faucet connections.

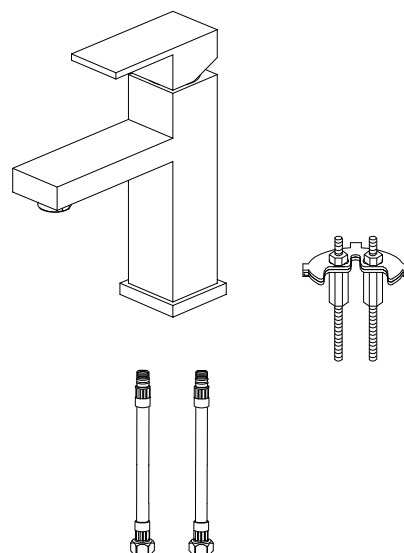

### Step 3

Disassemble the nuts from the threads and water supply lines. Place washer directly under the faucet and reassemble the threads and water supply lines to go through the washer.

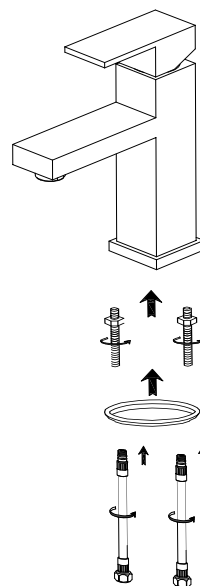

### Step 4

Place the faucet through the sink hole with the water supply lines. The gasket will assemble underneath the sink by screwing the nuts to the threads.

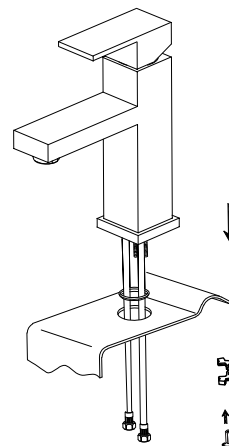

### Step 5

Use a wrench to connect the water supply lines to the matching water valves. Do not over tighten.

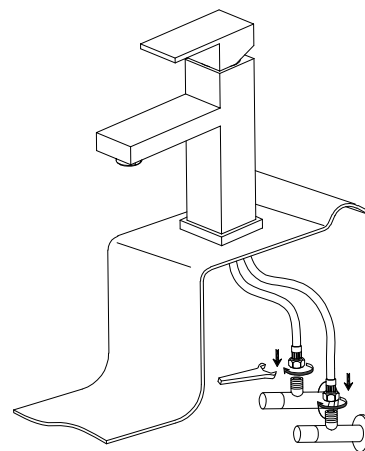

For troubleshooting questions or concerns, please reference the Owner's Manual or visit our website at [www.lulani.com](http://www.lulani.com).

We value your opinion! Don't forget to leave us a review.