



ITEM FAE-207 FIRST AID BED USER MANUAL



I. Scope of application

The examination couch is used in different clinic areas for patient examinations. The compact design with functional back rest provides both the physician and patient with an excellent using experience.

II. Parameter & Function

Size: 71in x 24in x 33in (180.3cm x 60.9cm x 83.8cm)

Back section adjustable from 0-70 degree by rod.

Mattress thickness: 1.9in (5cm)

Rubber feet thickness: 0.2in (.5cm)



III. Assembly Steps :

PARTS

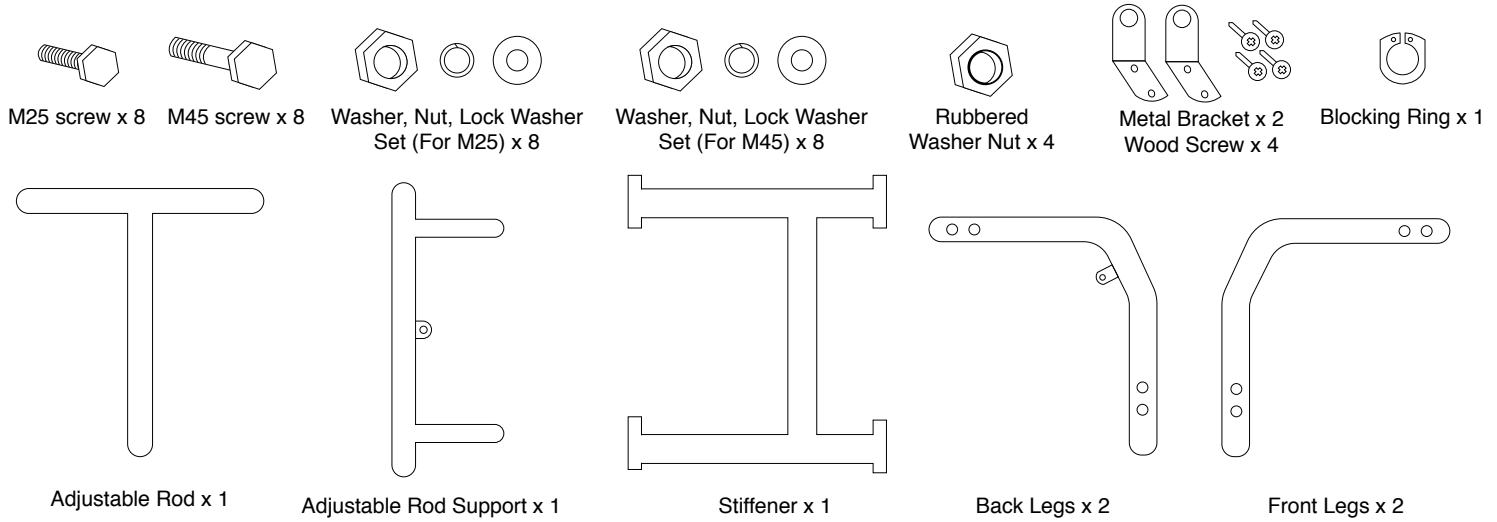

STEPS

1. Place the Adjustable Rod into the two holes provided behind the backrest of the treatment bed using the rubbered washer nut (2).

2. Screw the 4 legs in place into the holes provided on the side of the treatment bed using the M45 screws and lock into place using the medium sized washers, nuts, and lock washers. Screw the legs in loosely to leave room for the Adjustable Rod Support and Stiffener. Note: If the legs are tightly screwed in place, it will be difficult to insert the adjustable rod support and stiffener in between the legs. Alternatively, you may screw legs on one side in first, insert the support and stiffener, and assemble the second set of legs into place. For instructions on how to assemble Stiffener see Step 5.

3. Insert the adjustable rod support into the two holes provided in the back legs of the treatment bed. Secure into place using the remaining rubbered washer nut (2). Note: the handles on the adjustable support MUST be facing outwards.

4. To adjust the the backrest, lift the handles on the Adjustable Rod Support upwards and adjust backrest angle accordingly. Use the Blocking Ring provided to secure the rod in place and prevent it from disconnecting from the Rod Support. To secure with Blocking Ring: insert ring into groove located at the end of the rod.





5. Connect the stiffener to the holes provided in each leg (each leg should provide 2 holes) with the M25 screw and secure in place with the small set of washers, nuts, and lock washers. Once the stiffener has been assembled into place, tighten all screws on each leg. Note: The middle bar of the stiffener is not centered, allowing for more leg room on one side. If the bed is being placed against the wall, ensure that the bigger space is facing outward or away from the wall.



6. To assemble the disposable liner roll holder, place the metal bracket underneath the front part of the treatment bed. Make sure the part with two holes is the part placed against the bed. Screw in using the wood screws provided. Note: Liner roll is not included.



IV. Operation Instruction :

A) Operation the back section of bed: Back rest adjustable by pole in various degree.

* MAINTENANCE :

The examination couch is a reusable medical device and should be noted:

Do not expose the device to excessive moisture, as this may result in personal injury or equipment damage.

Routine cleaning: Do not directly wash the surface of the table with water to avoid damage to the electrical equipment. Wipe it with a soft, clean cotton cloth and wring it with warm water. It can also be wiped with a 75% isopropyl alcohol solution for better results.

Clean stubborn dirt: To clean stubborn dirt, use a standard household cleaner and a soft brush. To soften stubborn stains that have already dried up, first need to soak the stain.

The life cycle of parts is six years. Before the end of the life cycle, it is necessary to check the wear of each part frequently and replace the parts in time.

The mattress and the leather surface of the auxiliary table shall be replaced in time after the damage, and the waste shall be disposed of in accordance with relevant regulations. If you need to replace the leather pad, it is recommended to contact the manufacturer to use the original size matching product, do not use other manufacturers' accessories to improve the safety of use. The bed should be stored in a dry, non-corrosive atmosphere and well ventilated environment to avoid direct sunlight.



The maintenance period is: 6 months.

*** LONG TERM CUSTODY AND REUSE :**

The examination couch in package should be placed in a ventilated room with relative humidity no more than 95% and there should not be any signs of corrosive gas.

The place where the treatment bed shall be kept should meet the environmental conditions as specified in Article 4 and Chapter 6 (a)(b) of this manual.

The Stock and transport condition:

- a) Environment condition : 10°C ~ +40°C;
- b) Atmospheric moisture : 30% ~ 70% RH;
- c) atmospheric pressure : 500hPa ~ 1060hPa;

*** ANALYSIS AND ELIMINATION OF MALFUNCTION:**

Description of malfunction	Analysis of cause	Elimination measures
Backrest cannot be adjusted	Obstacle indentified to be blocking adjustable bar	Removal of obstacle

VII. Others

If the product's appearance and individual technical parameters change, please contact us.

Note: If there are other concerns or issues that cannot be resolved, please contact the customer service department.