

**Berkey®**  
**Water Purifiers**  
"Simply the Best"

New Millennium Concepts Ltd.

**Black Berkey®**  
**Purification Element Installation**  
**and Operating Instructions**

**Berkey®**  
**Water Purifiers**  
"Simply the Best"

New Millennium Concepts Ltd.

**Black Berkey®**  
**Purification Element Installation**  
**and Operating Instructions**

**INTRODUCTION:**

Congratulations on your purchase of **Black Berkey®** purification elements, you have taken the first step towards protecting you and your family from water born contaminants.

**CONTENTS:** 2-Purification Elements, 2-Sealing Washers, 2-Wing Nuts, 1-Priming Button, 1-Instruction Sheet

**ASSEMBLY INSTRUCTIONS:**

1. Wash hands before proceeding to ensure that contamination of filter system components does not take place during assembly.
2. Remove parts from their protective packaging, checking items against contents list.
3. **Prime Black Berkey® purification elements. (See back side of system instruction sheet).**
4. Place the large sealing washer over the threaded mount of the **Black Berkey®** purification element.
5. Place the threaded mount stem into the hole in the interior base of the upper chamber.
6. Secure element in the base of the chamber by screwing the wing nut onto the threaded mount. Repeat #3- #6 until all elements have been installed.

**OPERATION:**

Fill upper chamber with cold room temperature water (**do not use hot or boiling water**) and cover with lid. Allow water to filter into lower chamber. Open the spigot to allow all water to run to waste. This will flush fines and process dust from inner bore of the purification elements. (Note: Do not be concerned if particulate is visible within flush water, this is normal). Refill upper chamber, your system is now ready to purify water.

**Note: Purification elements may take up to 15 minutes to begin dripping. Maximum flow rate will be achieved after the initial 12-20 hours of use as micro air pockets within purification elements are replaced with water.**

**MAINTENANCE:**

As the elements filter out particulate from the water, the flow will gradually reduce over time. When this occurs, remove the element and scrub the outer surface with a stiff toothbrush or ScotchBrite® pad under running water. Re-prime elements (optional). This procedure will restore the flow rate to normal. Take precautions not to contaminate the threaded portion of the purifying elements. If contamination does occur, wipe threads with an alcohol swab.

**Never wash purifying elements with soap. NEVER CLEAN ELEMENTS IN A DISHWASHER.**

**SYSTEM TEST:** Your **Black Berkey®** purification elements are powerful enough to remove red food coloring from water; this feature allows you to make sure your system is operating properly. Simply fill the upper chamber with water and add one teaspoon of artificial red food coloring per gallon capacity of your system. If the red food coloring is removed entirely, your purification system is working properly. If not, check to make sure that the wing nuts on your elements are securely tightened, then re-run the test. We recommend this test be done upon receiving the elements, first actual use, then while in use-every 3 to 6 months, before you take your system out of the country, or any time you use your system after drying and storing the elements for an extended period of time.

**GENERAL WARRANTY INFORMATION**

**Black Berkey®** purification elements have a two-year prorated warranty calculated in six months intervals from the date of purchase. New Millennium Concepts, Ltd. (NMCL) will replace or repair any product that it deems is not properly functioning during the stated warranty period. Relief under this warranty is limited to the replacement or repair of defective materials or workmanship only. NMCL shall not be held liable for incidental or consequential damage to personal property from, but not limited to, a defective unit, improper use, abuse, accident, or neglect, etc. NMCL shall not be responsible for any damage or loss other than for the product purchased. It is the customers responsibility to prevent misuse of the system and to replace parts when, due to the natural course of wear and tear, they must be replaced. No warranty will apply to units which have been used for purposes not intended, which have been altered so as, in the manufacturers judgment, to affect adversely its performance. This warranty is for the original retail purchaser only, and cannot be transferred. Repair or replacement of parts will be made upon delivery to manufacturer's plant or authorized service dealer at customer's expense. The laws of the State of Texas, USA, will govern any disputes regarding this warranty or claim made. This warranty which is given expressly in lieu of all warranties, expressed or implied, or merchantability and fitness for a particular purpose, constitutes the only warranty made by New Millennium Concepts, Ltd. (NMCL).

Each **Black Berkey®** element will give efficient purification for up to 3,000 gallons (6,000 per set of two) for the contaminants listed on box. The **Black Berkey®** element formulation has been tested by State & EPA accredited laboratories to exceed EPA & ANS/NSF (Std. 53) protocol. Tested by Analytical Services, the County of Los Angeles, Environmental Toxicology Lab, Envirotek Laboratories, Inc. & Water Filter Labs.

For questions, please contact your local **Berkey®** distributor, or call (888) 803-4438 / (817) 481-0717

**INTRODUCTION:**

Congratulations on your purchase of **Black Berkey®** purification elements, you have taken the first step towards protecting you and your family from water born contaminants.

**CONTENTS:** 2-Purification Elements, 2-Sealing Washers, 2-Wing Nuts, 1-Priming Button, 1-Instruction Sheet

**ASSEMBLY INSTRUCTIONS:**

1. Wash hands before proceeding to ensure that contamination of filter system components does not take place during assembly.
2. Remove parts from their protective packaging, checking items against contents list.
3. **Prime Black Berkey® purification elements. (See back side of system instruction sheet).**
4. Place the large sealing washer over the threaded mount of the **Black Berkey®** purification element.
5. Place the threaded mount stem into the hole in the interior base of the upper chamber.
6. Secure element in the base of the chamber by screwing the wing nut onto the threaded mount. Repeat #3- #6 until all elements have been installed.

**OPERATION:**

Fill upper chamber with cold room temperature water (**do not use hot or boiling water**) and cover with lid. Allow water to filter into lower chamber. Open the spigot to allow all water to run to waste. This will flush fines and process dust from inner bore of the purification elements. (Note: Do not be concerned if particulate is visible within flush water, this is normal). Refill upper chamber, your system is now ready to purify water.

**Note: Purification elements may take up to 15 minutes to begin dripping. Maximum flow rate will be achieved after the initial 12-20 hours of use as micro air pockets within purification elements are replaced with water.**

**MAINTENANCE:**

As the elements filter out particulate from the water, the flow will gradually reduce over time. When this occurs, remove the element and scrub the outer surface with a stiff toothbrush or ScotchBrite® pad under running water. Re-prime elements (optional). This procedure will restore the flow rate to normal. Take precautions not to contaminate the threaded portion of the purifying elements. If contamination does occur, wipe threads with an alcohol swab.

**Never wash purifying elements with soap. NEVER CLEAN ELEMENTS IN A DISHWASHER.**

**SYSTEM TEST:** Your **Black Berkey®** purification elements are powerful enough to remove red food coloring from water; this feature allows you to make sure your system is operating properly. Simply fill the upper chamber with water and add one teaspoon of artificial red food coloring per gallon capacity of your system. If the red food coloring is removed entirely, your purification system is working properly. If not, check to make sure that the wing nuts on your elements are securely tightened, then re-run the test. We recommend this test be done upon receiving the elements, first actual use, then while in use-every 3 to 6 months, before you take your system out of the country, or any time you use your system after drying and storing the elements for an extended period of time.

**GENERAL WARRANTY INFORMATION**

**Black Berkey®** purification elements have a two-year prorated warranty calculated in six months intervals from the date of purchase. New Millennium Concepts, Ltd. (NMCL) will replace or repair any product that it deems is not properly functioning during the stated warranty period. Relief under this warranty is limited to the replacement or repair of defective materials or workmanship only. NMCL shall not be held liable for incidental or consequential damage to personal property from, but not limited to, a defective unit, improper use, abuse, accident, or neglect, etc. NMCL shall not be responsible for any damage or loss other than for the product purchased. It is the customers responsibility to prevent misuse of the system and to replace parts when, due to the natural course of wear and tear, they must be replaced. No warranty will apply to units which have been used for purposes not intended, which have been altered so as, in the manufacturers judgment, to affect adversely its performance. This warranty is for the original retail purchaser only, and cannot be transferred. Repair or replacement of parts will be made upon delivery to manufacturer's plant or authorized service dealer at customer's expense. The laws of the State of Texas, USA, will govern any disputes regarding this warranty or claim made. This warranty which is given expressly in lieu of all warranties, expressed or implied, or merchantability and fitness for a particular purpose, constitutes the only warranty made by New Millennium Concepts, Ltd. (NMCL). Each **Black Berkey®** element will give efficient purification for up to 3,000 gallons (6,000 per set of two) for the contaminants listed on box. The **Black Berkey®** element formulation has been tested by State & EPA accredited laboratories to exceed EPA & ANS/NSF (Std. 53) protocol. Tested by Analytical Services, the County of Los Angeles, Environmental Toxicology Lab, Envirotek Laboratories, Inc. & Water Filter Labs.

For questions, please contact your local **Berkey®** distributor, or call (888) 803-4438 / (817) 481-0717

## PRIMING THE **Black Berkey**® PURIFICATION ELEMENTS

-The micro-pores within the **Black Berkey**® purification elements are extremely small, in fact they are small enough to filter food coloring from water. The benefit from having such extremely small pores is that an exponential increase is realized in the efficiency at removing viruses, pathogenic bacteria and other waterborne contaminants.

-Water tension may require that the purification elements be primed in order to flow properly. Water tension is higher in certain parts of the country and can change from season to season. The higher the water tension, the more difficult it is for the water, using gravity pressure alone, to force the air from the micro-pores of a new element. Priming your purification elements forces the air from the micro pores of the element.

**-Notes When Traveling:** When using the system in an area where treated water is not available, we recommend that the user bring along a bottle of clean water, or the **Black Berkey Primer**™ (sold separately) to prime the purification elements. Using bottled water, have one person hold the element, with the priming button attached and facing upward. Have a second person press the mouth of the bottled water against the priming button and squeeze until water is forced through the entire exterior wall of the element and it begins to sweat beads of water. Alternatively, the elements can also be primed using the **Black Berkey Primer**™. The **Black Berkey Primer**™ is a hand-powered priming pump that makes it possible to prime elements easily, without the need for faucets or hose connections.

-Do not discard priming button after purification elements have been primed. Re-prime elements after cleaning (see maintenance instructions) and when elements have been allowed to dry for a prolonged period of time.

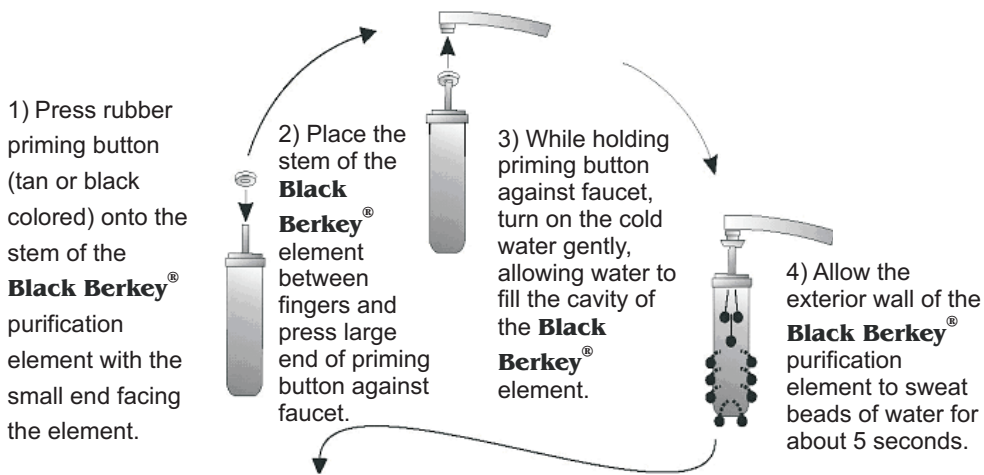

5) Rinse process dust from exterior of purification element. The element has now been successfully primed. Repeat steps 1 - 5 for each additional element.



## PRIMING THE **Black Berkey**® PURIFICATION ELEMENTS

-The micro-pores within the **Black Berkey**® purification elements are extremely small, in fact they are small enough to filter food coloring from water. The benefit from having such extremely small pores is that an exponential increase is realized in the efficiency at removing viruses, pathogenic bacteria and other waterborne contaminants.

-Water tension may require that the purification elements be primed in order to flow properly. Water tension is higher in certain parts of the country and can change from season to season. The higher the water tension, the more difficult it is for the water, using gravity pressure alone, to force the air from the micro-pores of a new element. Priming your purification elements forces the air from the micro pores of the element.

**-Notes When Traveling:** When using the system in an area where treated water is not available, we recommend that the user bring along a bottle of clean water, or the **Black Berkey Primer**™ (sold separately) to prime the purification elements. Using bottled water, have one person hold the element, with the priming button attached and facing upward. Have a second person press the mouth of the bottled water against the priming button and squeeze until water is forced through the entire exterior wall of the element and it begins to sweat beads of water. Alternatively, the elements can also be primed using the **Black Berkey Primer**™. The **Black Berkey Primer**™ is a hand-powered priming pump that makes it possible to prime elements easily, without the need for faucets or hose connections.

-Do not discard priming button after purification elements have been primed. Re-prime elements after cleaning (see maintenance instructions) and when elements have been allowed to dry for a prolonged period of time.

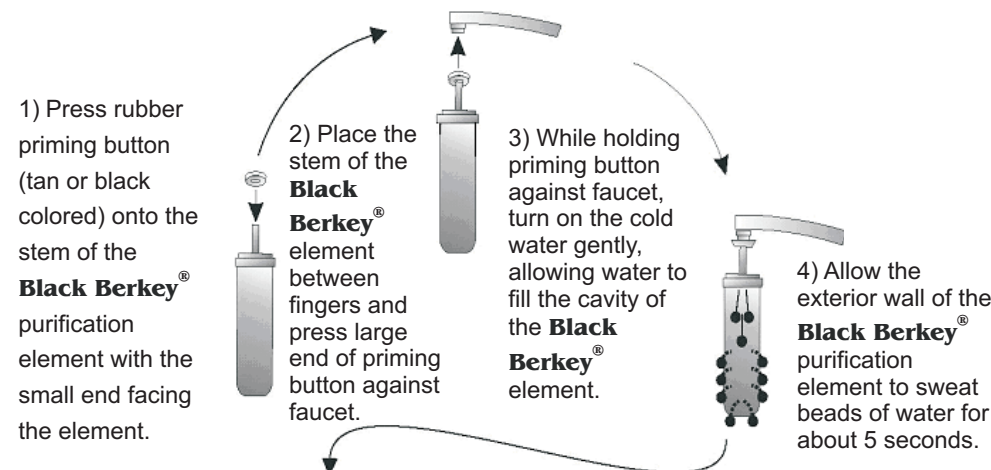

5) Rinse process dust from exterior of purification element. The element has now been successfully primed. Repeat steps 1 - 5 for each additional element.

