

D3542EVO Motor 基本参数

测试KV	KV1000	重量 (含线)	136g
电机尺寸	φ35.3 x42mm	相间内阻	34.4mΩ
引线规格	85mm	槽极	12N14P
轴径	5mm	工作额定电压 (Lipo)	3-4S
空载电流	2.05A	最大电流 (60S)	50.28A
最大功率	585.2W	最大拉力	2136g(3S/APC13x6.5)

测试KV	KV1250	重量 (含线)	136g
电机尺寸	φ35.3 x42mm	相间内阻	24mΩ
引线规格	85mm	槽极	12N14P
轴径	5mm	工作额定电压 (Lipo)	3-4S
空载电流	2.66A	最大电流 (60S)	62.94A
最大功率	961.7W	最大拉力	2567g(3S/APC10x6)

测试KV	KV1400	重量 (含线)	137.4g
电机尺寸	φ35.3 x42mm	相间内阻	19mΩ
引线规格	85mm	槽极	12N14P
轴径	5mm	工作额定电压 (Lipo)	3-4S
空载电流	3.34A	最大电流 (60S)	53.02A
最大功率	613.4W	最大拉力	2036g(3S/APC10x5)

MOTOR OUTLINES:

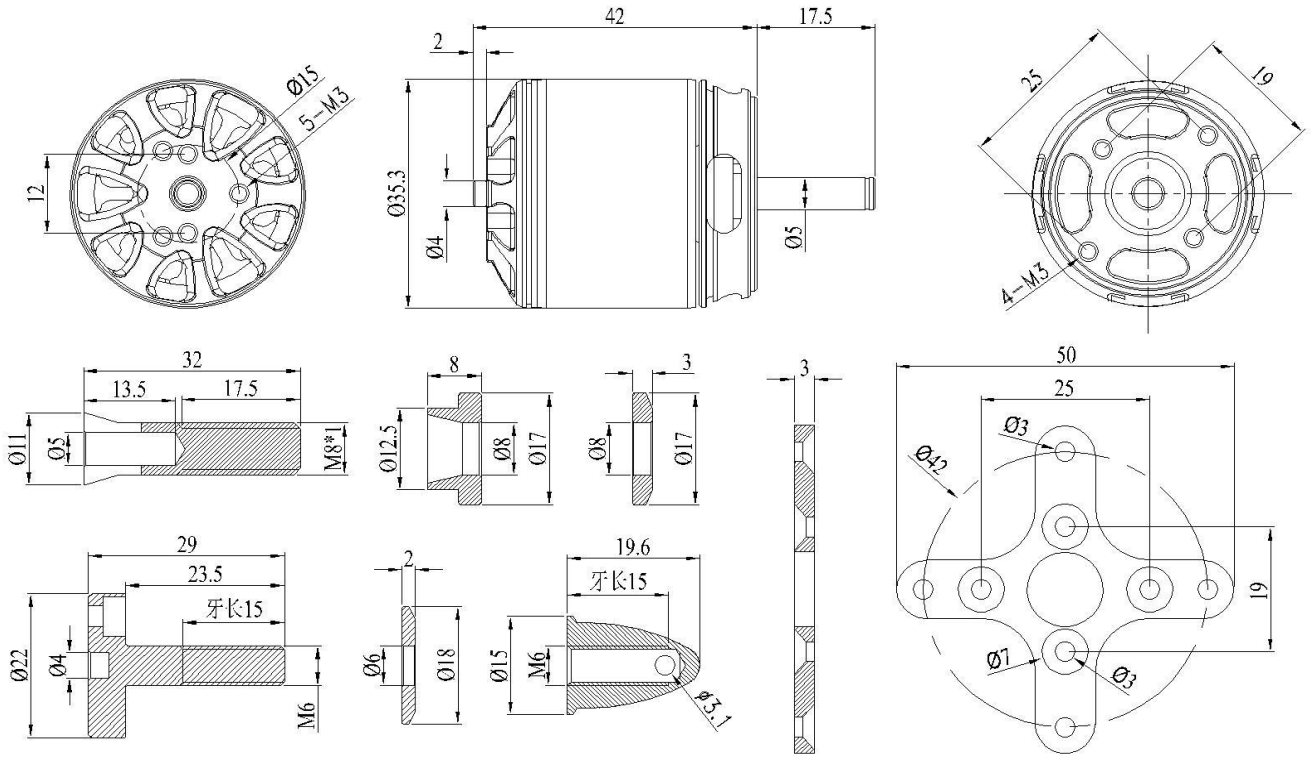

MOTOR TECHNICAL DATA:

Item NO.	Volts(V)	Prop	Throttle(%)	CURRENT (A)	Power(W)	Thrust (g)	PRM	Efficiency (g/W)	Operating temperature(°C)
D3542-1000KV(EVO)	12.47	10x5	40%	7.29	90.9	591	6204	5.6	41.5°C
	12.43		50%	9.69	120.4	723	6871	5.4	
	12.39		60%	11.97	148.3	828	7409	5.2	
	12.35		70%	14.16	174.9	947	7865	4.8	
	12.29		80%	17.53	215.4	1088	8495	4.8	
	12.18		90%	23.58	287.2	1346	9342	4.6	
	12.13		100%	26.84	325.6	1451	9703	4.4	
	12.44	APC 11x7	40%	8.32	103.5	623	5289	6.0	43.8°C
	12.40		50%	11.38	141.1	771	5887	5.5	
	12.34		60%	14.87	183.5	914	6381	5.0	
	12.25		70%	19.84	243.0	1090	6994	4.5	
	12.13		80%	26.48	321.2	1304	7632	4.1	
	11.97		90%	35.49	424.8	1523	8269	3.6	
	11.87		100%	40.27	478.0	1615	8517	3.4	
	12.46	APC 12x6	40%	8.08	100.7	691	5470	6.9	44.3°C
	12.42		50%	11.10	137.9	829	6120	6.0	
	12.36		60%	14.23	175.9	1002	6622	5.7	
	12.29		70%	18.24	224.2	1196	7175	5.3	
	12.18		80%	24.08	293.3	1444	7868	4.9	
	12.04		90%	32.14	387.0	1736	8514	4.5	
	11.96		100%	36.70	438.9	1867	8805	4.3	
	12.45	APC 13x6.5	40%	8.88	110.6	737	4534	6.7	47.3°C
	12.38		50%	12.75	157.8	948	5121	6.0	
	12.29		60%	18.04	221.7	1204	5696	5.4	
	12.15		70%	25.77	313.1	1392	6325	4.4	
	11.98		80%	34.80	416.9	1777	6820	4.3	
	11.77		90%	44.94	528.9	2033	7267	3.8	
	11.65		100%	50.28	585.8	2136	7417	3.6	

D3542-1250KV(EVO)	12.48	APC9x6	40%	10.18	127.0	639	7631	5.0	44.2°C
	12.42		50%	13.52	167.9	784	8457	4.7	
	12.37		60%	16.59	205.2	909	9072	4.4	
	12.31		70%	19.45	239.4	983	9589	4.1	
	12.25		80%	23.55	288.5	1097	10238	3.8	
	12.10		90%	30.98	374.9	1395	11177	3.7	
	12.04		100%	34.89	420.1	1530	11619	3.6	
D3542-1250KV(EVO)	12.47	APC10x6	40%	11.12	138.7	717	7114	5.2	48.4°C
	12.41		50%	14.94	185.4	891	7884	4.8	
	12.33		60%	18.72	230.8	1048	8451	4.5	
	12.27		70%	22.13	271.5	1160	8995	4.3	
	12.16		80%	28.18	342.7	1387	9695	4.0	
	12.00		90%	36.68	440.2	1646	10572	3.7	
	11.90		100%	41.92	498.8	1789	10923	3.6	
D3542-1250KV(EVO)	16.34	APC10x6	40%	15.76	257.5	1079	8558	4.2	52.3°C
	16.24		50%	21.35	346.7	1331	9450	3.8	
	16.14		60%	26.91	434.3	1550	10140	3.6	
	16.02		70%	33.31	533.6	1788	10871	3.3	
	15.82		80%	43.24	684.1	2078	11807	3.0	
	15.47		90%	56.42	872.8	2438	12614	2.8	
	15.28		100%	62.94	961.7	2567	12919	2.7	
D3542-1400KV(EVO)	12.33	APC9x6	40%	12.92	159.3	757	8159	4.8	47.5°C
	12.26		50%	17.26	211.6	926	9036	4.4	
	12.19		60%	21.29	259.5	1085	9721	4.2	
	12.12		70%	25.24	305.9	1233	10239	4.0	
	12.02		80%	30.55	367.2	1408	10920	3.8	
	11.85		90%	39.43	467.2	1670	11878	3.6	
	11.74		100%	44.78	525.7	1815	12293	3.5	
D3542-1400KV(EVO)	12.32	APC10x5	40%	14.08	173.5	840	7573	4.8	55.1°C
	12.23		50%	18.97	232.0	1021	8382	4.4	
	12.15		60%	23.71	288.1	1196	9005	4.2	
	12.06		70%	28.34	341.8	1361	9529	4.0	
	11.93		80%	35.67	425.5	1593	10302	3.7	
	11.71		90%	46.11	539.9	1861	11112	3.4	
	11.57		100%	53.02	613.4	2036	11465	3.3	

Notes: The test condition of temperature is motor surface temperature in 100% throttle while the motor run 15 s. environment temperature 26°C