

D2826 Out Runner Brushless Motor Instruction

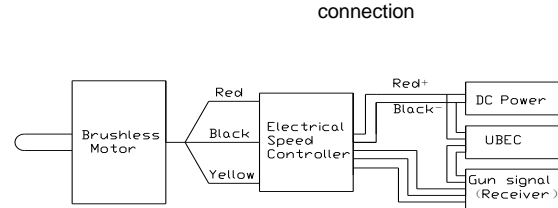
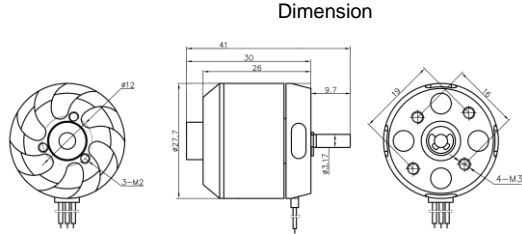

Congratulation for your purchase of high performance brushless outrunner motor series.

Our motors are designed to use perfectly with our own electronic speed controllers. But it is also possible to use them with most of other common electronic speed controllers. The motors are designed for running clockwise or counterclockwise. To change the turning direction you just simply exchange the red and yellow connection wire. If you want to use other speed controllers, please refer to your controller instruction manual.

D2826 (2212) SERIES OUTRUNNER BRUSHLESS MOTOR

Model	Volts	KV (rpm/v)	Max pull	Weight	Motor size	Shaft size	Max power	ESC(A)	Battery/prop
D2826-6	7.4~11.1V	2200	960g	50g	$\Phi 27.7*26\text{mm}$	$\Phi 3.175 \times 41\text{mm}$	342watt	40A	LiPox2/7x4 LiPox3/7x3
D2826-10		1400	780g				205watt		LiPox2/9x4.7 LiPox3/7x4
D2826-13		1000	660g				150watt		LiPox2/11x7 LiPox3/10x5
D2826-15		930	645g				130watt		LiPox2/12x6 LiPox3/11x7

Product description

1. Mount your motor with the includes screws tightly on your front cover of model.
2. Our motors provide high efficiency stator design.
3. Small size, lightweight and long life.

ATTENTION:

1. Please make sure your motor has enough cooling while running. Consider to put a whole into your model motor cover to improve the ventilation.
 2. Our motors providing best performance with the recommended propeller size. If you consider to change the propeller size be aware that motor can overheat and damaged.
 3. Keep motors away from moisture, dust, scrap and small items to avoid damages.
- We wish you many happy landings with our long life quality equipment.