

D2822 Out Runner Brushless Motor Instruction

Dimension

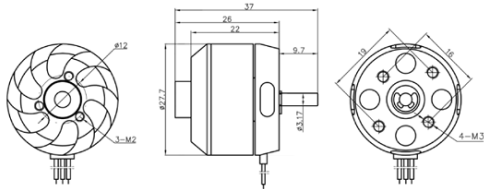

connection

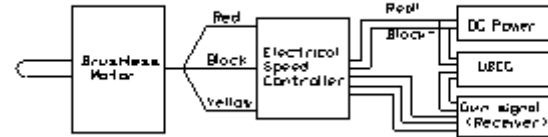

Congratulation for your purchase of high performance brushless outrunner motor series.

Our motors are designed to use perfectly with our own electronic speed controllers. But it is also possible to use them with most of other common electronic speed controllers. The motors are designed for running clockwise or counterclockwise. To change the turning direction you just simply exchange the red and yellow connection wire. If you want to use other speed controllers, please refer to your controller instruction manual.

D2822(2208) SERIES OUTRUNNER BRUSHLESS MOTOR

Model	Volts	KV (rpm/V)	Max Pull	Weight	Motor size	Shaft size	Max Power	ESC	Battery/prop
D2822-8	7.4~11.1V	2600	850g	38g	Φ28x22mm	Φ3.175x37mm	260watt	30A	LiPo × 2/7 × 3 LiPo × 3//6 × 4
D2822-12		1800	660g				180watt		LiPo × 2/8 × 4 LiPo × 3/7 × 3
D2822-14		1450	550g				160watt		LiPo × 2/8 × 6 LiPo × 3/7 × 4.5
D2822-17		1100	520g				102watt		LiPo × 2/8 × 6 LiPo × 3/7 × 4

Product description

1. Mount your motor with the includes screws tightly on your front cover of model.
2. Our motors provide high efficiency stator design.
3. Small size, lightweight and long life.

ATTENTION:

1. Please make sure your motor has enough cooling while running. Consider to put a whole into your model motor cover to improve the ventilation.
2. Our motors providing best performance with the recommended propeller size. If you consider to change the propeller size be aware that motor can overheat and damaged.
3. Keep motors away from moisture, dust, scrap and small items to avoid damages.
We wish you many happy landings with our long life quality equipment.