

**SINGLE ENDED BEAM, NICKEL PLATED  
ALLOY STEEL IP67**

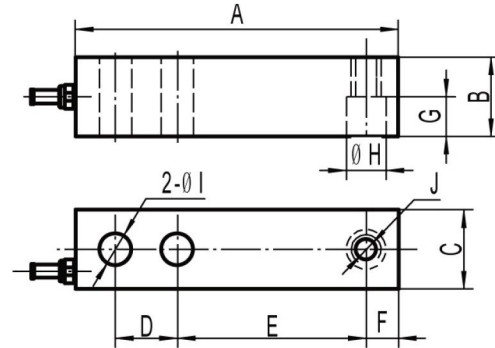

SPECIFICATIONS		
PART#	CAPACITY	ENVELOPE
LS-818-0.25	250 lbs	Small
LS-818-0.5	500 lbs	Small
LS-818-1	1,000 lbs	Small
LS-818-1.5	1,500 lbs	Small
LS-818-2.5	2,500 lbs	Small
LS-818-4	4,000 lbs	Small
LS-818-5	5,000 lbs	Small
LS-818LE-5	5,000 lbs	Large
LS-818-10	10,000 lbs	Large
LS-818-15	15,000 lbs	Large
LS-818-20	20,000 lbs	Large

RATED CAPACITY	DIMENSIONS									
	A	B	C	D	E	F	G	H	I	J
<b>lb/inches</b>										
100-5K lbs	5.12	1.25	1.25	1.00	3.00	0.50	0.62	0.53	0.53	1/2-20UNF
5K LE-10K lbs	6.75	1.50	1.50	1.50	3.75	0.75	0.75	0.78	0.78	3/4-6UNF
15K-20K lbs	8.88	2.00	2.00	2.00	4.88	1.00	1.00	1.03	1.03	1-14UNF
<b>kg/mm</b>										
45-2,268 kg	130.05	31.75	31.75	25.40	76.20	12.70	15.75	13.46	13.46	1/2-20UNF
2,268 LE-4,536 kg	171.45	38.10	38.10	38.10	95.25	19.05	19.05	19.81	19.81	3/4-16UNF
6,804-9,072 kg	225.55	50.80	50.80	50.80	123.95	25.40	25.40	26.16	26.16	1-14UNF
<b>kg/mm</b>										
50-2,500 kg	130.05	31.75	31.75	25.40	76.20	12.70	15.75	13.46	13.46	M12
3,000-5,000 kg	171.45	38.10	38.10	38.10	95.25	19.05	19.05	19.81	19.81	M20
7,000-10,000 kg	225.55	50.80	50.80	50.80	123.95	25.40	25.40	26.16	26.16	M24X2
<b>lb/inches</b>										
110-5.5K lbs	5.12	1.25	1.25	1.00	3.00	0.50	0.62	0.53	0.53	M12
6.6K-11K lbs	6.75	1.50	1.50	1.50	3.75	0.75	0.75	0.78	0.78	M20
15.4K-22K lbs	8.88	2.00	2.00	2.00	4.88	1.00	1.00	1.03	1.03	M24X2

Note: LE - large envelope

**SPECIFICATIONS**

**Rated Capacity:**

lb: 100/250/500/750K/1K/1.5K/  
2K/2.5K/4K/5K/5K LE/  
10K/15K/20K

kg: 50/100/200/300/500/1,000  
1,500/2,000/2,500/3,000/  
5,000/7,000/10,000

**Rated Output:**

3.0mV/V

**Non-Linearity:**

±0.03% F.S.

**Hysteresis:**

±0.03% F.S.

**Repeatability:**

±0.02% F.S.

**Creep (30 minutes):**

±0.02% F.S.

**Temperature Effect on Span:**

±0.0015% F.S./C

**Temperature Effect on Zero:**

±0.0027% F.S./C

**Zero Balance:**

±1.00% F.S.

**Insulation Resistance:**

>5000 MEGOHMS

**Input Impedance:**

385±20Ω

**Output Impedance:**

350±3Ω

**Safe Overload:**

150% F.S

**Destructive Load:**

300% F.S

**Excitation Recommended:**

10-15V AC/DC

**Material/Finish:**

Alloy Steel

**Operation Temperature:**

-10°C - + 40°C (14°F - 104°F)

**Cable Length:**

Standard Cable - 20ft/6m

**Load Cell Wiring:**

Red..... +Excitation  
Black..... -Excitation  
Green..... +Signal  
White..... -Signal

**INTERCHANGEABLE PRODUCTS**

Artech: **30310**

Revere: **5123**

Celtron: **SQB**

Coti Global Sensors: **CG-23**

Tedea: **3411**

Totalcomp: **TSB**

**WEIGHING MODULES AVAILABLE**

LS-818-TM