

**SINGLE POINT BEAM, ALUMINUM IP67**

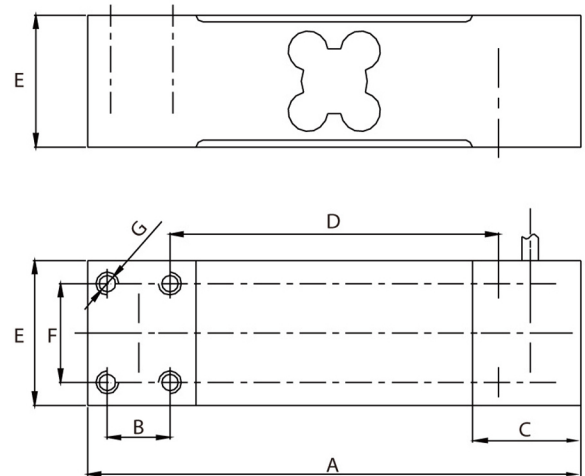

RATED CAPACITY	DIMENSIONS						
	A	B	C	D	E	F	G
<b>kg/mm</b>							
50-350 kg	150	19	33	100	44	30	M8
<b>lb/inches</b>							
100-700 lb	5.91	0.75	2.05	3.94	1.73	1.18	M8

**Rated Capacity:**

50/100/150/200/250/  
300/350 kg

**Rated Output:**

2.0±0.2mV/V

**Non-linearity:**

±0.02% F.S.

**Hysteresis:**

±0.02% F.S.

**Repeatability:**

±0.02% F.S.

**Temperature Effect on Span:**

±0.0015% F.S./°C

**Temperature Effect on Zero:**

±0.0027% F.S./°C

**Zero Balance:**

±1.00% F.S.

**Insulation Resistance:**

> 5000 MEGOHMS

**Compensated Temperature Range:**

-10°C - +40°C (14°F-104°F)

**Creep(30 minutes):**

±0.016% F.S.

**Input Resistance:**

410±10Ω

**Output Resistance:**

352±2Ω

**Safe Overload:**

150% F.S.

**Excitation Recommended:**

4-12V AC/DC

**Material/Finish:**

Aluminum

**Cable Length:**

Standard cable

10ft/3m

**Load Cell Wiring:**

Red.....+Excitation

Black.....- Excitation

Green .....+Signal

White ..... - Signal

**Max Platform Size:**

400mm x 400mm